

**NOTES:**  
 1. CONTROL LINE REFERENCE IS ALONG SOUTHBOUND CURB LANE GUTTER AND NORTHBOUND CURB LANE GUTTER.  
 2. ABUTMENT WORKING POINTS (WP) ARE LOCATED ON THE ABUTMENT WALL BEARING SEAT AT THE FACE OF THE BALLAST WALL.  
 3. SEE SHEET 14 FOR BORE LOGS.  
 4. SEE SHEETS 26 THROUGH 29 FOR ROCK SOCKETED CAISSON DETAILS.

**FOUNDATION LAYOUT**  
1:125

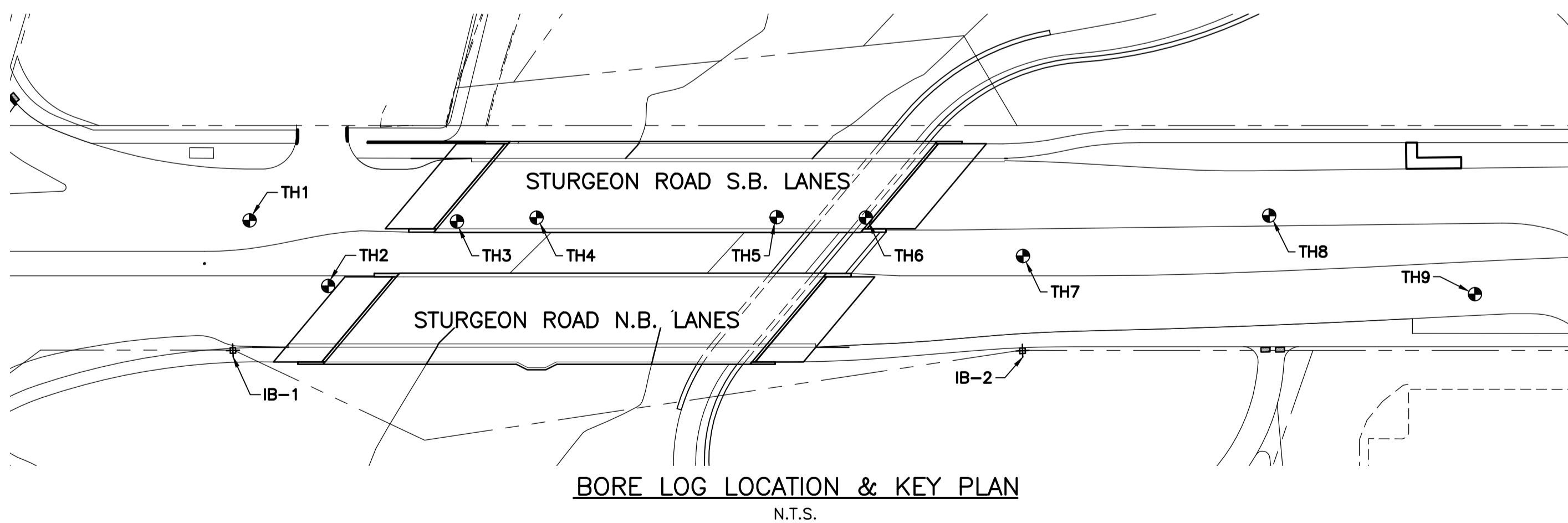

**BORE LOG LOCATION & KEY PLAN**  
N.T.S.

WORK POINT LOCATION & ELEVATION				
BM.	NORTHING	EASTING	ELEVATION	DESCRIPTION
B.M.	5527114.360	623668.570	236.590	83R592
IB-1	5526707.002	623657.134	234.577	IRON BAR
IB-2	5526813.955	623661.025	234.331	IRON BAR
S.B. WP-1	5526743.151	623632.840	235.251	TOP OF ABUTMENT BEARING SEAT
S.B. WP-2	5526760.632	623633.469	235.558	TOP OF PIER
S.B. WP-3	5526783.504	623634.292	236.038	TOP OF PIER
S.B. WP-4	5526800.984	623634.921	236.466	TOP OF ABUTMENT BEARING SEAT
N.B. WP-1	5526721.551	623656.779	234.799	TOP OF ABUTMENT BEARING SEAT
N.B. WP-2	5526739.030	623657.408	235.158	TOP OF PIER
N.B. WP-3	5526761.901	623658.231	235.708	TOP OF PIER
N.B. WP-4	5526779.380	623658.860	236.185	TOP OF ABUTMENT BEARING SEAT

BILL OF CAISSONS						
No.	PILE TYPE	DESCRIPTION	LOCATION	APPROX. AVERAGE LENGTH (m)	TOTAL (m)	
3	914 O.D. x 9.5 THK. CONC. FILLED STEEL CASING	CAISSON	S.B. SU.2	12.8	38.4	
3	762Ø CONC. FILLED ROCK SOCKET	CAISSON	S.B. SU.2	4.5	13.5	
3	914 O.D. x 9.5 THK. CONC. FILLED STEEL CASING	CAISSON	S.B. SU.3	13.2	39.6	
3	762Ø CONC. FILLED ROCK SOCKET	CAISSON	S.B. SU.3	4.5	13.5	
3	914 O.D. x 9.5 THK. CONC. FILLED STEEL CASING	CAISSON	N.B. SU.2	12.8	38.4	
3	762Ø CONC. FILLED ROCK SOCKET	CAISSON	N.B. SU.2	4.5	13.5	
3	914 O.D. x 9.5 THK. CONC. FILLED STEEL CASING	CAISSON	N.B. SU.3	13.3	39.9	
3	762Ø CONC. FILLED ROCK SOCKET	CAISSON	N.B. SU.3	4.5	13.5	
					<b>TOTAL LENGTH (m)</b>	<b>655.0</b>

BILL OF PILES						
No.	PILE TYPE	DESCRIPTION	LOCATION	LENGTH (m)	TOTAL (m)	
10	HP360x132 STEEL PILE	ABUTMENT	S.B. SU.1	16.0	160.0	
10	HP360x132 STEEL PILE	ABUTMENT	N.B. SU.1	15.5	155.0	
10	HP360x132 STEEL PILE	ABUTMENT	S.B. SU.4	17.0	170.0	
10	HP360x132 STEEL PILE	ABUTMENT	N.B. SU.4	17.0	170.0	
					<b>TOTAL LENGTH (m)</b>	<b>655.0</b>

83R592 - S.E. COR. STURGEON RD. & BOOTH DR., TBLT. ON TOP OF 0.05m DIA. X 2.4m IRON PIPE, 3.5m W. OF E.L. OF STURGEON RD. & 3.3m N. OF S.L. OF BOOTH DR.

**APEGM**  
 Certificate of Authorization  
 Stantec Consulting Ltd.  
 No. 1301 Date: \_\_\_\_\_

**LOCATION APPROVED UNDERGROUND STRUCTURES**  
 SUPV. U/G STRUCTURES COMMITTEE DATE \_\_\_\_\_  
 NOTE:  
 LOCATION OF UNDERGROUND STRUCTURES AS SHOWN ARE BASED ON THE BEST INFORMATION AVAILABLE BUT NO GUARANTEE IS GIVEN THAT ALL EXISTING UTILITIES ARE SHOWN OR THAT THE GIVEN LOCATIONS ARE EXACT. CONFIRMATION OF EXISTENCE AND EXACT LOCATION OF ALL SERVICES MUST BE OBTAINED FROM THE INDIVIDUAL UTILITIES BEFORE PROCEEDING WITH CONSTRUCTION.

NO.	ISSUED FOR TENDER	DATE	BY
0	ISSUED FOR TENDER	11.12.15	K.S.A.
NO.	REVISIONS	DATE	BY

**Stantec Consulting Ltd.**  
 100-1355 Taylor Ave., Winnipeg, Manitoba  
 Tel 204-928-8840 Fax 204-284-4795

DESIGNED BY	K.S.A.	CHECKED BY	K.S.A.
DRAWN BY	J.M.B.	APPROVED BY	B.J.W.
HOR. SCALE:	AS SHOWN	RELEASED FOR CONSTRUCTION:	
VERTICAL:		DATE	DEC. 15, 2011

ENGINEER'S SEAL  
 CONSULTANT DRAWING NO.  
**S-104**

**THE CITY OF WINNIPEG**  
 PUBLIC WORKS DEPARTMENT  
 ENGINEERING DIVISION

**STURGEON ROAD**  
 BRIDGE REPLACEMENT  
 PORTAGE AVENUE TO HALLONQUIST DRIVE  
 FOUNDATION LAYOUT & DETAILS

SHEET **12** OF **81**  
 CAD FILE DRAWING NUMBER  
 31590s-104-767.dwg  
 CITY DRAWING NUMBER  
**B120-12-012**

V:\1137\1590\drawing\402\_design\sheet\_files\2011-11-12\_tender\_issue\31590s-104-767.dwg  
 Date: 2011 Dec 20 2:49pm Login: Beermorts, James