

ELEVATION

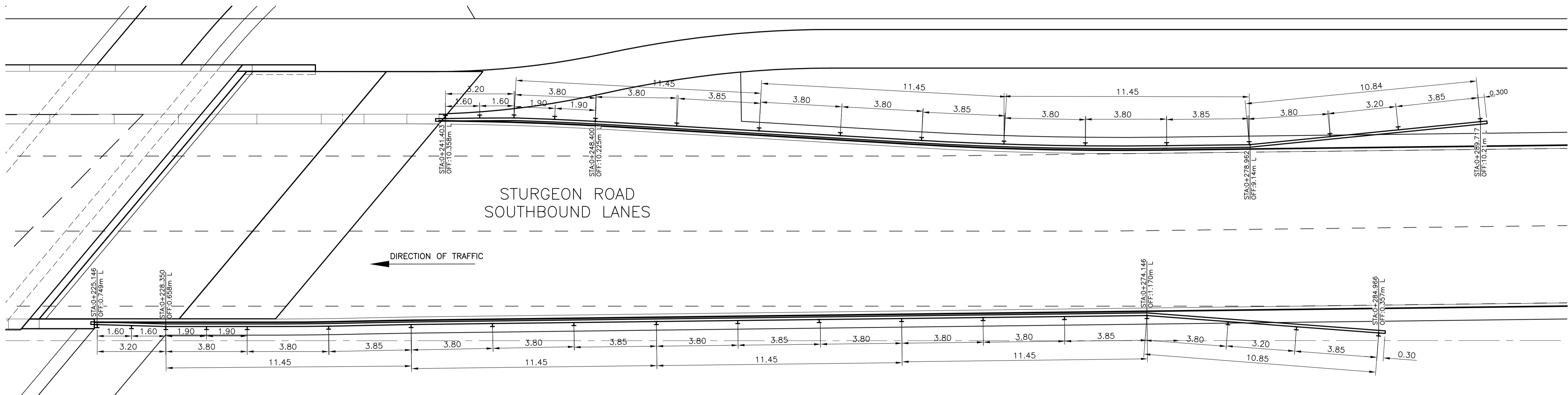

STURGEON ROAD SOUTHBOUND LANES

PLAN

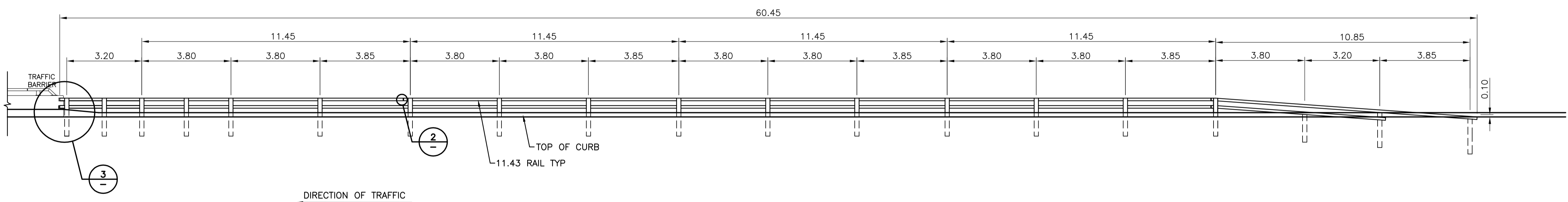

ELEVATION

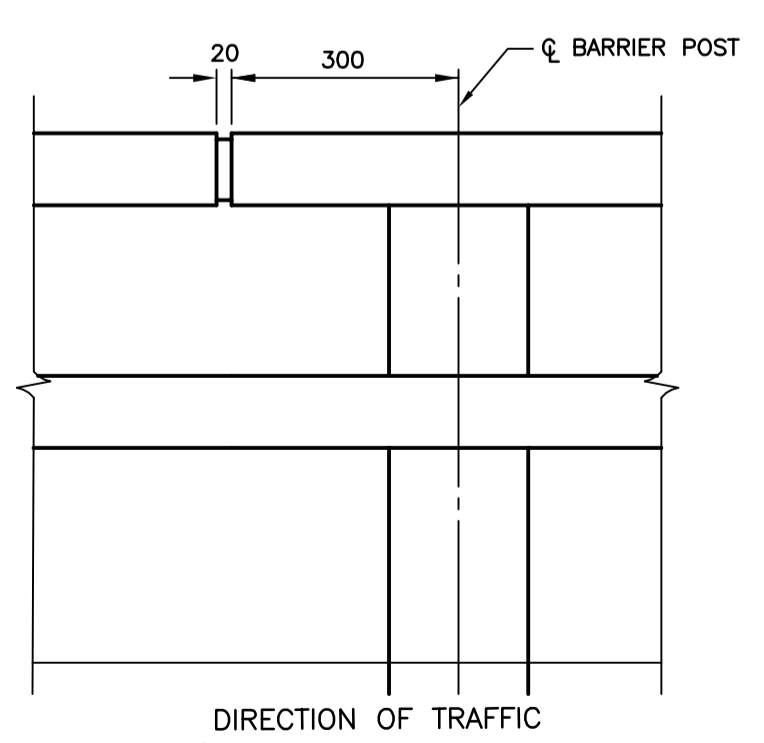

2 SPLICE DETAIL
1 : 10

1 STURGEON ROAD - SOUTHBOUND LANES
58 N.T.S.

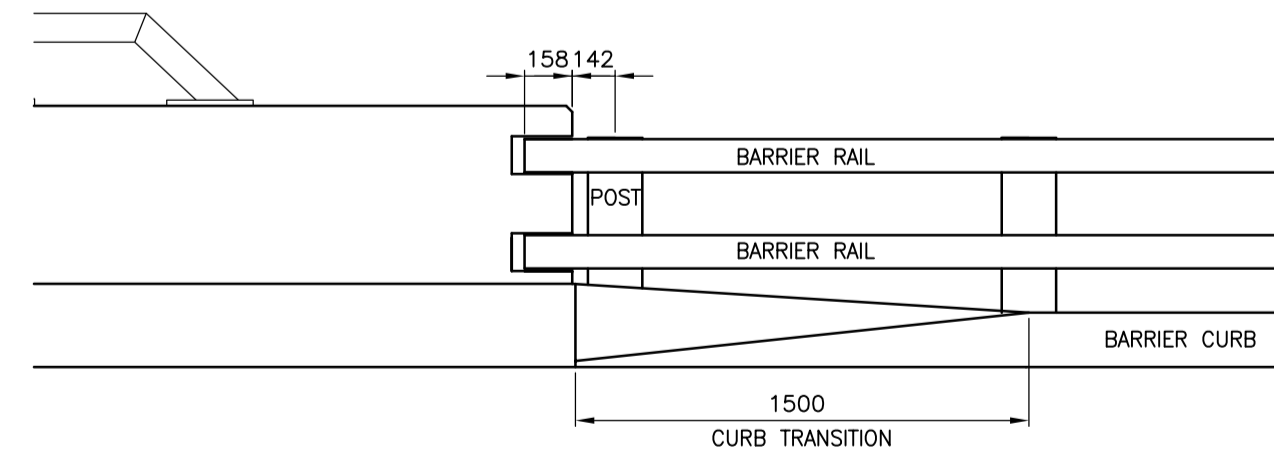

3 BARRIER TIE-IN DETAIL
1:25

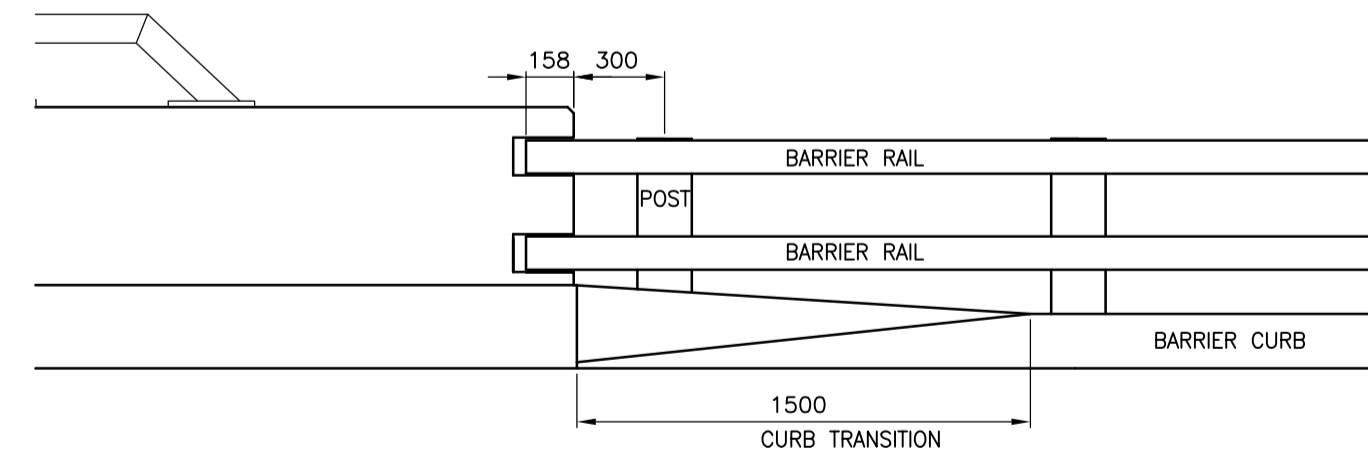

4 BARRIER TIE-IN DETAIL
1:25

METRIC
WHOLE NUMBERS INDICATE MILLIMETRES
DECIMALIZED NUMBERS INDICATE METRES

LOCATION APPROVED UNDERGROUND STRUCTURES

SUPV. U/G STRUCTURES COMMITTEE DATE

NOTE:
LOCATION OF UNDERGROUND STRUCTURES AS SHOWN ARE BASED ON THE BEST INFORMATION AVAILABLE BUT NO GUARANTEE IS GIVEN THAT ALL EXISTING UTILITIES ARE SHOWN OR THAT THE GIVEN LOCATIONS ARE EXACT. CONFIRMATION OF EXISTENCE AND EXACT LOCATION OF ALL SERVICES MUST BE OBTAINED FROM THE INDIVIDUAL UTILITIES BEFORE PROCEEDING WITH CONSTRUCTION.

B.M. ELEV.	DATE	BY
	11.12.15	V.M.M.
0	ISSUED FOR TENDER	
	NO. REVISIONS	

Stantec Consulting Ltd.
100-1355 Taylor Ave., Winnipeg, Manitoba
Tel 204-928-8840 Fax 204-284-4795

DESIGNED BY: V.M.M. CHECKED BY: R.P.K.
DRAWN BY: T.G. APPROVED BY: V.M.M.

HOR. SCALE: AS NOTED
VERTICAL: _____

RELEASED FOR CONSTRUCTION: _____
DATE: 10.10.20

ENGINEER'S SEAL

CONSULTANT DRAWING NO.
C-503

THE CITY OF WINNIPEG
PUBLIC WORKS DEPARTMENT
ENGINEERING DIVISION

STURGEON ROAD
BRIDGE REPLACEMENT
PORTAGE AVENUE TO HALLONQUIST DRIVE
SOUTHBOUND LANES - NORTH OF BRIDGE
ALUMINUM BALANCED BARRIER DETAILS

SHEET **81** OF **82**
CAD FILE DRAWING NUMBER
31590c-502-767.dwg
CITY DRAWING NUMBER
P-3331-19

V:\1137\active\113705040\drawing_A020208.DWG\A02.dwg\sheet\sheet\package_C:\PWC-GD_PACKAGES\05040-505-xxx.dwg
2011 October 20, 12:24 p.m.