

- CONSTRUCTION NOTES:**
- CONTRACTOR SHALL TAKE PRECAUTIONARY STEPS TO AVOID DAMAGE FROM CONSTRUCTION ACTIVITIES TO EXISTING BOULEVARDS AND TREES WITHIN THE LIMITS OF CONSTRUCTION.
  - LOCATION OF EXISTING SERVICES ARE TO BE CONFIRMED IN THE FIELD BY THE CONTRACTOR.
  - TIE-INS TO BE VERIFIED IN THE FIELD BY THE CONTRACT ADMINISTRATOR.
  - BOULEVARD REPLACEMENT TO BE FINALIZED IN THE FIELD BY THE CONTRACT ADMINISTRATOR.
  - ALL APPROACHES TO RECEIVE NEW CSP CULVERTS AS DIRECTED BY THE CONTRACT ADMINISTRATOR.
  - BACK SLOPES OF DITCHES TO BE GRADED BACK AT 4:1 WHERE POSSIBLE TO A MAX OF 2:1

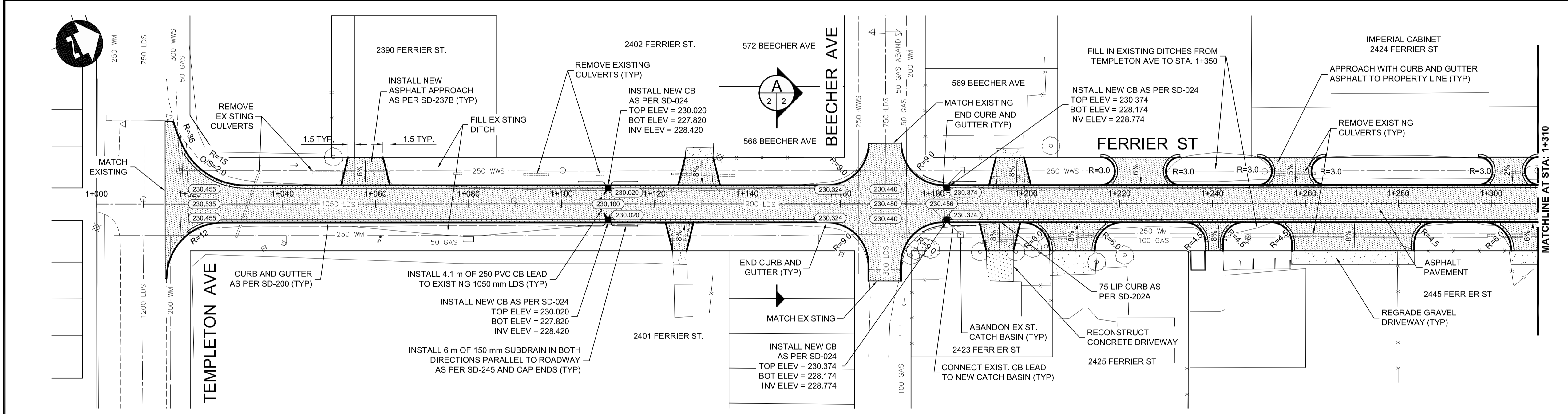

**METRIC**  
WHOLE NUMBERS INDICATE MILLIMETRES  
DECIMALIZED NUMBERS INDICATE METRES

**WARNING**  
IF POWER EQUIPMENT OR EXPLOSIVES ARE TO BE USED FOR EXCAVATION ON THIS PROJECT THE CONTRACTOR MUST:

- NOTIFY THE GAS COMPANY OF THE PROPOSED LOCATION OF EXCAVATION.
- TAKE PRECAUTION TO AVOID DAMAGE TO GAS COMPANY INSTALLATIONS SEE PROVINCIAL REGULATION 210/72 FOR DETAILS.
- OBTAIN EXCAVATION PERMITS PRIOR TO CONSTRUCTION.

CONTROL LINE GEOMETRY						
SEGMENT	STATION (START)	STATION (END)	NORTHING (START)	EASTING (START)	NORTHING (END)	EASTING (END)
L1	1+000.000	1+480.486	5534774.228	634629.959	5535209.220	634834.040
L2	1+480.486	1+939.338	5535209.220	634834.040	5535624.957	635028.225
L3	1+939.338	2+136.051	5535624.957	635028.225	5535803.179	635111.489
C1	2+136.051	2+312.601	5535803.179	635111.489	5535955.724	635199.915
L4	2+312.601	2+388.229	5535955.724	635199.915	5536017.555	635243.463

CURVE DATA					
#	R.	Δc	Tc	L.	L.C.
C1	1000.000	10°06'56"	88.505	176.550	176.321

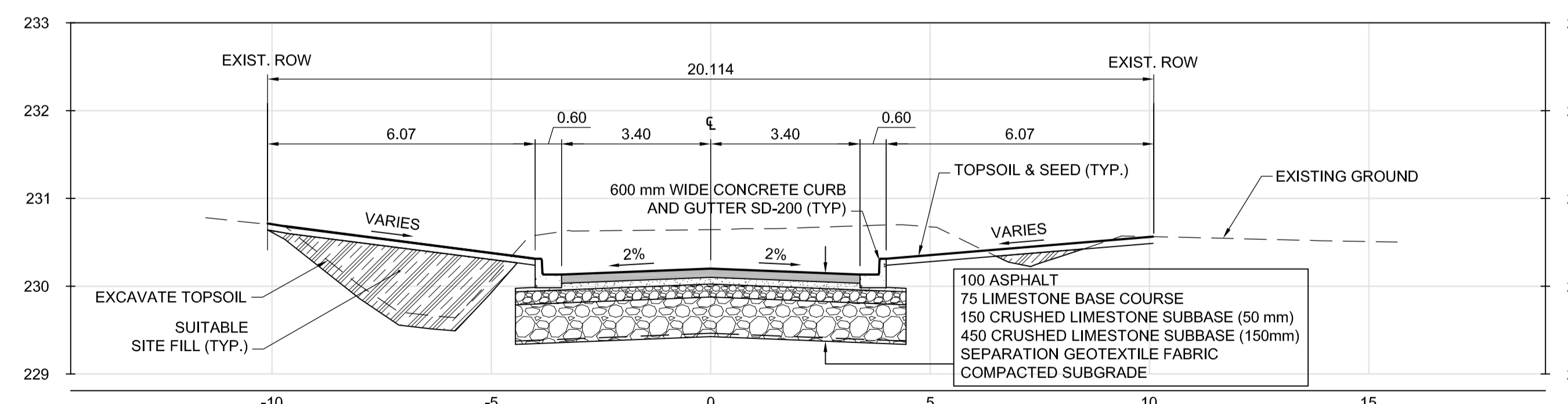

**A** FERRIER ST - STA: 1+140  
SCALE - H 1:100, V 1:50



EXISTING	LEGEND-PLAN	PROPOSED	EXISTING	LEGEND-PLAN	PROPOSED	EXISTING	LEGEND-PROFILE	PROPOSED
150 WM	WATERMAIN	150 WM	HYDRO	HYDRO	HYDRO	150 mm W.M.	WATERMAIN	150 mm W.M.
Hydrant	HYDRANT	Hydrant	MTS	M.T.S.	MTS	Hydrant	HYDRANT	Hydrant
Valve	VALVE	Valve	CONCRETE	CONCRETE	CONCRETE	Valve	VALVE	Valve
300 LDS	LAND DRAINAGE SEWER	300 LDS	ASPHALT	ASPHALT	ASPHALT	300 mm L.D.S.	LAND DRAINAGE SEWER	300 mm L.D.S.
250 WWS	WASTE WATER SEWER	250 WWS	PLANING	PLANING	PLANING	250 mm W.W.S.	WASTE WATER SEWER	250 mm W.W.S.
Manhole	MANHOLE	Manhole	SIDEWALK	SIDEWALK	SIDEWALK	Profile	PROFILE	Profile
Catch Basin	CATCH BASIN	Catch Basin	PAVING STONES	PAVING STONES	PAVING STONES	North/West Gutter	NORTH/WEST GUTTER	North/West Gutter
Curb Inlet	CURB INLET	Curb Inlet	PARTIAL DEPTH REPAIR	PARTIAL DEPTH REPAIR	PARTIAL DEPTH REPAIR	South/East Gutter	SOUTH/EAST GUTTER	South/East Gutter
Junctions	JUNCTIONS	Junctions	PROPERTY LINE	PROPERTY LINE	PROPERTY LINE	North/West P/L	NORTH/WEST P/L	North/West P/L
Culvert	CULVERT	Culvert	SURVEY BAR	SURVEY BAR	SURVEY BAR	South/East P/L	SOUTH/EAST P/L	South/East P/L
100 GAS	GAS	100 GAS	CURB RAMP	CURB RAMP	CURB RAMP	Drainage Arrow	DRAINAGE ARROW	Drainage Arrow

UNDERGROUND STRUCTURES				B.M. ELEV.	
SUPV. U/G STRUCTURES COMMITTEE	DATE	DESIGNED BY	RTP	DATE	BY
		DRAWN BY	TJH		
		CHECKED BY	ORIGINAL SIGNED BY TARAN J. PETERS		
		APPROVED BY	ORIGINAL SIGNED BY DAVID P. KRAHN		
		HOR. SCALE	1:500		
		VERTICAL	1:25		
		RELEASED FOR CONSTRUCTION	ORIGINAL SIGNED BY BRENT KELLET, C.E.T.		
		DATE	03/11/2011		
		CONSULTANT PROJECT NUMBER	09-2696		
		NO. REVISIONS			
		DATE			

**THE CITY OF WINNIPEG PUBLIC WORKS DEPARTMENT**

2011 GRANULAR ROADWAY IMPROVEMENTS  
FERRIER STREET  
TEMPLETON AVENUE TO MURRAY AVENUE

PLAN-PROFILE - FERRIER ST - STA. 1+000 TO 1+310

CITY DRAWING NUMBER: -  
SHEET: 02 OF 06  
CONSULTANT DRAWING NUMBER: -

G:\CAD\092696\Contract\Current\Plan-Profile-Section.dwg