

WATER SERVICE INFORMATION					
ADDRESS	SIZE(mm) & TYPE (STREET)	SIZE(mm) & TYPE (PROP.)	SHORT & LONG MEASUREMENT	CORP. LOCATION	REMARKS
533 ST ANNE'S ST	-	20	5.65 SNL BLDG	-	-
COMMERCIAL	-	COPPER	93.02>NNL BISHOP GRANDIN	-	-
533 ST ANNE'S ST	-	12	15.42 NSL BLDG	-	-
COMMERCIAL	-	COPPER	77.49>NNL BISHOP GRANDIN	-	-
534 ST ANNE'S ST	38	38	9.48 SNL BLDG	0.4 N OF S/C	-
COMMERCIAL	COPPER	COPPER	25.04 SSL ROSE	-	-
537 ST ANNE'S ST	150	150	7.49 SN LOTLINE	-	-
COMMERCIAL	-	-	17.14 SSL ROSE	-	OPP VALVE
539 ST ANNE'S ST	-	20	2.14 SSL HSE	-	-
RESIDENTIAL	-	COPPER	2.35>NNL BISHOP GRANDIN	-	-

* SERVICES TO BE RENEWED TO R UPON CONFIRMATION BY THE CONTRACTOR OF EXISTING LEAD SERVICE.

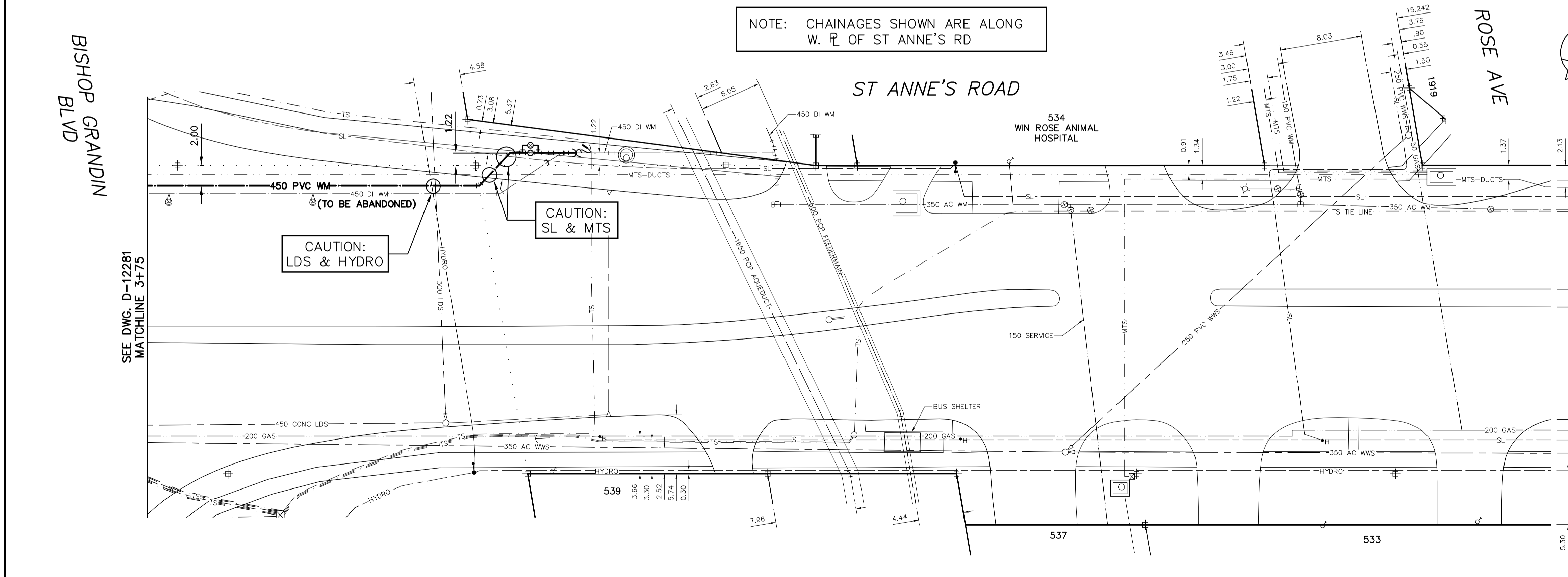

CONSTRUCTION NOTES

1. EXPOSE EXISTING WATERMAIN & CONFIRM INVERTS PRIOR TO CONSTRUCTION.
2. LOCATION OF ALL SERVICES TO BE CONFIRMED IN THE FIELD.
3. INSTALL WATERMAIN BY TRENCHLESS METHODS.
4. TRENCHES AND EXCAVATIONS WITHIN 1 METRE OF A PAVED AREA INCLUDING SIDEWALKS SHALL BE CLASS 3 BACKFILL.
5. ALL MATERIALS SHALL CONFORM TO THE CITY OF WINNIPEG STANDARD CONSTRUCTION SPECIFICATIONS.
6. MINIMUM COVER TO TOP OF WATERMAIN SHALL BE 2.4 m.
7. REPLACE ALL EXISTING LEAD SERVICES FROM PROPOSED WATERMAIN TO R.
8. NOTIFY ALL AFFECTED RESIDENTS AND BUSINESSES 24 HOURS IN ADVANCE OF ANY WATER SHUTDOWNS OR DISRUPTION OF SERVICE.

WARNING

IF POWER EQUIPMENT OR EXPLOSIVES ARE TO BE USED FOR EXCAVATION ON THIS PROJECT THE CONTRACTOR MUST:

- 1) NOTIFY THE GAS COMPANY OF THE PROPOSED LOCATION OF EXCAVATION.
- 2) TAKE PRECAUTION TO AVOID DAMAGE TO GAS COMPANY INSTALLATIONS.

SEE PROVINCIAL REGULATION 210/72 FOR DETAILS

EXISTING	LEGEND-PLAN	PROPOSED	EXISTING	LEGEND-PLAN	PROPOSED	EXISTING	LEGEND-PROFILE	PROPOSED
200 WM	WATERMAIN	200 WM	SL, HYDRO	150 WM	WATERMAIN	150 WM	WATERMAIN	150 WM
525 LDS	LAND DRAINAGE SEWER	525 LDS	MTS	300 LDS	LAND DRAINAGE SEWER	300 LDS	HYDRANT	300 LDS
375 WWS	WASTEWATER SEWER	375 WWS	TRAFFIC SIGNALS	250 WWS	WASTEWATER SEWER	250 WWS	VALVE	250 WWS
50 GAS	50 GAS	50 GAS	GAS	50 GAS	50 GAS	50 GAS	GROUND ABOVE PIPE	50 GAS
200 GAS	200 GAS	200 GAS	SURVEY BAR	200 GAS	200 GAS	200 GAS	DITCH (NORTH & WEST)	200 GAS
350 AC WWS	350 AC WWS	350 AC WWS	FENCE	350 AC WWS	350 AC WWS	350 AC WWS	DITCH (SOUTH & EAST)	350 AC WWS
450 DI WM	450 DI WM	450 DI WM	POLE - HYDRO, MTS	450 DI WM	450 DI WM	450 DI WM	GUY ANCHOR	450 DI WM
450 PVC WM	450 PVC WM	450 PVC WM	CURB STOP	450 PVC WM	450 PVC WM	450 PVC WM	GUTTER (NORTH & WEST)	450 PVC WM
450 CONC LDS	450 CONC LDS	450 CONC LDS	REDUCER	450 CONC LDS	450 CONC LDS	450 CONC LDS	GUTTER (SOUTH & EAST)	450 CONC LDS
MANHOLE	MANHOLE	MANHOLE	COUPLER	MANHOLE	MANHOLE	MANHOLE	ANODE	MANHOLE
CATCH BASIN	CATCH BASIN	CATCH BASIN	ANODE	CATCH BASIN	CATCH BASIN	CATCH BASIN	LEGEND-PLAN	LEGEND-PLAN
CURB INLET	CURB INLET	CURB INLET	LEGEND-PLAN	CURB INLET	CURB INLET	CURB INLET	PROPOSED	PROPOSED
REDUCER	REDUCER	REDUCER	PROPOSED	REDUCER	REDUCER	REDUCER	PROPOSED	PROPOSED
COUPLER	COUPLER	COUPLER	PROPOSED	COUPLER	COUPLER	COUPLER	PROPOSED	PROPOSED
ANODE	ANODE	ANODE	PROPOSED	ANODE	ANODE	ANODE	PROPOSED	PROPOSED
LEGEND-PLAN	LEGEND-PLAN	LEGEND-PLAN	PROPOSED	LEGEND-PLAN	LEGEND-PLAN	LEGEND-PLAN	PROPOSED	PROPOSED

NO.	REVISIONS	DATE	BY

CITY OF WINNIPEG
WATER AND WASTE
ENGINEERING DIVISION

DESIGNED BY: RC
 CHECKED BY: SC
 DRAWN BY: CJH
 APPROVED BY: SC
 HOR. SCALE: 1:250
 VERTICAL: 1:50
 DATE: 2011 02 11
 RELEASED FOR CONSTRUCTION: KAS ZUREK
 DATE: 03-03-11

ENGINEER'S SEAL
 ORIGINAL SIGNED BY
 R.W. CARROLL
 02-14-11

THE CITY OF WINNIPEG
 WATER AND WASTE DEPARTMENT

2011 WATERMAIN RENEWALS
 CONTRACT 7
 ST ANNE'S ROAD
 BISHOP GRANDIN BOULEVARD TO
 ROSE AVENUE

SHEET 5 OF 6
 CITY DRAWING NUMBER
 D-12282