



Existing Evergreen Tree (Typ.)

Existing Peastone Safety Surfacing To Be Excavated & Legally Disposed

Existing Timber Edging To Be Removed (By Others)

Existing Play Structure To Be Removed (By Others)

Existing 1-Bay, 3 Seat (2 Baby, 1 Belt) Wooden-Framed Swingset To Be Removed (By Others)

Existing Bench (Typ.) To Be Removed (By Others)

Existing W.R. To Be Removed (By Others)

Sod
F.H.

F.H.

Existing Tree (Typ.)

C.B.

L.S.

Existing Sandbox To Remain

Existing Bench To Be Removed (By Others)

L.S.

C.B.

DR

WATER MAIN

SEWER MAIN

SANDPIPER DRIVE PARK

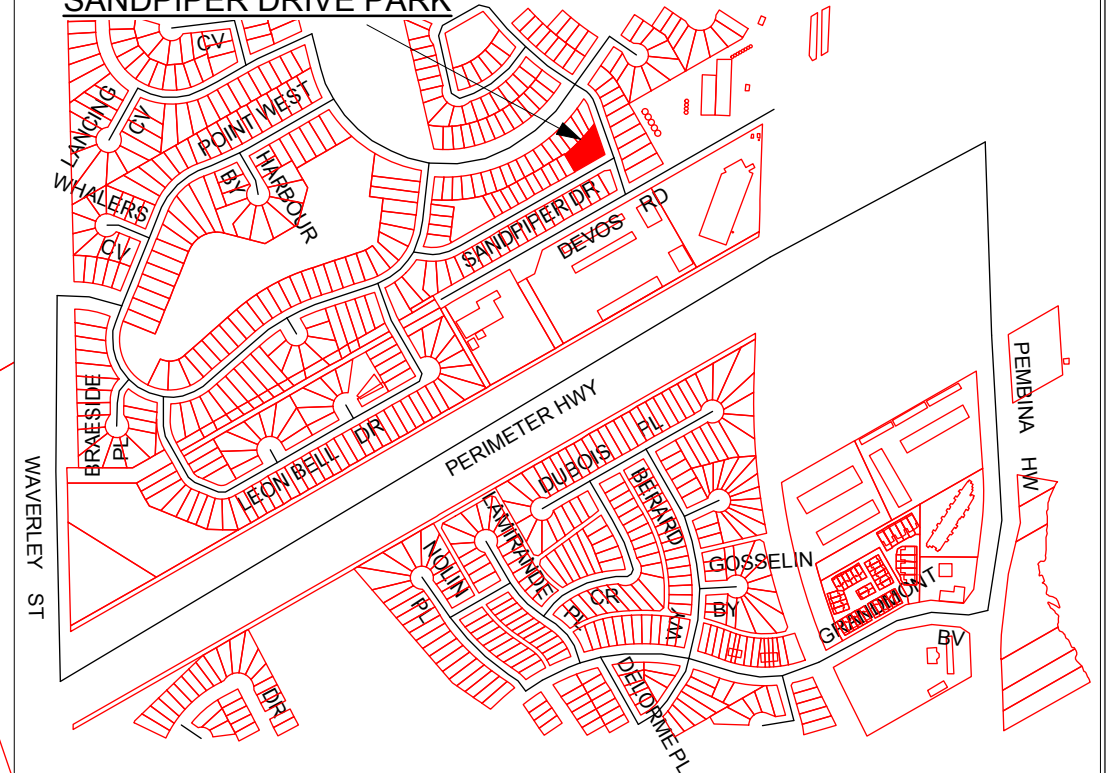

SITE LOCATION MAP
SCALE : 1:10,000

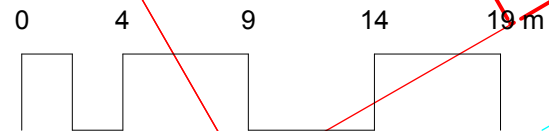

CONTRACTOR TO CONFIRM ALL DIMENSIONS AND REPORT ANY DISCREPANCIES TO CONTRACT ADMINISTRATOR PRIOR TO CONSTRUCTION. LOCATION OF UNDERGROUND STRUCTURES AS SHOWN ARE BASED ON THE BEST INFORMATION AVAILABLE BUT NO GUARANTEE IS GIVEN THAT ALL EXISTING UTILITIES ARE SHOWN OR THAT THE GIVEN LOCATIONS ARE EXACT. CONFIRMATION OF EXISTENCE AND EXACT LOCATION OF ALL SERVICES MUST BE OBTAINED FROM THE INDIVIDUAL UTILITIES BEFORE PROCEEDING WITH CONSTRUCTION.



THE CITY OF WINNIPEG
Planning, Property and Development Department
Planning and Land Use Division
Unit 15 - 30 Fort Street, Winnipeg, MB, (R3C 4X5)

DESIGNED BY

CHECKED BY

DRAWN BY

HF

APPROVED BY

MANAGER,
PARK AND OPEN SPACES

DATE

HORIZ. SCALE

1:300

VERT. SCALE

DATE

FEB/11

MANAGER,
PLANNING AND LAND USE DIVISION

DATE

DRAWING TITLE

SANDPIPER PARK

PLAYGROUND REDEVELOPMENT

EXISTING SITE CONDITIONS & REMOVALS

SITE ADDRESS

Sandpiper Drive

DRAWING NO.

S.74-B

BID OPPORTUNITY NO.

143-2011