

ASSINIBOINE RIVER

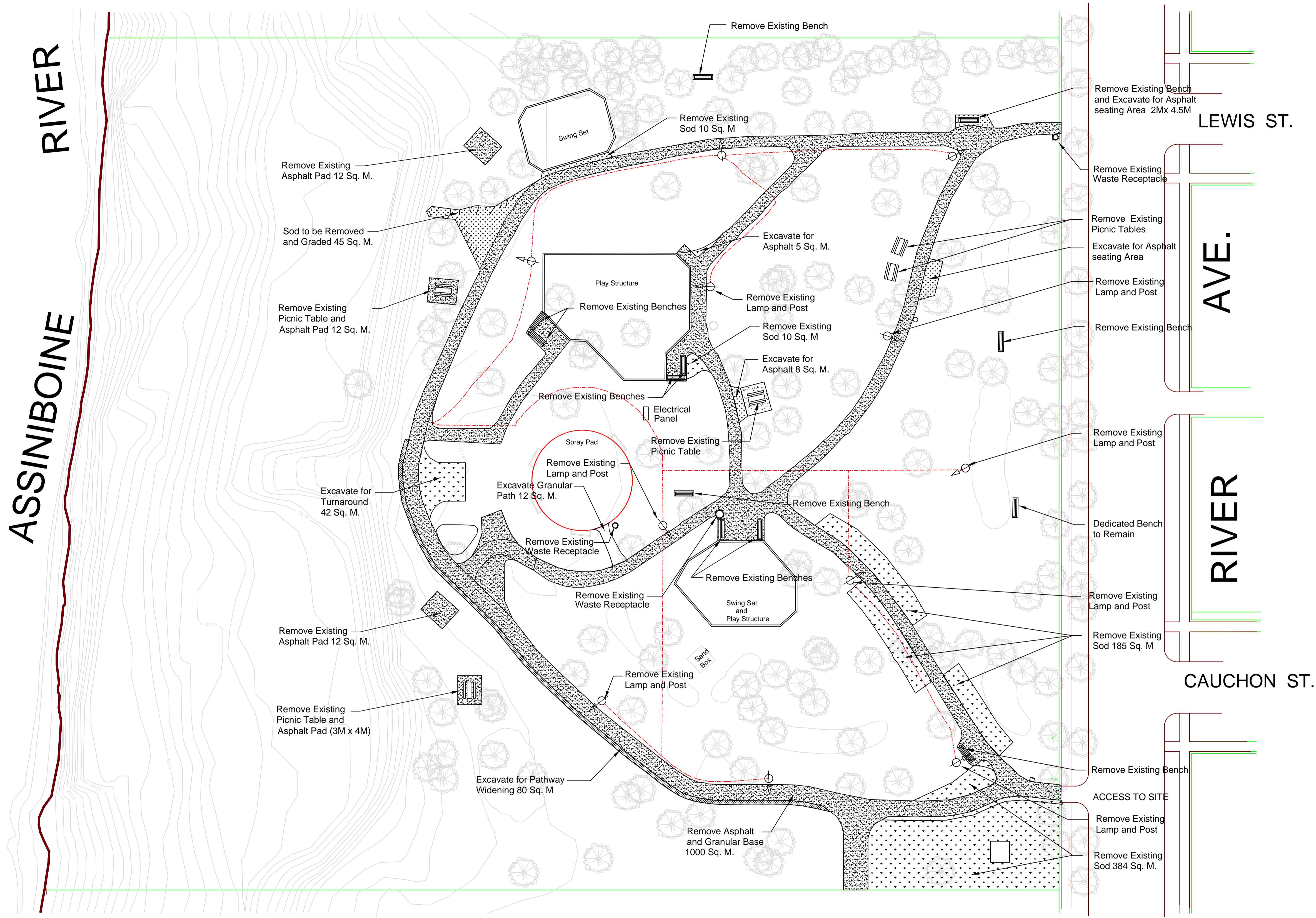

METRIC
WHOLE NUMBERS INDICATE MILLIMETRES
DECIMALIZED NUMBERS INDICATE METRES

WARNING

IF POWER EQUIPMENT OR EXPLOSIVES ARE TO BE USED FOR EXCAVATION ON THIS PROJECT THE CONTRACTOR MUST:
1) NOTIFY THE GAS COMPANY OF THE PROPOSED LOCATION OF EXCAVATION.
2) TAKE PRECAUTION TO AVOID DAMAGE TO GAS COMPANY INSTALLATIONS.
SEE PROVINCIAL REGULATION 210/72 FOR DETAILS

200 WM	WATERMAIN	200 WM	SL, HYDRD	150 WM	WATERMAIN	150 WM
⊕	HYDRANT	⊕	MTS	+	HYDRANT	+
⊗	VALVE	⊗	TRAFFIC SIGNALS	X	VALVE	X
525 LDS	LAND DRAINAGE SEWER	525 LDS	GAS	300 LDS	LAND DRAINAGE SEWER	300 LDS
375 WWS	WASTEWATER SEWER	375 WWS	SURVEY BAR	250 WWS	WASTEWATER SEWER	250 WWS
○	MANHOLE	●	POLE TOP LUMINARES	X	TOP OF ASPHALT	○○○○○
□	CATCH BASIN	⊙	EXIST. POLE TOP LUMINARES		TOP OF LIMESTONE BASE	
▽	CURB INLET	▶	PROP. POLE & LUMINARE			
△	REDUCER	▶	PROP. BASE, POLE & LUMINARE			
X	COUPLER	X	BURIED LIGHT CABLE			
⊕	ANODE	⊕	TREE			
EXISTING	LEGEND-PLAN	PROPOSED	EXISTING	LEGEND-PLAN	PROPOSED	EXISTING

LOCATION APPROVED		B.M. ELEV.	FIELD BOOK #
UNDERGROUND STRUCTURES		POSTED TO LBIS	
SUPV. U/G STRUCTURES COMMITTEE	DATE		
NOTE: LOCATION OF UNDERGROUND STRUCTURES AS SHOWN ARE BASED ON THE BEST INFORMATION AVAILABLE BUT NO GUARANTEE IS GIVEN THAT ALL EXISTING UTILITIES ARE SHOWN OR THAT THE GIVEN LOCATIONS ARE EXACT. CONFIRMATION OF EXISTENCE AND EXACT LOCATION OF ALL SERVICES MUST BE OBTAINED FROM THE INDIVIDUAL UTILITIES BEFORE PROCEEDING WITH CONSTRUCTION.			
NO.	REVISIONS	DATE	BY

CITY OF WINNIPEG PARKS WATERWAYS AND COMMUNITY INITIATIVES			
DESIGNED BY	TB	CHECKED BY	RZ
DRAWN BY	TB	APPROVED BY	RZ
HOR. SCALE	1:300	RELEASED FOR CONSTRUCTION	
VERTICAL		DATE	MAY 20, 2011

LANDSCAPE ARCHITECT'S/
ENGINEER'S SEAL

THE CITY OF WINNIPEG
Planning, Property and Development Depart.
Parks, Waterways and Community Initiatives
Unit 15-30 Fort Street

Winnipeg

FORT ROUGE PARK
EXISTING CONDITIONS
AND REMOVALS

SHEET 1 OF 3
CITY DRAWING NUMBER
F.5-E

BID OPPORTUNITY
FILENAME
PLOT DATE