

WARNING
 IF POWER EQUIPMENT OR EXPLOSIVES ARE TO BE USED FOR EXCAVATION ON THIS PROJECT THE CONTRACTOR MUST:
 1) OBTAIN CLEARANCE FROM THE GAS UTILITY PRIOR TO EXCAVATION.
 2) TAKE PRECAUTION TO AVOID DAMAGE TO GAS UTILITY INSTALLATIONS.
 SEE PROVINCIAL REGULATION 210/72 FOR DETAILS

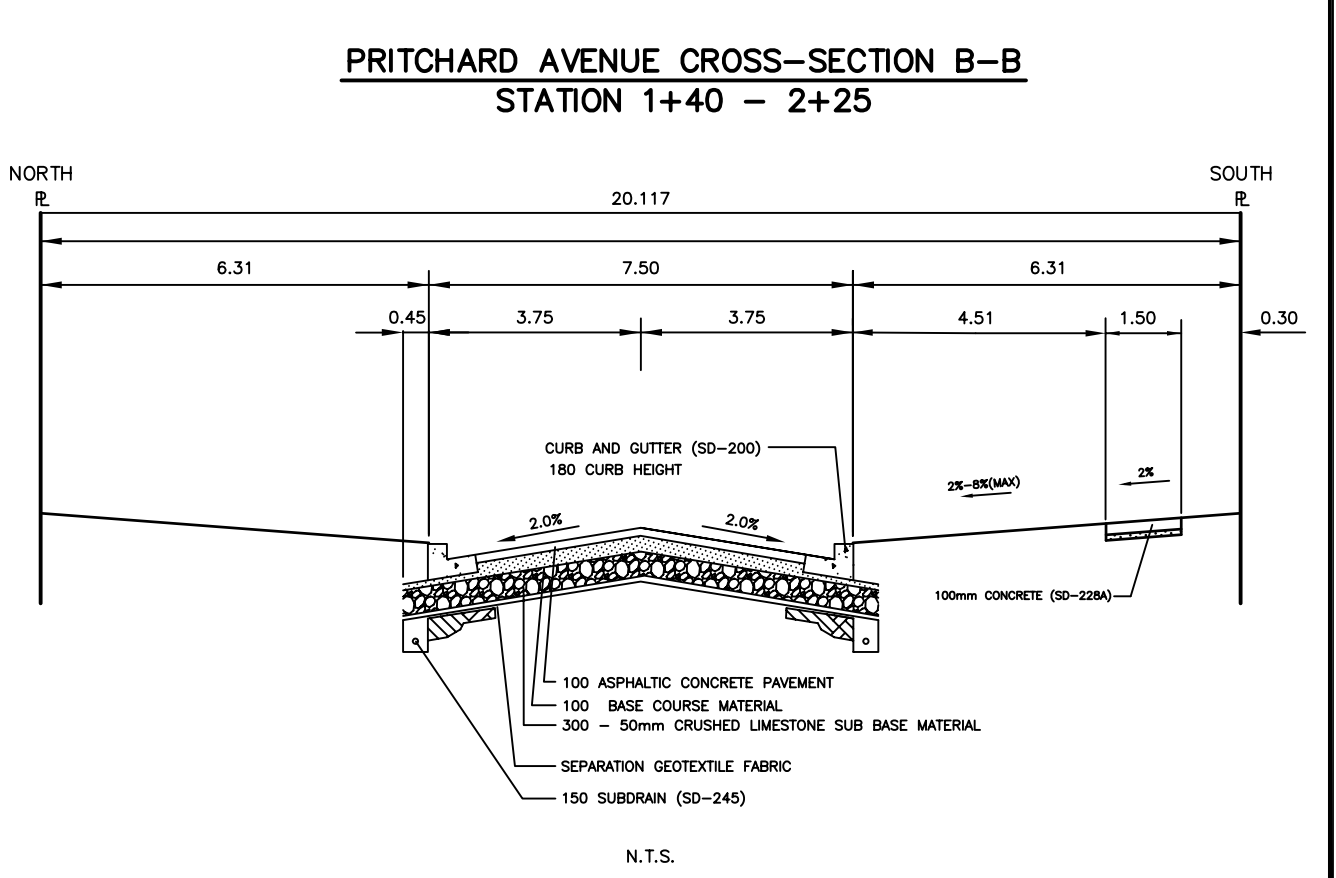
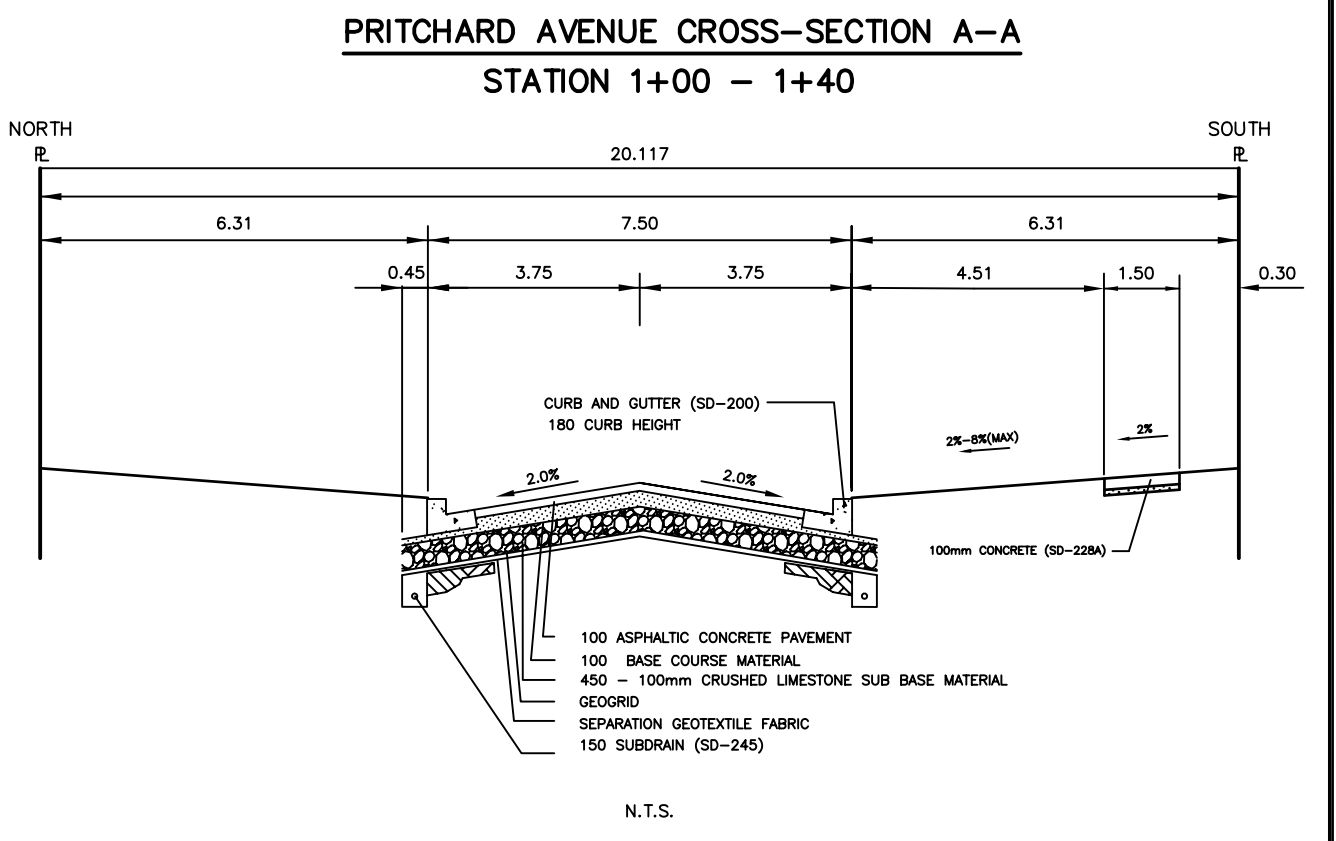
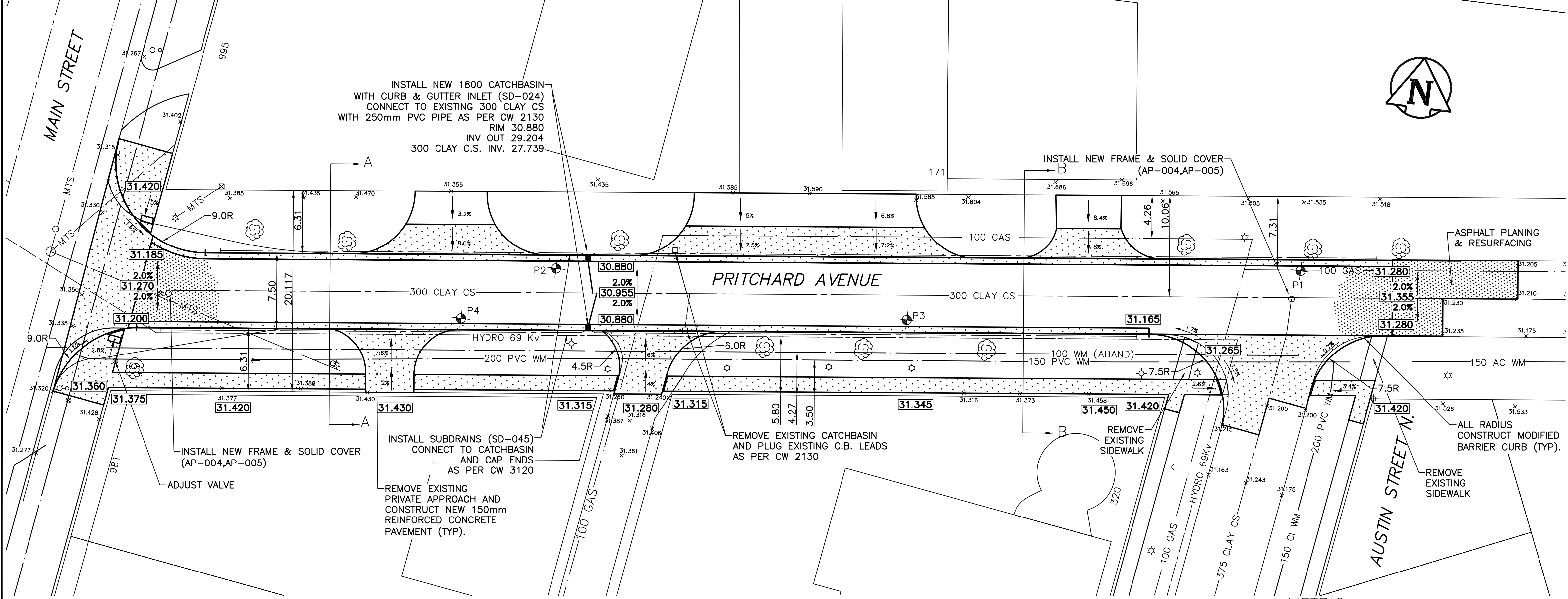

BID OPPORTUNITY NO. 21-2011

HYDRANT	VALVE	CURB STOP	CONCRETE	O.L.S.	MANHOLE	CATCH BASIN	HYDRO POLE	TRAFFIC SIGNAL POLE	TEST HOLE LOCATION	TACTILE WARNING SURFACE	EXISTING	LEGEND - PLAN	PROPOSED	EXISTING	LEGEND - PLAN	PROPOSED	EXISTING	LEGEND - PROFILE	PROPOSED
---	---	---	---	---	---	---	---	---	---	---	---	---	---	---	---	---	---	---	---
---	---	---	---	---	---	---	---	---	---	---	---	---	---	---	---	---	---	---	---
---	---	---	---	---	---	---	---	---	---	---	---	---	---	---	---	---	---	---	---

LOCATION APPROVED UNDERGROUND STRUCTURES

DATE

NOTE:
 LOCATION OF UNDERGROUND STRUCTURES AS SHOWN ARE BASED ON THE BEST INFORMATION AVAILABLE. BUT NO GUARANTEE IS GIVEN THAT ALL EXISTING UTILITIES ARE SHOWN OR THAT THE GIVEN LOCATIONS ARE EXACT. CONFIRMATION OF EXISTENCE AND EXACT LOCATION OF ALL SERVICES MUST BE OBTAINED FROM THE INDIVIDUAL UTILITIES BEFORE PROCEEDING WITH CONSTRUCTION.

B.M. ELEV.	GBM 26-013	230.979	
NO.	ISSUED FOR CONSTRUCTION	MAR 21	B.K.
NO.	REVISIONS	DATE	BY

**ENGINEERING DIVISION
 TECHNOLOGY SERVICES BRANCH
 106 - 1155 PACIFIC AVE**

DESIGNED BY: D.T./C.T.
 CHECKED BY: C.T.
 DRAWN BY: D.T./J.C.
 APPROVED BY: S.P.

HOR. SCALE: 1 : 250
 VERTICAL: 1 : 10

DATE: 2011/03/21

ENGINEER'S SEAL
 PROVINCE OF MANITOBA
B.S. KIBBINS
 Member
 24334
 REGISTERED PROFESSIONAL ENGINEER

ORIGINAL SIGNED MARCH 21, 2011

THE CITY OF WINNIPEG
 PUBLIC WORKS DEPARTMENT

PRITCHARD AVENUE
 FROM MAIN STREET TO AUSTIN STREET NORTH
 ASPHALT PAVEMENT RECONSTRUCTION AND ASSOCIATED WORKS
 FROM STA. 1+00 TO STA. 2+25

CITY DRAWING NUMBER: SE-11-04
 SHEET 4 OF 4
 4