

KEY NOTES

- 1 EXISTING EMERGENCY EYEWASH STATION AREA FLOOR DRAIN TO BE REMOVED; CAP EXISTING 75# SAN. DRAIN UNDER FLOOR CLOSE TO MAIN. PATCH FLOOR TO MATCH NEW FLOOR FINISH BY G.C.
- 2 EXISTING FLOOR DRAINS TO BE REPLACED & RECONNECTED TO EXISTING SANITARY DRAIN.
- 3 EXISTING SERVICE SINK FLOOR DRAIN TO BE REMOVED UP TO MAIN TRUNK; CAP STUB; CONCRETE FLOOR CURB REMOVED BY GENERAL CONTRACTOR. PATCH FLOOR TO MATCH NEW FLOOR FINISH BY G.C.
- 4 EXISTING WATER FILTER UNIT DRAIN LINE, LOCATED ABOVE FLOOR, TO BE REMOVED.
- 5 REMOVE EXISTING EYE WASH STATION; DISCONNECT DOW SUPPLY AND CAP BELOW FLOOR; PATCH CORED HOLE.
- 6 REMOVE EXISTING 13# COMPRESSED AIR & 13# VACUUM SERVICE; PATCH IN CORED HOLES; CAP BELOW FLOOR.
- 7 REMOVE EXPOSED 25# DOW LINE TO FILTERS; TERMINATE LINE BELOW FLOOR C/W ICAP.
- 8 REMOVE EXISTING DOMESTIC HOT WATER STORAGE TANK AND ALL ASSOCIATED PIPING.
- 9 REMOVE EXISTING 25# DOW LINE, C/W BACKFLOW PREVENTER TO FILTERS; VALVE AND CAP BELOW FLOOR; PATCH HOLE.
- 10 REMOVE 13# DHW & 13# DOW WASH STATION LINES, FITTINGS AND VALVES (RISERS THRU DEMOLISHED WALL) CAP AND VALVE BELOW FLOOR; REMOVE ALL PIPING ABOVE FLOOR; PATCH ALL FLOOR CORED HOLES.
- 11 REMOVE 13# DHW & 13# DOW, 13# DI; RISERS WITHIN DEMOLISHED WALL, STATIONS ON BOTH SIDES OF WALL; REMOVE ALL PIPING, FITTINGS AND VALVES ABOVE FLOOR; PATCH CORED HOLES; TERMINATE LINES WITH CAPS BELOW FLOOR.
- 12 REMOVE 32# TEMPERED DW 32# WASTE RISERS TO EXISTING SHOWER/EYEWASH STATION; FILL CORED OPENINGS, TERMINATE LINES BELOW FLOOR C/W END CAPS.
- 13 REMOVE EXISTING HUMIDIFIER & TURN OVER TO CITY; REMOVE EXISTING 13# DOW SUPPLY, ABOVE FLOOR; PATCH CORED OPENING; CAP LINE BELOW FLOOR C/W VALVE.
- 14 REMOVE EXISTING 20# HUMIDIFIER DRAIN LINE BACK TO MAIN DRAIN TRUNK; CAP END OF LINE; PATCH CORED OPENING.

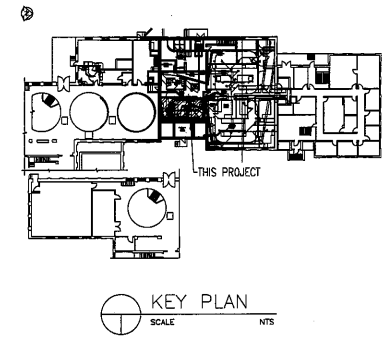

GENERAL NOTES

1. PERFORM ALL WORK IN ACCORDANCE WITH ALL APPLICABLE CODES, STANDARDS AND CITY INSPECTIONS REQUIREMENTS.
2. COORDINATE WORKS WITH OTHER SUB-TRADES. REFER TO SPECIFIC DETAILS FOR CUTTING AND SEALING PENETRATIONS THROUGH OPENINGS & FIRE SEPARATIONS.
3. REFER TO TECHNICAL SPECIFICATIONS FOR EQUIPMENT AND MATERIAL SPECIFICATIONS AND INSTALLATION AND CONSTRUCTION REQUIREMENTS.
4. INSULATE PLUMBING PIPES AND DUCTWORK WHERE INDICATED AND AS SPECIFIED.
5. SUPPORT ALL PLUMBING LINES AND DUCTWORK TO MEET CODE REQUIREMENTS & ESTABLISHED INDUSTRY TRADE PRACTICES, (SMACNA, ASHRAE).
6. INVESTIGATE SITE PRIOR TO CONSTRUCTION TO CONFIRM ALL DIMENSIONS AND INSTALLATION REQ'S.
7. PERFORM ALL CUTTING & PATCHING NECESSARY FOR ANY REQUIRED OPENINGS THRU WALLS, ROOF AND FLOOR.
8. PROVIDE TAB TO ENSURE AIR DISTRIBUTION TO VOLUMES INDICATED.
9. NOT ALL EQUIPMENT/PIPING, ETC. IS SHOWN.
10. PROVIDE FIRE STOPS AT ALL FIRE RATED WALLS/FLOOR OPENINGS TO MATCH EXISTING RATING.
11. DURING DEMOLITION PHASE, TERMINATE ALL LINES INDICATED FOR REMOVAL BELOW LAB FLOOR AND CAP. CONFIRM LINES WILL NOT INTERFERE WITH LINES BEING INSTALLED. PATCH IN CORED HOLES AND FINISH TO MATCH EXISTING FLOOR.

1 EXISTING WATER & LAB SERVICES ROOM EXISTING PLUMBING - DEMOLITION PLAN
SCALE 1:50

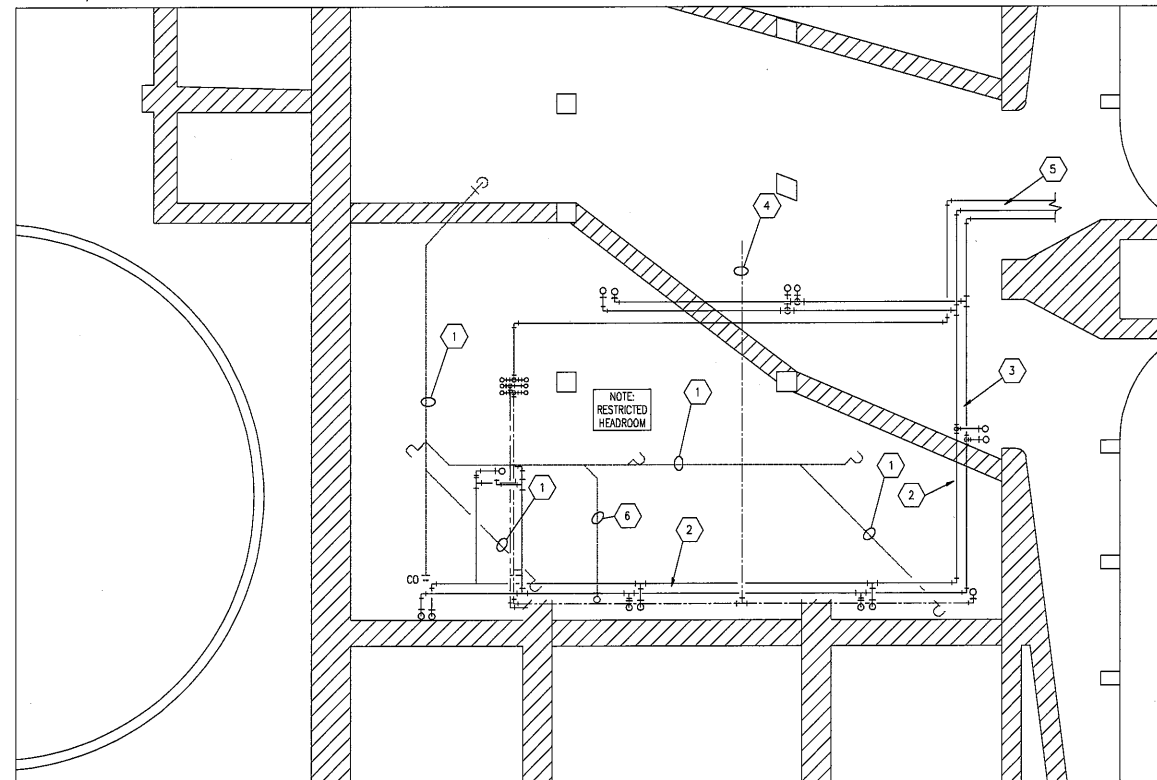

KEY NOTES

- 1 REMOVE EXISTING SAN. DRAIN & FITTINGS, SERVING EXISTING ROOMS 106 & 107 & CAP AT RISER.
- 2 EXISTING 19# COMPRESSED AIR HEADER TO REMAIN IN SERVICE; SEE EXISTING SERVICE LAB PLAN FOR ALL WORK RELATED TO REMOVAL OF CA LINES THRU FLOOR.
- 3 EXISTING 19# VACUUM HEADER TO REMAIN IN SERVICE; SEE SERVICE LAB PLAN FOR ALL WORK RELATED TO REMOVAL OF VACUUM LINES THRU FLOOR.
- 4 EXISTING 38# DOW LINE TO REMAIN IN SERVICE
- 5 EXISTING 19# DI LINE TO REMAIN IN SERVICE; SEE SERVICE LAB PLAN FOR ALL WORK RELATED TO REMOVAL OF DI LINES THRU FLOOR.
- 6 EXISTING UNTRAPPED UNUSED DRAIN LINE (UNDER REFRIGERATOR); REMOVE & PATCH FLOOR

2 EXISTING WATER & LAB SERVICES - BASEMENT EXISTING CONDITIONS & DEMOLITION
SCALE 1:50

ALLIANCE
Engineering Services Inc.

 Certificate of Authorization Alliance Engineering Services Inc. No.2906 Date: _____	B.M. ELEV.	FIELD BOOK #:	 LM Architectural Group 500-136 Market Ave Winnipeg, Manitoba, Canada R3B 0P4 t: (204) 942.0681 f: (204) 943.8676 www.lm-architects.com	DESIGNED BY	CHECKED BY	 CONSULTANT DRAWING NO. M1.1	 THE CITY OF WINNIPEG WATER AND WASTE DEPARTMENT NORTH END WATER POLLUTION CONTROL CENTRE - LAB RENOVATIONS SHEET 1 OF 1 CITY DRAWING NUMBER 1-0101M-H0001-001-01
	POSTED TO LBIS			DESIGNED BY	CHECKED BY		
				3 ISSUED FOR FINAL REVIEW	2011/08-20	AG	
				2 ISSUED FOR REVIEW	2011/08-06	AG	
				1 ISSUED FOR REVIEW	2011/08-20	AG	
				A ISSUED FOR CO-ORDINATION	2011/06-05	AG	
				NO. REVISIONS	DATE	BY	
				DESIGNED BY	AS	APPROVED BY	
				HOR. SCALE		RELEASED FOR CONSTRUCTION	
				VERTICAL		DATE	