

Existing Roof Construction







T&G cedar decking  
1 dry felt  
4 ply felt and asphalt  
gravel cover

Roof Construction (2010)

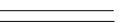
T&G cedar deck  
1/2" drywall  
torch grade 2.2 mm base sheet VB  
2% sloped type 2 EPS min 1"  
1" polyisocyanurate  
1/8" recovery board  
torch grade 180 gr base sheet  
torch grade 250 gr cap sheet

Note: insulation system is mechanically fastened

GRAPHIC LEGEND

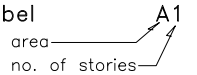
- Parapet 
- Gravel stop 
- Gas line 
- Control joint 
- Expansion joint 
- New insulated drain pipe 
- Photo vantage point 
- Area Label 

⊠ = attic vent    X = leak

KEYNOTE LEGEND

- 1 core sample
- 2 chimney
- 3 AC unit
- 4 vent hood
- 5 ventilator
- 6 vent pipe
- 7 roof drain
- 8 skylight
- 9 eavestrough
- 10 firewall
- 11 antenna
- 12 ladder
- 13 stub column
- 14 roof hatch
- 15 scupper
- 16 pitch box
- 17 HVAC unit
- 18 capped curb
- 19 flag pole
- 20 electrical mast
- 21 cooling tower
- 22 splash pad
- 23 splash pan
- 24 downspout/rainwater leader
- 25 back slope
- 26 cant
- 27 increase slope to drain
- 28 cricket
- 29 parapet/wide flashing
- 30 life line anchor

Note: Insulation saddles for scuppers is to be 4"-0"x4' and saddles behind skylight curbs is to be 2"-0"x2'.

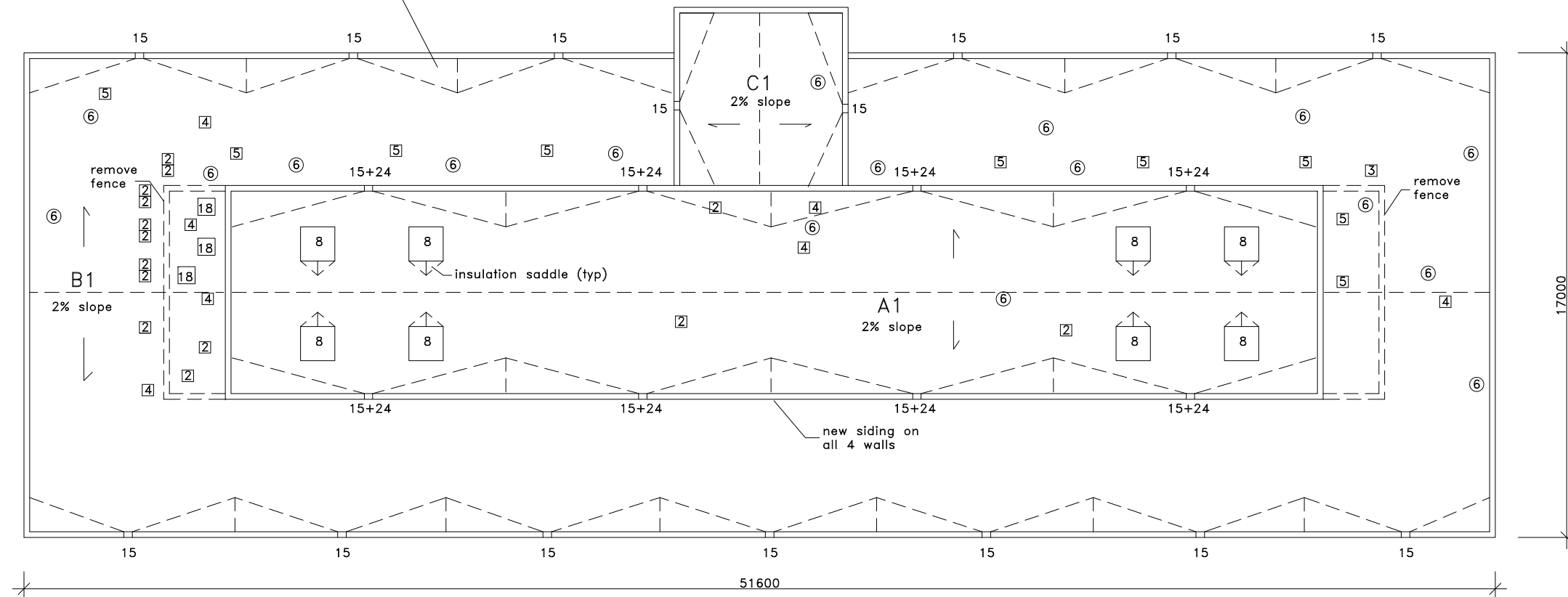

Note: Allow for the new siding band on the walls of area A1 is to extend to 8" above the top of the new roofing on areas C1 and B1. The siding on area B1 is to extend to the bottom of the overhang. On area C1 the siding is to also extend to the bottom of the overhang but to the top of the beams on the side walls. Final layout is to be confirmed on site with the Contract Administrator.

Approx. Area  
sq.m.  
A1 = 289  
B1 = 560  
C1 = 38  
D1 = 62

Notes:

- .01 Contractor is responsible for site verifications of all dimensions
- .02 Drawings are not to be scaled for estimating purposes
- .03 All areas given are approximate
- .04 Contractor is responsible for site verification of existing roof constructions

Stated scale is when in 11x17 format



AGASSIZ  
CONSULTING  
GROUP  
LTD.

809 Pipeline Road, Winnipeg, Manitoba  
Phone: 697-8091 Fax: 697-8039

Project: Kildonan Park Outdoor Pool  
2021 Main Street  
Winnipeg, MB

Date: August 30, 2010

Drawing No. R-1

File no: 3508-10 Scale: 1:200