

SITE PLAN - POOL SERVICES - ALTERATIONS
SCALE: 1/8"=1'-0"

DRAWING NOTES

- 1 EXISTING PUMP HOUSE TO REMAIN.
- 2 EXTENSION TO EXISTING PUMPHOUSE. REFER TO STRUCTURAL FOR REQUIREMENTS.
- 3 EXISTING WADING POOL DRAIN LINE TO REMAIN.
- 4 NEW WADING POOL DRAIN. RECONNECT TO EXISTING DRAIN LINE W/ 4" DRAIN LINES VIA NEW HEADER (4").
- 5 EXISTING WATER FEATURE TO REMAIN.
- 6 EXISTING 1 1/2" WATER FEATURE SUPPLY LINE TO REMAIN.
- 7 NOT USED (SPARE NOTE).
- 8 NEW 2" P.E. WATER FEATURE SUCTION LINE TO PUMP HOUSE. PUSH LINE UNDER EXISTING POOL.
- 9 EXISTING WADING POOL PUMP CIRCULATION LINE TO REMAIN.
- 10 EXISTING PORTION OF 3/4" WATER LINE TO WATER SLIDE TO REMAIN FROM SLIDE TO EDGE OF APRON.
- 11 NEW 1 1/4" P.E. WATER LINE FROM PUMP HOUSE TO WATER SLIDE. (CONNECT TO EXISTING 3/4" AT EDGE OF APRON) MARKED \rightarrow
- 12 BREAK OUT 8'-0" DIA. AREA IN CENTRE OF POOL. INSTALL NEW DRAINS/PIPING IN NEW DEAD LEVEL AREA 8'-0" IN DIAMETER. REFER TO STRUCTURAL.

- 13 THIS PORTION OF EXISTING WATER FEATURE SUPPLY LINE TO BE ABANDONED.
- 14 NEW 1 1/2" P.E. LINE FROM NEW PUMP TO CONNECT TO EXISTING WATER FEATURE LINE AT POINT MARKED \rightarrow
- 15 NEW 4" DRAINAGE HEADER CONNECTING THREE (3) MAIN POOL DRAINS, 4" MAIN DRAIN TO SEWER AND 4" PUMP SUCTION TO WATER FEATURE PUMP IN PUMP HOUSE.

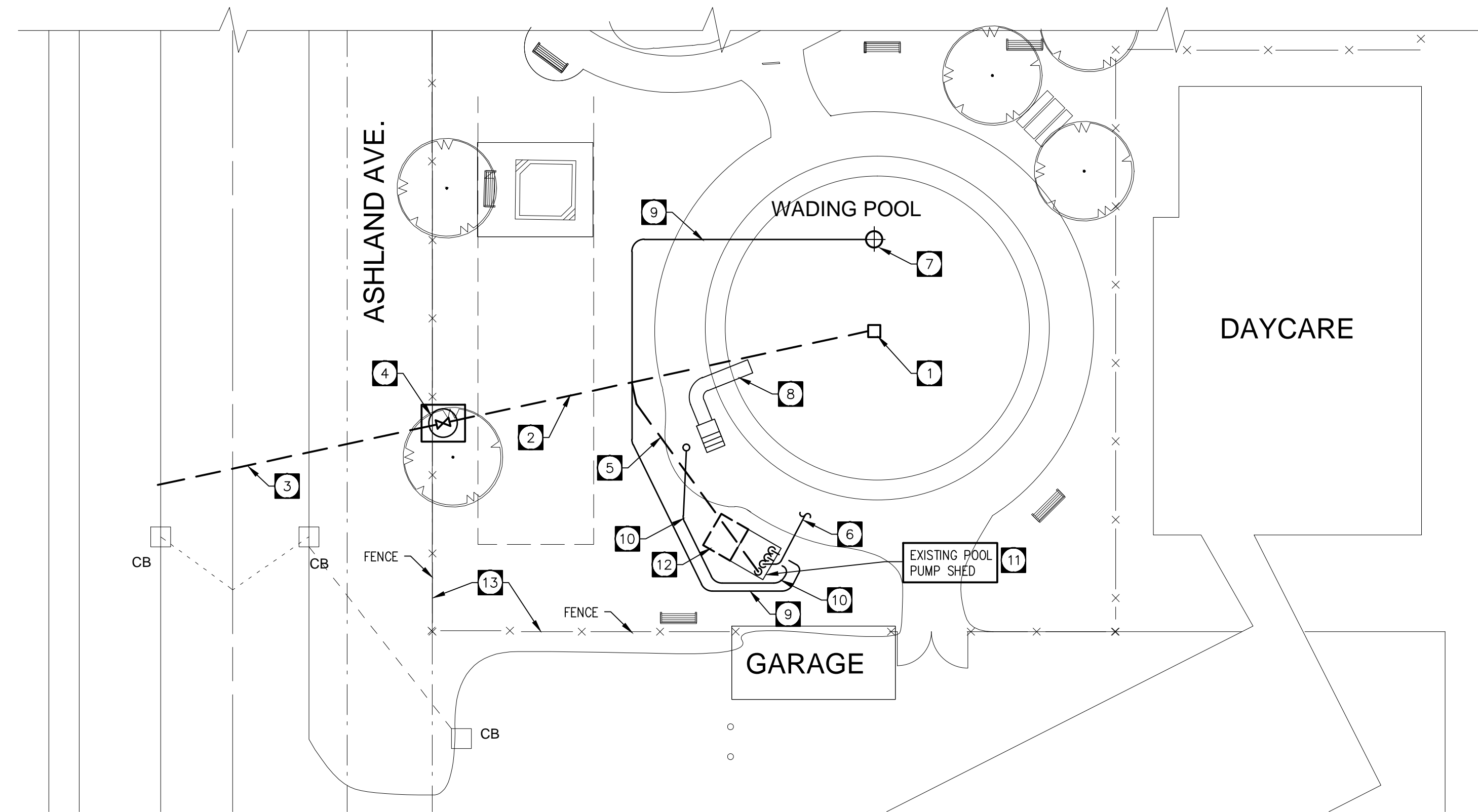

SITE PLAN - EXISTING WADING POOL SERVICES
SCALE: 1/16"=1'-0"

DRAWING NOTES

- 1 EXISTING WADING POOL DRAIN (12"x12") TO BE REMOVED.
- 2 EXISTING WADING POOL DRAIN LINE TO REMAIN.
- 3 EXISTING WADING POOL DRAIN TO STREET TO REMAIN.
- 4 EXISTING PIT AND POOL DRAIN VALVE TO REMAIN.
- 5 EXISTING WADING POOL CIRCULATION LINE TO PUMP HOUSE TO REMAIN.
- 6 EXISTING CIRCULATION LINE TO POOL TO REMAIN.
- 7 EXISTING WATER FEATURE TO REMAIN.
- 8 EXISTING WATER SLIDE TO REMAIN.
- 9 EXISTING CIRCULATION LINE TO WATER FEATURE (1 1/2") TO REMAIN.
- 10 EXISTING CIRCULATION LINE TO WATER SLIDE (3/4") TO BE ABANDONED IN PLACE TO EDGE OF APRON.
- 11 EXISTING PUMP HOUSE CONTAINING CIRCULATION PUMP/CHLORINATOR, CONTROLS, ETC. TO REMAIN.
- 12 PUMP HOUSE TO BE EXPANDED - SEE DWG. M-2.
- 13 EXISTING FENCE TO REMAIN.

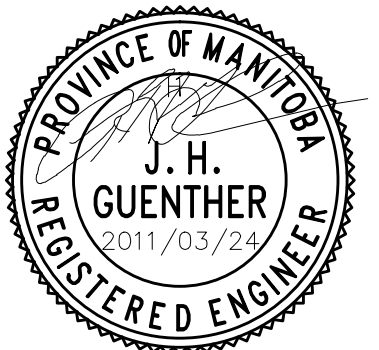

No.	REVISION	BY	DATE
0	ISSUED FOR TENDER	JHG	MAR.24/11

THE DRAWINGS ARE THE PROPERTY OF THE PLANNER AND MAY NOT BE REPRODUCED WITHOUT THEIR PERMISSION.
CONTRACTORS SHALL CHECK ALL DIMENSIONS AND INFORMATION AND REPORT ANY DISCREPANCIES PRIOR TO COMMENCEMENT OF WORK.

NOVA 3 ENGINEERING LTD.
CONSULTING ENGINEERS
201-120 FORT STREET TEL.: (204) 943-6142
WINNIPEG, MANITOBA FAX: (204) 942-1276
R3C 1C7 JN. 30206
THIS DRAWING IS THE EXCLUSIVE PROPERTY OF NOVA 3 ENGINEERING LTD. AND MAY ONLY BE REPRODUCED WITH THE WRITTEN PERMISSION OF NOVA 3 ENGINEERING LTD.
THE CONCEPT AND DESIGN INCORPORATED INTO THIS DRAWING ARE BASED ON INFORMATION PROVIDED BY THE CLIENT AND OTHER RELATED SOURCES. PROFESSIONAL ENGINEER ACCEPTS NO RESPONSIBILITY FOR DRAWING AND DESIGN UNLESS DRAWING IS ACCOMPANIED BY ORIGINAL SEALED AND SIGNED LETTER OF INTENT AND CERTIFICATE OF INSPECTION. REFER TO WINNIPEG.CA FOR CAUTIONARY NOTES.

PROJECT TITLE
**RIVERVIEW COMMUNITY CENTRE
UP-GRADE OF POOL SERVICES
60 ASHLAND AVE
WINNIPEG, MANITOBA**

DRAWING TITLE
**SITE PLAN - EXISTING
SITE PLAN - ALTERATIONS**

APPROVED	CHECKED	DRAWN BY
JHG	DMM	RB

SCALE	DATE	BID OP. NO.
AS SHOWN	MARCH 24, 2011	271-2011

DRAWING NUMBER	REVISION NUMBER
M-1	0