

CB TABLE - COMBINED SEWER

| DESCRIPTION | RIM ELEV. | INVERT |      |         |         |
|-------------|-----------|--------|------|---------|---------|
|             |           | EAST   | WEST | NORTH   | SOUTH   |
| CB 4        | 231.909   |        |      | 230.910 | 230.280 |
| CB 5        | 231.961   |        |      |         |         |

- REFERENCE NOTES**
- PAVEMENT DIMENSIONS ARE TO BACK OF CURB
  - BASELINE IS CENTRELINE OF RIGHT-OF-WAY
  - PROPERTY LINES OBTAINED FROM THE CITY OF WINNIPEG L.B.I.S., AND NO SCALE FACTOR WAS APPLIED
  - REFER TO AECOM FIELD BOOK NO. 4703

- CONSTRUCTION NOTES**
- REMOVE EXISTING PAVEMENT AND CONSTRUCT NEW 230mm PLAIN DOWELLED CONCRETE PAVEMENT
  - CONSTRUCT NEW 200mm PLAIN DOWELLED CONCRETE PAVEMENT
  - CONSTRUCT NEW 200mm REINFORCED CONCRETE PAVEMENT
  - CONSTRUCT NEW ASPHALTIC CONCRETE OVERLAY
  - REMOVE EXISTING DRAINAGE INLET
  - REMOVE EXISTING CATCHBASIN AND ABANDON EXISTING LEAD
  - ADJUST EXISTING CATCHBASIN/MANHOLE FRAME AND COVER
  - ADJUST EXISTING WATERMAIN VALVE BOX TO GRADE
  - INSTALL NEW 50mm CAST IRON RISER RING
  - INSTALL 150mm SUBDRAIN 12m ON EACH SIDE OF CATCHBASIN
  - ADJUST EXISTING CURB STOP TO GRADE
  - REMOVE EXISTING HYDRO POLE (BY OTHERS)
  - ADJUST EXISTING HYDRO MANHOLE (BY OTHERS)
  - INSTALL NEW CATCHBASIN (SD024) AND CONNECT NEW 250mm LEAD TO EXISTING 375 COMBINED SEWER
  - INSTALL NEW DETECTABLE SURFACE WARNING TILES
  - CONSTRUCT NEW MONOLITHIC CONCRETE MEDIAN
  - CONSTRUCT NEW MONOLITHIC SAFETY MEDIAN
  - PLANE EXISTING ASPHALTIC CONCRETE PAVEMENT AND CONSTRUCT NEW ASPHALTIC CONCRETE PAVEMENT
  - SUPPLY AND INSTALL NEW FRAME AND COVER (AP004/AP005)
  - REMOVE EXISTING STEEL POST / WOOD RAIL FENCE. SALVAGE EXISTING POSTS. REINSTALL EXISTING POSTS AND SUPPLY AND INSTALL NEW 150 x 150 WOOD RAILS. CORE HOLES THROUGH EXISTING ASPHALT AS REQUIRED. PATCH WITH NEW ASPHALT FOLLOWING INSTALLATION
  - CONSTRUCT NEW MODIFIED BARRIER CURB (180mm HT. INTEGRAL)
  - CONSTRUCT NEW MONOLITHIC BARRIER CURB (180mm HT.) AND 100mm CONCRETE SIDEWALK
  - REGRADE EXISTING BOULEVARD AND SEED WITH SALT TOLERANT SEED

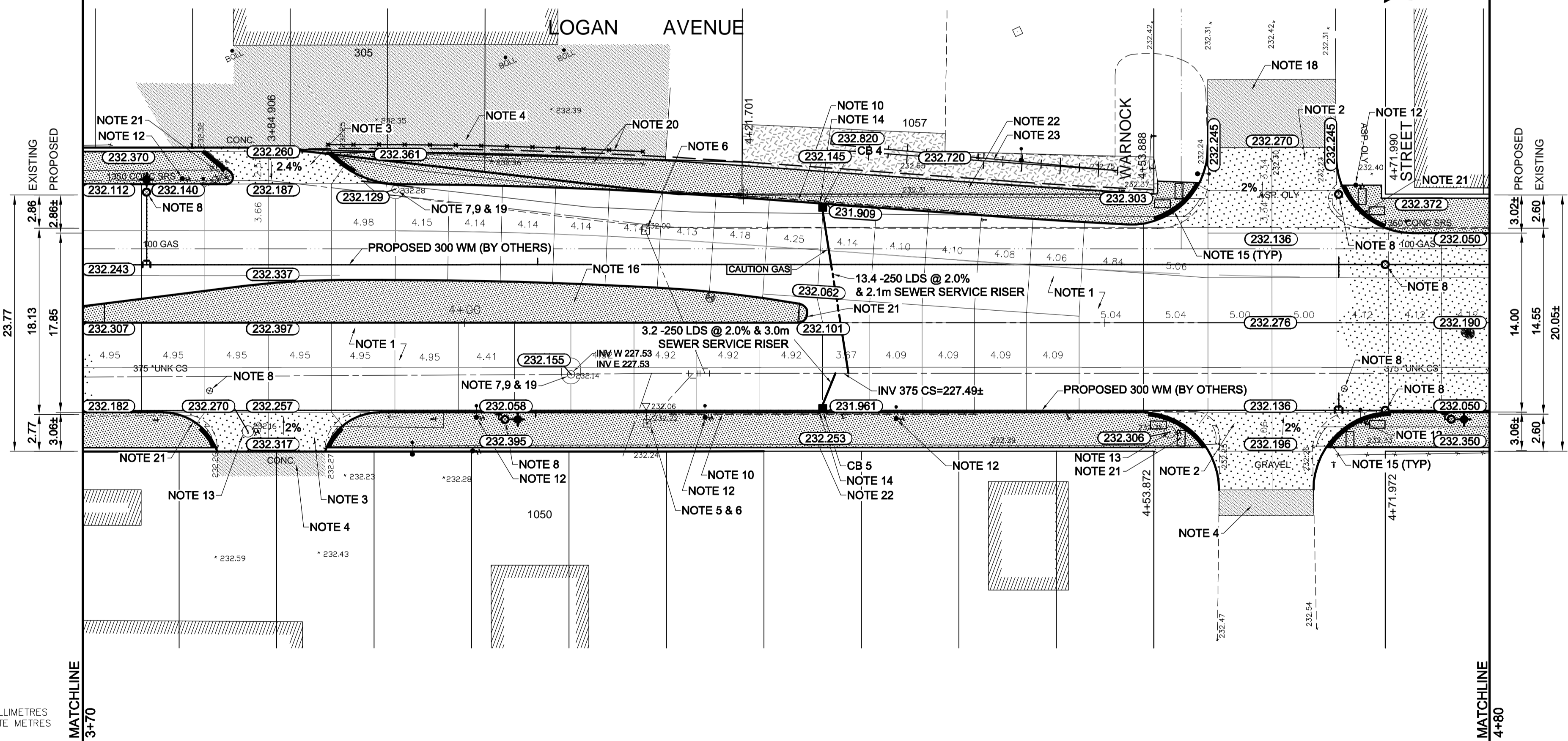

**METRIC**  
WHOLE NUMBERS INDICATE MILLIMETRES  
DECIMALIZED NUMBERS INDICATE METRES

| EXISTING     | LEGEND - PLAN       | PROPOSED     | EXISTING          | LEGEND - PLAN | PROPOSED  | EXISTING | LEGEND - PROFILE  | PROPOSED |
|--------------|---------------------|--------------|-------------------|---------------|-----------|----------|-------------------|----------|
| 150 mm W.M.  | WATERMAIN           | 150 mm W.M.  | HYDRO             | CONCRETE      | C PROFILE | ---      | NORTH/WEST GUTTER | ---      |
| 300mm L.D.S. | LAND DRAINAGE SEWER | 300mm L.D.S. | ASPHALT           | PROPERTY LINE | ---       | ---      | SOUTH/EAST GUTTER | ---      |
| 250mm W.W.S. | WASTEWATER SEWER    | 250mm W.W.S. | SURVEY BAR        | ELEVATION     | (35.750)  | ---      | N/W PROPERTY LINE | ---      |
| ---          | MANHOLE             | ---          | TREE              | ---           | ---       | ---      | S/E PROPERTY LINE | ---      |
| ---          | CATCH BASIN         | ---          | SIDEWALK RAMP     | ---           | ---       | ---      | ---               | ---      |
| ---          | CURB INLET          | ---          | CONCRETE SIDEWALK | ---           | ---       | ---      | ---               | ---      |
| ---          | JUNCTIONS           | ---          | FENCE             | ---           | ---       | ---      | ---               | ---      |
| ---          | CULVERT             | ---          | ---               | ---           | ---       | ---      | ---               | ---      |
| ---          | GAS                 | ---          | ---               | ---           | ---       | ---      | ---               | ---      |

**LOCATION APPROVED**  
**UNDERGROUND STRUCTURES**

SUPV. U/G STRUCTURES COMMITTEE DATE

**NOTE:**  
LOCATION OF UNDERGROUND STRUCTURES AS SHOWN ARE BASED ON THE BEST INFORMATION AVAILABLE. BUT NO GUARANTEE IS GIVEN THAT ALL EXISTING UTILITIES ARE SHOWN OR THAT THE GIVEN LOCATIONS ARE EXACT. CONFIRMATION OF EXISTENCE AND EXACT LOCATION OF ALL SERVICES MUST BE OBTAINED FROM THE INDIVIDUAL UTILITIES BEFORE PROCEEDING WITH CONSTRUCTION.

B.M. 36-020  
ELEV. 232.294

S.E. Cor. Logan Ave. & Trinity St., Tbt. in N. Conc. ldn. of No. 936 Logan Ave., 3 m W. & 0.3 m below window of N.E. Cor. of Bldg.

**AECOM**

DESIGNED BY TDW  
CHECKED BY KWR

DRAWN BY PAAP  
APPROVED BY KWR

HOR. SCALE: 1:250  
VERTICAL: 1:10

RELEASED FOR CONSTRUCTION BY: ORIGINAL SIGNED BY B.S. KIBBINS

DATE 2011/05/13

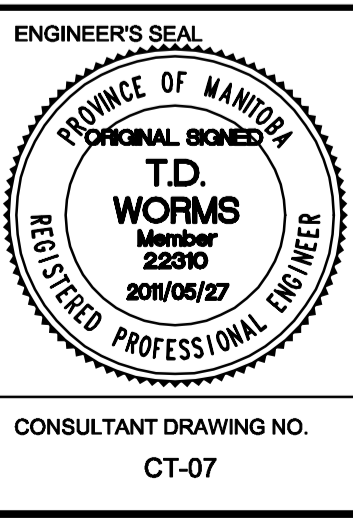

**THE CITY OF WINNIPEG**  
PUBLIC WORKS DEPARTMENT  
ENGINEERING DIVISION

**LOGAN AVENUE**  
McPHILLIPS STREET TO TRINITY STREET  
PAVEMENT RECONSTRUCTION

PLAN/PROFILE  
STATION 3+70 TO STATION 4+50

CITY DRAWING NUMBER  
P-3326-07  
SHEET 7 OF 10

CONSULTANT DRAWING NO.  
CT-07