

General Notes

1. All existing trees, sidewalks, curbs, catch basins, culverts, survey markers, to remain are to be protected during construction. Any damage to them is to be made good by the Contractor. Maintain positive drainage into all catch basins and curb inlets.
2. Contractor is to limit operations to the area within the area of work shown on the drawing. Should areas outside of this limit be damaged during the course of construction, Contractor is to make good the damage at his own expense
3. Contractor is to obtain location of all utilities prior to construction. If using power equipment to excavate contractor must notify Hydro and Gas and telephone utilities and take steps to avoid damaging their installations.
4. All dimensions are in meters unless otherwise noted

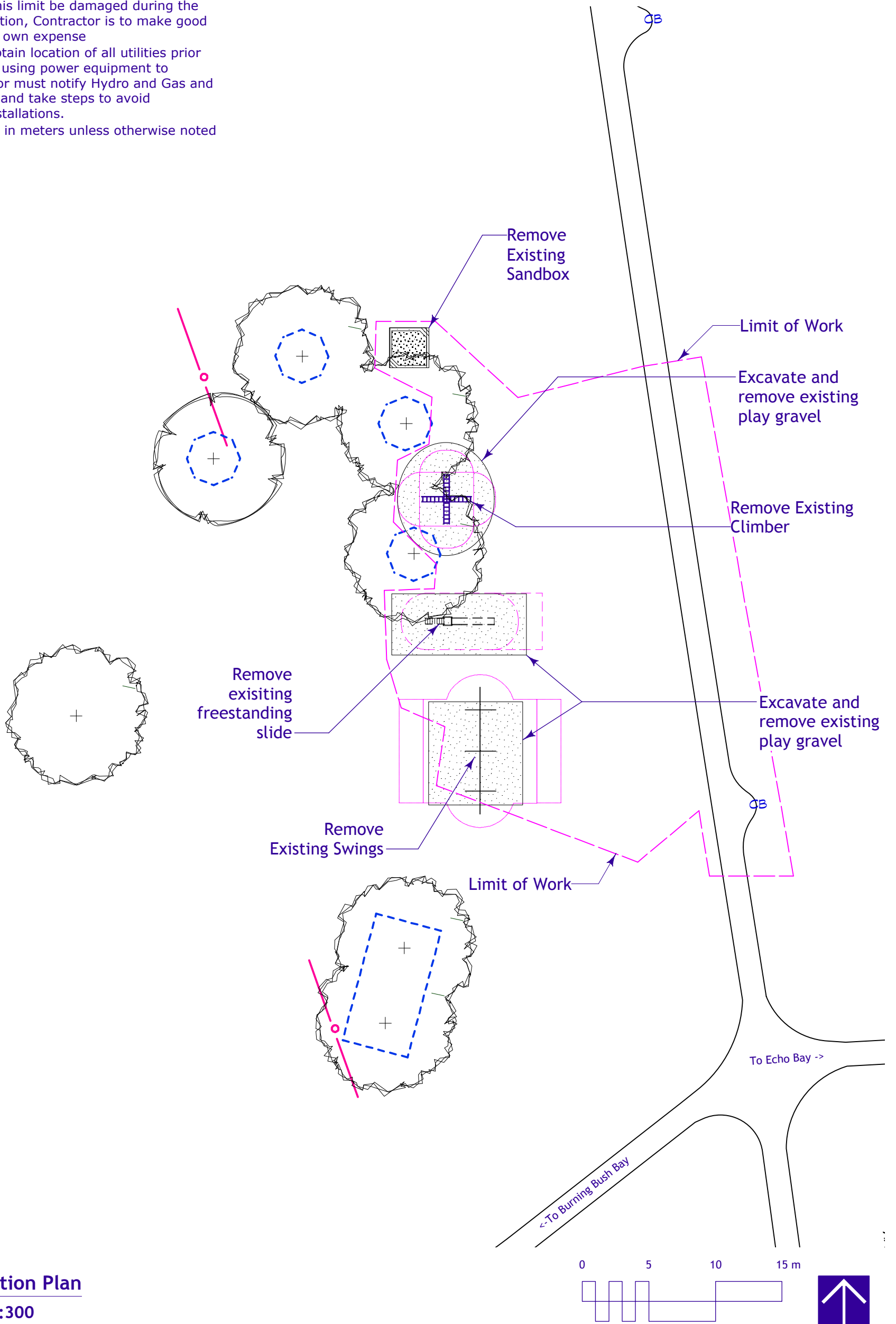

1 Demolition Plan
L-PG-3 Scale: 1:300

No.	Date	Issue Notes
C	5/10/11	For Bid Opp.
Drawing No.		