

WARNING
 IF POWER EQUIPMENT OR EXPLOSIVES ARE TO BE USED FOR EXCAVATION ON THIS PROJECT, THE CONTRACTOR MUST NOTIFY THE GAS COMPANY OF THE PROPOSED LOCATION OF EXCAVATION. TAKE PRECAUTION TO AVOID DAMAGE TO GAS COMPANY INSTALLATIONS. SEE PROVINCIAL REGULATION 140/92 FOR DETAILS.

NOTIFY ANDY VINCENT (CITY OF WINNIPEG) AT 986-3823 48 HOURS PRIOR TO EXCAVATION NEAR FEEDERMAIN OR SECONDARY SEWER

- CONSTRUCTION NOTES:**
- EXPOSE WATERMAIN CONNECTIONS AND CONFIRM INVERTS PRIOR TO CONSTRUCTION
 - INSTALL WATERMAIN BY TRENCHLESS METHODS.
 - ALL MATERIALS SHALL CONFORM TO THE CITY OF WINNIPEG STANDARD CONSTRUCTION SPECIFICATIONS.
 - MINIMUM COVER TO TOP OF PROPOSED WATERMAIN SHALL BE 2.5m FROM STREET CENTERLINE.
 - INSTALL ALL HYDRANTS WITH FLANGE ELEVATION 50mm TO 150mm ABOVE FINISHED GRADE.
 - REPLACE ALL EXISTING LEAD SERVICES FROM THE PROPOSED WATERMAIN TO PROPERTY LINE.
 - NOTIFY ALL AFFECTED RESIDENTS AND BUSINESSES 24 HOURS IN ADVANCE OF ANY WATER SHUTDOWN OR DISRUPTION OF SERVICE.
 - LOCATION OF WATER SERVICES SHOWN ON DRAWINGS ARE APPROXIMATE. THE CONTRACTOR SHALL FIELD LOCATE ALL WATER SERVICES PRIOR TO CONSTRUCTION.
 - BACKFILL UNDER OR WITHIN 1.0m OF PAVEMENTS, INCLUDING SIDEWALKS SHALL BE CLASS 3 BACKFILL EXCEPT AS NOTED. BACKFILL IN BOULEVARDS SHALL BE CLASS 5 BACKFILL. BACKFILL WITHIN 1.5m OF THE 900 FEEDERMAIN SHALL BE MODIFIED CLASS 3 AS SPECIFIED IN E9.

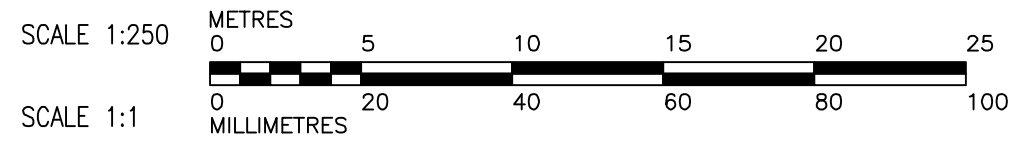

METRIC
 WHOLE NUMBERS INDICATE MILLIMETRES
 DECIMALIZED NUMBERS INDICATE METRES

APEGM
 Certificate of Authorization
 AECOM Canada Ltd.
 No. 4671 Date: MAY 26, 2011

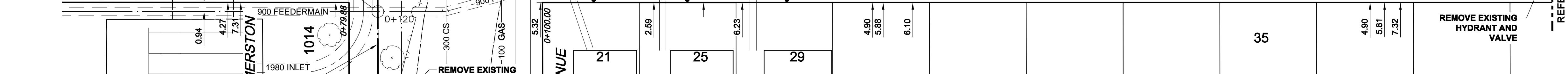

ADDRESS	NATURE OF SERVICE	SIZE	MATERIAL	DISTANCE SC TO PROPERTY	POSITION OF SC (curb stop)	POSITION OF CC (corp)	COMMENTS:
1010 PALMERSTON AVE	RESIDENTIAL	3/4 in (19 mm)	LEAD	(0.3 m)	Long: (18.7 m) E of EL AUBREY HOUSE Short: (2.6 m) E of WL HOUSE	Long: of of Short: OPP of S/C	
1016 PALMERSTON AVE	COMMERCIAL	3/4 in (19 mm)	COPPER		Long: (14.2 m) W of E L Short: of of	Long: of of Short: of of	
1016 PALMERSTON AVE	COMMERCIAL	3/4 in (19 mm)	COPPER		Long: (14.2 m) W of E L Short: of of	Long: of of Short: of of	
1030 PALMERSTON AVE	RESIDENTIAL	3/4 in (19 mm)	COPPER	(0.3 m)	Long: (11.3 m) W of WL AUBREY HOUSE Short: (5.2 m) E of WL AUBREY HOUSE	Long: (4.6 m) W of WL AUBREY HOUSE Short: of of	MAIN TAPPED OPPOSITE SIDE RENEW TO PROPERTY

ADDRESS	NATURE OF SERVICE	SIZE	MATERIAL	DISTANCE SC TO PROPERTY	POSITION OF SC (curb stop)	POSITION OF CC (corp)	COMMENTS:
20 AUBREY ST	RESIDENTIAL	3/4 in (19 mm)	COPPER	(0.5 m)	Long: (6.2 m) S of NL HOUSE Short: (1.2 m) N of SL HOUSE	Long: of of Short: (1.1 m) S of S/C	RENEW TO PROPERTY
21 AUBREY ST	RESIDENTIAL	3/4 in (19 mm)	COPPER	(0.5 m)	Long: (5.3 m) N of NL PALMERSTON HOUSE Short: (2.1 m) N of SL HOUSE	Long: of of Short: (1.5 m) N of S/C	MAIN TAPPED OPPOSITE SIDE
22 AUBREY ST	RESIDENTIAL	3/4 in (19 mm)	COPPER	(0.5 m)	Long: (5.9 m) S of NL HOUSE Short: (1.4 m) N of SL HOUSE	Long: of of Short: (1.1 m) N of S/C	MAIN TAPPED OPPOSITE SIDE
24 AUBREY ST	RESIDENTIAL	3/4 in (19 mm)	COPPER	(0.5 m)	Long: (5.8 m) S of NL HOUSE Short: (1.7 m) N of SL HOUSE	Long: of of Short: (1.2 m) N of S/C	RENEW TO PROPERTY
25 AUBREY ST	RESIDENTIAL	3/4 in (19 mm)	LEAD	(0.6 m)	Long: (15.2 m) N of NL PALMERSTON HOUSE Short: (1.8 m) N of SL HOUSE	Long: of of Short: (2.0 m) N of S/C	MAIN TAPPED OPPOSITE SIDE
26 AUBREY ST	RESIDENTIAL	3/4 in (19 mm)	COPPER	(0.5 m)	Long: (4.4 m) S of NL HOUSE Short: (3.0 m) N of SL HOUSE	Long: of of Short: (0.3 m) N of S/C	MAIN TAPPED OPPOSITE SIDE
28 AUBREY ST	RESIDENTIAL	3/4 in (19 mm)	COPPER	(0.5 m)	Long: (6.4 m) S of NL HOUSE Short: (2.1 m) N of SL HOUSE	Long: of of Short: (0.6 m) N of S/C	RENEW TO PROPERTY
29 AUBREY ST	RESIDENTIAL	3/4 in (19 mm)	LEAD	(0.3 m)	Long: (25.3 m) N of NL PALMERSTON HOUSE Short: (3.4 m) N of SL HOUSE	Long: of of Short: (0.3 m) N of S/C	MAIN TAPPED OPPOSITE SIDE
36 AUBREY ST	RESIDENTIAL	3/4 in (19 mm)	COPPER	(0.5 m)	Long: (6.4 m) S of NL HOUSE Short: (1.5 m) N of SL HOUSE	Long: of of Short: OPP of S/C	MAIN TAPPED OPPOSITE SIDE
48 AUBREY ST	RESIDENTIAL	3/4 in (19 mm)	COPPER	(0.5 m)	Long: (8.4 m) S of NL HOUSE Short: (1.7 m) S of SL HOUSE	Long: of of Short: OPP of S/C	MAIN TAPPED OPPOSITE SIDE

LOCATION APPROVED UNDERGROUND STRUCTURES

DATE COMMITTEE

NOTE: LOCATION OF UNDERGROUND STRUCTURES AS SHOWN ARE BASED ON THE BEST INFORMATION AVAILABLE. BUT NO GUARANTEE IS GIVEN THAT ALL EXISTING UTILITIES ARE SHOWN OR THAT THE GIVEN LOCATIONS ARE EXACT. CONFIRMATION OF EXISTENCE AND EXACT LOCATION OF ALL SERVICES MUST BE OBTAINED FROM THE INDIVIDUAL UTILITIES BEFORE PROCEEDING WITH CONSTRUCTION.

BM 37-059 ELEV. 232.782m

S.E. Cor. Westminster Ave. & Lipson St., T4L in W. typical State Foundation of No. 191 Lipson St., 0.5m S. & 0.3 m A.G.L. of N.W. Cor. of Blg.

NO.	REVISIONS	DATE	BY
0	ISSUED FOR TENDER	11/05/26	GL
A	ISSUED FOR REVIEW	11/05/19	JP

AECOM

DESIGNED BY GSK CHECKED BY FMI
 DRAWN BY JP APPROVED BY CCM

HOR. SCALE 1:250
 VERT. SCALE 1:50

RELEASED FOR CONSTRUCTION
 DATE 2011/05/26

PROFESSIONAL'S SEAL
 ORIGINAL SIGNED BY
K.W. FITCHETT
 MAY 26, 2011
 CONSULTANT DRAWING NO.
 60188096-01-C-101-ROX.dwg

THE CITY OF WINNIPEG WATER AND WASTE DEPARTMENT

2011 WATERMAIN RENEWALS CONTRACT 4

AUBREY STREET PALMERSTON AVENUE TO STATION 0+205

SHEET 1 OF 7
 CITY DRAWING NUMBER
D-12431