

\*\* Ensure adequate safety zones are met between relocated and existing play equipment. Existing play equipment locations are not necessarily accurate.

### PLAY EQUIPMENT LAYOUT

NTS

Supply and Install Engineered Wood Fibre Safety Surfacing including drainage layer

New Natural Play Area by others

Supply and Install benches x 2

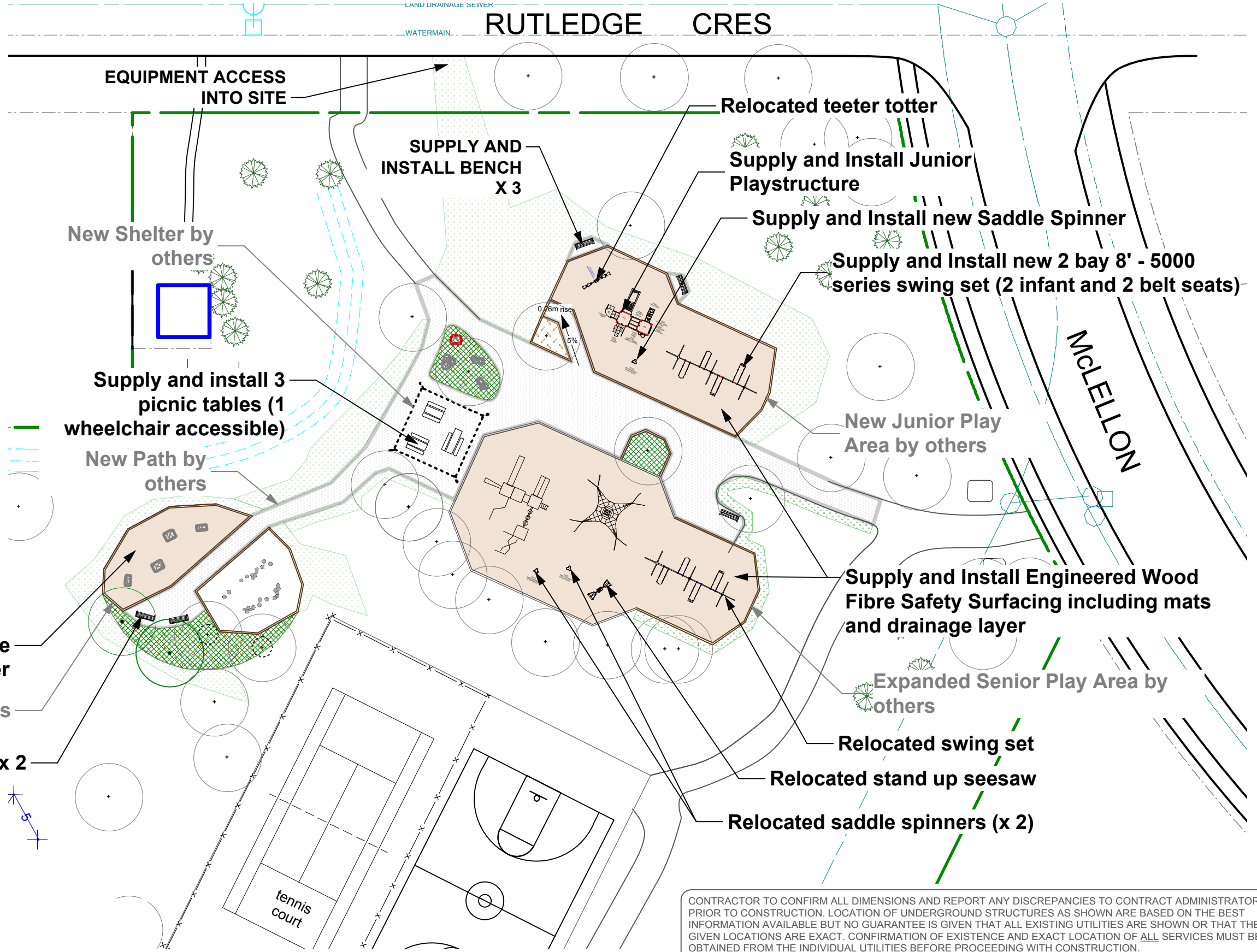

EQUIPMENT ACCESS INTO SITE

SUPPLY AND INSTALL BENCH X 3

New Shelter by others

Supply and install 3 picnic tables (1 wheelchair accessible)

New Path by others

Relocated teeter totter

Supply and Install Junior Playstructure

Supply and Install new Saddle Spinner

Supply and Install new 2 bay 8' - 5000 series swing set (2 infant and 2 belt seats)

New Junior Play Area by others

Supply and Install Engineered Wood Fibre Safety Surfacing including mats and drainage layer

Expanded Senior Play Area by others

Relocated swing set

Relocated stand up seesaw

Relocated saddle spinners (x 2)

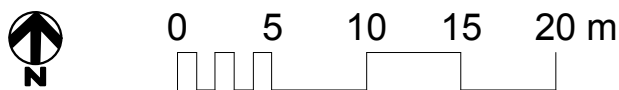

CONTRACTOR TO CONFIRM ALL DIMENSIONS AND REPORT ANY DISCREPANCIES TO CONTRACT ADMINISTRATOR PRIOR TO CONSTRUCTION. LOCATION OF UNDERGROUND STRUCTURES AS SHOWN ARE BASED ON THE BEST INFORMATION AVAILABLE BUT NO GUARANTEE IS GIVEN THAT ALL EXISTING UTILITIES ARE SHOWN OR THAT THE GIVEN LOCATIONS ARE EXACT. CONFIRMATION OF EXISTENCE AND EXACT LOCATION OF ALL SERVICES MUST BE OBTAINED FROM THE INDIVIDUAL UTILITIES BEFORE PROCEEDING WITH CONSTRUCTION.



THE CITY OF WINNIPEG  
 Planning, Property and Development Department  
 Planning and Land Use Division  
 Unit 15 - 30 Fort Street, Winnipeg, MB, (R3C 4X5)

DESIGNED BY	SP	CHECKED BY	
DRAWN BY	SP	APPROVED BY	
HORIZ. SCALE	1:400		
VERT. SCALE			
DATE	MAY 2011		

MANAGER, PARK AND OPEN SPACES	DATE
MANAGER, PLANNING AND LAND USE DIVISION	DATE

DRAWING TITLE	DRAWING NO.
<b>Archambault Park</b>	
<b>Play Equipment Redevelopment</b>	
<b>Proposed</b>	
SITE ADDRESS	
224 Rutledge Crescent	

<b>A.63-B2</b>
BID OPPORTUNITY NO. <b>466-2011</b>