

NOTES:
1.) Measurement Corresponds to Inside Edge for Concrete Play Edging and Rolled Asphalt

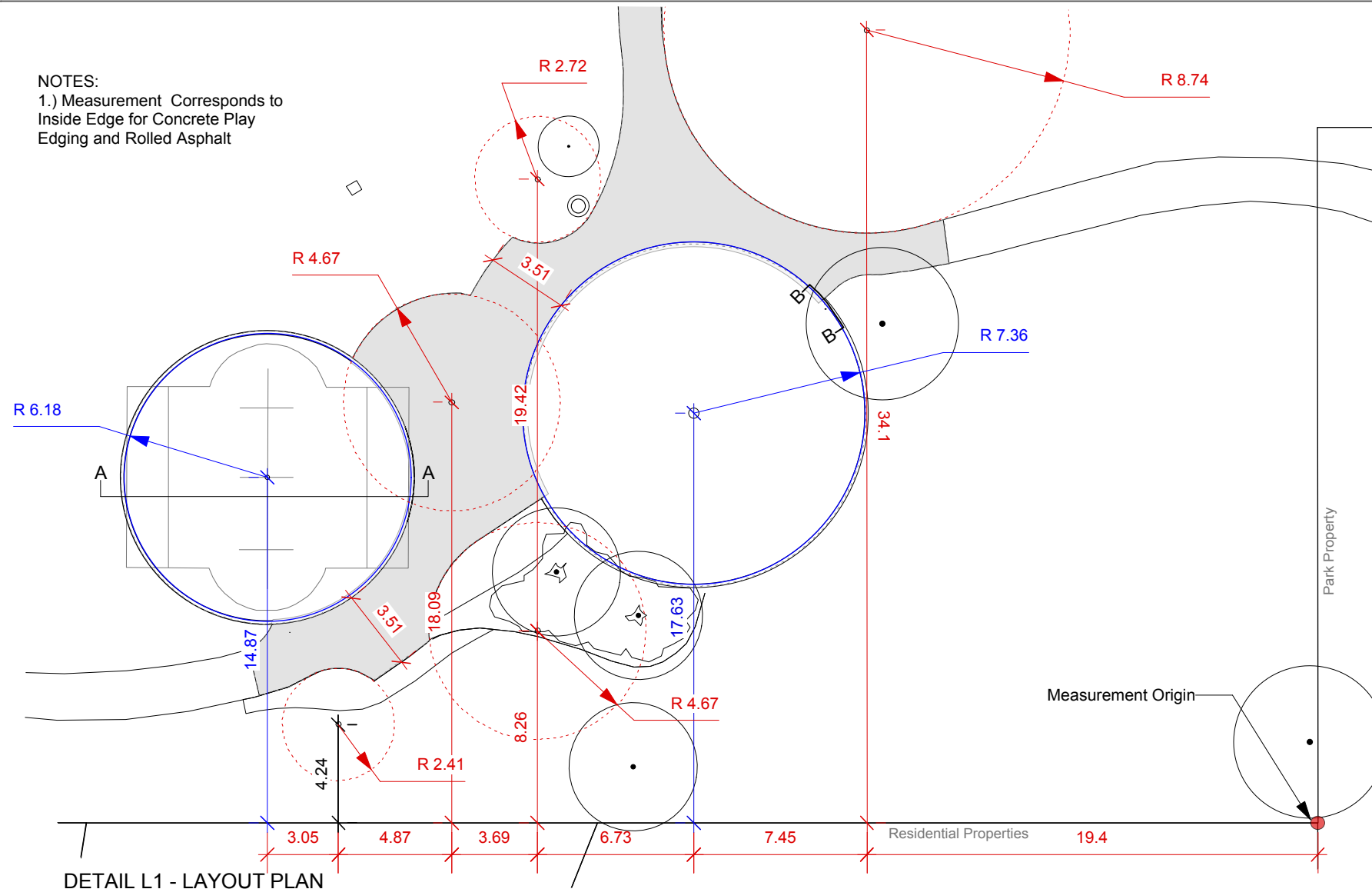

DETAIL L1 - LAYOUT PLAN

Scale - 1:250

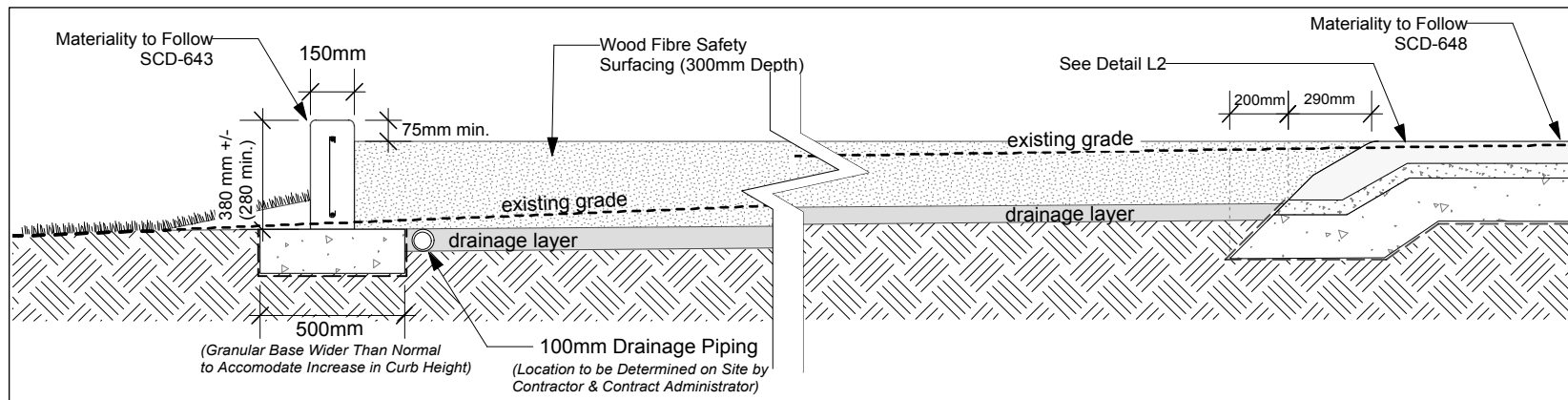

DETAIL L3 - SECTION A-A

Scale - 1:25

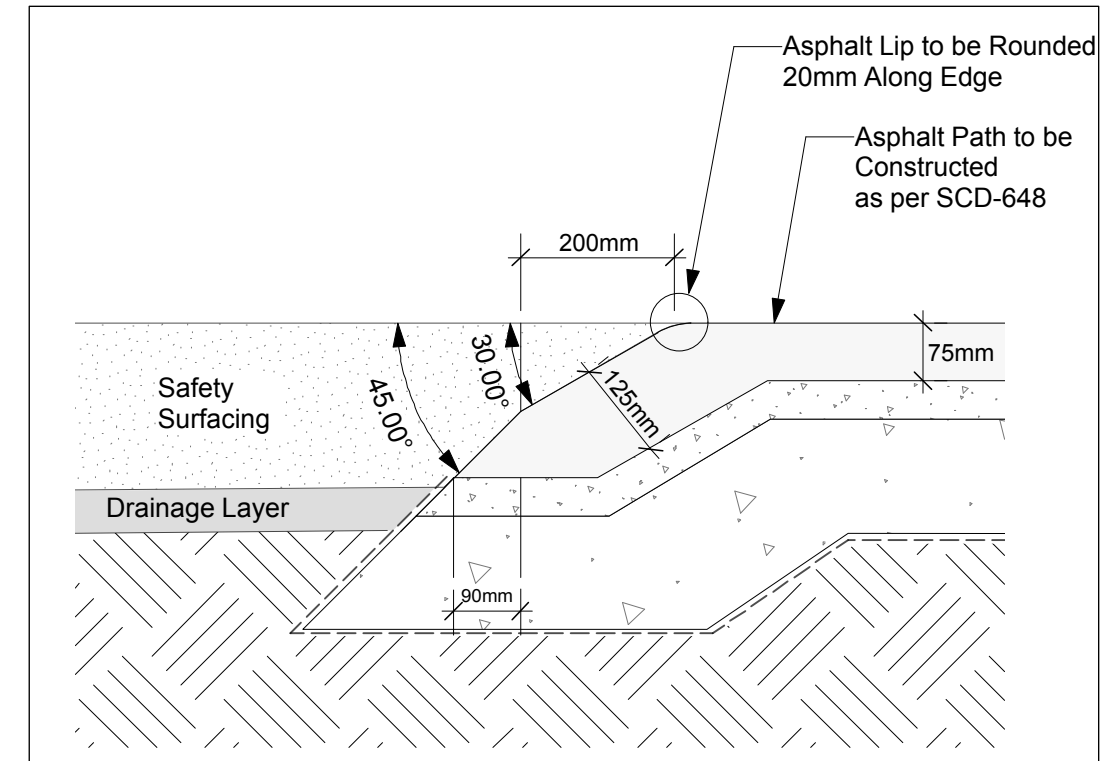

DETAIL L2 - ASPHALT ROLLED EDGE

Scale - 1:10

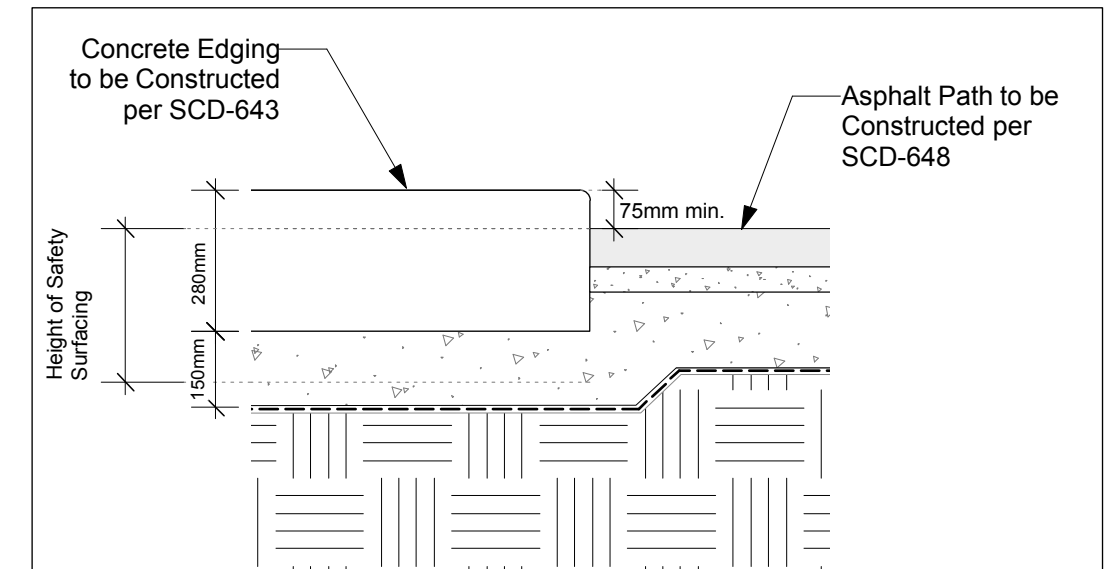

DETAIL L4 - LONGITUDINAL SECTION B-B

Scale - 1:15

CONTRACTOR TO CONFIRM ALL DIMENSIONS AND REPORT ANY DISCREPANCIES TO CONTRACT ADMINISTRATOR PRIOR TO CONSTRUCTION. LOCATION OF UNDERGROUND STRUCTURES AS SHOWN ARE BASED ON THE BEST INFORMATION AVAILABLE BUT NO GUARANTEE IS GIVEN THAT ALL EXISTING UTILITIES ARE SHOWN OR THAT THE GIVEN LOCATIONS ARE EXACT. CONFIRMATION OF EXISTENCE AND EXACT LOCATION OF ALL SERVICES MUST BE OBTAINED FROM THE INDIVIDUAL UTILITIES BEFORE PROCEEDING WITH CONSTRUCTION.



THE CITY OF WINNIPEG
Planning, Property and Development Department
Planning and Land Use Division
Unit 15 - 30 Fort Street, Winnipeg, MB, (R3C 4X5)

DESIGNED BY	IL	CHECKED BY	
DRAWN BY	IL	APPROVED BY	
HORIZ. SCALE	As Indicated		
VERT. SCALE	As Indicated		
DATE	MAY 2011		

MANAGER, PARK AND OPEN SPACES	DATE
MANAGER, PLANNING AND LAND USE DIVISION	DATE

DRAWING TITLE McBETH PARK PLAYGROUND PLAYGROUND RENEWAL Layout Plan & Details	DRAWING NO. M.28-CC
SITE ADDRESS	BID OPPORTUNITY NO. 468-2011