

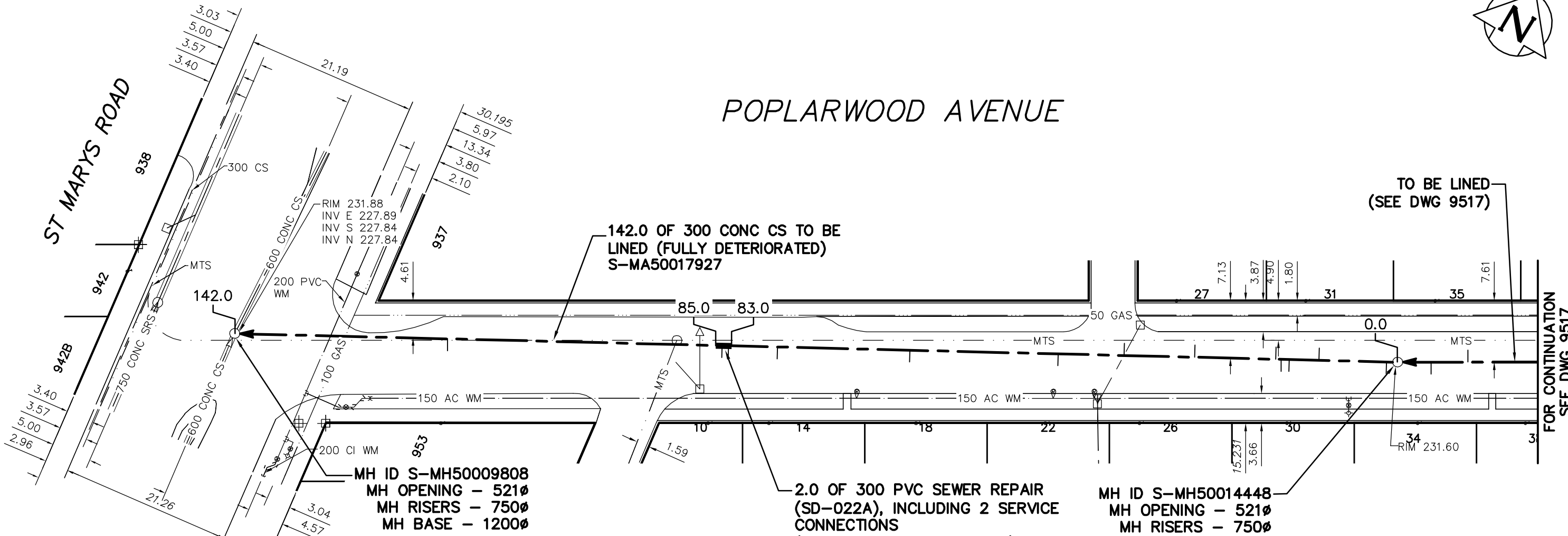

POPLARWOOD AVENUE



142.0 OF 300 CONC CS TO BE LINED (FULLY DETERIORATED)
S-MA50017927

2.0 OF 300 PVC SEWER REPAIR (SD-022A), INCLUDING 2 SERVICE CONNECTIONS (TO BE DONE WITH OTHERS)

MH ID S-MH50014448
MH OPENING - 521
MH RISERS - 750
MH BASE - 1200

MH ID S-MH50009808
MH OPENING - 521
MH RISERS - 750
MH BASE - 1200

SEWER JUNCTION INFORMATION FROM SEWER VIDEO INSPECTION
SEWER ID S-MA50017927

DISTANCE FROM MH ID S-MH50014448				
1.4	S	150	EAST	CXI
9.8	S	150	WEST	JN
13.5	S	150	EAST	CNI
14.5	S	150	EAST	CN
15.2	S	150	WEST	CNI
25.3	S	150	WEST	JN
34.1	S	150	WEST	CNI
42.3	S	150	EAST	CN
60.8	S	150	EAST	CNI
77.3	S	150	EAST	CNI
83.4	S	150	EAST	CNI
84.2	S	150	EAST	CX
118.4	S	150	EAST	JN

TO BE LINED (SEE DWG 9517)

FOR CONTINUATION SEE DWG 9517

ENGINEER'S SEAL

ORIGINAL SIGNED BY
S.R.J. COURNOYER
11-03-18

BID OPPORTUNITY No: 49-2011
FILENAME : 9515-9518.DWG
PLOT DATE : 2011 03 22

LEGEND:
52.0 | MEASUREMENT TO REPAIR FROM REFERENCE MH SHOWN THUS...

METRIC
WHOLE NUMBERS INDICATE MILLIMETRES
DECIMALIZED NUMBERS INDICATE METRES

B.M. ELEV.	FIELD BOOK #:	CITY OF WINNIPEG WATER AND WASTE ENGINEERING DIVISION		THE CITY OF WINNIPEG WATER AND WASTE DEPARTMENT	
POSTED TO LBIS		DESIGNED BY: SC	CHECKED BY: SC	2011 SEWER RENEWALS BY CIPP LINING, CONTRACT 14	
		DRAWN BY: RS	APPROVED BY: KZ	POPLARWOOD AVENUE	
		HOR. SCALE: 1:500	RELEASED FOR CONSTRUCTION: KAS ZUREK	2ND MH W OF NEEPAWA STREET TO MH AT ST MARYS ROAD	
		VERTICAL	DATE: 2011 03 18	DATE: 11-03-22	
NO. REVISIONS	DATE BY			SHEET 40 OF 85	
				CITY DRAWING NUMBER	
				9518	