

ALLEY PAVEMENT PROFILE

SCALE: HOR 1:250
VER 1:10

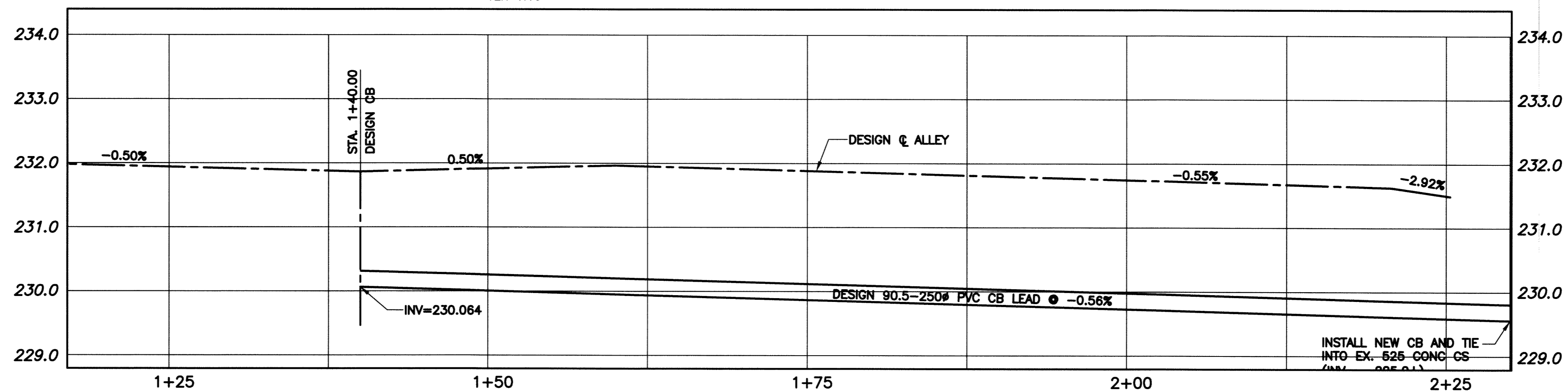

CATCH BASIN & CATCH BASIN LEAD PROFILE

SCALE: HOR 1:250
VER 1:50

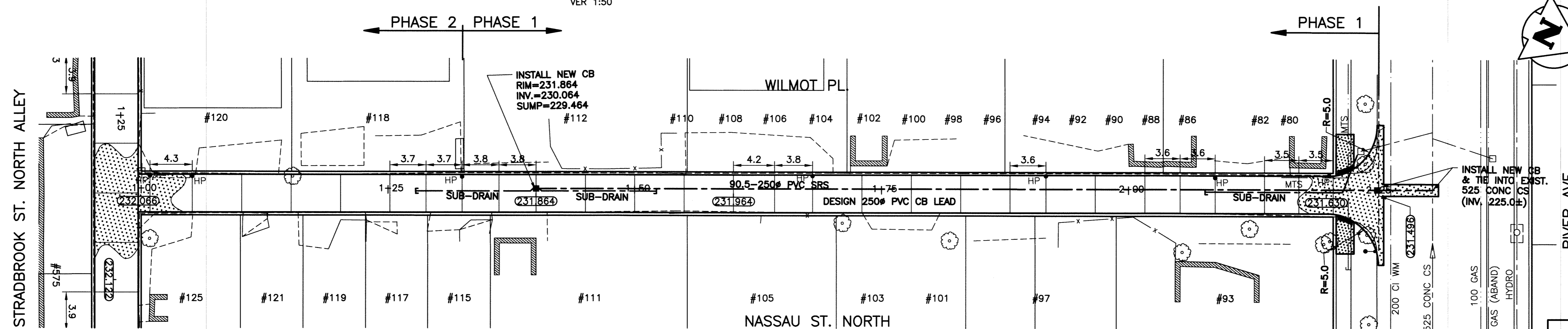

ALLEY PAVEMENT PLAN

SCALE: HOR 1:250

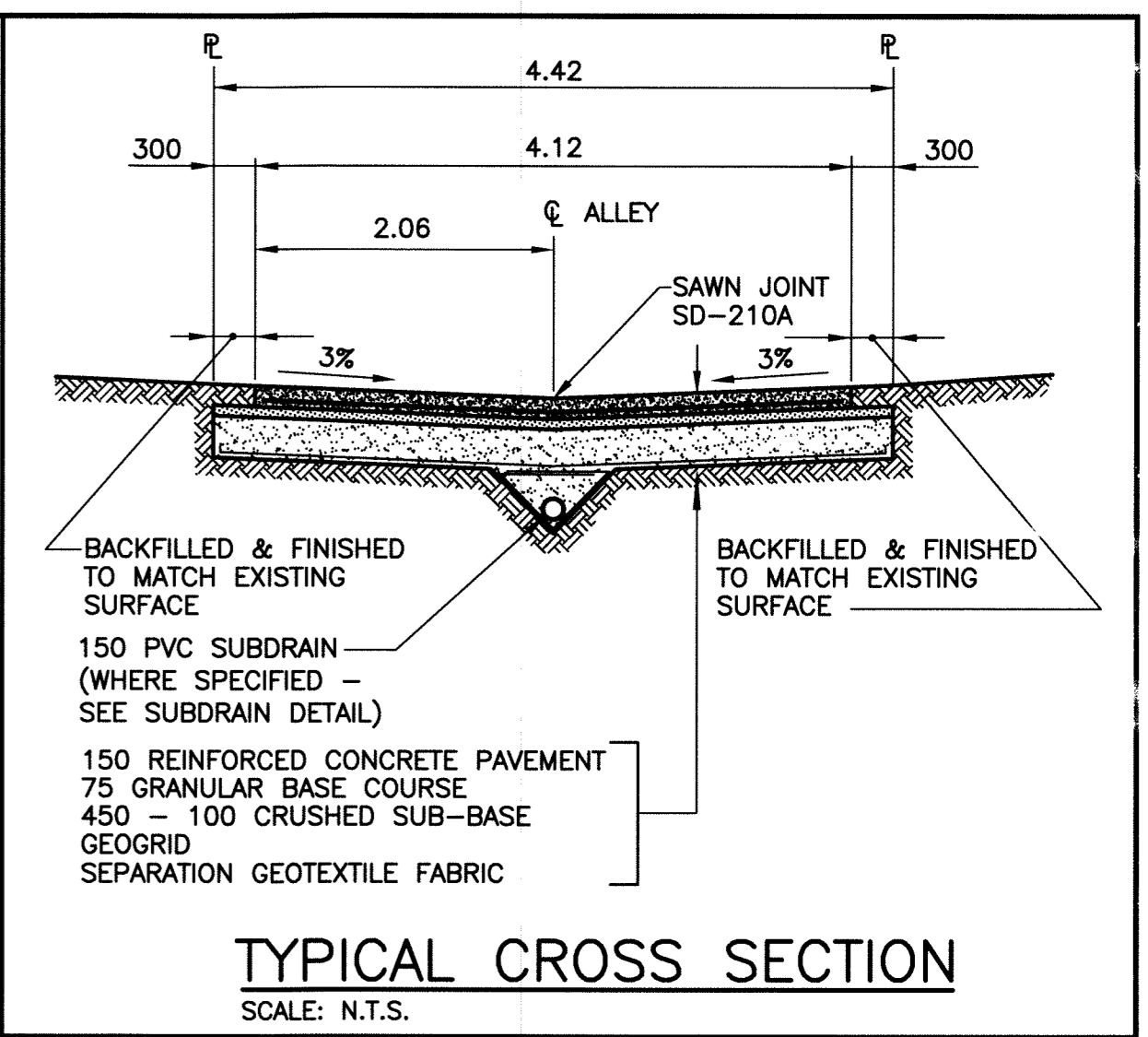

TYPICAL CROSS SECTION

SCALE: N.T.S.

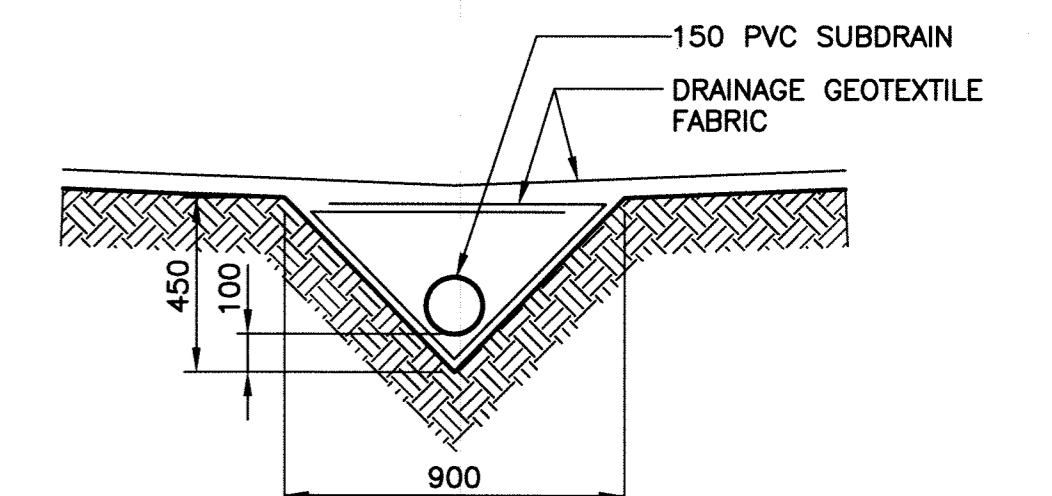

SUBDRAIN DETAIL

SCALE: 1:20

NOTE:

1. STATION CHAINAGE IS BASED ON CENTERLINE OF ALLEY RIGHT OF WAY.
2. ADJUST MH AND CB RIMS TO NEW GRADES.
3. PLUG SUBDRAINS AT TERMINAL ENDS.
4. REGRADE EXISTING PRIVATE SIDEWALKS AS REQUIRED.
5. INSTALLATION OF LIP CURBS AND THEIR EXTENTS TO BE DETERMINED BY THE CONTRACT ADMINISTRATOR.
6. LIGHT STANDARDS, HYDRO POLES AND ANCHORS MAY REQUIRE TEMPORARY SUPPORT/REMOVAL OR REPLACEMENT AT THE CONTRACTOR'S EXPENSE.
7. ISOLATE ALL POLES, BASES AND PILES WITHIN ALLEY RIGHT OF WAY (SD-228C)
8. AVOID DAMAGE TO EXISTING TREES WITHIN THE LIMITS OF CONSTRUCTION.

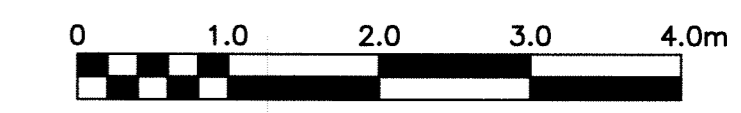

SCALE: 1:100 METRIC A1
1:100 METRIC A3

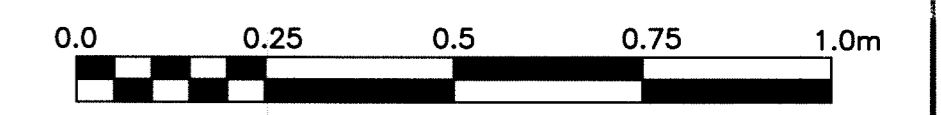

SCALE: 1:10 METRIC A1
1:20 METRIC A3

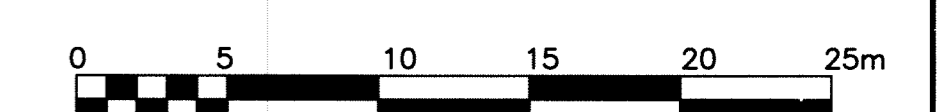

SCALE: 1:250 METRIC A1
1:500 METRIC A3

WARNING

NOTIFY THE GAS COMPANY OF THE PROPOSED LOCATION OF EXCAVATION.

TAKE PRECAUTION TO AVOID DAMAGE TO GAS COMPANY INSTALLATIONS.

SEE PROVINCIAL REGULATION 210/72 FOR DETAILS.

PROPERTY LIMITS DELINEATION

DELINEATION OF PROPERTY LIMITS AS SHOWN ON THIS DWG DOES NOT REPRESENT A "LEGAL SURVEY". KGS GROUP MAKES NO REPRESENTATION OR WARRANTY AS TO THE ACCURACY OF PROPERTY LIMITS DELINEATED ON THIS DWG, NOR ON THE DIMENSIONAL ACCURACY OF DWG FEATURES RELATIVE TO THOSE PROPERTY LIMITS.

APEGM
Certificate of Authorization
KGS Group
No. 245

METRIC
WHOLE NUMBERS INDICATE MILLIMETRES
DECIMALIZED NUMBERS INDICATE METRES

THE CITY OF WINNIPEG
PUBLIC WORKS DEPARTMENT
TRANSPORTATION ENGINEERING DIVISION

PROJECT TITLE
2011 ALLEY RENEWAL PROGRAM
WILMOT PL./NASSAU ST.
STRADBROOK ST. NORTH ALLEY TO
RIVER AVE.
STA. 1+00 TO STA. 2+30

SHEET OF
04 OF **18**

COMPUTER FILE NAME
STRADBROOK NORTH

CITY DRAWING NUMBER
P-XX04

300 LBS	LAND DRAINAGE SEWER	300 LBS							
250 WWS	WASTE WATER SEWER	250 WWS	+	TEST HOLE					
	GAS		-	GUY WIRE					
	HYDRO		○	LIGHT STANDARD					
	M.T.S.		---	BACK OF CURB					
150 WM	WATERMAIN	150 WM	+	CONCRETE					
	HYDRANT		+	ASPHALT					
	VALVE		+	SIDEWALK					
	MANHOLE		○	PROPERTY LINE					
	CATCH BASIN		+	SURVEY BAR					
	CURB INLET		▽	GEODETIC BENCHMARK					
	POLES		•	ELEVATION					
EXISTING	LEGEND-PLAN	PROPOSED	EXISTING	LEGEND-PLAN	PROPOSED	EXISTING	LEGEND-PROFILE	PROPOSED	

LOCATION APPROVED UNDERGROUND STRUCTURES		DATE	
SUPV. U/G STRUCTURES COMMITTEE		DATE	

NOTE:
LOCATION OF UNDERGROUND STRUCTURES AS SHOWN ARE BASED ON THE BEST INFORMATION AVAILABLE BUT NO GUARANTEE IS GIVEN THAT ALL EXISTING UTILITIES ARE SHOWN OR THAT THE GIVEN LOCATIONS ARE EXACT. CONFIRMATION OF EXISTENCE AND EXACT LOCATION OF ALL SERVICES MUST BE OBTAINED FROM THE INDIVIDUAL UTILITIES BEFORE PROCEEDING WITH CONSTRUCTION.

B.M. 52-036	N. side River Ave. W. of Wellington Cres. 19ft. in S. Conc. wall of parking garage of No. 625 River Ave. 5.0m E. & 0.3m below top of Conc. retaining wall from S.W. Cor. of parking garage	ELEV. 230.712	
ISSUED FOR TENDER		11/06/09	MSM
NO. REVISIONS		DATE	BY

KGS GROUP CONSULTING ENGINEERS	
DESIGNED BY MSM	CHECKED BY RBO
DRAWN BY DMW	APPROVED BY <i>[Signature]</i>
HOR. SCALE: 1:250	RELEASED FOR CONSTRUCTION:
VERTICAL: 1:50	DATE

ENGINEER'S SEAL

PROVINCE OF MANITOBA
REGISTERED PROFESSIONAL ENGINEER
M.S. MANZANO
Member
2239
JAN 1988 - FEB 2009

CONSULTANT DRAWING NO.
11-0107-10

P:\PROJECTS\2011\11-0107-10\MUN\DWGS PLOT 1:1 A-1