

EAST BOUND PROFILE - NORTH LANE
SCALE: 1:250 HOR
1:10 VER

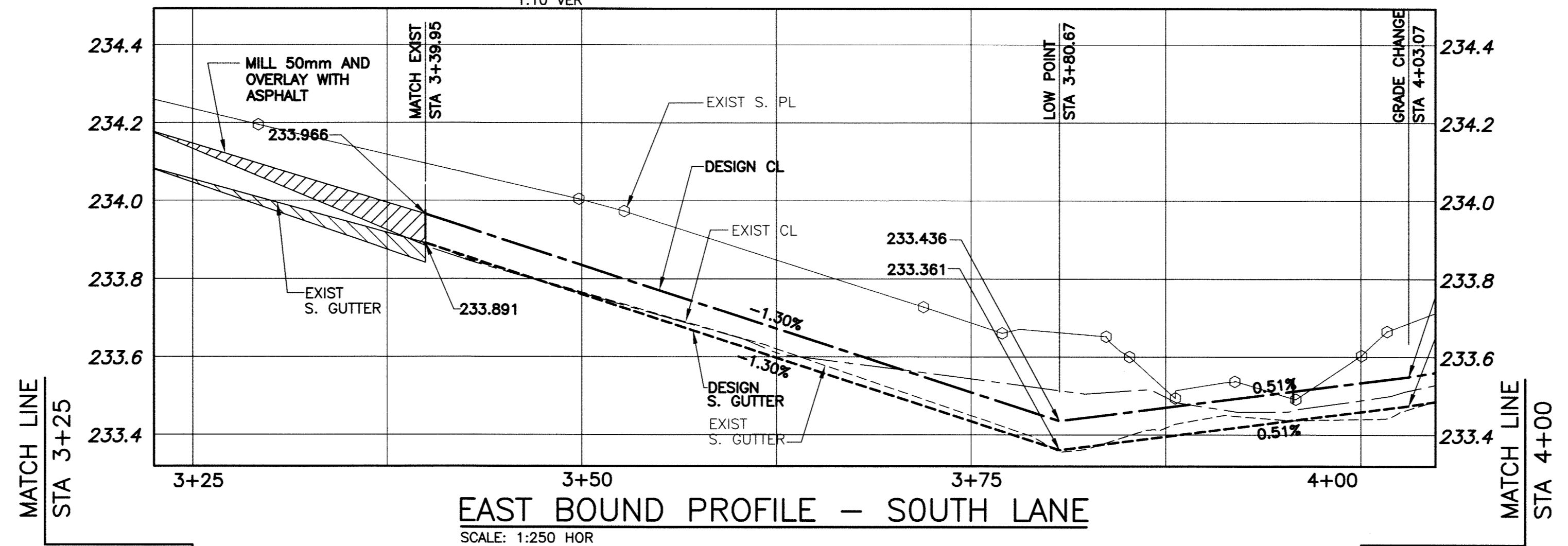

EAST BOUND PROFILE - SOUTH LANE
SCALE: 1:250 HOR
1:10 VER

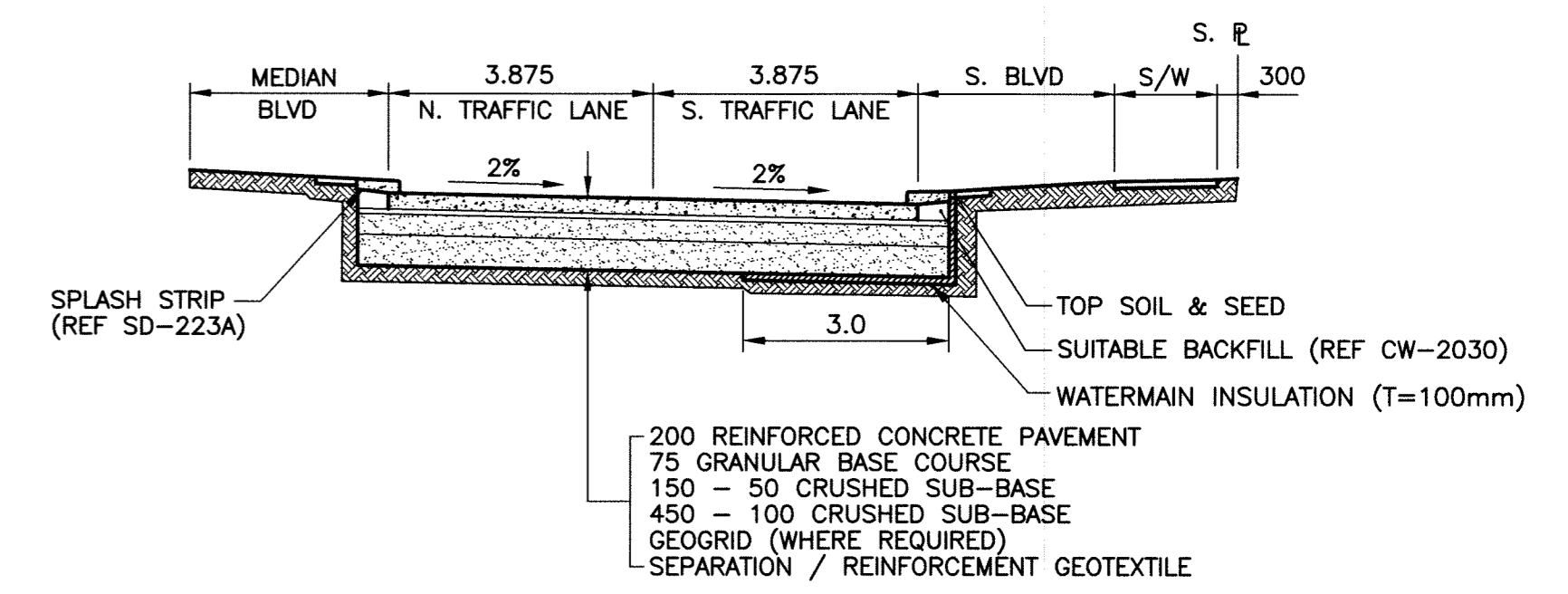

ROAD CROSS SECTION
SCALE: 1:100

- NOTE:**
- STATION CHAINAGE IS BASED ON CENTRELINE OF CORYDON AVENUE.
 - ADJUST NEW MH AND CB RIMS TO NEW GRADES.
 - PLUG SUBDRAINS AT TERMINAL ENDS.
 - REGRADE EXISTING PRIVATE SIDEWALKS AS REQUIRED.
 - ISOLATE ALL POLES, BASES AND PILES WITHIN SIDEWALK (SD-228C).
 - AVOID DAMAGE TO EXISTING TREES WITHIN THE LIMITS OF CONSTRUCTION.
 - ALL PAVEMENT MEASUREMENTS ARE TO BACK OF CURB.
 - CONTACT TERASPERN TO LOWER FIBRE OPTIC CABLE WHERE REQUIRED.
 - CONSTRUCT MANHOLE AND CATCH BASIN ISOLATIONS IN ACCORDANCE WITH SD-228C.
 - INSTALL DETECTABLE WARNING SURFACE TILES IN ACCORDANCE WITH SPECIFICATION.
 - CAUTION: THE TERASPERN CABLE IS LOCATED ALONG THE ENTIRE LENGTH OF THE PROJECT AND WITHIN 300mm OF THE GROUND/PAVEMENT SURFACE.
 - INSTALL 100mm THICK APPROVED INSULATION BETWEEN NEW CATCH BASINS AND EXISTING 400 AC WATERMAIN. INSTALL INSULATION ACCORDING TO SPECIFICATION.
 - INSTALL 100mm THICK INSULATION ACCORDING TO THE ROAD CROSS SECTION FROM STA. 1+00 TO STA. 4+00. INSTALL 3.0m WIDE INSULATION AS CLOSE TO THE SOUTH WALL OF THE ROADWAY EXCAVATION AS POSSIBLE.

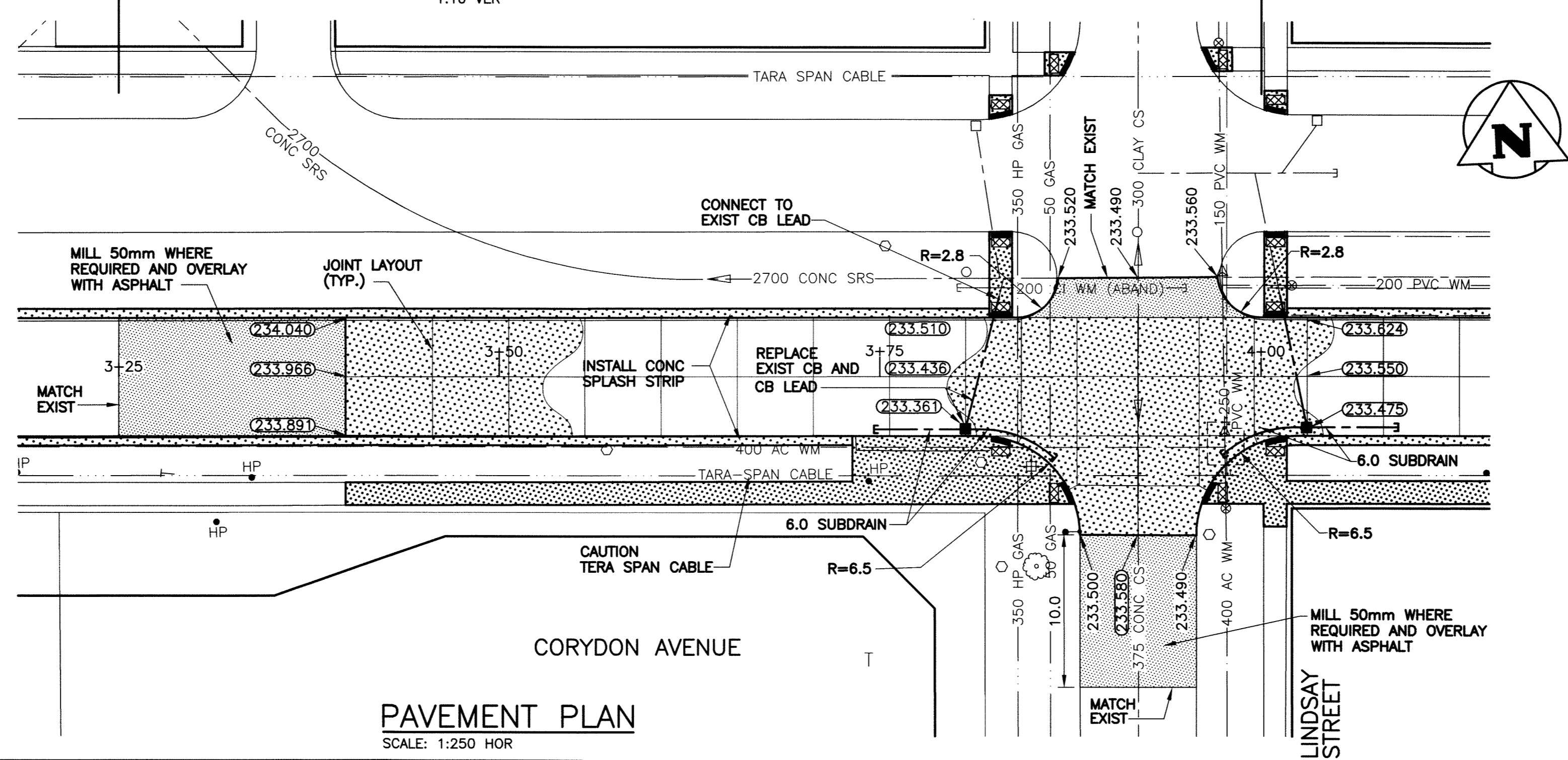

PAVEMENT PLAN
SCALE: 1:250 HOR

PROPERTY LIMITS DELINEATION

DELINEATION OF PROPERTY LIMITS AS SHOWN ON THIS DWG DOES NOT REPRESENT A "LEGAL SURVEY". KGS GROUP MAKES NO REPRESENTATION OR WARRANTY AS TO THE ACCURACY OF PROPERTY LIMITS DELINEATED ON THIS DWG, NOR ON THE DIMENSIONAL ACCURACY OF DWG FEATURES RELATIVE TO THOSE PROPERTY LIMITS.

WARNING

- NOTIFY THE GAS COMPANY OF THE PROPOSED LOCATION OF EXCAVATION.
- TAKE PRECAUTION TO AVOID DAMAGE TO GAS COMPANY INSTALLATIONS.
- SEE PROVINCIAL REGULATION 210/72 FOR DETAILS.

METRIC

WHOLE NUMBERS INDICATE MILLIMETRES
DECIMALIZED NUMBERS INDICATE METRES

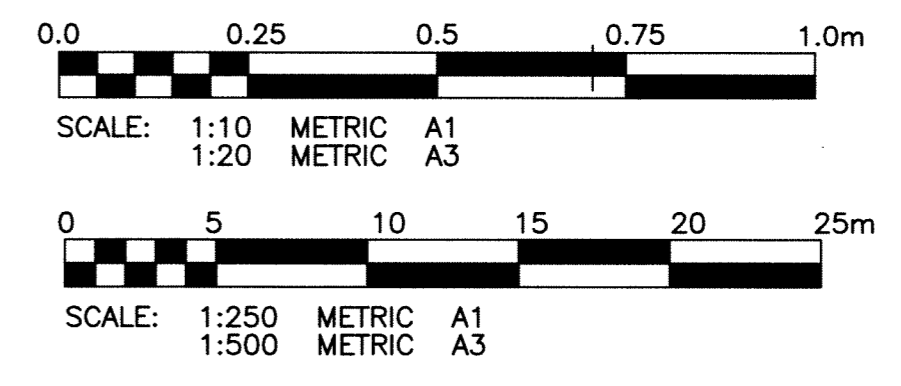

P:\Projects\2011\11-0107-08\DocControl\Released\DWG\3328-04-Rev.0.dwg - Tab: 04 Plotted By: Dieroché 07/04/2011 [Mon 1:38pm]

EXISTING	LEGEND-PLAN	PROPOSED	EXISTING	LEGEND-PLAN	PROPOSED	EXISTING	LEGEND-PROFILE	PROPOSED
300 LBS	LAND DRAINAGE SEWER	300 LBS	BACK OF CURB					
250 WWS	WASTE WATER SEWER	250 WWS	CONCRETE					
	GAS		ASPHALT					
	HYDRO		SIDEWALK					
	M.T.S.		CURB RAMP					
150 WM	WATERMAIN	150 WM	PROPERTY LINE					
⊕	HYDRANT	⊕	DETECTABLE WARNING TILES	⊕		BLVD PROFILE		
⊕	VALVE	⊕	TEST HOLE	⊕		S PL PROFILE		
⊕	MANHOLE	⊕	GUY WIRE	⊕		C PROFILE		
⊕	CATCH BASIN	⊕	TREE	⊕		N GUTTER PROFILE		
⊕	CURB INLET	⊕	SURVEY BAR	⊕		S GUTTER PROFILE		
⊕	LIGHT STANDARD	⊕	GEODETIC BENCHMARK	⊕		S PARK GUTTER PROFILE		
⊕	POLES	⊕	ELEVATION	⊕				

LOCATION APPROVED UNDERGROUND STRUCTURES

SUPV. U/G STRUCTURES COMMITTEE DATE

NOTE:
LOCATION OF UNDERGROUND STRUCTURES AS SHOWN ARE BASED ON THE BEST INFORMATION AVAILABLE BUT NO GUARANTEE IS GIVEN THAT ALL EXISTING UTILITIES ARE SHOWN OR THAT THE GIVEN LOCATIONS ARE EXACT. CONFIRMATION OF EXISTENCE AND EXACT LOCATION OF ALL SERVICES MUST BE OBTAINED FROM THE INDIVIDUAL UTILITIES BEFORE PROCEEDING WITH CONSTRUCTION.

NO.	REVISIONS	DATE	BY
0	ISSUED FOR TENDER	11/07/04	

DESIGNED BY	JDF	CHECKED BY	MCR
DRAWN BY	DMW	APPROVED BY	RJH
HOR. SCALE:	1:250	RELEASED FOR CONSTRUCTION:	
VERTICAL:	1:50	DATE	2011/03/09

ENGINEER'S SEAL

J.D. PRIESEN
Member
23879
PROFESSIONAL ENGINEER

THE CITY OF WINNIPEG
PUBLIC WORKS DEPARTMENT
TRANSPORTATION ENGINEERING DIVISION

PROJECT TITLE
CORYDON AVENUE EASTBOUND PAVEMENT RECONSTRUCTION
CORYDON AVENUE
LANARK STREET TO BOREBANK STREET
STA 3+25 TO STA. 4+00

SHEET OF
04 OF **13**

COMPUTER FILE NAME
CORYDON-PLOT

CITY DRAWING NUMBER
P-3328-04

CONSULTANT DRAWING NO.
11-0107-08_04

APEGM
Certificate of Authorization
KGS Group
No. 245