

PAVEMENT PROFILE
SCALE: 1:250 HOR
1:10 VER

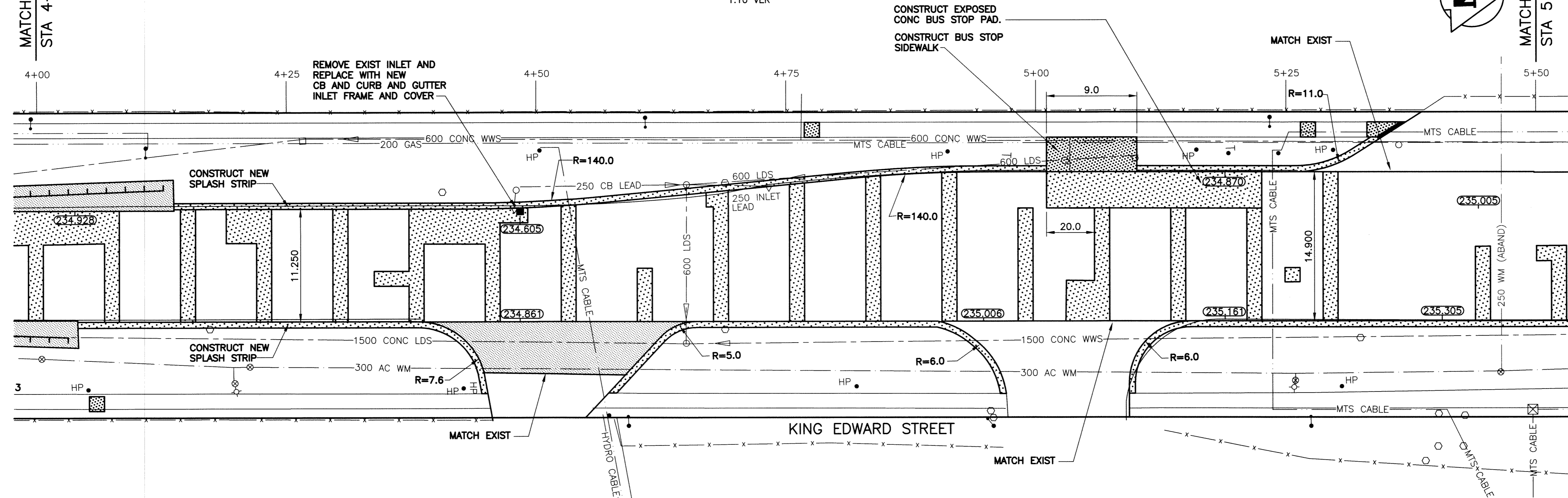

PAVEMENT PLAN
SCALE: 1:250 HOR

- GENERAL NOTES:**
1. STATION CHAINAGE IS BASED ON CENTRELINE OF KING EDWARD STREET
 2. ADJUST MH AND CB RIMS TO NEW GRADES
 3. DESIGN GRADES TO BE CONFIRMED BY KGS GROUP AFTER ASPHALT PLANING OF EACH LANE.
 4. AVOID DAMAGE TO EXISTING TREES WITHIN THE LIMITS OF CONSTRUCTION.
 5. ISOLATE ALL POLES, BASES AND PILES WITHIN BUS STOP SIDEWALK (SD-228C).
 6. ALL PAVEMENT MEASUREMENTS ARE TO BACK OF CURB.

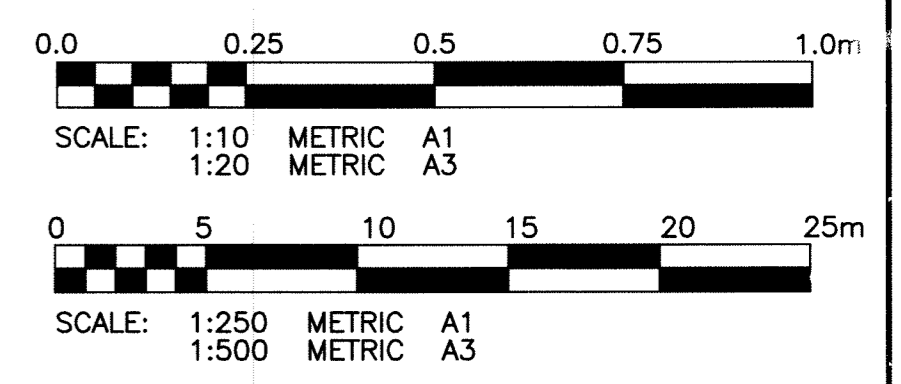

- NOTE:**
1. STATION CHAINAGE IS BASED ON CENTRELINE OF STREET RIGHT OF WAY.
 2. ADJUST MH AND CB RIMS TO NEW GRADES.
 3. PLUG SUBDRAINS AT TERMINAL ENDS.
 4. REGRADE EXISTING SIDEWALKS AS REQUIRED.
 5. ISOLATE ALL POLES, BASES AND PILES WITHIN RIGHT OF WAY

PROPERTY LIMITS DELINEATION
DELINEATION OF PROPERTY LIMITS AS SHOWN ON THIS DWG DOES NOT REPRESENT A "LEGAL SURVEY". KGS GROUP MAKES NO REPRESENTATION OR WARRANTY AS TO THE ACCURACY OF PROPERTY LIMITS DELINEATED ON THIS DWG, NOR ON THE DIMENSIONAL ACCURACY OF DWG FEATURES RELATIVE TO THOSE PROPERTY LIMITS.

METRIC
WHOLE NUMBERS INDICATE MILLIMETRES
DECIMALIZED NUMBERS INDICATE METRES



P:\Projects\2011\11-0107-08\DocControl\Released\DWG\P-3328-08-Rev. 0.dwg - Tab: 08 Plotted By: DDenoché 07/04/2011 [Mon 1:37pm]

300 LDS	LAND DRAINAGE SEWER	300 LDS	TEST HOLE					
250 WWS	WASTE WATER SEWER	250 WWS	GUY WIRE					
	GAS		LIGHT STANDARD					
	HYDRO		BACK OF CURB					
	M.T.S.		CONCRETE					
150 WM	WATERMAIN	150 WM	ASPHALT	EXISTING				
	HYDRANT		SIDEWALK					
	VALVE		RAMP CURB					
	MANHOLE		PROPERTY LINE					
	CATCH BASIN		SURVEY BAR					
	CURB INLET		GEODETIC BENCHMARK					
	POLES		ELEVATION					
EXISTING	LEGEND-PLAN	PROPOSED	EXISTING	LEGEND-PROFILE	PROPOSED	EXISTING	LEGEND-PROFILE	PROPOSED

LOCATION APPROVED UNDERGROUND STRUCTURES
SUPV. U/G STRUCTURES COMMITTEE DATE
NOTE: LOCATION OF UNDERGROUND STRUCTURES AS SHOWN ARE BASED ON THE BEST INFORMATION AVAILABLE BUT NO GUARANTEE IS GIVEN THAT ALL EXISTING UTILITIES ARE SHOWN OR THAT THE GIVEN LOCATIONS ARE EXACT. CONFIRMATION OF EXISTENCE AND EXACT LOCATION OF ALL SERVICES MUST BE OBTAINED FROM THE INDIVIDUAL UTILITIES BEFORE PROCEEDING WITH CONSTRUCTION.

B.M. ELEV.	
ISSUED FOR TENDER	11/07/04
NO. REVISIONS	DATE BY

KGS GROUP CONSULTING ENGINEERS

DESIGNED BY: JDF
DRAWN BY: DMW
HOR. SCALE: 1:250
VERTICAL: 1:50
DATE: 2011/03/09

CHECKED BY: RJH
APPROVED BY:
RELEASED FOR CONSTRUCTION:
DATE:

ENGINEER'S SEAL
Member 23875
CONSULTANT DRAWING NO. 11-0107-08_08

THE CITY OF WINNIPEG PUBLIC WORKS DEPARTMENT TRANSPORTATION ENGINEERING DIVISION

PROJECT TITLE: KING EDWARD STREET SOUTHBOUND PAVEMENT REHABILITATION
SASKATCHEWAN AVE TO DUBLIN AVE STA 4+00 TO STA. 5+50

SHEET 08 OF 13
COMPUTER FILE NAME: KING EDWARD-PL0T
CITY DRAWING NUMBER: P-3328-08