

File Name: P:\Projects\2011\11-0107-25\Doc.Control\ToBeIssued\DWG\11-0107-25_0001-Rev 0.dwg - Tab: 01 Plotted By: Gloewen 11/08/29 [Mon 4:16pm]
 A1/PLOT SCALE

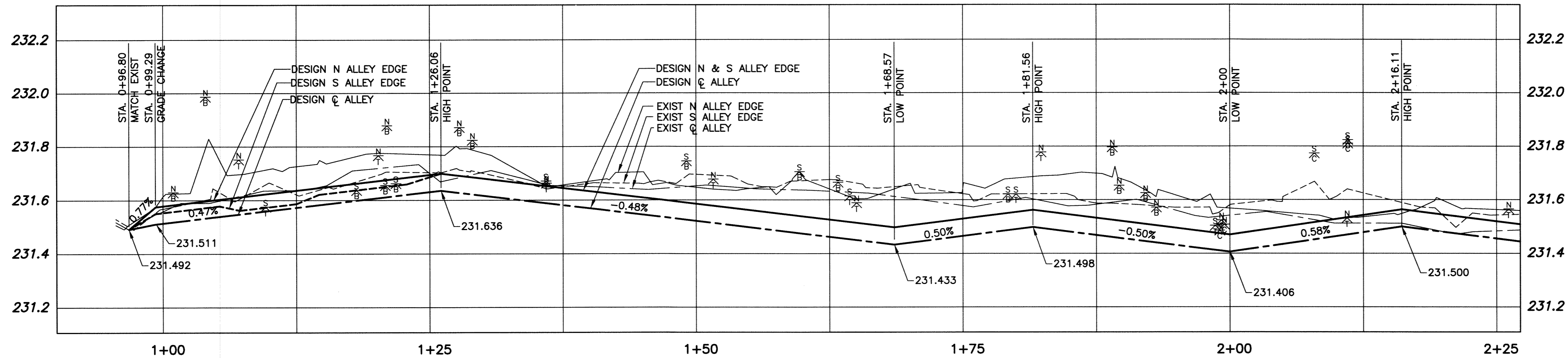

ALLEY PAVEMENT PROFILE
 SCALE: HOR 1:250
 VER 1:10

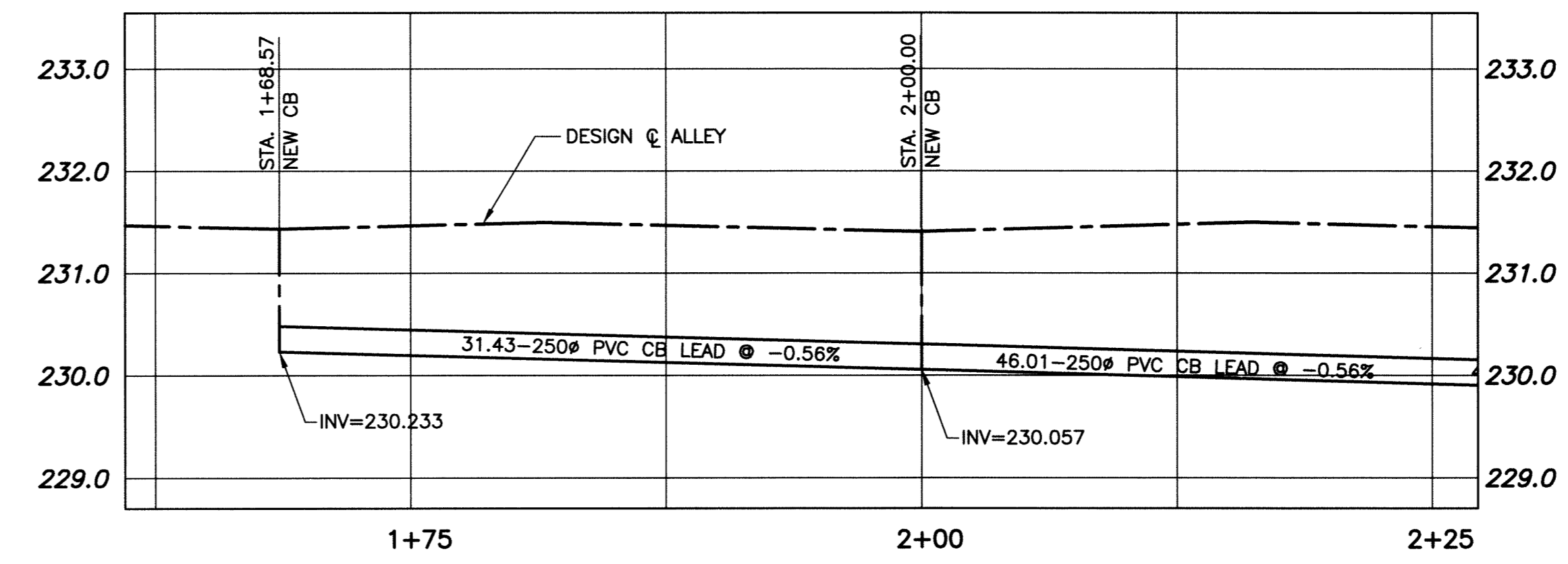

CATCH BASIN & CATCH BASIN LEAD PROFILE
 SCALE: HOR 1:250
 VER 1:50

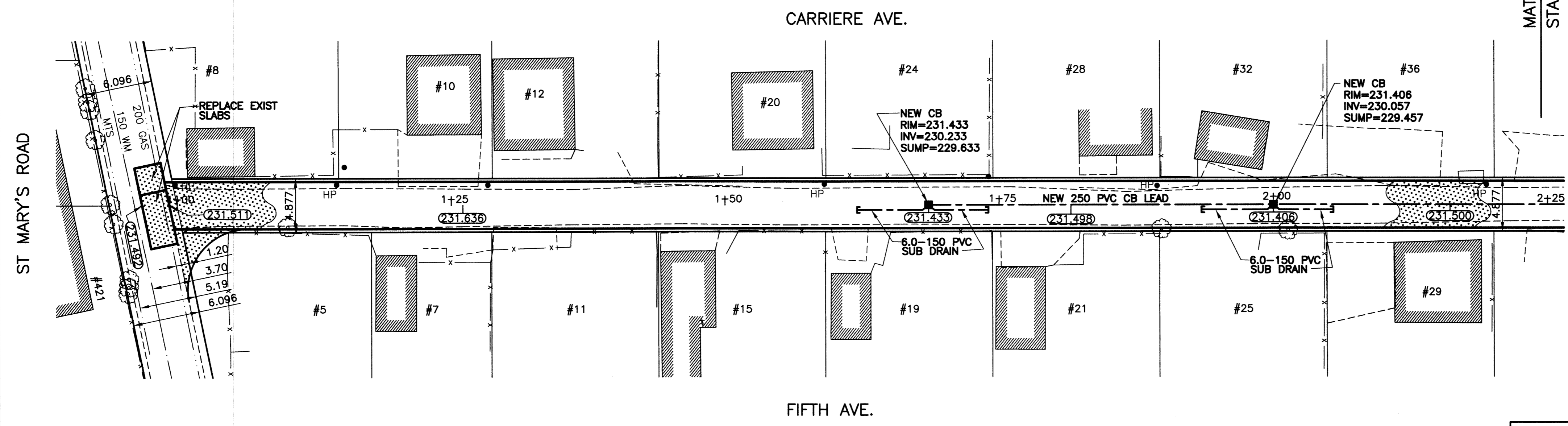

ALLEY PAVEMENT PLAN
 SCALE: HOR 1:250

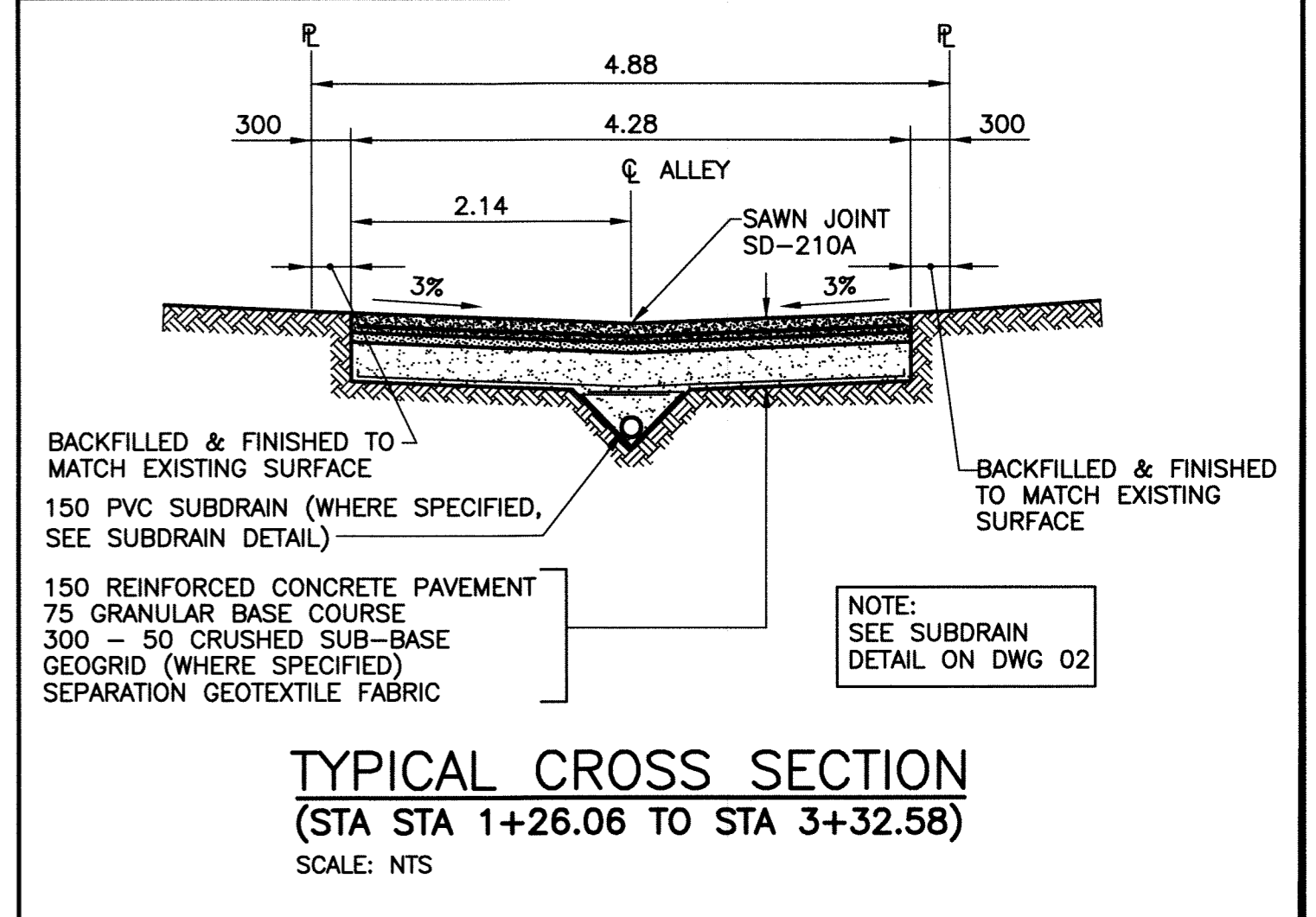
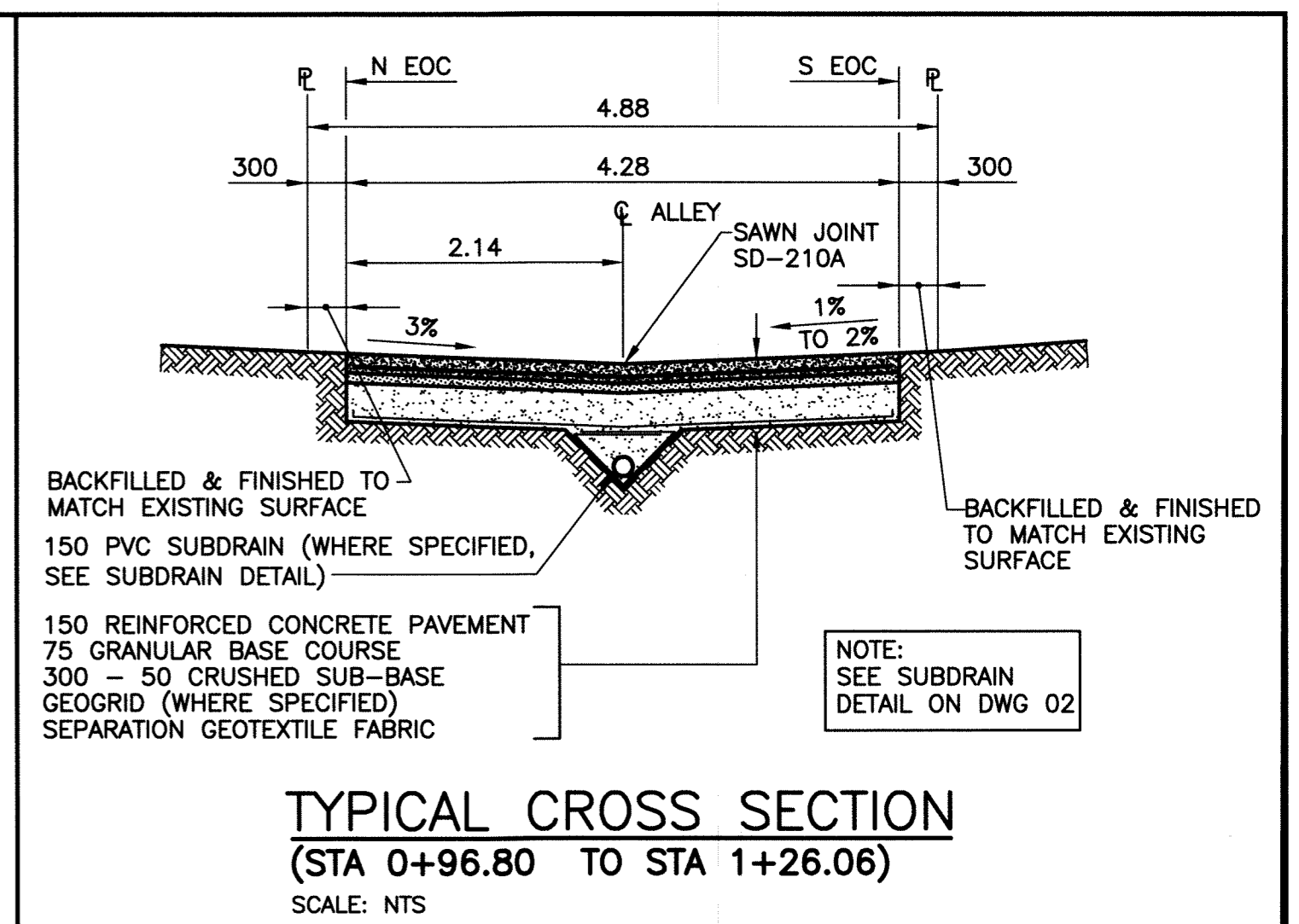

- NOTE:**
1. STATION CHAINAGE IS BASED ON CENTERLINE OF ALLEY RIGHT OF WAY.
 2. ADJUST MH AND CB RIMS TO NEW GRADES.
 3. PLUG SUBDRAINS AT TERMINAL ENDS.
 4. REGRADE EXISTING PRIVATE SIDEWALKS AS REQUIRED.
 5. LIP CURB TO BE INSTALLED AT 29 FIFTH AVE & 43 FIFTH AVE. INSTALLATION OF LIP CURBS AND THEIR EXTENTS TO BE DETERMINED BY THE CONTRACT ADMINISTRATOR.
 6. LIGHT STANDARDS, HYDRO POLES AND ANCHORS MAY REQUIRE TEMPORARY SUPPORT/REMOVAL OR REPLACEMENT AT THE CONTRACTOR'S EXPENSE.
 7. ISOLATE ALL POLES, BASES AND PILES WITHIN ALLEY RIGHT OF WAY (SD-228C).
 8. AVOID DAMAGE TO EXISTING TREES WITHIN THE LIMITS OF CONSTRUCTION.

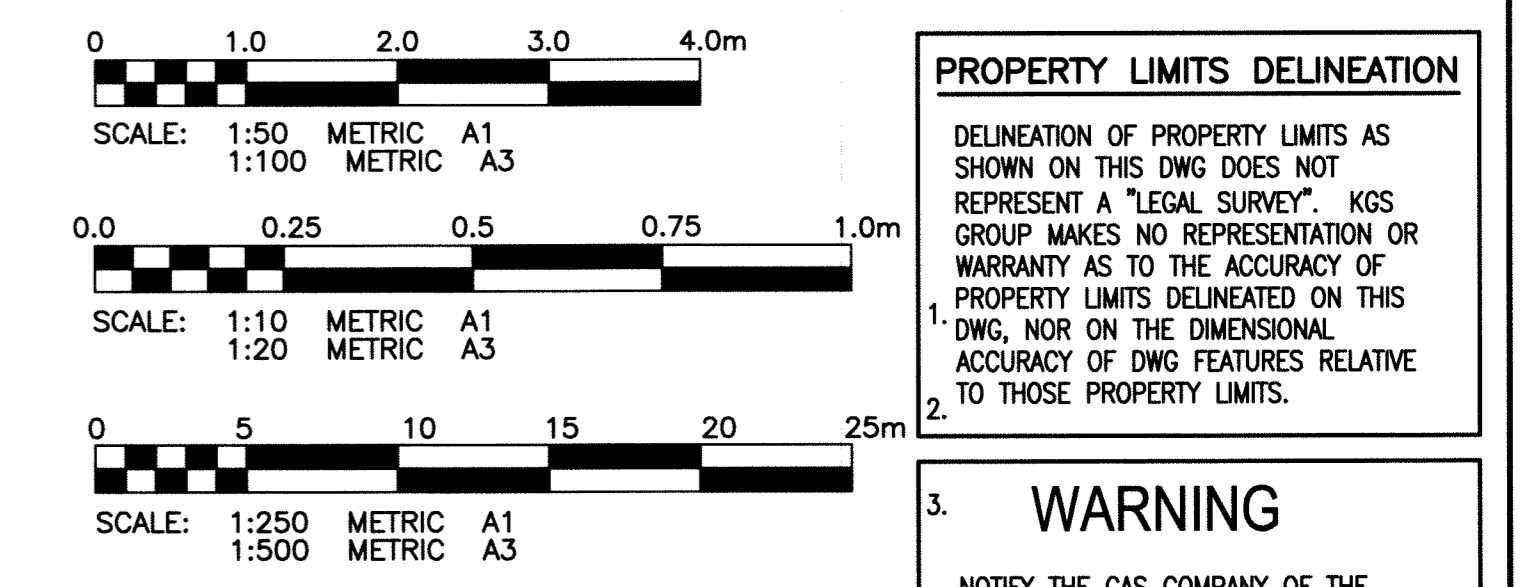

METRIC
 WHOLE NUMBERS INDICATE MILLIMETRES
 DECIMALIZED NUMBERS INDICATE METRES

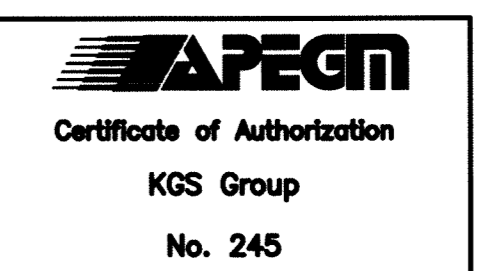

WARNING
 NOTIFY THE GAS COMPANY OF THE PROPOSED LOCATION OF EXCAVATION.
 TAKE PRECAUTION TO AVOID DAMAGE TO GAS COMPANY INSTALLATIONS.
 SEE PROVINCIAL REGULATION 210/72 FOR DETAILS.

| EXISTING | LEGEND-PLAN | PROPOSED | EXISTING | LEGEND-PLAN | PROPOSED | EXISTING | LEGEND-PROFILE | PROPOSED |
|----------|---------------------|----------|--------------------|-------------|----------|----------------|----------------|----------|
| 300 LBS | LAND DRAINAGE SEWER | 300 LBS | TEST HOLE | | | | | |
| 250 WWS | WASTE WATER SEWER | 250 WWS | GUY WIRE | | | | | |
| | GAS | | LIGHT STANDARD | | | S/E TOPO | | |
| | HYDRO | | BACK OF CURB | | | N/W TOPO | | |
| | M.T.S. | | CONCRETE | | | S/E BLDG | | |
| 150 WM | WATERMAIN | 150 WM | ASPHALT | | | N/W BLDG | | |
| | HYDRANT | | SIDEWALK | | | S/E CONCRETE | | |
| | VALVE | | PROPERTY LINE | | | N/W CONCRETE | | |
| | MANHOLE | | SURVEY BAR | | | Q PROFILE | | |
| | CATCH BASIN | | GEODETIC BENCHMARK | | | N/W ALLEY EDGE | | |
| | CURB INLET | | ELEVATION | | | S/E ALLEY EDGE | | |
| | POLES | | | | | | | |

LOCATION APPROVED UNDERGROUND STRUCTURES
 SUPV. U/G STRUCTURES COMMITTEE DATE
 NOTE: LOCATION OF UNDERGROUND STRUCTURES AS SHOWN ARE BASED ON THE BEST INFORMATION AVAILABLE BUT NO GUARANTEE IS GIVEN THAT ALL EXISTING UTILITIES ARE SHOWN OR THAT THE GIVEN LOCATIONS ARE EXACT. CONFIRMATION OF EXISTENCE AND EXACT LOCATION OF ALL SERVICES MUST BE OBTAINED FROM THE INDIVIDUAL UTILITIES BEFORE PROCEEDING WITH CONSTRUCTION.

| NO. | REVISIONS | DATE | BY |
|-----|-------------------|----------|-----|
| 0 | ISSUED FOR TENDER | 11/08/29 | RBO |

KGS GROUP CONSULTING ENGINEERS
 DESIGNED BY: RBO
 CHECKED BY: RJH
 DRAWN BY: DMW
 APPROVED BY: RJH
 HOR. SCALE: 1:250
 VERTICAL: 1:50
 RELEASED FOR CONSTRUCTION: 11/09/15

ENGINEER'S SEAL
 R.B. OFFMAN
 CONSULTANT DRAWING NO. 11-0107-25_01

THE CITY OF WINNIPEG PUBLIC WORKS DEPARTMENT ENGINEERING SERVICES DIVISION
 PROJECT TITLE: 2011 ALLEY RENEWAL PROGRAM
 SHEET OF: 01 OF 03
 COMPUTER FILE NAME: FIFTH_CARRIER
 CITY DRAWING NUMBER: 0001
 ST. MARY'S RD. TO DES MEURONS ST. STA. 0+96.80 TO STA. 2+25