

CHAINAGE ALONG CENTER OF ROW

SUNSET / GLENLAWN ALLEY LDS

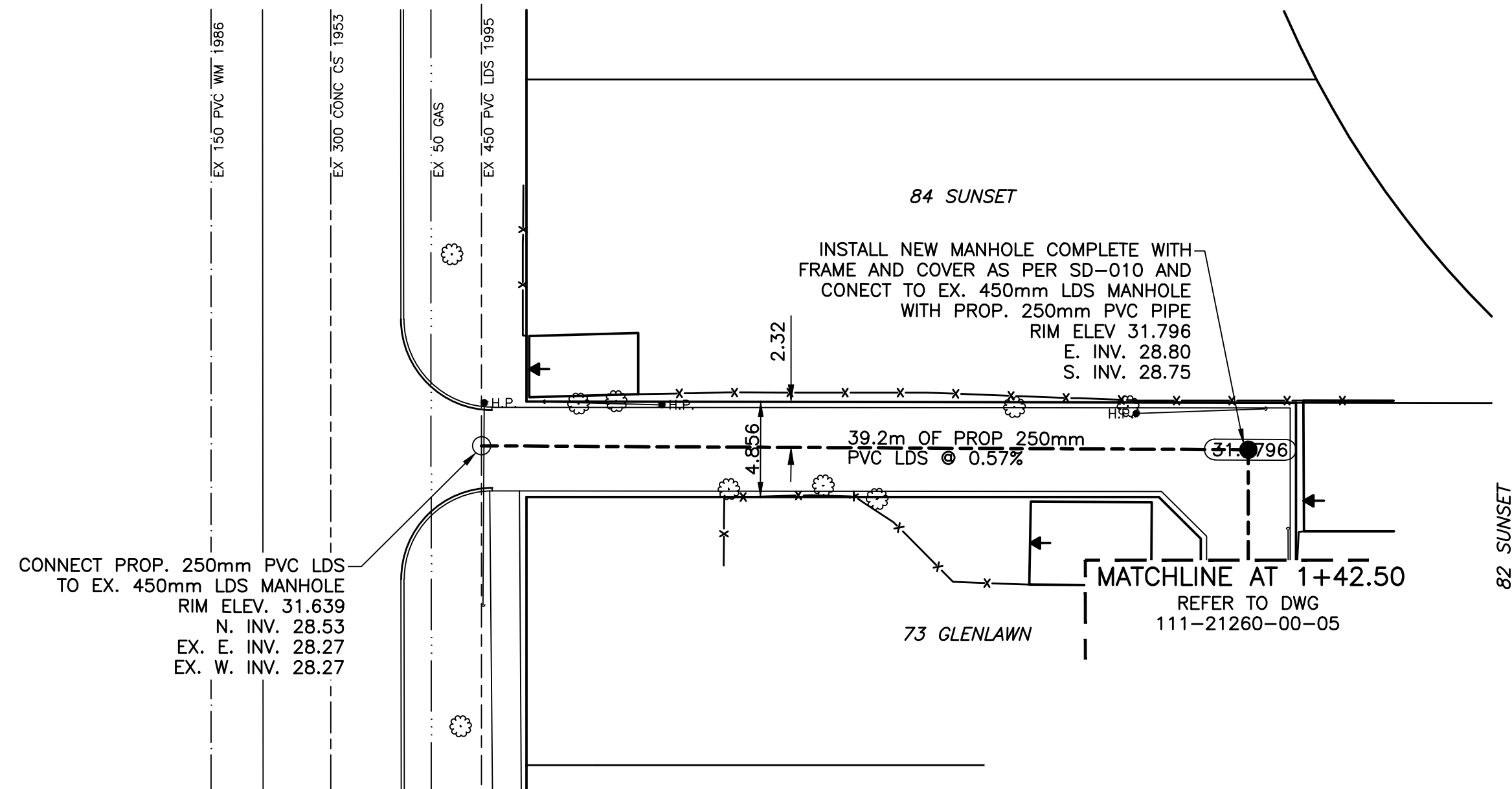
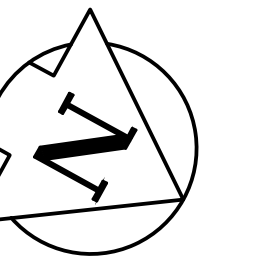

"Description of property limits, and existing and/or proposed features relative to these limits as shown on this drawing do not represent a Legal Survey. GENIVAR makes no representation or guarantee that the property limit information is accurate. GENIVAR accepts no responsibility for damages, if any, suffered by any third party as a result of decisions made or actions based on this drawing."

DESCRIPTION
S.E. COR. FERROV AVE & DUNKIRK DR., TBLT.
ON TOP OF 0.05m DIA. X 2.4m IRON PIPE, 27.5m N.
OF S.L. OF LANE N. OF GLEN AVE. & 4.4m W. OF E.L.
(FENCE LINE) OF LAST HOUSE ON N. SIDE OF GLEN AVE.

EXISTING	LEGEND - PLAN	PROPOSED	EXISTING	LEGEND - PLAN	PROPOSED	EXISTING	LEGEND - PROFILE	PROPOSED
	WATERMAIN			M.T.S.			WATERMAIN VALVE	
	HYDRANT			TRAFFIC SIGNAL			LAND DRAINAGE SEWER	
	VALVE			CONCRETE/ASPHALT			WASTE WATER SEWER	
	CURB STOP			SIDEWALK			CENTERLINE	
	WASTE WATER SEWER			CURB RAMP			SOUTH & EAST GUTTER	
	LAND DRAINAGE SEWER			PROPERTY LINE			NORTH & WEST GUTTER	
	C.B. LEAD			ELEVATIONS				
	MANHOLE			TEST HOLE LOCATION				
	CATCH BASIN			GARAGE DOOR LOCATION				
	GAS							

LOCATION APPROVED UNDERGROUND STRUCTURES

SUPV. U/G STRUCTURES DATE COMMITTEE

NOTE:
LOCATION OF UNDERGROUND STRUCTURES AS SHOWN ARE BASED ON THE BEST INFORMATION AVAILABLE BUT NO GUARANTEE IS GIVEN THAT ALL EXISTING UTILITIES ARE SHOWN OR THAT THE GIVEN LOCATIONS ARE EXACT. CONFIRMATION OF EXISTENCE AND EXACT LOCATION OF ALL SERVICES MUST BE OBTAINED FROM THE INDIVIDUAL UTILITIES BEFORE PROCEEDING WITH CONSTRUCTION.

B.M. ELEV.	54-026	231.638
NO.	REVISIONS	DATE BY
3	ADDENDUM 1 DRAWING	31/08/11 R.H.
2	TENDER DRAWING	19/08/11 R.H.
1	SUBMISSION	15/08/11 R.H.

GENIVAR
10 PRAIRIE WAY WINNIPEG, MANITOBA R2J 3J8
PH: (204)-233-2113 FAX: (204)-233-2080

DESIGNED BY	R.H.	CHECKED BY	S.M.
DRAWN BY	R.H.	APPROVED BY	I.McK.
HOR. SCALE:	1:250	RELEASED FOR CONSTRUCTION	NOT RELEASED
VERT. SCALE:	1:50	DATE	
DATE	AUGUST 2011	DATE	

ENGINEERS SEAL

CONSULTANT DRAWING NO.
111-21260-00 -04

THE CITY OF WINNIPEG
WATER AND WASTE DEPARTMENT

2011 LOCAL IMPROVEMENTS

SUNSET / GLENLAWN ALLEY

FROM EX. MANHOLE AT STA. 0+97.69 TO MATCHLINE AT STA 1+42.50

LAND DRAINAGE SEWER

CITY DRAWING NO.
SHEET 4 OF 5

699-2011