

CHAINAGE ALONG CENTER OF ROW

SUNSET / GLENLAWN ALLEY LDS

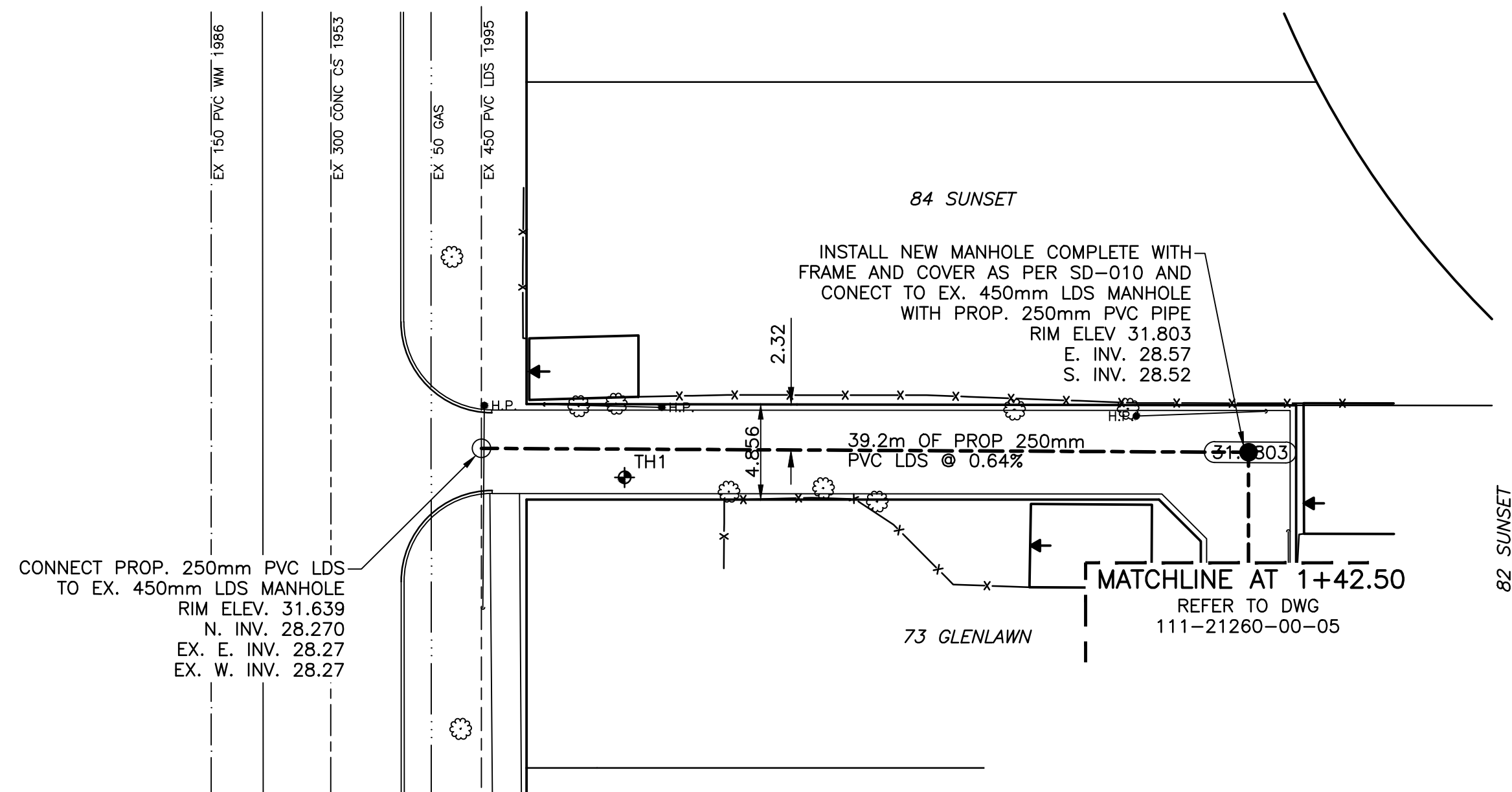
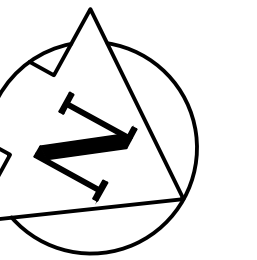

"Description of property limits, and existing and/or proposed features relative to these limits as shown on this drawing do not represent a Legal Survey. GENIVAR makes no representation or guarantee that the property limit information is accurate. GENIVAR accepts no responsibility for damages, if any, suffered by any third party as a result of decisions made or actions based on this drawing."

DESCRIPTION  
S.E. COR. FERROV AVE. & DUNKIRK DR., TBLT.  
ON TOP OF 0.05m DIA. X 2.4m IRON PIPE, 27.5m N.  
OF S.L. OF LANE N. OF GLEN AVE. & 4.4m W. OF E.L.  
(FENCE LINE) OF LAST HOUSE ON N. SIDE OF GLEN AVE.

EXISTING	LEGEND - PLAN	PROPOSED	EXISTING	LEGEND - PLAN	PROPOSED	EXISTING	LEGEND - PROFILE	PROPOSED
	WATERMAIN		M.T.S.		WATERMAIN		WATERMAIN	
	HYDRANT		TRAFFIC SIGNAL		VALVE		LAND DRAINAGE SEWER	
	VALVE		CONCRETE/ASPHALT		LAND DRAINAGE SEWER		WASTE WATER SEWER	
	CURB STOP		SIDEWALK		SOUTH & EAST GUTTER		NORTH & WEST GUTTER	
	WASTE WATER SEWER		CURB RAMP		CENTERLINE		SOUTH & EAST GUTTER	
	LAND DRAINAGE SEWER		PROPERTY LINE		SOUTH & EAST GUTTER		NORTH & WEST GUTTER	
	C.B. LEAD		ELEVATIONS		SOUTH & EAST GUTTER		NORTH & WEST GUTTER	
	MANHOLE		TEST HOLE LOCATION		SOUTH & EAST GUTTER		NORTH & WEST GUTTER	
	CATCH BASIN		GARAGE DOOR LOCATION		SOUTH & EAST GUTTER		NORTH & WEST GUTTER	
	GAS							

LOCATION APPROVED UNDERGROUND STRUCTURES

SUPV. U/G STRUCTURES DATE COMMITTEE

NOTE:  
LOCATION OF UNDERGROUND STRUCTURES AS SHOWN ARE BASED ON THE BEST INFORMATION AVAILABLE BUT NO GUARANTEE IS GIVEN THAT ALL EXISTING UTILITIES ARE SHOWN OR THAT THE GIVEN LOCATIONS ARE EXACT. CONFIRMATION OF EXISTENCE AND EXACT LOCATION OF ALL SERVICES MUST BE OBTAINED FROM THE INDIVIDUAL UTILITIES BEFORE PROCEEDING WITH CONSTRUCTION.

NO.	REVISIONS	DATE	BY
2	TENDER DRAWING	19/08/11	R.H.
1	SUBMISSION	15/08/11	R.H.

**GENIVAR**  
10 PRAIRIE WAY WINNIPEG, MANITOBA R2J 3J8  
PH: (204)-233-2113 FAX: (204)-233-2080

DESIGNED BY: R.H. CHECKED BY: S.M.  
DRAWN BY: R.H. APPROVED BY: I.McK.  
HOR. SCALE: 1:250  
VERT. SCALE: 1:50  
DATE: AUGUST 2011  
RELEASED FOR CONSTRUCTION: NOT RELEASED

ENGINEERS SEAL

CONSULTANT DRAWING NO. 111-21260-00-04

**THE CITY OF WINNIPEG**  
WATER AND WASTE DEPARTMENT

2011 LOCAL IMPROVEMENTS  
SUNSET / GLENLAWN ALLEY  
FROM EX. MANHOLE AT STA. 0+97.69 TO MATCHLINE AT STA 1+42.50  
LAND DRAINAGE SEWER

CITY DRAWING NO. SHEET 4 OF 5  
699-2011