

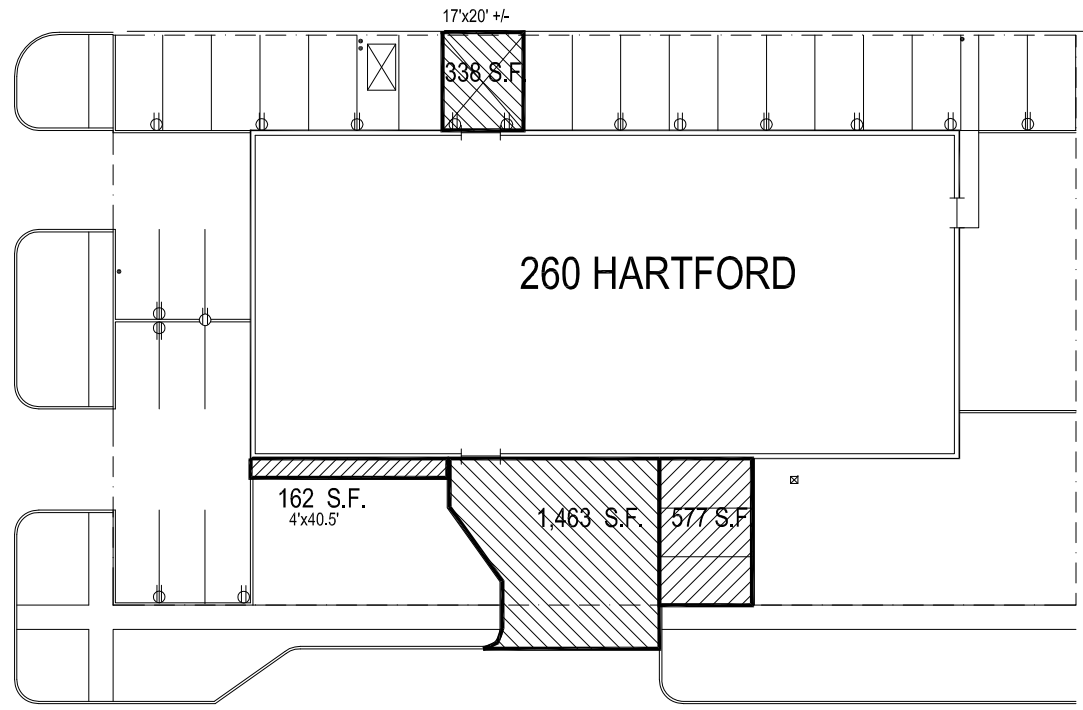



NOTES :

AREA OF SNOW REMOVAL = 2,540 SQ.FT. 



No.	REVISION/DESCRIPTION	BY	DATE
SEALS			

DRAWN BY:	TC	CHECKED BY:	APPROVED:
DATE:	2011.09.26	USER APPROVAL:	

 THE CITY OF WINNIPEG
 PLANNING, PROPERTY AND
 DEVELOPMENT DEPARTMENT
 3-65 GARRY STREET
 R3C 4K4

PROJECT:
 North-East District
 Police Station
 260 Hartford Avenue

SHEET TITLE:
 SITE PLAN-SNOW REMOVAL
 0260hfsp

SCALE:	PROJECT No.:	SHEET No.:
N.T.S.	817-2011	