

COORDINATE TABLE (SEE DETAIL A FOR POINT LOCATIONS)

NORTH FORCEMAIN			SOUTH FORCEMAIN		
Point Number	Northing	Easting	Point Number	Northing	Easting
301	5529377.004	635926.238	401	5529374.709	635925.615
302	5529377.210	635925.259	402	5529374.851	635923.958
303	5529375.059	635921.592	403	5529372.795	635921.065
304	5529374.136	635920.112	404	5529371.357	635918.122
305	5529373.723	635918.154	405	5529369.527	635916.492
306	5529373.856	635918.416	406	5529370.058	635914.044
307	5529375.056	635915.476	407	5529370.341	635913.001
308	5529377.453	635905.795	408	5529370.072	635913.983
309	5529380.044	635896.092	409	5529372.411	635904.244
310	5529382.709	635886.451	410	5529374.744	635894.504
311	5529385.354	635876.805	411	5529377.113	635884.775
312	5529388.224	635867.225	412	5529380.051	635875.216
313	5529391.264	635857.697	413	5529383.042	635865.673
314	5529394.240	635848.150	414	5529386.026	635856.128
315	5529397.412	635838.661	415	5529389.236	635846.650
316	5529400.586	635829.173	416	5529392.539	635837.201
317	5529403.761	635819.685	417	5529395.839	635827.763
318	5529406.934	635810.196	418	5529399.310	635818.351

COORDINATE TABLE (SEE DETAIL A FOR POINT LOCATIONS)

NORTH FORCEMAIN			SOUTH FORCEMAIN		
Point Number	Northing	Easting	Point Number	Northing	Easting
319	5529410.196	635800.734	419	5529402.710	635808.931
320	5529413.523	635791.292	420	5529405.993	635799.475
321	5529416.729	635781.813	421	5529409.257	635790.014
322	5529419.821	635772.301	422	5529412.716	635780.611
323	5529422.761	635762.742	423	5529416.076	635771.178
324	5529425.637	635753.165	424	5529419.167	635761.665
325	5529428.578	635743.607	425	5529422.295	635752.163
326	5529431.580	635734.067	426	5529425.459	635742.672
327	5529434.726	635724.570	427	5529428.915	635733.269
328	5529438.063	635715.131	428	5529432.627	635723.941
329	5529441.515	635705.726	429	5529436.382	635714.627
330	5529444.834	635696.281	430	5529439.889	635705.239
331	5529448.354	635686.886	431	5529443.150	635695.778
332	5529452.165	635677.599	432	5529446.660	635686.389
333	5529455.876	635668.272	433	5529449.663	635676.849
334	5529463.438	635658.715	434	5529451.407	635667.090
335	5529464.284	635655.715	435	5529452.724	635657.570
336	5529464.786	635654.028	436	5529463.329	635653.407
337	5529465.182	635652.158	437	5529463.720	635652.557
			438	5529463.973	635651.947
			439	5529464.609	635651.430

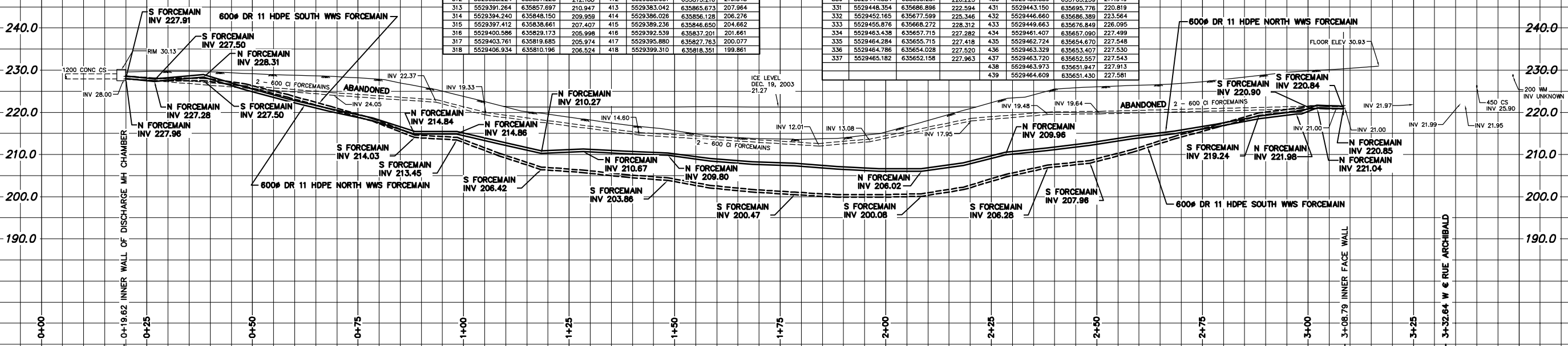

NOTE: CHAINAGES SHOWN ARE ALONG ? OF EXISTING 2-600 STEEL PIPES

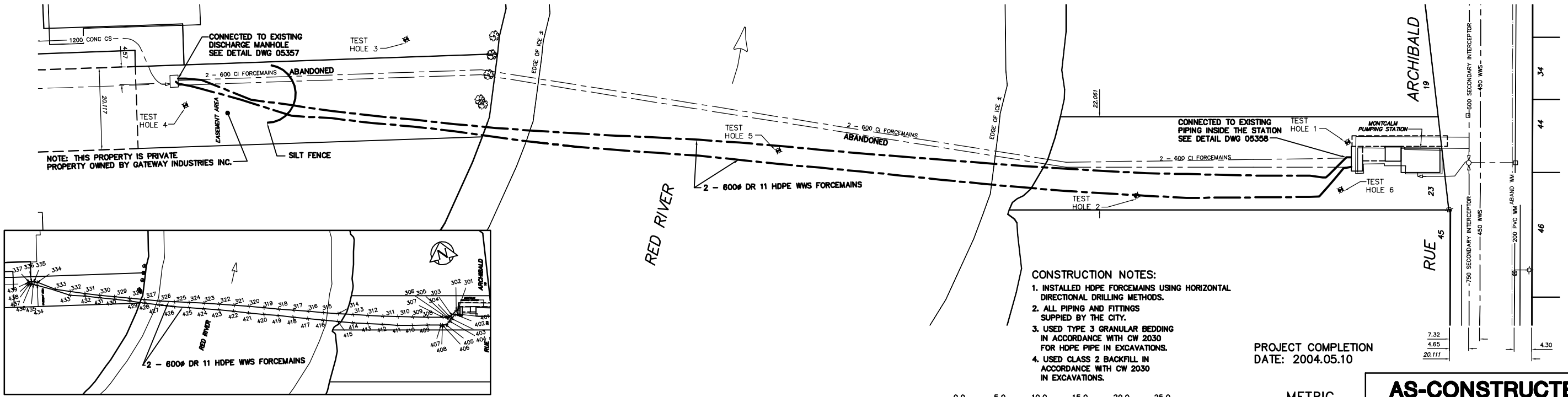

- CONSTRUCTION NOTES:**
1. INSTALLED HDPE FORCEMAINS USING HORIZONTAL DIRECTIONAL DRILLING METHODS.
 2. ALL PIPING AND FITTINGS SUPPLIED BY THE CITY.
 3. USED TYPE 3 GRANULAR BEDDING IN ACCORDANCE WITH CW 2030 FOR HDPE PIPE IN EXCAVATIONS.
 4. USED CLASS 2 BACKFILL IN ACCORDANCE WITH CW 2030 IN EXCAVATIONS.

PROJECT COMPLETION DATE: 2004.05.10

AS-CONSTRUCTED
WATER AND WASTE DEPARTMENT

EXISTING	LEGEND-PLAN	PROPOSED	EXISTING	LEGEND-PLAN	PROPOSED	EXISTING	LEGEND-PROFILE	PROPOSED
200 WM	WATERMAIN	200 WM	SL, HYDRO	50 GAS	50 GAS	150 WM	WATERMAIN	150 WM
525 LDS	LAND DRAINAGE SEWER	525 LDS	TRAFFIC SIGNALS	300 LDS	300 LDS	300 LDS	LAND DRAINAGE SEWER	300 LDS
375 WWS	WASTEWATER SEWER	375 WWS	SURVEY BAR	250 WWS	250 WWS	250 WWS	WASTEWATER SEWER	250 WWS
○	MANHOLE	●	FENCE	○	○	○	PROFILE	○
□	CATCH BASIN	■	POLE - HYDRO, MTS	○	○	○	GROUND ABOVE PIPE	○
▽	CURB INLET	▽	CURB STOP	○	○	○		○
+	JUNCTIONS	+	GUY ANCHOR	○	○	○		○
—	CULVERT	—	LIGHT STANDARD	○	○	○		○
○	ANODE	○	TREE	○	○	○		○

LOCATION APPROVED
UNDERGROUND STRUCTURES

SUPV. U/G STRUCTURES COMMITTEE DATE

NOTE:
LOCATION OF UNDERGROUND STRUCTURES AS SHOWN ARE BASED ON THE BEST INFORMATION AVAILABLE BUT NO GUARANTEE IS GIVEN THAT ALL EXISTING UTILITIES ARE SHOWN OR THAT THE GIVEN LOCATIONS ARE EXACT. CONFIRMATION OF EXISTENCE AND EXACT LOCATION OF ALL SERVICES MUST BE OBTAINED FROM THE INDIVIDUAL UTILITIES BEFORE PROCEEDING WITH CONSTRUCTION.

NO.	REVISIONS	DATE	BY
2.)	REVISED TO AS-CONSTRUCTED	04.10.01	WKT/CJH
1.)	CHANGED SOUTH PIPE ALIGNMENT	04.01.23	WKT

CITY OF WINNIPEG
WATER AND WASTE
ENGINEERING DIVISION

DESIGNED BY: JE
CHECKED BY: JE

DRAWN BY: WKT
APPROVED BY: KZ

HOR. SCALE: 1:500
VERTICAL: 1:500

DATE: 2004 01 15

ENGINEER'S SEAL
ORIGINAL MYLAR SIGNED BY
K.R. ZUREK
04/10/07

THE CITY OF WINNIPEG
WATER AND WASTE DEPARTMENT

MONTCALM SEWAGE PUMPING STATION

FORCEMAIN REPLACEMENT

SHEET 1 OF 4
CITY DRAWING NUMBER
05356

TENDER No. 16-2004
FILENAME: 05356.DWG
PLOT DATE: 2004 10 01