

HILL STREET

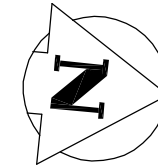

SEWER JUNCTION INFORMATION  
FOR SEWER ID MA50007514  
REFERENCE—METERS SOUTH OF MANHOLE MH50006432

DIST. FROM REF. MH	JUNCTION DIA.	CLOCK REF.	SERVICE TYPE	DESCRIPTION
9.7	150	11	CN	
16.5	150	12	CXI	LIVE
18.5	150	01	CN	LIVE
20.7	150	11	CNI	
34.5	150	01	CNI	LIVE
37.5	150	11	CN	LIVE
45.9	150	11	CN	LIVE
55.3	150	01	CN	LIVE
60.8	150	11	CN	LIVE
71.7	150	11	CN	LIVE
75.4	150	12	CNI	LIVE
77.3	200	11	CNI	LIVE
85.2	150	12	CN	LIVE
88.5	150	11	CN	LIVE

ALL JUNCTION INFORMATION  
BASED ON CCTV INSPECTION

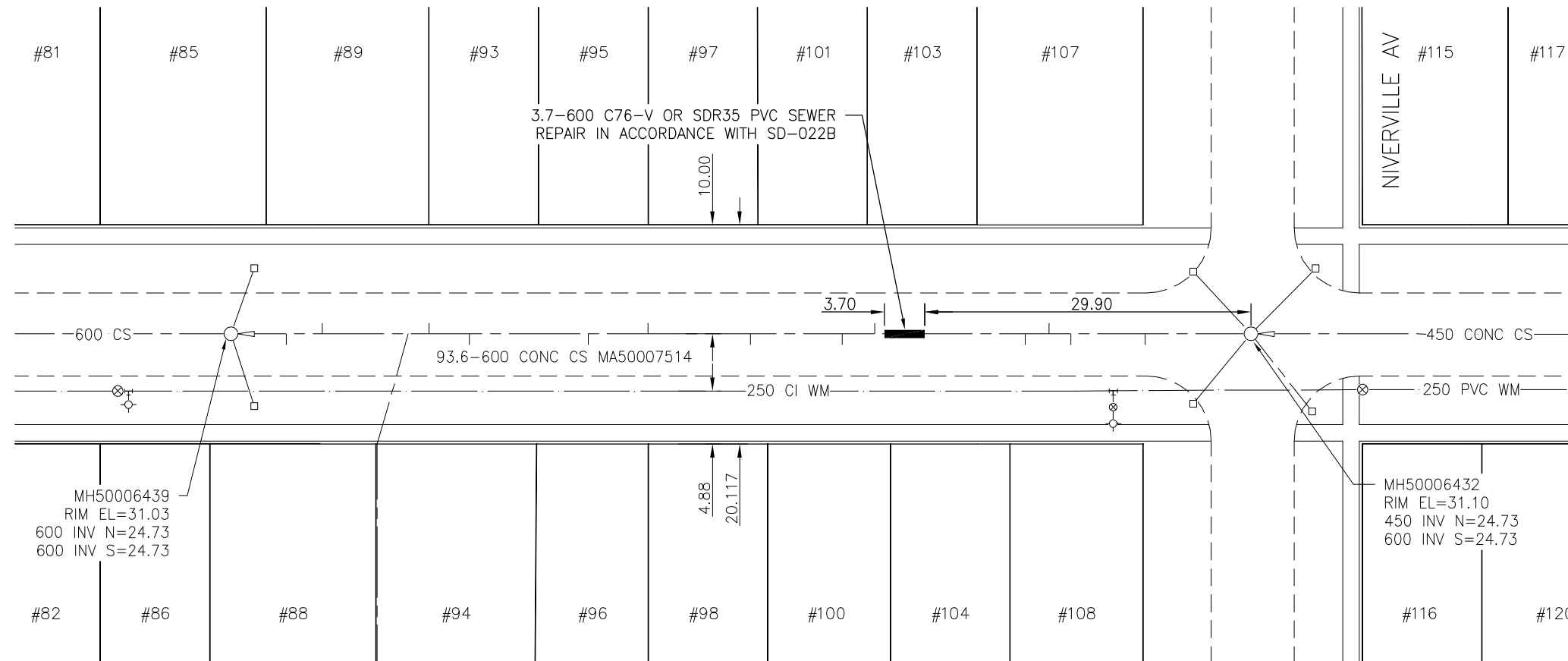

**METRIC**

WHOLE NUMBERS INDICATE MILLIMETRES  
DECIMALIZED NUMBERS INDICATE METRES

BENCH MARK: N.E. Cor. Rue Des Meurons & Dubuc St., Tblt. in W. Conc. foundation of No. 361 Dubuc St., 0.5 m N. & 0.5 m below cedar siding of the S.W. Cor. of dwelling.



Certificate of Authorization  
Stantec Consulting Ltd.  
No. 1301 Date: \_\_\_\_\_

BID OPPORTUNITY 911-2011

**LOCATION APPROVED UNDERGROUND STRUCTURES**

SUPV. U/G STRUCTURES COMMITTEE DATE

NOTE:  
LOCATION OF UNDERGROUND STRUCTURES AS SHOWN ARE BASED ON THE BEST INFORMATION AVAILABLE BUT NO GUARANTEE IS GIVEN THAT ALL EXISTING UTILITIES ARE SHOWN OR THAT THE GIVEN LOCATIONS ARE EXACT. CONFIRMATION OF EXISTENCE AND EXACT LOCATION OF ALL SERVICES MUST BE OBTAINED FROM THE INDIVIDUAL UTILITIES BEFORE PROCEEDING WITH CONSTRUCTION.

B.M. ELEV.	34-09 231.143m		
NO.	REVISIONS	DATE	BY



**Stantec Consulting Ltd.**

905 Waverley Street, Winnipeg, Manitoba  
Tel 204-489-5900 Fax 204-453-9012

DESIGNED BY	J.C.	CHECKED BY	W.A.B.
DRAWN BY	D.L.	APPROVED BY	H.A.K.
HOR. SCALE:	1:500	RELEASED FOR CONSTRUCTION:	
VERTICAL:	N/A	DATE	
DATE	11.09.01	DATE	

ENGINEER'S SEAL  
  
CONSULTANT DRAWING NO.  
C-II5



**THE CITY OF WINNIPEG  
WATER AND WASTE DEPARTMENT**

2011 SEWER RENEWALS  
AND EXTERNAL POINT REPAIRS  
CONTRACT NO. 18

HILL STREET  
MH AT NIVERVILLE AV TO 1ST MH S OF NIVERVILLE AV  
600 CS POINT REPAIR

SHEET	OF
22	58
CAD FILE DRAWING NUMBER 13090c-115-768.dwg	
CITY DRAWING NUMBER 9732	

V:\1112\active\111213090\drawing\402\_design\sheet\_files\13090c-115-768-Hill.dwg  
2011 December 07, 9:14 a.m.