

# QUEENSWAY CRESCENT (NORTH LEG)

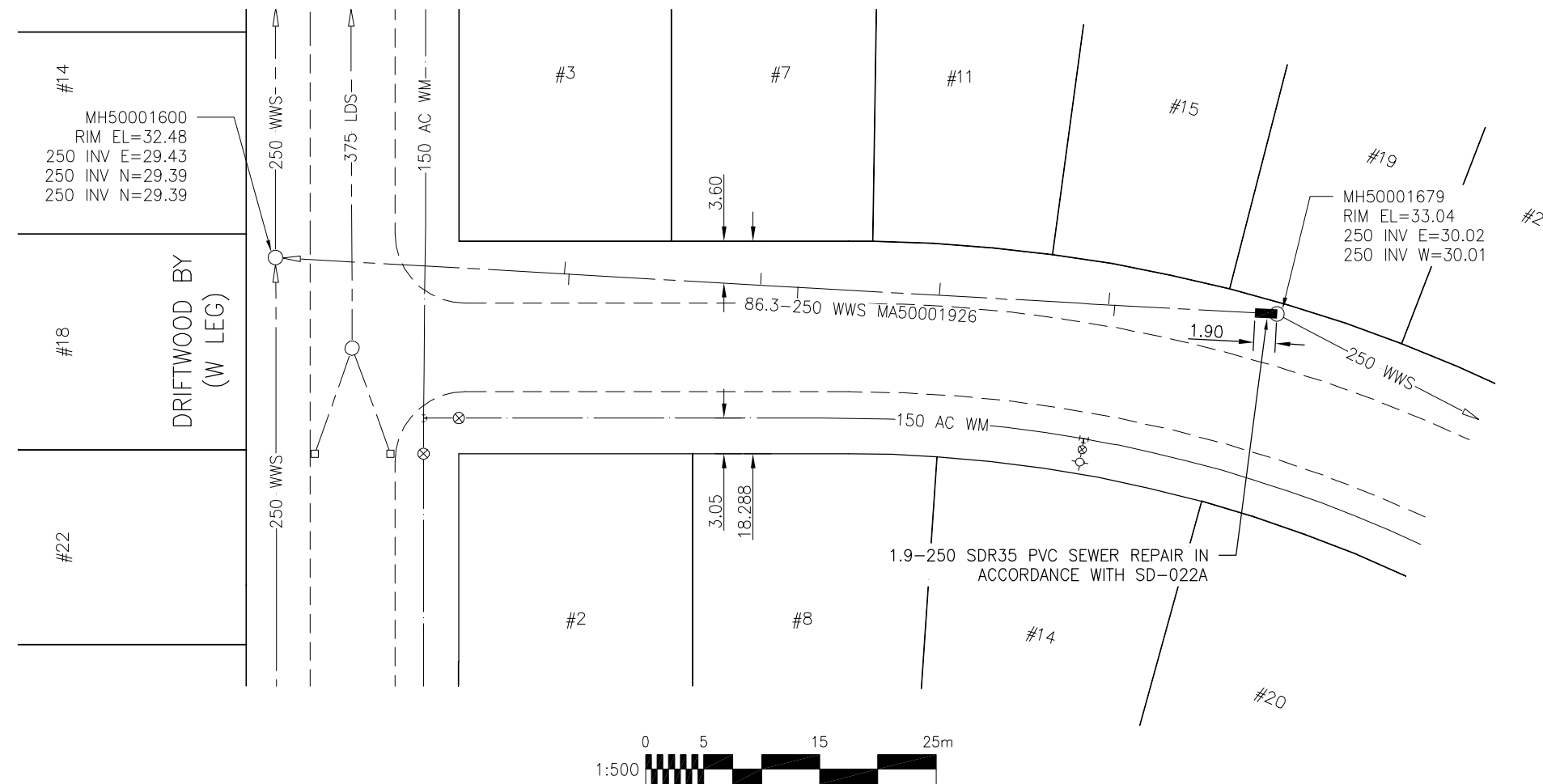

SEWER JUNCTION INFORMATION  
FOR SEWER ID MA50001926  
REFERENCE—METERS WEST OF MANHOLE MH50001679

DIST. FROM REF. MH	JUNCTION DIA.	CLOCK REF.	SERVICE TYPE	DESCRIPTION
14.0	100	10	CN	
14.5	100	02	CN	
29.1	100	02	CN	
41.3	100	10	CN	
44.5	100	02	CN	
61.0	100	10	CN	
61.4	100	02	CN	

ALL JUNCTION INFORMATION  
BASED ON CCTV INSPECTION

## METRIC

WHOLE NUMBERS INDICATE MILLIMETRES  
DECIMALIZED NUMBERS INDICATE METRES

BENCH MARK: N. side Beaverhill Blvd., E. of Lakewood Blvd., Tblt. in E. Conc. foundation No. 584 Beaverhill Blvd., 3.5 m N. & 0.4 m below stucco of most Ely. & S. Cor. of dwelling.



Certificate of Authorization  
Stantec Consulting Ltd.  
No. 1301 Date: \_\_\_\_\_

BID OPPORTUNITY 911-2011

### LOCATION APPROVED UNDERGROUND STRUCTURES

SUPV. U/G STRUCTURES COMMITTEE DATE

NOTE:  
LOCATION OF UNDERGROUND STRUCTURES AS SHOWN ARE BASED ON THE BEST INFORMATION AVAILABLE BUT NO GUARANTEE IS GIVEN THAT ALL EXISTING UTILITIES ARE SHOWN OR THAT THE GIVEN LOCATIONS ARE EXACT. CONFIRMATION OF EXISTENCE AND EXACT LOCATION OF ALL SERVICES MUST BE OBTAINED FROM THE INDIVIDUAL UTILITIES BEFORE PROCEEDING WITH CONSTRUCTION.

B.M. ELEV.	55-18 232.481m		
NO.	REVISIONS	DATE	BY



### Stantec Consulting Ltd.

905 Waverley Street, Winnipeg, Manitoba  
Tel 204-489-5900 Fax 204-453-9012

DESIGNED BY	J.C.	CHECKED BY	W.A.B.
DRAWN BY	D.L.	APPROVED BY	H.A.K.
HOR. SCALE:	1:500	RELEASED FOR CONSTRUCTION:	
VERTICAL:	N/A	DATE	
NO.	REVISIONS	DATE	BY
		11.09.01	

ENGINEER'S SEAL

CONSULTANT DRAWING NO.  
C-130



## THE CITY OF WINNIPEG WATER AND WASTE DEPARTMENT

2011 SEWER RENEWALS  
AND EXTERNAL POINT REPAIRS  
CONTRACT NO. 18  
QUEENSWAY CRESCENT (NORTH LEG)  
1ST MH W OF SERINO PL TO MH AT DRIFTWOOD BY (W LEG)  
250 WWS POINT REPAIR

SHEET	OF
37	58
CAD FILE DRAWING NUMBER 13090c-130-768.dwg	
CITY DRAWING NUMBER 9745	