

**SEWER JUNCTION INFORMATION
FOR SEWER ID MA60000185**

REFERENCE—METERS EAST OF MANHOLE MH60000085

DIST. FROM REF. MANHOLE	JUNCTION DIA.	CLOCK REF.	SERVICE TYPE	DESCRIPTION
2.3	150	12	JN	-
14.4	150	12	CN	-
22.0	150	12	JN	-
31.2	150	12	CN	-
40.3	150	12	CN	-
40.9	150	12	CNI	-
52.6	150	12	CN	-
68.0	150	12	JN	-
69.5	150	12	JN	-
75.6	150	12	JN	-
77.1	150	12	JN	-
87.9	150	12	JN	-
97.1	150	12	JN	-

ALL JUNCTION INFORMATION
BASED ON CCTV INSPECTION

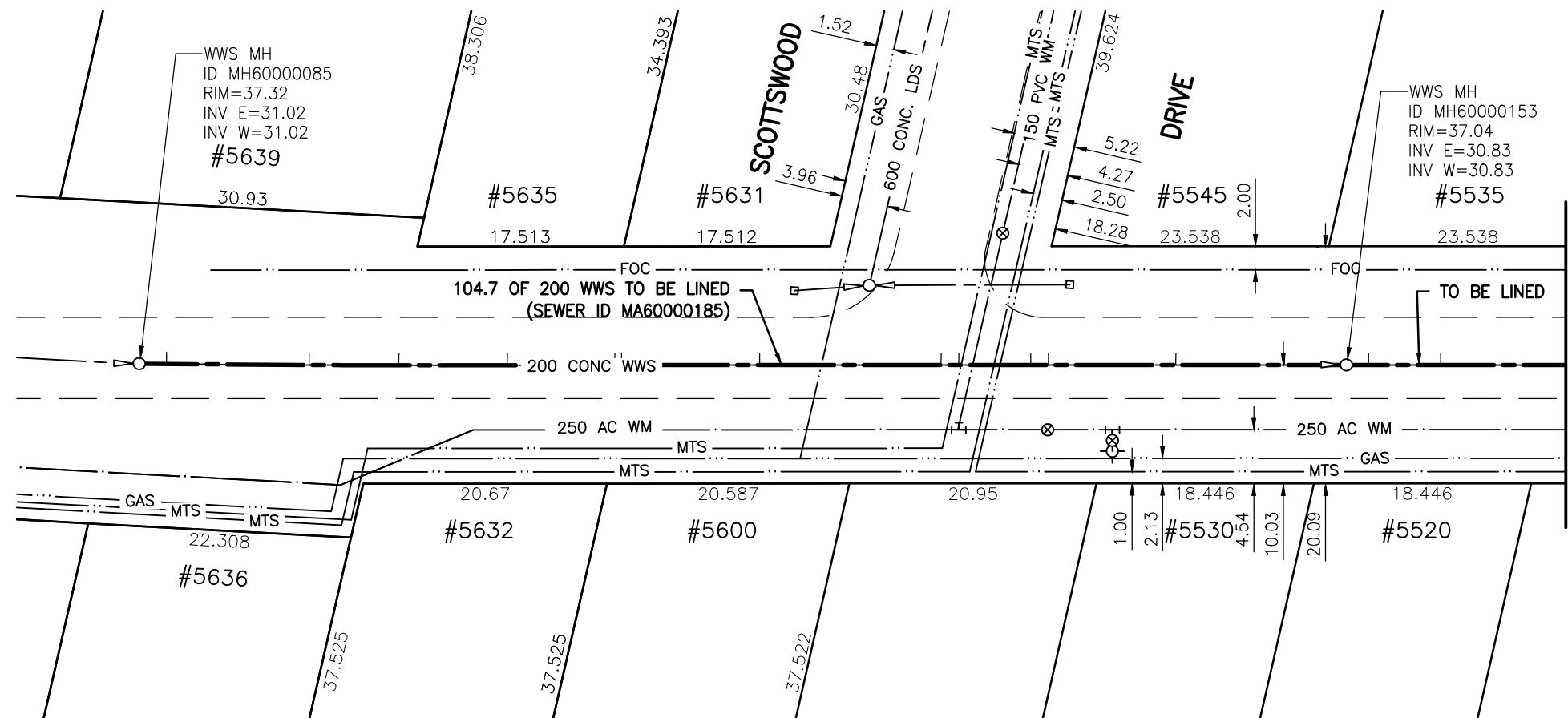

FOR CONTINUATION
SEE DRAWING 9886



WARNING

IF POWER EQUIPMENT OR EXPLOSIVES ARE TO BE USED FOR EXCAVATION ON THIS PROJECT THE CONTRACTOR MUST:

- 1) NOTIFY THE GAS COMPANY OF THE PROPOSED LOCATION OF EXCAVATION.
- 2) TAKE PRECAUTION TO AVOID DAMAGE TO GAS COMPANY INSTALLATIONS.

SEE PROVINCIAL REGULATION 140/92 FOR DETAILS

METRIC

WHOLE NUMBERS INDICATE MILLIMETRES
DECIMALIZED NUMBERS INDICATE METRES

BENCH MARK: W. side Community Row N. of Rannock Ave., Tblt. in N. Conc. Foundation of N. 762 Community Row, 1.0 m W. of N.E. Cor. of house & 0.15 m below stucco.

BID OPPORTUNITY 927-2011

<p>LOCATION APPROVED UNDERGROUND STRUCTURES</p> <p>SUPV. U/G STRUCTURES COMMITTEE _____ DATE _____</p> <p>NOTE: LOCATION OF UNDERGROUND STRUCTURES AS SHOWN ARE BASED ON THE BEST INFORMATION AVAILABLE BUT NO GUARANTEE IS GIVEN THAT ALL EXISTING UTILITIES ARE SHOWN OR THAT THE GIVEN LOCATIONS ARE EXACT. CONFIRMATION OF EXISTENCE AND EXACT LOCATION OF ALL SERVICES MUST BE OBTAINED FROM THE INDIVIDUAL UTILITIES BEFORE PROCEEDING WITH CONSTRUCTION.</p>	<p>B.M. 48-015 ELEV. 237.649m</p>	<p>Stantec Consulting Ltd. 905 Waverley Street, Winnipeg, Manitoba Tel 204-489-5900 Fax 204-453-9012</p>	<p>ENGINEER'S SEAL</p>	<p>THE CITY OF WINNIPEG WATER AND WASTE DEPARTMENT</p>																																
<table border="1" style="width: 100%; border-collapse: collapse;"> <thead> <tr> <th>NO.</th> <th>REVISIONS</th> <th>DATE</th> <th>BY</th> </tr> </thead> <tbody> <tr> <td> </td> <td> </td> <td> </td> <td> </td> </tr> </tbody> </table>	NO.	REVISIONS	DATE	BY					<table border="1" style="width: 100%; border-collapse: collapse;"> <tr> <td>DESIGNED BY</td> <td>J.K.H.</td> <td>CHECKED BY</td> <td>W.A.B.</td> </tr> <tr> <td>DRAWN BY</td> <td>K.R.</td> <td>APPROVED BY</td> <td>H.A.K.</td> </tr> <tr> <td>HOR. SCALE:</td> <td>1:500</td> <td>RELEASED FOR CONSTRUCTION:</td> <td> </td> </tr> <tr> <td>VERTICAL:</td> <td>N/A</td> <td>DATE</td> <td> </td> </tr> </table>	DESIGNED BY	J.K.H.	CHECKED BY	W.A.B.	DRAWN BY	K.R.	APPROVED BY	H.A.K.	HOR. SCALE:	1:500	RELEASED FOR CONSTRUCTION:		VERTICAL:	N/A	DATE		<table border="1" style="width: 100%; border-collapse: collapse;"> <tr> <td>CONSULTANT DRAWING NO.</td> <td style="text-align: center;">C-107</td> </tr> </table>	CONSULTANT DRAWING NO.	C-107	<p>2011 SEWER RENEWALS BY CIPP LINING - CONTRACT 21 RANNOCK AVENUE</p> <p>2ND MH E. OF COMMUNITY ROW TO 1ST MH W. OF VANSKOY RD.</p>	<table border="1" style="width: 100%; border-collapse: collapse;"> <tr> <td>SHEET OF</td> <td style="text-align: center;">10 119</td> </tr> <tr> <td>CAD FILE DRAWING NUMBER</td> <td style="text-align: center;">I3220c-101-766.dwg</td> </tr> <tr> <td>CITY DRAWING NUMBER</td> <td style="text-align: center;">9776</td> </tr> </table>	SHEET OF	10 119	CAD FILE DRAWING NUMBER	I3220c-101-766.dwg	CITY DRAWING NUMBER	9776
NO.	REVISIONS	DATE	BY																																	
DESIGNED BY	J.K.H.	CHECKED BY	W.A.B.																																	
DRAWN BY	K.R.	APPROVED BY	H.A.K.																																	
HOR. SCALE:	1:500	RELEASED FOR CONSTRUCTION:																																		
VERTICAL:	N/A	DATE																																		
CONSULTANT DRAWING NO.	C-107																																			
SHEET OF	10 119																																			
CAD FILE DRAWING NUMBER	I3220c-101-766.dwg																																			
CITY DRAWING NUMBER	9776																																			

\\CD1201-F02\work_group\1112\active\111213220\drawing\402_design\sheet_files\13220c-101-766.dwg
Date: 2011-12-19 3:42pm Login: Ammeter, Wes