



**SEWER JUNCTION INFORMATION
FOR SEWER ID MA20005044**

REFERENCE—METERS WEST OF MANHOLE MH20004623

DIST. FROM REF. MANHOLE	JUNCTION DIA.	CLOCK REF.	SERVICE TYPE	DESCRIPTION
6.5	150	10	JN	—
6.9	150	01	CN	—
8.9	150	11	JN	CAPPED
9.7	150	02	JN	—
20.3	150	09	CX	LIVE. FC IN ADJ. SEWER
28.2	150	10	JN	CAPPED
34.3	150	11	CN	—
46.2	150	10	JN	CAPPED
58.0	150	09	CN	LIVE
68.2	150	10	CN	CAPPED
72.9	150	01	CN	—
93.1	150	08	CN	LIVE

ALL JUNCTION INFORMATION
BASED ON CCTV INSPECTION

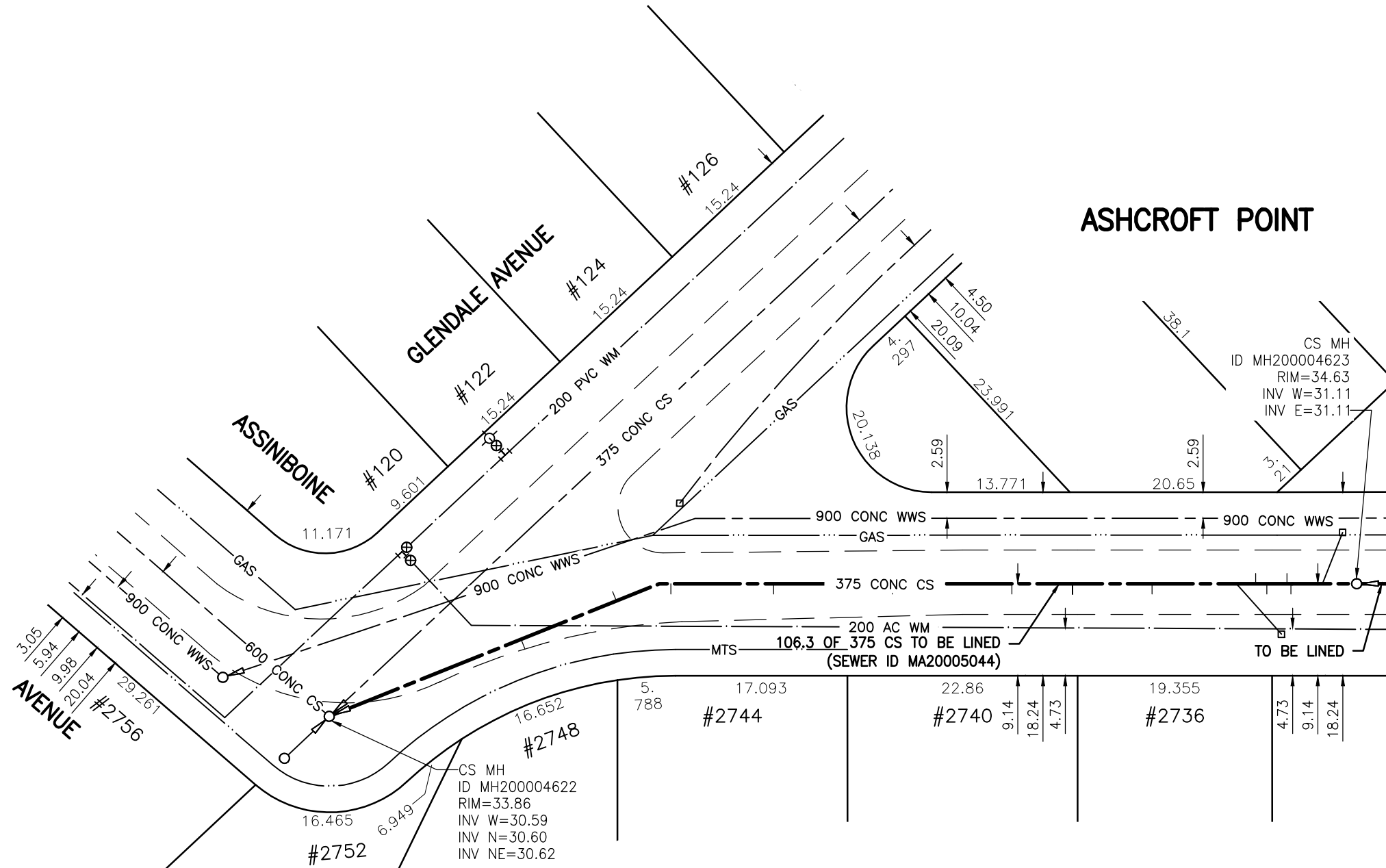

FOR CONTINUATION
SEE DRAWING 9789

WARNING

IF POWER EQUIPMENT OR EXPLOSIVES ARE TO BE USED FOR EXCAVATION ON THIS PROJECT THE CONTRACTOR MUST:

- 1) NOTIFY THE GAS COMPANY OF THE PROPOSED LOCATION OF EXCAVATION.
- 2) TAKE PRECAUTION TO AVOID DAMAGE TO GAS COMPANY INSTALLATIONS.

SEE PROVINCIAL REGULATION 140/92 FOR DETAILS

METRIC

WHOLE NUMBERS INDICATE MILLIMETRES
DECIMALIZED NUMBERS INDICATE METRES

BENCH MARK: 83R503 — N.W. Assiniboine Ave. & Glendale Blvd., Tblt. on top of 0.05 m dia x 2.4 m iron pipe, 8.6 m W. of W. wall produced from the S. of No. 2748 Assiniboine Ave. No. 13.4 m S. of N. wall of No. 120 Glendale Blvd., or 5.4 m E. of W.L. Glendale Blvd. & 1.3 m N. of N.L. Assiniboine Ave.



APEGM
Certificate of Authorization
Stantec Consulting Ltd.
No. 1301 Date: _____

BID OPPORTUNITY 927-2011

**LOCATION APPROVED
UNDERGROUND STRUCTURES**

B.M.	41-050		
ELEV.	233.918m		
SUPV. U/G STRUCTURES COMMITTEE	DATE		
NOTE:	LOCATION OF UNDERGROUND STRUCTURES AS SHOWN ARE BASED ON THE BEST INFORMATION AVAILABLE BUT NO GUARANTEE IS GIVEN THAT ALL EXISTING UTILITIES ARE SHOWN OR THAT THE GIVEN LOCATIONS ARE EXACT. CONFIRMATION OF EXISTENCE AND EXACT LOCATION OF ALL SERVICES MUST BE OBTAINED FROM THE INDIVIDUAL UTILITIES BEFORE PROCEEDING WITH CONSTRUCTION.		
NO.	REVISIONS	DATE	BY



Stantec Consulting Ltd.

905 Waverley Street, Winnipeg, Manitoba
Tel 204-489-5900 Fax 204-453-9012

DESIGNED BY	J.K.H.	CHECKED BY	W.A.B.
DRAWN BY	K.R.	APPROVED BY	H.A.K.
HOR. SCALE:	1:500	RELEASED FOR CONSTRUCTION:	
VERTICAL:	N/A	DATE	2011.10.03

ENGINEER'S SEAL

CONSULTANT DRAWING NO.
C-121



**THE CITY OF WINNIPEG
WATER AND WASTE DEPARTMENT**

**2011 SEWER RENEWALS
BY CIPP LINING - CONTRACT 21
ASHCROFT POINT**

1ST MH E. OF GLENDALE BV. TO
MH AT GLENDALE BV. (CL)

SHEET	OF
24	119
CAD FILE DRAWING NUMBER 13220c-116-766.dwg	
CITY DRAWING NUMBER 9790	

\\CD1201-F02\work_group\1112\active\111213220\drawing\402_design\sheet_files\13220c-116-766.dwg
Date: 2011-12-19 3:35pm Login: Ammeter, Wes