

**SEWER JUNCTION INFORMATION
FOR SEWER ID MA20003178**

REFERENCE—METERS WEST OF MANHOLE MH20002899

DIST. FROM REF. MANHOLE	JUNCTION DIA.	CLOCK REF.	SERVICE TYPE	DESCRIPTION
12.0	150	10	CNI	LIVE
12.6	150	02	CN	-

ALL JUNCTION INFORMATION
BASED ON CCTV INSPECTION

CARLYLE BAY (S. LEG)

FOR CONTINUATION
SEE DRAWING 9800

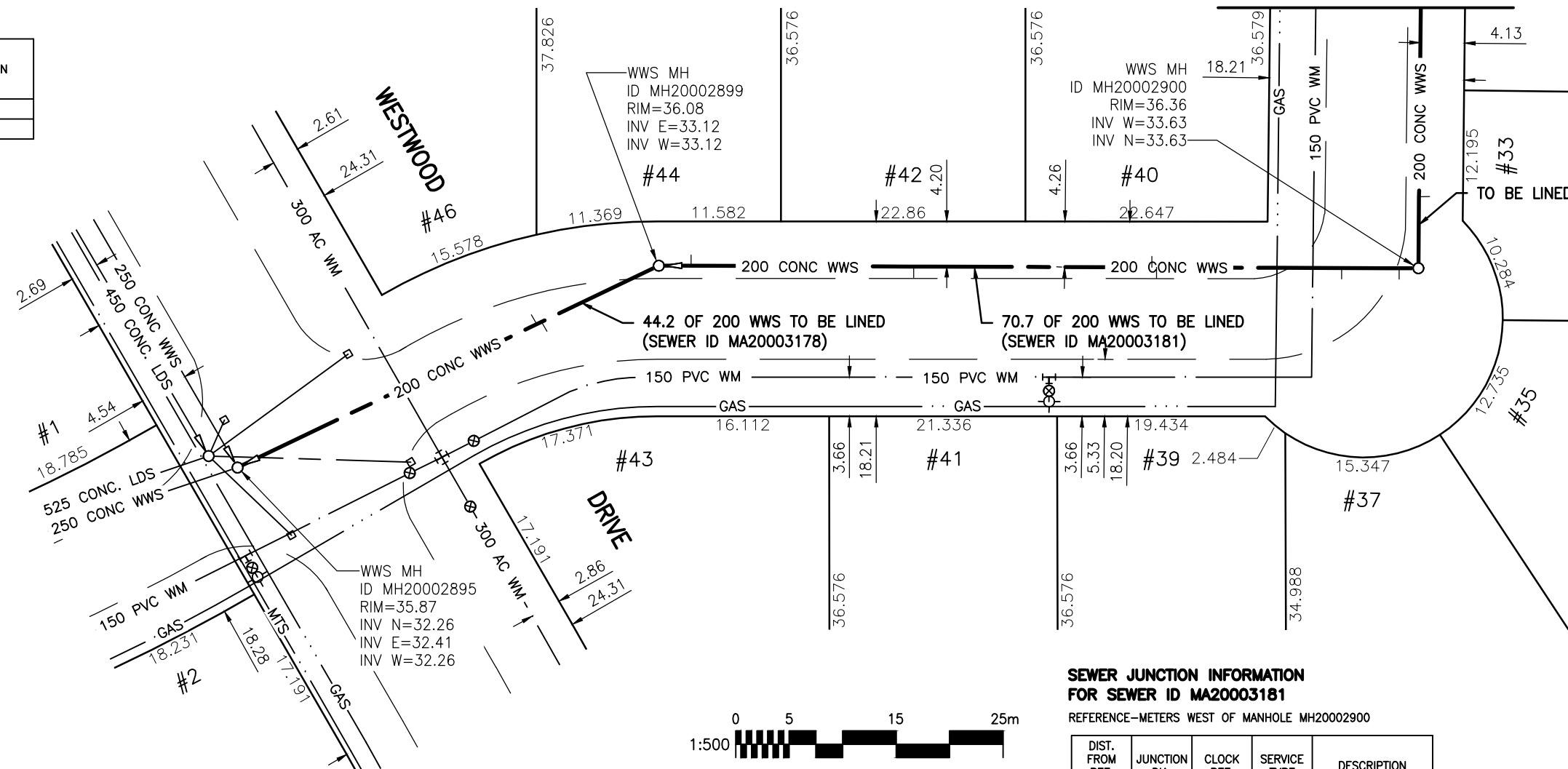

**SEWER JUNCTION INFORMATION
FOR SEWER ID MA20003181**

REFERENCE—METERS WEST OF MANHOLE MH20002900

DIST. FROM REF. MANHOLE	JUNCTION DIA.	CLOCK REF.	SERVICE TYPE	DESCRIPTION
1.8	150	09	CNI	-
7.1	150	09	CXI	LIVE. CRACK.
24.5	150	10	CX	CRACK
24.8	150	02	CNI	-
46.8	150	02	CN	-
47.2	150	10	CN	-
68.0	150	02	CN	LIVE

ALL JUNCTION INFORMATION
BASED ON CCTV INSPECTION

WARNING

IF POWER EQUIPMENT OR EXPLOSIVES ARE TO BE USED FOR EXCAVATION ON THIS PROJECT THE CONTRACTOR MUST:

- 1) NOTIFY THE GAS COMPANY OF THE PROPOSED LOCATION OF EXCAVATION.
- 2) TAKE PRECAUTION TO AVOID DAMAGE TO GAS COMPANY INSTALLATIONS.

SEE PROVINCIAL REGULATION 140/92 FOR DETAILS

METRIC

WHOLE NUMBERS INDICATE MILLIMETRES
DECIMALIZED NUMBERS INDICATE METRES

BENCH MARK: 83R466 - N.E. Cor. Westwood Dr. & N. Leg of Sandburg Bay, Tblt. on top of 0.05 m dia x 2.4 m iron pipe, 7.4 m W. of W. wall & 9.6 m S. of S. wall of attached garage on W. side of No. 1 Sandburg Bay., or 19.3 m E. of W.L. Westwood Dr. & 3.2 m S. of N.L. Sandburg Bay.



Certificate of Authorization

Stantec Consulting Ltd.

No. 1301 Date: _____

BID OPPORTUNITY 927-2011

**LOCATION APPROVED
UNDERGROUND STRUCTURES**

B.M. 41-034		ELEV. 236.265m	
SUPV. U/G STRUCTURES COMMITTEE	DATE		
NOTE:			
LOCATION OF UNDERGROUND STRUCTURES AS SHOWN ARE BASED ON THE BEST INFORMATION AVAILABLE BUT NO GUARANTEE IS GIVEN THAT ALL EXISTING UTILITIES ARE SHOWN OR THAT THE GIVEN LOCATIONS ARE EXACT. CONFIRMATION OF EXISTENCE AND EXACT LOCATION OF ALL SERVICES MUST BE OBTAINED FROM THE INDIVIDUAL UTILITIES BEFORE PROCEEDING WITH CONSTRUCTION.			
NO.	REVISIONS	DATE	BY



Stantec Consulting Ltd.

905 Waverley Street, Winnipeg, Manitoba
Tel 204-489-5900 Fax 204-453-9012

DESIGNED BY	J.K.H.	CHECKED BY	W.A.B.
DRAWN BY	K.R.	APPROVED BY	H.A.K.
HOR. SCALE:	1:500	RELEASED FOR CONSTRUCTION:	
VERTICAL:	N/A	DATE	2011.10.03

ENGINEER'S SEAL

CONSULTANT DRAWING NO.
C-130



**THE CITY OF WINNIPEG
WATER AND WASTE DEPARTMENT**

**2011 SEWER RENEWALS
BY CIPP LINING - CONTRACT 21
CARLYLE BAY (S. LEG)**

**MH AT WESTWOOD DR. (CL) TO
MH AT CARLYLE BY. (E. LEG)**

SHEET	OF	
33		119
CAD FILE DRAWING NUMBER I3220c-116-766.dwg		
CITY DRAWING NUMBER 9799		

\\CD1201-F02\work_group\1112\active\111213220\drawing\402_design\sheet_files\13220c-116-766.dwg
 Date: 2011-12-19 3:35pm Login: Ammeter, Wes