



**SEWER JUNCTION INFORMATION
FOR SEWER ID MA20004070**

REFERENCE—METERS SOUTH OF MANHOLE MH20003734

DIST. FROM REF. MANHOLE	JUNCTION DIA.	CLOCK REF.	SERVICE TYPE	DESCRIPTION
25.3	100	01	JN	—
52.8	100	12	JN	—
54.1	100	10	CNI	LIVE

ALL JUNCTION INFORMATION
BASED ON CCTV INSPECTION

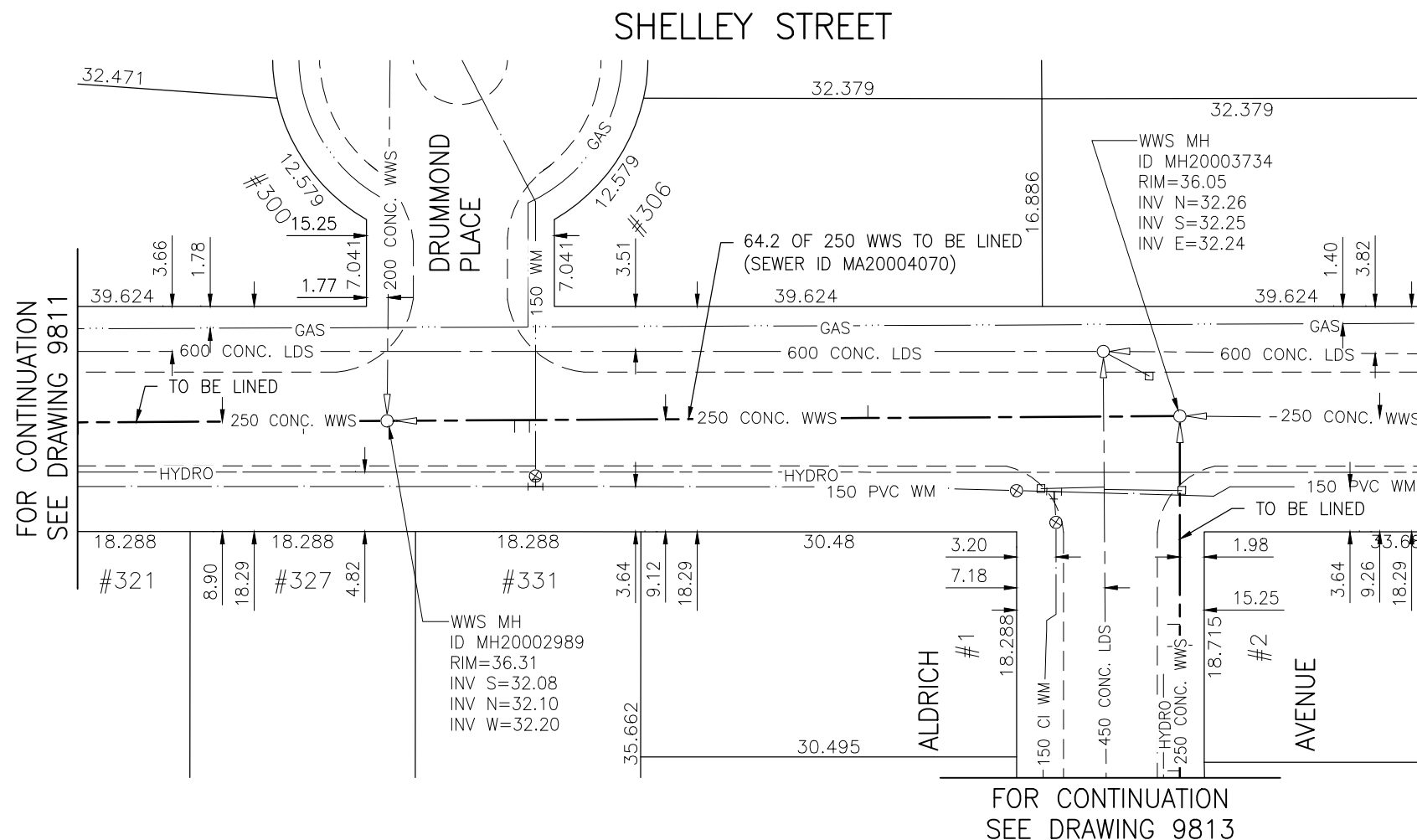

WARNING

IF POWER EQUIPMENT OR EXPLOSIVES ARE TO BE USED FOR EXCAVATION ON THIS PROJECT THE CONTRACTOR MUST:

- 1) NOTIFY THE GAS COMPANY OF THE PROPOSED LOCATION OF EXCAVATION.
- 2) TAKE PRECAUTION TO AVOID DAMAGE TO GAS COMPANY INSTALLATIONS.

SEE PROVINCIAL REGULATION 140/92 FOR DETAILS

METRIC

WHOLE NUMBERS INDICATE MILLIMETRES
DECIMALIZED NUMBERS INDICATE METRES

BENCH MARK: S.W. Cor. Browning Blvd. & Pinehurst Cres., 19 mm dia. x 6.1 m I.B. in valve box, 0.3 m N. of S.L. Browning Blvd. & 0.3 m W. of W.L. Pinehurst Cres.

BID OPPORTUNITY 927-2011

LOCATION APPROVED
UNDERGROUND STRUCTURES

B.M. 41-019			
ELEV. 236.056m			
SUPV. U/G STRUCTURES COMMITTEE	DATE		
NOTE:			
LOCATION OF UNDERGROUND STRUCTURES AS SHOWN ARE BASED ON THE BEST INFORMATION AVAILABLE BUT NO GUARANTEE IS GIVEN THAT ALL EXISTING UTILITIES ARE SHOWN OR THAT THE GIVEN LOCATIONS ARE EXACT. CONFIRMATION OF EXISTENCE AND EXACT LOCATION OF ALL SERVICES MUST BE OBTAINED FROM THE INDIVIDUAL UTILITIES BEFORE PROCEEDING WITH CONSTRUCTION.			
NO.	REVISIONS	DATE	BY



Stantec Consulting Ltd.

905 Waverley Street, Winnipeg, Manitoba
Tel 204-489-5900 Fax 204-453-9012

DESIGNED BY	J.K.H.	CHECKED BY	W.A.B.
DRAWN BY	K.R.	APPROVED BY	H.A.K.
HOR. SCALE:	1:500	RELEASED FOR CONSTRUCTION:	
VERTICAL:	N/A	DATE	2011.10.04

ENGINEER'S SEAL

CONSULTANT DRAWING NO.
C-143



**THE CITY OF WINNIPEG
WATER AND WASTE DEPARTMENT**

2011 SEWER RENEWALS
BY CIPP LINING - CONTRACT 21
SHELLEY STREET
MH AT DRUMMOND PL. (CL) TO
MH AT ALDRICH AV. (CL)

SHEET OF	46 OF 119
CAD FILE DRAWING NUMBER	I3220c-I40-766.dwg
CITY DRAWING NUMBER	9812

\\CD1201-F02\work_group\1112\active\111213220\drawing\402_design\sheet_files\13220c-140-766.dwg
 Date: 2011-12-19 1:59pm Login: Ammeter, Wes