



**SEWER JUNCTION INFORMATION
FOR SEWER ID MA20004061**

REFERENCE—METERS WEST OF MANHOLE MH20003729

DIST. FROM REF. MANHOLE	JUNCTION DIA.	CLOCK REF.	SERVICE TYPE	DESCRIPTION
22.7	100	10	JN	—
23.0	100	10	CN	—
23.6	100	02	JN	—
28.0	100	01	CNI	LIVE
41.2	100	02	JN	LIVE
41.8	100	10	JN	LIVE
42.8	100	02	JN	CAPPED

REFERENCE—METERS EAST OF MANHOLE MH20003733

DIST. FROM REF. MANHOLE	JUNCTION DIA.	CLOCK REF.	SERVICE TYPE	DESCRIPTION
5.0	100	10	CX	CAPPED
5.9	100	02	JN	CAPPED
7.3	100	02	CXI	—
8.6	100	10	CNI	—
9.0	100	02	CNI	—
23.4	100	10	JN	CAPPED
24.3	100	10	CN	—

ALL JUNCTION INFORMATION
BASED ON CCTV INSPECTION

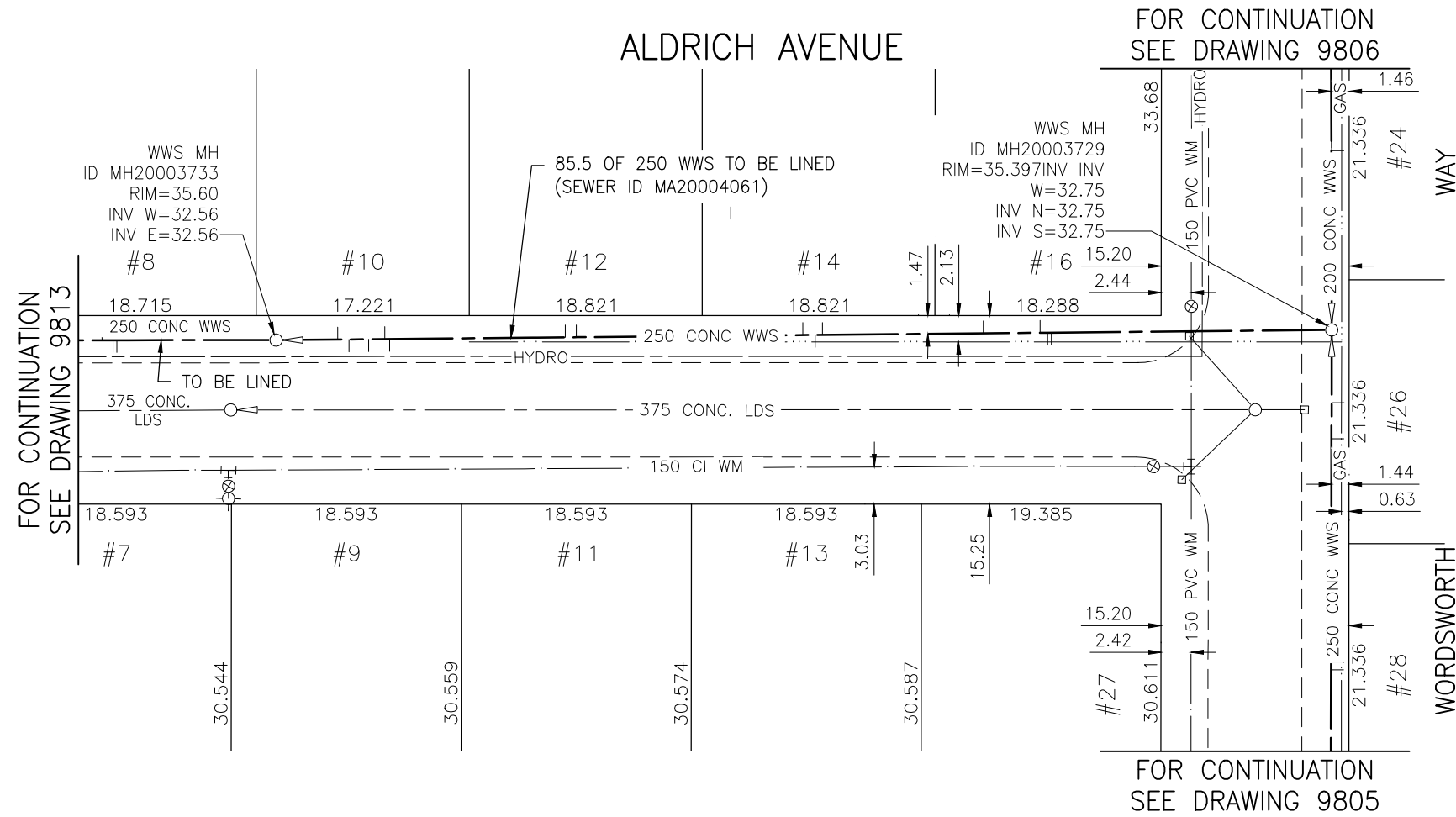

WARNING

IF POWER EQUIPMENT OR EXPLOSIVES ARE TO BE USED FOR EXCAVATION ON THIS PROJECT THE CONTRACTOR MUST:

- 1) NOTIFY THE GAS COMPANY OF THE PROPOSED LOCATION OF EXCAVATION.
- 2) TAKE PRECAUTION TO AVOID DAMAGE TO GAS COMPANY INSTALLATIONS.

SEE PROVINCIAL REGULATION 140/92 FOR DETAILS

METRIC

WHOLE NUMBERS INDICATE MILLIMETRES
DECIMALIZED NUMBERS INDICATE METRES

BENCH MARK: S.W. Cor. Browning Blvd. & Pinehurst Cres., 19 mm dia. x 6.1 m I.B. in valve box, 0.3 m N. of S.L Browning Blvd. & 0.3 m W. of W.L. Pinehurst Cres.

BID OPPORTUNITY 927-2011

<p>LOCATION APPROVED UNDERGROUND STRUCTURES</p> <p>SUPV. U/G STRUCTURES COMMITTEE _____ DATE _____</p> <p>NOTE: LOCATION OF UNDERGROUND STRUCTURES AS SHOWN ARE BASED ON THE BEST INFORMATION AVAILABLE BUT NO GUARANTEE IS GIVEN THAT ALL EXISTING UTILITIES ARE SHOWN OR THAT THE GIVEN LOCATIONS ARE EXACT. CONFIRMATION OF EXISTENCE AND EXACT LOCATION OF ALL SERVICES MUST BE OBTAINED FROM THE INDIVIDUAL UTILITIES BEFORE PROCEEDING WITH CONSTRUCTION.</p>	<p>B.M. 41-019 ELEV. 236.056m</p>	<p>Stantec Consulting Ltd. 905 Waverley Street, Winnipeg, Manitoba Tel 204-489-5900 Fax 204-453-9012</p>	<p>ENGINEER'S SEAL</p>	<p>THE CITY OF WINNIPEG WATER AND WASTE DEPARTMENT</p>																														
<table border="1" style="width:100%; border-collapse: collapse;"> <thead> <tr> <th>NO.</th> <th>REVISIONS</th> <th>DATE</th> <th>BY</th> </tr> </thead> <tbody> <tr> <td> </td> <td> </td> <td> </td> <td> </td> </tr> </tbody> </table>	NO.	REVISIONS	DATE	BY					<table border="1" style="width:100%; border-collapse: collapse;"> <tr> <td>DESIGNED BY</td> <td>J.K.H.</td> <td>CHECKED BY</td> <td>W.A.B.</td> </tr> <tr> <td>DRAWN BY</td> <td>K.R.</td> <td>APPROVED BY</td> <td>H.A.K.</td> </tr> <tr> <td>HOR. SCALE:</td> <td>1:500</td> <td>RELEASED FOR CONSTRUCTION:</td> <td> </td> </tr> <tr> <td>VERTICAL:</td> <td>N/A</td> <td>DATE</td> <td> </td> </tr> </table>	DESIGNED BY	J.K.H.	CHECKED BY	W.A.B.	DRAWN BY	K.R.	APPROVED BY	H.A.K.	HOR. SCALE:	1:500	RELEASED FOR CONSTRUCTION:		VERTICAL:	N/A	DATE		<p>CONSULTANT DRAWING NO. C-145</p>	<p style="text-align: center;">2011 SEWER RENEWALS BY CIPP LINING - CONTRACT 21 ALDRICH AVENUE MH AT WORDSWORTH WY. (E. LEG) (CL) TO 1ST MH E. OF SHELLEY ST. (CL)</p>	<table border="1" style="width:100%; border-collapse: collapse;"> <tr> <td>SHEET OF</td> <td style="text-align: center;">48 OF 119</td> </tr> <tr> <td>CAD FILE DRAWING NUMBER</td> <td style="text-align: center;">I3220c-I40-766.dwg</td> </tr> <tr> <td>CITY DRAWING NUMBER</td> <td style="text-align: center;">9814</td> </tr> </table>	SHEET OF	48 OF 119	CAD FILE DRAWING NUMBER	I3220c-I40-766.dwg	CITY DRAWING NUMBER	9814
NO.	REVISIONS	DATE	BY																															
DESIGNED BY	J.K.H.	CHECKED BY	W.A.B.																															
DRAWN BY	K.R.	APPROVED BY	H.A.K.																															
HOR. SCALE:	1:500	RELEASED FOR CONSTRUCTION:																																
VERTICAL:	N/A	DATE																																
SHEET OF	48 OF 119																																	
CAD FILE DRAWING NUMBER	I3220c-I40-766.dwg																																	
CITY DRAWING NUMBER	9814																																	

\\CD1201-F02\work_group\1112\active\111213220\drawing\402_design\sheet_files\13220c-140-766.dwg
 Date: 2011-12-19 2:01pm Login: Ammeter, Wes