

**SEWER JUNCTION INFORMATION
FOR SEWER ID MA20004096**

REFERENCE—METERS EAST OF MANHOLE MH20003767

DIST. FROM REF. MANHOLE	JUNCTION DIA.	CLOCK REF.	SERVICE TYPE	DESCRIPTION
11.2	100	02	CN	—
78.4	100	10	CN	LIVE

ALL JUNCTION INFORMATION
BASED ON CCTV INSPECTION

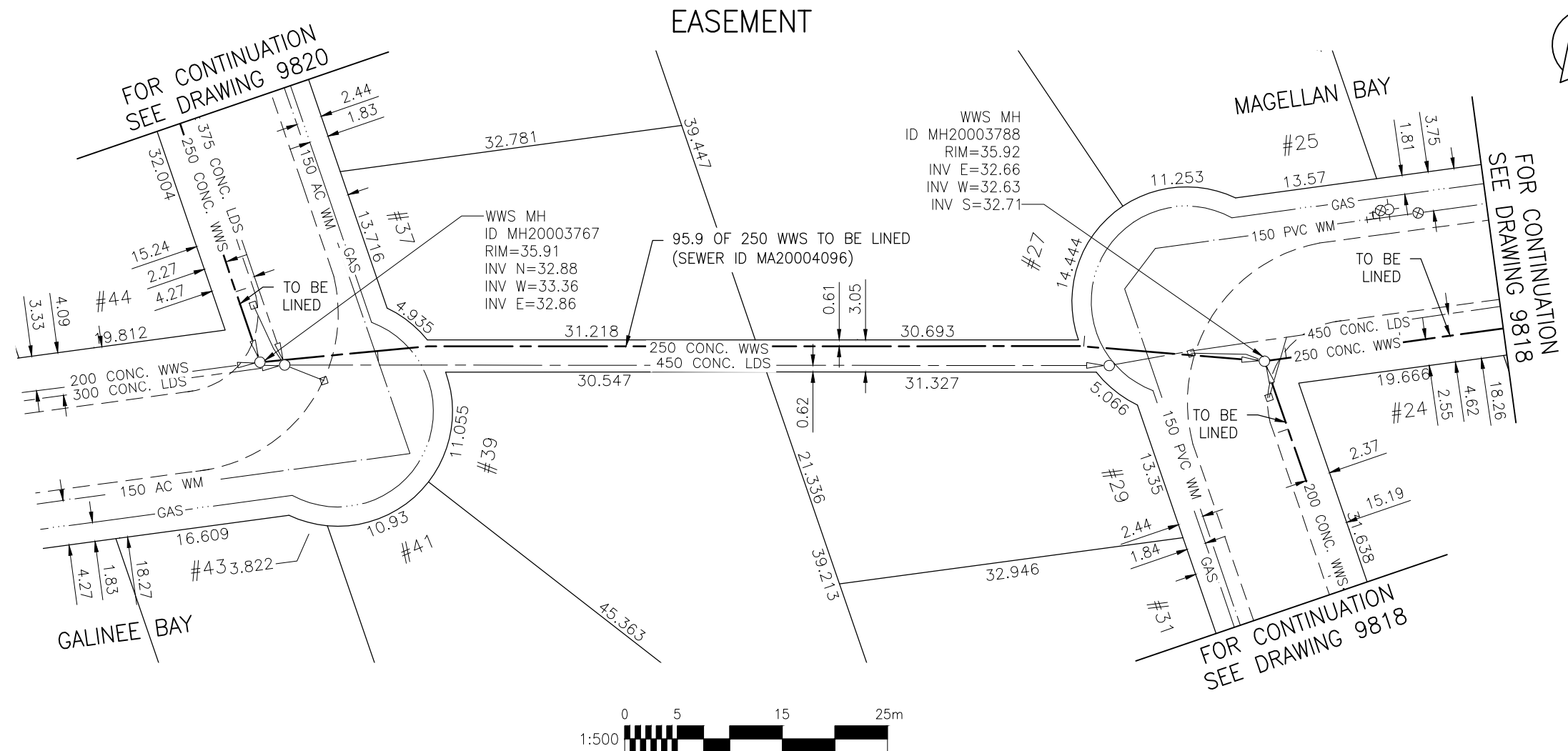

WARNING

IF POWER EQUIPMENT OR EXPLOSIVES ARE TO BE USED FOR EXCAVATION ON THIS PROJECT THE CONTRACTOR MUST:

- 1) NOTIFY THE GAS COMPANY OF THE PROPOSED LOCATION OF EXCAVATION.
- 2) TAKE PRECAUTION TO AVOID DAMAGE TO GAS COMPANY INSTALLATIONS.

SEE PROVINCIAL REGULATION 140/92 FOR DETAILS

METRIC

WHOLE NUMBERS INDICATE MILLIMETRES
DECIMALIZED NUMBERS INDICATE METRES

BENCH MARK: N.W. Cor. Rouge Rd. & Sansome Ave., Tblt. in the most Ely. Conc. foundation of Westwood Collegiate No. 360 Rouge Rd., 13.6 m N. 7 0.2 m below brick of the S.E. Cor. of the School.

APEGM
Certificate of Authorization
Stantec Consulting Ltd.
No. 1301 Date: _____

BID OPPORTUNITY 927-2011

**LOCATION APPROVED
UNDERGROUND STRUCTURES**

B.M.	41-016		
ELEV.	237.418m		
SUPV. U/G STRUCTURES COMMITTEE	DATE		
NOTE:	LOCATION OF UNDERGROUND STRUCTURES AS SHOWN ARE BASED ON THE BEST INFORMATION AVAILABLE BUT NO GUARANTEE IS GIVEN THAT ALL EXISTING UTILITIES ARE SHOWN OR THAT THE GIVEN LOCATIONS ARE EXACT. CONFIRMATION OF EXISTENCE AND EXACT LOCATION OF ALL SERVICES MUST BE OBTAINED FROM THE INDIVIDUAL UTILITIES BEFORE PROCEEDING WITH CONSTRUCTION.		
NO.	REVISIONS	DATE	BY



Stantec Consulting Ltd.

905 Waverley Street, Winnipeg, Manitoba
Tel 204-489-5900 Fax 204-453-9012

DESIGNED BY	J.K.H.	CHECKED BY	W.A.B.
DRAWN BY	K.R.	APPROVED BY	H.A.K.
HOR. SCALE:	1:500	RELEASED FOR CONSTRUCTION:	
VERTICAL:	N/A	DATE	2011.10.04

ENGINEER'S SEAL

CONSULTANT DRAWING NO.
C-150



**THE CITY OF WINNIPEG
WATER AND WASTE DEPARTMENT**

2011 SEWER RENEWALS
BY CIPP LINING - CONTRACT 21
EASEMENT

MH AT GALINEE BY. (E. LEG) TO
MH AT MAGELLAN BY. (W. LEG)

SHEET	OF	
53		119
CAD FILE DRAWING NUMBER 13220c-140-766.dwg		
CITY DRAWING NUMBER 9819		

\\CD1201-F02\work_group\1112\active\111213220\drawing\402_design\sheet_files\13220c-140-766.dwg
 Date: 2011-12-19 2:19pm Login: Ammeter, Wes