

**SEWER JUNCTION INFORMATION
FOR SEWER ID MA20003860**

REFERENCE—METERS WEST OF MANHOLE MH20003533

DIST. FROM REF. MANHOLE	JUNCTION DIA.	CLOCK REF.	SERVICE TYPE	DESCRIPTION
18.5	150	12	CNI	—
27.9	150	02	CN	LIVE
40.7	150	12	CN	LIVE. W/EH
58.2	150	01	CNI	W.EH

ALL JUNCTION INFORMATION
BASED ON CCTV INSPECTION

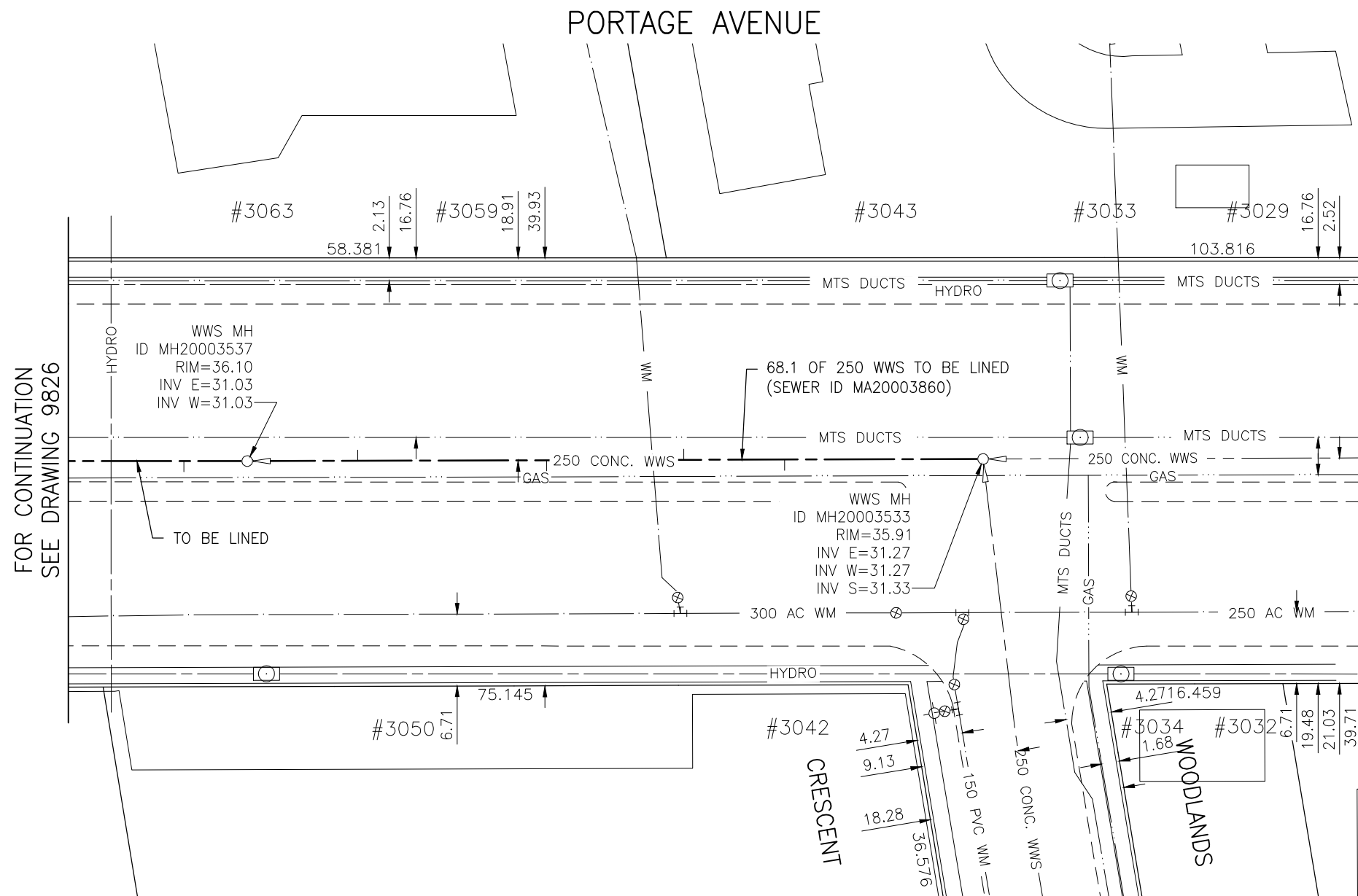

FOR CONTINUATION
SEE DRAWING 9826

WARNING

IF POWER EQUIPMENT OR EXPLOSIVES ARE TO BE USED FOR EXCAVATION ON THIS PROJECT THE CONTRACTOR MUST:

- 1) NOTIFY THE GAS COMPANY OF THE PROPOSED LOCATION OF EXCAVATION.
- 2) TAKE PRECAUTION TO AVOID DAMAGE TO GAS COMPANY INSTALLATIONS.

SEE PROVINCIAL REGULATION 140/92 FOR DETAILS

METRIC

WHOLE NUMBERS INDICATE MILLIMETRES
DECIMALIZED NUMBERS INDICATE METRES

BENCH MARK: S.W. Cor. Portage Ave. & Woodlands Cres., Tblt. in E. Conc. foundation of Bldg. (Goodyear Auto Service), 0.7 m S. & 0.1 m below brick of N.E. cor. of Bldg.



Certificate of Authorization

Stantec Consulting Ltd.

No. 1301 Date: _____

BID OPPORTUNITY 927-2011

**LOCATION APPROVED
UNDERGROUND STRUCTURES**

B.M. 41-009 ELEV. 236.224m			
NO.	REVISIONS	DATE	BY

SUPV. U/G STRUCTURES COMMITTEE DATE

NOTE:
LOCATION OF UNDERGROUND STRUCTURES AS SHOWN ARE BASED ON THE BEST INFORMATION AVAILABLE BUT NO GUARANTEE IS GIVEN THAT ALL EXISTING UTILITIES ARE SHOWN OR THAT THE GIVEN LOCATIONS ARE EXACT. CONFIRMATION OF EXISTENCE AND EXACT LOCATION OF ALL SERVICES MUST BE OBTAINED FROM THE INDIVIDUAL UTILITIES BEFORE PROCEEDING WITH CONSTRUCTION.



Stantec Consulting Ltd.

905 Waverley Street, Winnipeg, Manitoba
Tel 204-489-5900 Fax 204-453-9012

DESIGNED BY	J.K.H.	CHECKED BY	W.A.B.
DRAWN BY	K.R.	APPROVED BY	H.A.K.
HOR. SCALE:	1:500	RELEASED FOR CONSTRUCTION:	
VERTICAL:	N/A	DATE	2011.10.04

ENGINEER'S SEAL

CONSULTANT DRAWING NO.
C-156



**THE CITY OF WINNIPEG
WATER AND WASTE DEPARTMENT**

2011 SEWER RENEWALS
BY CIPP LINING - CONTRACT 21
PORTAGE AVENUE
MH AT WOODLANDS CR. (W. LEG) (CL) TO
1ST MH W. OF WOODLANDS CR. (W. LEG)

SHEET OF	59 OF 119
CAD FILE DRAWING NUMBER	I3220c-I40-766.dwg
CITY DRAWING NUMBER	9825

\\CD1201-F02\work_group\1112\active\111213220\drawing\402_design\sheet_files\13220c-140-766.dwg
 Date: 2011-12-19 2:29pm Login: Ammeter, Wes