

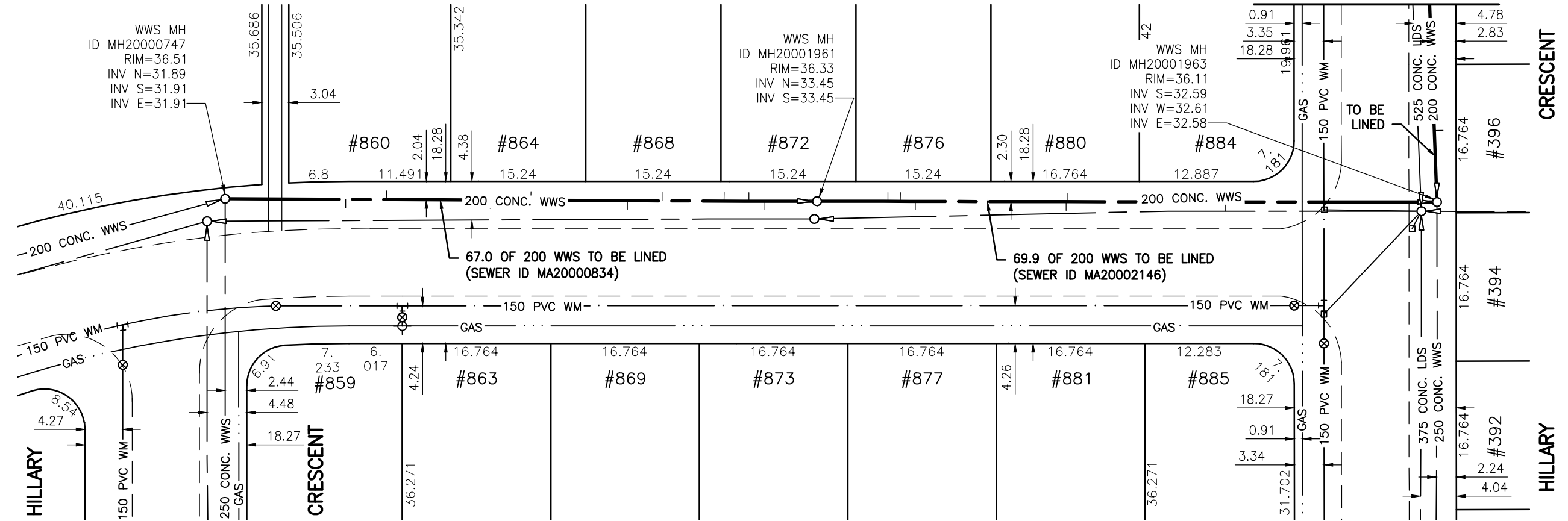

# MURIEL STREET

FOR CONTINUATION  
SEE DRAWING 9850



WWS MH  
ID MH2000747  
RIM=36.51  
INV N=31.89  
INV S=31.91  
INV E=31.91

WWS MH  
ID MH20001961  
RIM=36.33  
INV N=33.45  
INV S=33.45

WWS MH  
ID MH20001963  
RIM=36.11  
INV S=32.59  
INV W=32.61  
INV E=32.58



## WARNING

IF POWER EQUIPMENT OR EXPLOSIVES ARE TO BE USED FOR EXCAVATION ON THIS PROJECT THE CONTRACTOR MUST:

- 1) NOTIFY THE GAS COMPANY OF THE PROPOSED LOCATION OF EXCAVATION.
- 2) TAKE PRECAUTION TO AVOID DAMAGE TO GAS COMPANY INSTALLATIONS.

SEE PROVINCIAL REGULATION 140/92 FOR DETAILS

## METRIC

WHOLE NUMBERS INDICATE MILLIMETRES  
DECIMALIZED NUMBERS INDICATE METRES

BENCH MARK: W. side Cavalier Dr., S. of Fairlane Ave., Tblt. in E. Conc. foundation No. 664 Cavalier Dr., 2.5 m S. & 0.2 m below brick of N.E. Cor. of Dwelling.

### SEWER JUNCTION INFORMATION FOR SEWER ID MA20000834

REFERENCE—METERS NORTH OF MANHOLE MH20000747

DIST. FROM REF. MANHOLE	JUNCTION DIA.	CLOCK REF.	SERVICE TYPE	DESCRIPTION
13.6	100	03	JN	LIVE
18.2	100	10	JN	LIVE
29.9	100	03	JN	LIVE
34.5	100	09	JN	LIVE
45.4	100	03	JN	LIVE
49.1	100	09	CNI	LIVE
56.3	100	09	JN	LIVE
58.9	100	09	CNI	LIVE
60.8	100	02	CNI	LIVE

ALL JUNCTION INFORMATION BASED ON CCTV INSPECTION

### SEWER JUNCTION INFORMATION FOR SEWER ID MA20002146

REFERENCE—METERS NORTH OF MANHOLE MH20001961

DIST. FROM REF. MANHOLE	JUNCTION DIA.	CLOCK REF.	SERVICE TYPE	DESCRIPTION
8.0	100	09	JN	CAPPED
9.4	100	10	JN	-
11.1	100	03	JN	-
28.1	100	03	JN	-
28.3	100	09	JN	LIVE
44.3	100	09	JN	-
46.1	100	03	JN	-



Certificate of Authorization

Stantec Consulting Ltd.

No. 1301 Date: \_\_\_\_\_

BID OPPORTUNITY 927-2011

### LOCATION APPROVED UNDERGROUND STRUCTURES

B.M.	40-026		
ELEV.	237.452m		
SUPV. U/G STRUCTURES COMMITTEE	DATE		
NOTE:	LOCATION OF UNDERGROUND STRUCTURES AS SHOWN ARE BASED ON THE BEST INFORMATION AVAILABLE BUT NO GUARANTEE IS GIVEN THAT ALL EXISTING UTILITIES ARE SHOWN OR THAT THE GIVEN LOCATIONS ARE EXACT. CONFIRMATION OF EXISTENCE AND EXACT LOCATION OF ALL SERVICES MUST BE OBTAINED FROM THE INDIVIDUAL UTILITIES BEFORE PROCEEDING WITH CONSTRUCTION.		
NO.	REVISIONS	DATE	BY



### Stantec Consulting Ltd.

905 Waverley Street, Winnipeg, Manitoba  
Tel 204-489-5900 Fax 204-453-9012

DESIGNED BY	J.K.H.	CHECKED BY	W.A.B.
DRAWN BY	K.R.	APPROVED BY	H.A.K.
HOR. SCALE:	1:500	RELEASED FOR CONSTRUCTION:	
VERTICAL:	N/A	DATE	2011.10.05

ENGINEER'S SEAL

CONSULTANT DRAWING NO.  
**C-180**



## THE CITY OF WINNIPEG WATER AND WASTE DEPARTMENT

### 2011 SEWER RENEWALS BY CIPP LINING - CONTRACT 21 MURIEL STREET

MH AT HILLARY CR. (N. LEG) (PL)  
TO MH AT HILLARY CR. (S. LEG) (PL)

SHEET	OF
<b>83</b>	<b>119</b>
CAD FILE DRAWING NUMBER I3220c-161-766.dwg	
CITY DRAWING NUMBER <b>9849</b>	