

\\CD1201-F02\work_group\1112\active\111213220\drawing\402_design\sheet_files\13220c-207-766.dwg
 Date: 2011-12-20 8:54am Login: Ammeter, Wes

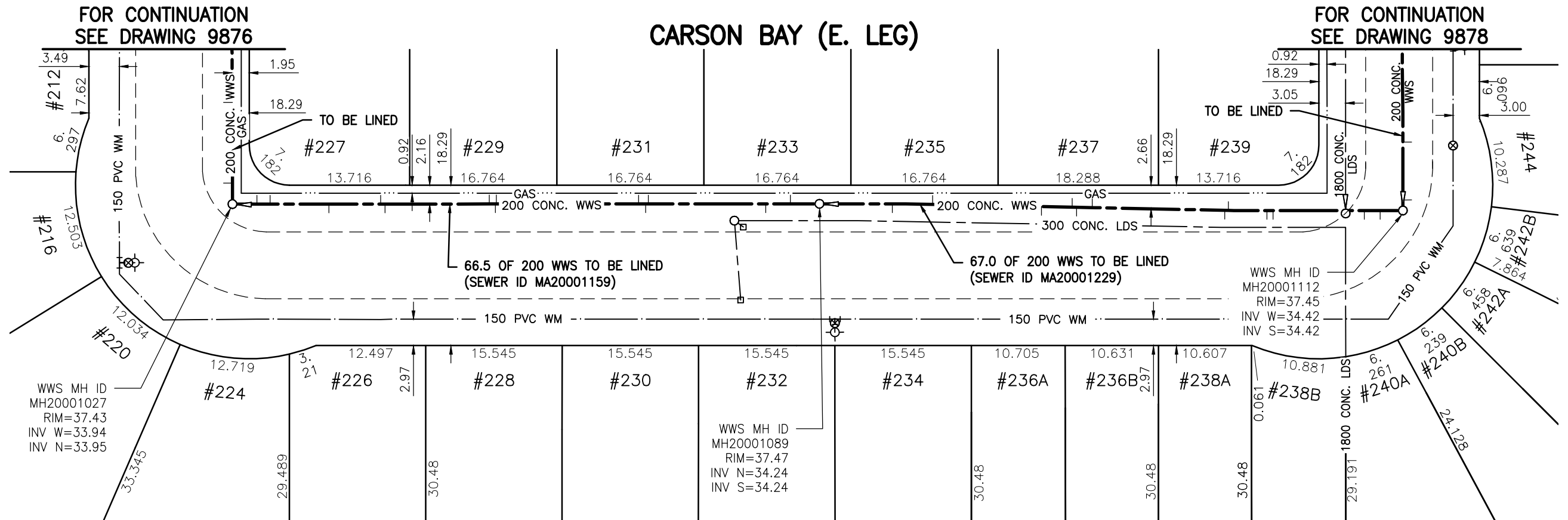

WARNING

IF POWER EQUIPMENT OR EXPLOSIVES ARE TO BE USED FOR EXCAVATION ON THIS PROJECT THE CONTRACTOR MUST:

- 1) NOTIFY THE GAS COMPANY OF THE PROPOSED LOCATION OF EXCAVATION.
- 2) TAKE PRECAUTION TO AVOID DAMAGE TO GAS COMPANY INSTALLATIONS.

SEE PROVINCIAL REGULATION 140/92 FOR DETAILS

METRIC

WHOLE NUMBERS INDICATE MILLIMETRES
DECIMALIZED NUMBERS INDICATE METRES

BENCH MARK: W. side Cavalier Dr., S. of Fairlane Ave., Tblt. in E. Conc. foundation No. 664 Cavalier Dr., 2.5 m S. & 0.2 m below brick of N.E. Cor. of dwelling.

SEWER JUNCTION INFORMATION FOR SEWER ID MA20001159

REFERENCE—METERS SOUTH OF MANHOLE MH20001089

DIST. FROM REF. MANHOLE	JUNCTION DIA.	CLOCK REF.	SERVICE TYPE	DESCRIPTION
3.3	150	03	JN	—
6.1	150	11	CNI	W RM
19.5	150	03	JN	CAPPED
19.8	150	10	JN	W RM
20.6	150	03	CN	W RM
36.8	150	03	JN	CAPPED
36.9	150	10	CN	LIVE
37.6	100	02	CN	LIVE
49.5	150	10	CN	—
50.0	100	1	CN	—
55.9	150	03	JN	CAPPED
62.6	100	10	CN	—
64.1	150	10	CN	LIVE

SEWER JUNCTION INFORMATION FOR SEWER ID MA20001229

REFERENCE—METERS SOUTH OF MANHOLE MH20001112

DIST. FROM REF. MANHOLE	JUNCTION DIA.	CLOCK REF.	SERVICE TYPE	DESCRIPTION
2.6	150	10	CN	—
4.4	150	09	CN	CAPPED
14.8	150	09	CN	W RM
15.5	100	09	CN	W RM
19.9	100	03	JN	W RM
20.3	100	10	CNI	—
35.4	150	03	JN	W RM
37.2	150	09	JX	FRACTURED
37.6	150	03	CNI	LIVE
41.2	150	10	CN	—
53.6	150	03	JN	—
58.2	150	09	JN	LIVE

ALL JUNCTION INFORMATION BASED ON CCTV INSPECTION

Certificate of Authorization

Stantec Consulting Ltd.

No. 1301 Date: _____

BID OPPORTUNITY 927-2011

<p>LOCATION APPROVED UNDERGROUND STRUCTURES</p> <p>SUPV. U/G STRUCTURES COMMITTEE _____ DATE _____</p> <p>NOTE: LOCATION OF UNDERGROUND STRUCTURES AS SHOWN ARE BASED ON THE BEST INFORMATION AVAILABLE BUT NO GUARANTEE IS GIVEN THAT ALL EXISTING UTILITIES ARE SHOWN OR THAT THE GIVEN LOCATIONS ARE EXACT. CONFIRMATION OF EXISTENCE AND EXACT LOCATION OF ALL SERVICES MUST BE OBTAINED FROM THE INDIVIDUAL UTILITIES BEFORE PROCEEDING WITH CONSTRUCTION.</p>	<p>B.M. 40-026 ELEV. 237.452m</p>	<p>Stantec Consulting Ltd. 905 Waverley Street, Winnipeg, Manitoba Tel 204-489-5900 Fax 204-453-9012</p>	<p>ENGINEER'S SEAL</p>	<p>THE CITY OF WINNIPEG WATER AND WASTE DEPARTMENT</p>	<p>SHEET OF III OF 119</p> <p>CAD FILE DRAWING NUMBER 13220c-207-766.dwg</p> <p>CITY DRAWING NUMBER 9877</p>																						
<table border="1" style="width: 100%; border-collapse: collapse;"> <thead> <tr> <th>NO.</th> <th>REVISIONS</th> <th>DATE</th> <th>BY</th> </tr> </thead> <tbody> <tr> <td> </td> <td> </td> <td> </td> <td> </td> </tr> </tbody> </table>	NO.	REVISIONS	DATE	BY					<table border="1" style="width: 100%; border-collapse: collapse;"> <tr> <td>DESIGNED BY</td> <td>J.K.H.</td> <td>CHECKED BY</td> <td>W.A.B.</td> </tr> <tr> <td>DRAWN BY</td> <td>K.R.</td> <td>APPROVED BY</td> <td>H.A.K.</td> </tr> <tr> <td>HOR. SCALE:</td> <td>1:500</td> <td>RELEASED FOR CONSTRUCTION:</td> <td> </td> </tr> <tr> <td>VERTICAL:</td> <td>N/A</td> <td>DATE</td> <td>2011.10.08</td> </tr> </table>	DESIGNED BY	J.K.H.	CHECKED BY	W.A.B.	DRAWN BY	K.R.	APPROVED BY	H.A.K.	HOR. SCALE:	1:500	RELEASED FOR CONSTRUCTION:		VERTICAL:	N/A	DATE	2011.10.08	<p>CONSULTANT DRAWING NO. C-208</p>	<p>2011 SEWER RENEWALS BY CIPP LINING - CONTRACT 21 CARSON BAY (E. LEG) MH AT CARSON BY. (S. LEG) (PL) TO MH AT CARSON BY. (N. LEG) (PL)</p>
NO.	REVISIONS	DATE	BY																								
DESIGNED BY	J.K.H.	CHECKED BY	W.A.B.																								
DRAWN BY	K.R.	APPROVED BY	H.A.K.																								
HOR. SCALE:	1:500	RELEASED FOR CONSTRUCTION:																									
VERTICAL:	N/A	DATE	2011.10.08																								