

**SEWER JUNCTION INFORMATION
FOR SEWER ID MA20001925**

REFERENCE—METERS NORTH OF MANHOLE MH20001740

DIST. FROM REF. MANHOLE	JUNCTION DIA.	CLOCK REF.	SERVICE TYPE	DESCRIPTION
3.7	150	03	JX	LIVE. FRACTURED
16.0	150	02	JN	ROOTS
28.8	150	02	JX	LIVE. FRACTURED
43.4	150	02	JX	CRACKED

ALL JUNCTION INFORMATION
BASED ON CCTV INSPECTION

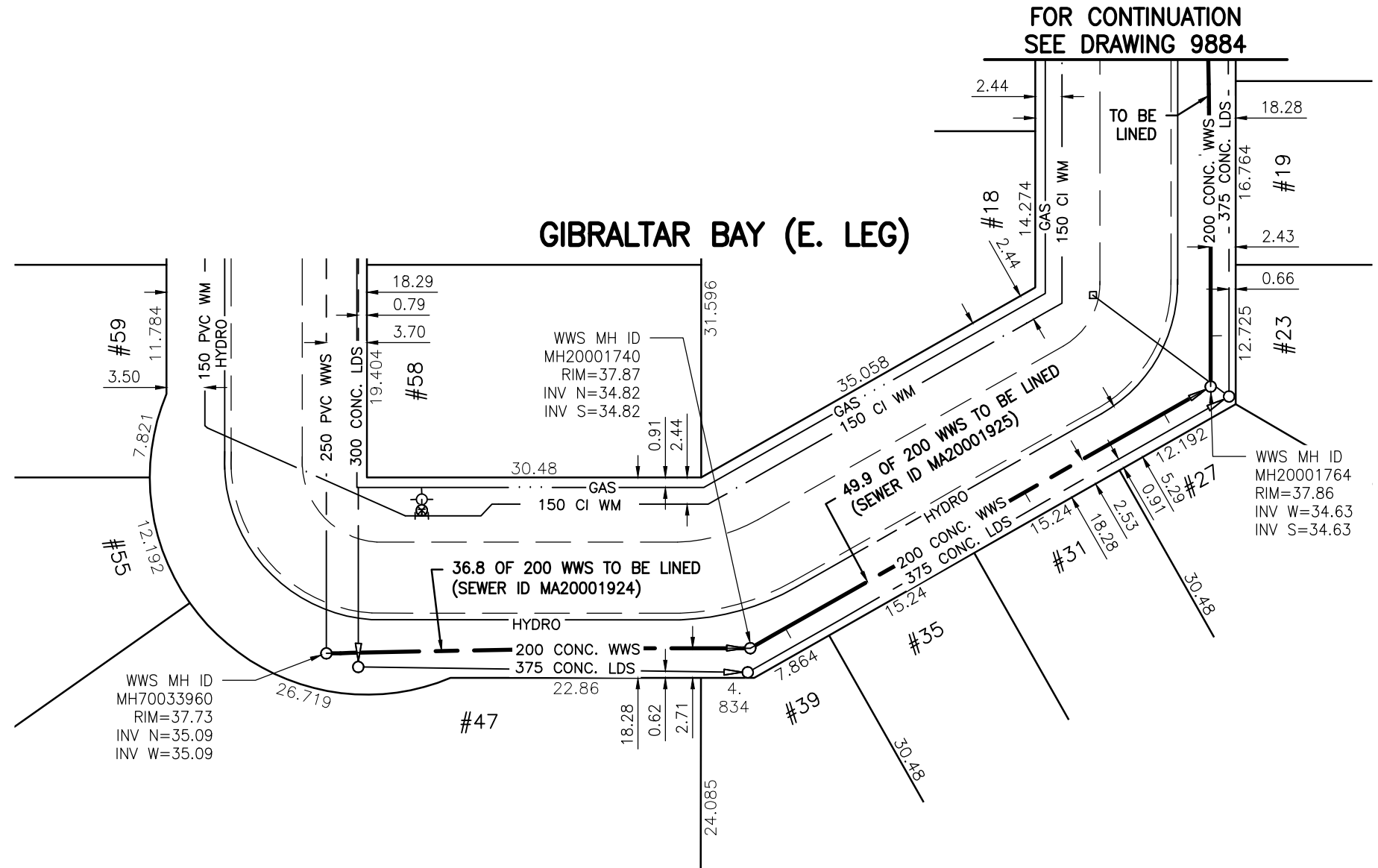

FOR CONTINUATION
SEE DRAWING 9884

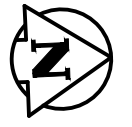

WARNING

IF POWER EQUIPMENT OR EXPLOSIVES ARE TO BE USED FOR EXCAVATION ON THIS PROJECT THE CONTRACTOR MUST:

- 1) NOTIFY THE GAS COMPANY OF THE PROPOSED LOCATION OF EXCAVATION.
- 2) TAKE PRECAUTION TO AVOID DAMAGE TO GAS COMPANY INSTALLATIONS.

SEE PROVINCIAL REGULATION 140/92 FOR DETAILS

METRIC

WHOLE NUMBERS INDICATE MILLIMETRES
DECIMALIZED NUMBERS INDICATE METRES

BENCH MARK: E. side Cavalier Dr. @ Lumsden Ave., Tblt. in W. Conc foundation No. 959
Cavalier Dr., 0.5 m S. & 0.2 m below stucco of N.W. Cor. of dwelling.



APEGM
Certificate of Authorization
Stantec Consulting Ltd.
No. 1301 Date: _____

BID OPPORTUNITY 927-2011

<p>LOCATION APPROVED UNDERGROUND STRUCTURES</p> <p>SUPV. U/G STRUCTURES COMMITTEE _____ DATE _____</p> <p>NOTE: LOCATION OF UNDERGROUND STRUCTURES AS SHOWN ARE BASED ON THE BEST INFORMATION AVAILABLE BUT NO GUARANTEE IS GIVEN THAT ALL EXISTING UTILITIES ARE SHOWN OR THAT THE GIVEN LOCATIONS ARE EXACT. CONFIRMATION OF EXISTENCE AND EXACT LOCATION OF ALL SERVICES MUST BE OBTAINED FROM THE INDIVIDUAL UTILITIES BEFORE PROCEEDING WITH CONSTRUCTION.</p>	<p>B.M. 40-020 ELEV. 237.963m</p>	<p>Stantec Consulting Ltd. 905 Waverley Street, Winnipeg, Manitoba Tel 204-489-5900 Fax 204-453-9012</p>	<p>ENGINEER'S SEAL</p>	<p>THE CITY OF WINNIPEG WATER AND WASTE DEPARTMENT</p>	<p>2011 SEWER RENEWALS BY CIPP LINING - CONTRACT 21 GIBRALTAR BAY (E. LEG) MH AT GIBRALTAR BY. (S. LEG) (PL) TO MH AT GIBRALTAR BY. (N. LEG) (PL)</p>	<p>SHEET OF 117 OF 119</p> <p>CAD FILE DRAWING NUMBER 13220c-207-766.dwg</p> <p>CITY DRAWING NUMBER 9883</p>																				
							<table border="1"> <tr> <th>NO.</th> <th>REVISIONS</th> <th>DATE</th> <th>BY</th> </tr> <tr> <td> </td> <td> </td> <td> </td> <td> </td> </tr> </table>	NO.	REVISIONS	DATE	BY					<table border="1"> <tr> <td>DESIGNED BY</td> <td>J.K.H.</td> <td>CHECKED BY</td> <td>W.A.B.</td> </tr> <tr> <td>DRAWN BY</td> <td>K.R.</td> <td>APPROVED BY</td> <td>H.A.K.</td> </tr> <tr> <td>HOR. SCALE:</td> <td>1:500</td> <td>RELEASED FOR CONSTRUCTION:</td> <td> </td> </tr> <tr> <td>VERTICAL:</td> <td>N/A</td> <td>DATE</td> <td> </td> </tr> </table>	DESIGNED BY	J.K.H.	CHECKED BY	W.A.B.	DRAWN BY	K.R.	APPROVED BY	H.A.K.	HOR. SCALE:	1:500
NO.	REVISIONS	DATE	BY																							
DESIGNED BY	J.K.H.	CHECKED BY	W.A.B.																							
DRAWN BY	K.R.	APPROVED BY	H.A.K.																							
HOR. SCALE:	1:500	RELEASED FOR CONSTRUCTION:																								
VERTICAL:	N/A	DATE																								

\\CD1201-F02\work_group\1112\active\111213220\drawing\402_design\sheet_files\13220c-207-766.dwg
 Date: 2011-12-20 9:17am Login: Ammeter, Wes