

ROAD AND APPROACH- SECTION  
N.T.S.

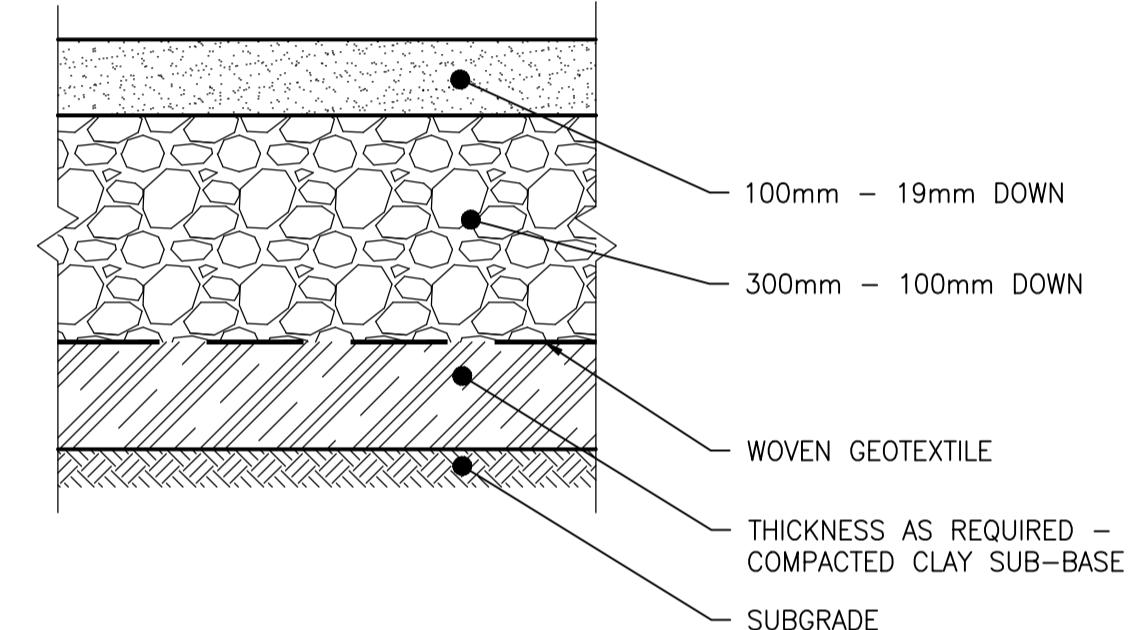

INTERIOR DUMPING AREA - SECTION  
N.T.S.

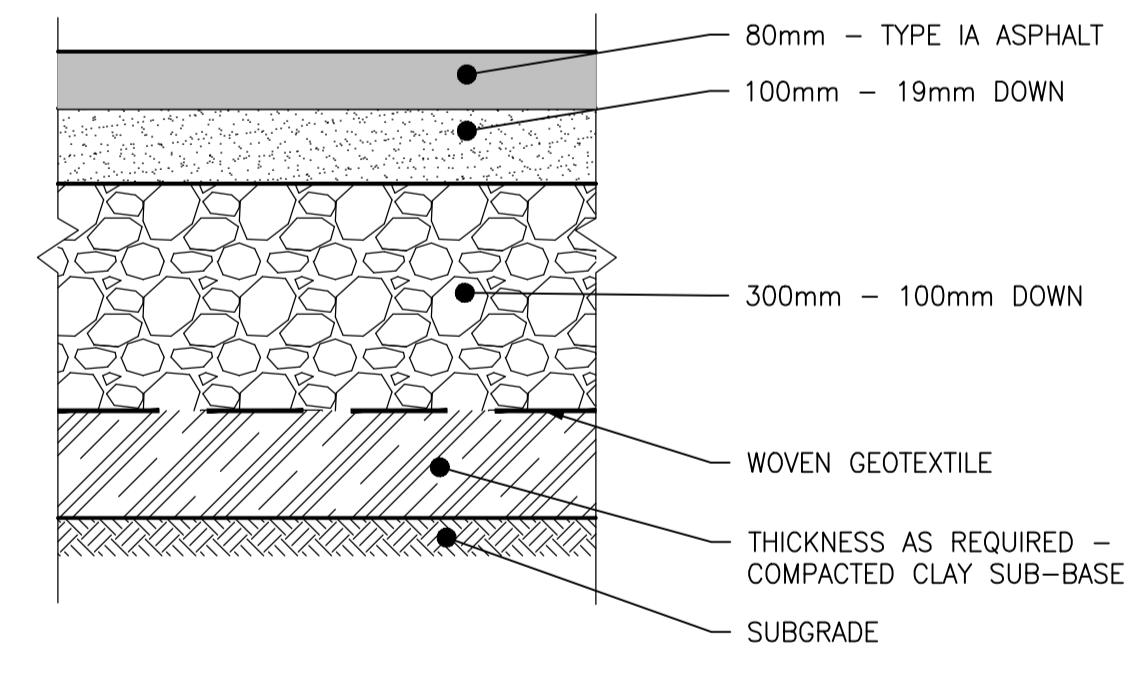

ASPHALT PAD - SECTION  
N.T.S.

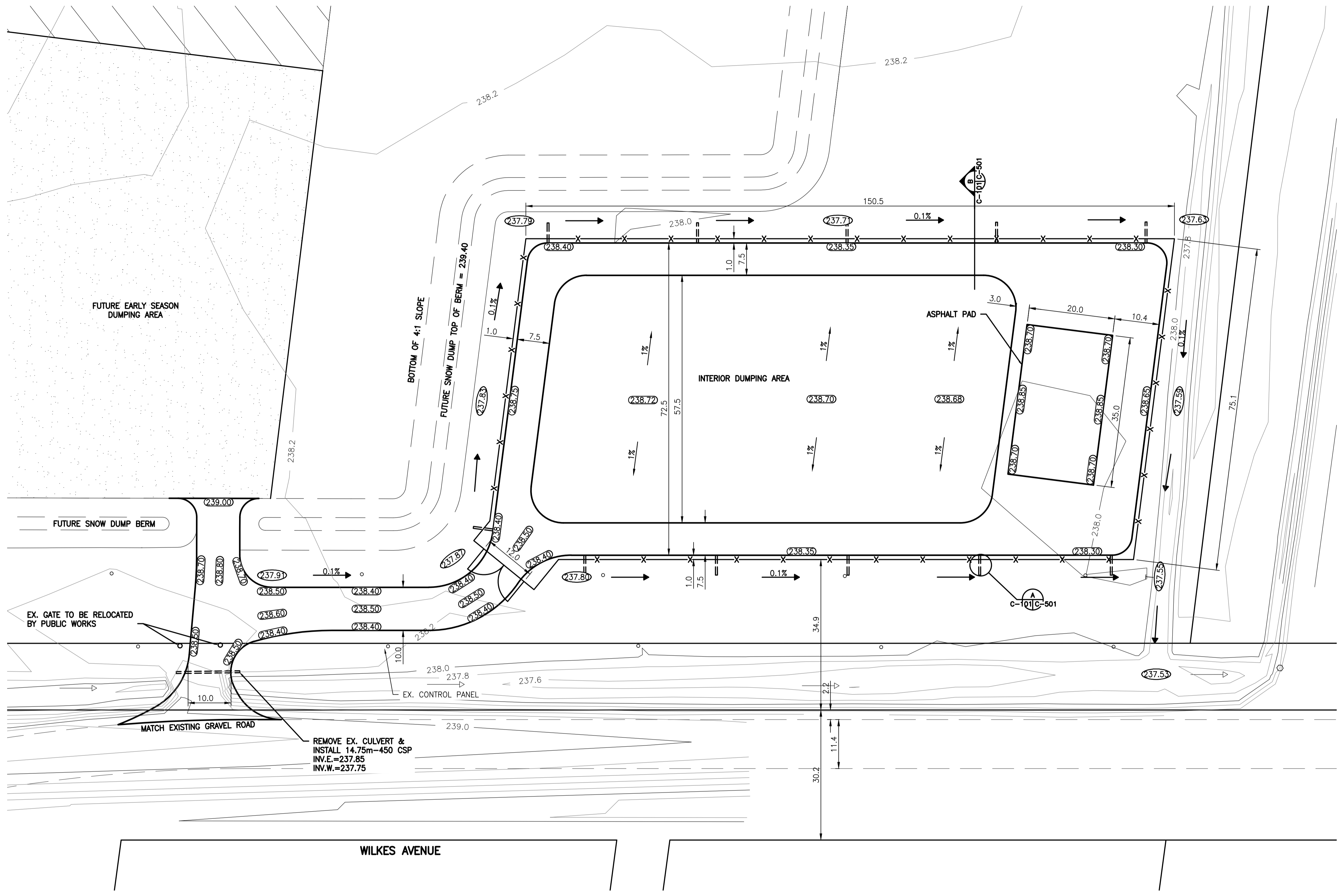

**APEGM**  
Certificate of Authorization  
Stantec Consulting Ltd.  
No. 1301 Date: \_\_\_\_\_

BENCH MARK: - D.B.M., S. of Manitoba Pool Elevator, N. of P.R. 427, 480 m W. of Perimeter Hwy, 14.6 m S. of line of S. wall of office, 4.6 m E. of E. wall of office.

BID OPPORTUNITY 108-2012

**WARNING**

IF POWER EQUIPMENT OR EXPLOSIVES ARE TO BE USED FOR EXCAVATION ON THIS PROJECT THE CONTRACTOR MUST:  
1) NOTIFY THE GAS COMPANY OF THE PROPOSED LOCATION OF EXCAVATION.  
2) TAKE PRECAUTION TO AVOID DAMAGE TO GAS COMPANY INSTALLATIONS.  
SEE PROVINCIAL REGULATION 140/92 FOR DETAILS

**METRIC**

WHOLE NUMBERS INDICATE MILLIMETRES  
DECIMALIZED NUMBERS INDICATE METRES

EXISTING	LEGEND-PLAN	PROPOSED	EXISTING	LEGEND-PLAN	PROPOSED
○	HYDRO POLE	○	— — — —	GAS	— — — —
—	ROAD ELEVATION	238.80	— — — —	HYDRO	— — — —
—	SWALE ELEVATION	238.80	— — — —	M.T.S.	— — — —
—	ELEVATION CONTOUR	238.8	— — — —	GRAVEL	— — — —
—	CULVERT	—	— — — —	ASPHALT	— — — —
			— — — —	SIDEWALK	— — — —
			— — — —	PROPERTY LINE	— — — —
			— — — —	SURVEY BAR	— — — —
			— — — —	DITCH	— — — —
			— — — —	GATE	— — — —
			— — — —	FENCE	— — — —

**LOCATION APPROVED UNDERGROUND STRUCTURES**  
SUPV. U/G STRUCTURES COMMITTEE DATE \_\_\_\_\_  
NOTE:  
LOCATION OF UNDERGROUND STRUCTURES AS SHOWN ARE BASED ON THE BEST INFORMATION AVAILABLE BUT NO GUARANTEE IS GIVEN THAT ALL EXISTING UTILITIES ARE SHOWN OR THAT THE GIVEN LOCATIONS ARE EXACT. CONFIRMATION OF EXISTENCE AND EXACT LOCATION OF ALL SERVICES MUST BE OBTAINED FROM THE INDIVIDUAL UTILITIES BEFORE PROCEEDING WITH CONSTRUCTION.

NO.	REVISIONS	DATE	BY

**Stantec Consulting Ltd.**  
905 Waverley Street, Winnipeg, Manitoba  
Tel 204-489-5900 Fax 204-453-9012

DESIGNED BY	R.M.S.	CHECKED BY	H.A.K.
DRAWN BY	R.M.S.	APPROVED BY	H.A.K.
HOR. SCALE:	1:500	RELEASED FOR CONSTRUCTION:	
VERTICAL:		DATE	

ENGINEER'S SEAL  
ORIGINAL SEALED BY  
R.M. SHERLOCK  
P. ENG.  
12/02/02  
CONSULTANT DRAWING NO.  
C-101

**THE CITY OF WINNIPEG**  
PUBLIC WORKS DEPARTMENT  
STREET MAINTENANCE DIVISION

**WILKES AVENUE SNOW DUMP**  
MARSHALLING YARD  
SITE PLAN

SHEET 1 OF 3  
CAD FILE DRAWING NUMBER  
13300c-101-710.dwg  
CITY DRAWING NUMBER

V:\112\winnipeg\11213300\drawings\102\_design\sheet\_01.dwg 13300c-101-710.dwg 2012 February 02 10:18 am