

- 0+73.11 EXIST BEND
- 0+74.52 EXIST BEND
- 0+76.21 EXIST 250X250X150 TEE
- 0+76.67 EXIST VALVE
- 0+77.22 EXIST 250X250X150 TEE
- 0+78.921 S & R GRAHAM AVE
- 0+85.06 EXIST 250X250X250 CROSS
- 0+93.85 EXIST 250X250X250 TEE
- 0+99.71 EXIST VALVE
- 1+00.00 N E GRAHAM AVE
- 1+02.03 REMOVE EXIST REDUCER & CONNECT TO EXIST 250 PVC WM
- 1+03.73 REMOVE EXIST BEND
- 1+05.23 EXIST BEND
- 1+05.83 EXIST COUPLING
- 1+25
- 1+50
- 1+62.80 INSTALL HYDRANT (SD-006)
- 1+66.21 ABANDON EXIST VALVE
- 1+75
- 1+86.88 REMOVE EXIST 150X150X150 TEE & INSTALL 250X250X150 TEE
- 1+93.72 REMOVE EXIST HYDRANT
- 2+00 MATCHLINE

WATER SERVICE INFORMATION

ADDRESS	SIZE (mm) MATERIAL (STREET)	SIZE (mm) MATERIAL (PROP.)	SHORT & LONG MEASUREMENT	CORP. LOCATION	REMARKS
270 FORT ST COMMERCIAL	50 COPPER	50 COPPER	5.02 NSL BLDG	3.0 N OF S/C	-
280 FORT ST COMMERCIAL	20 COPPER	20 COPPER	7.62 NSL BLDG	OPP S/C	RENEW TO 25 COPPER
280 FORT ST SPRINKLER	150 PVC	150 PVC	13.40 NSL BLDG	OPP VALVE	-
			86.80 NNL GRAHAM		

*SERVICES TO BE RENEWED TO R. ALL OTHERS TO BE RECONNECTED

NOTE: CHAINAGES SHOWN ARE ALONG E. R. OF FORT ST.

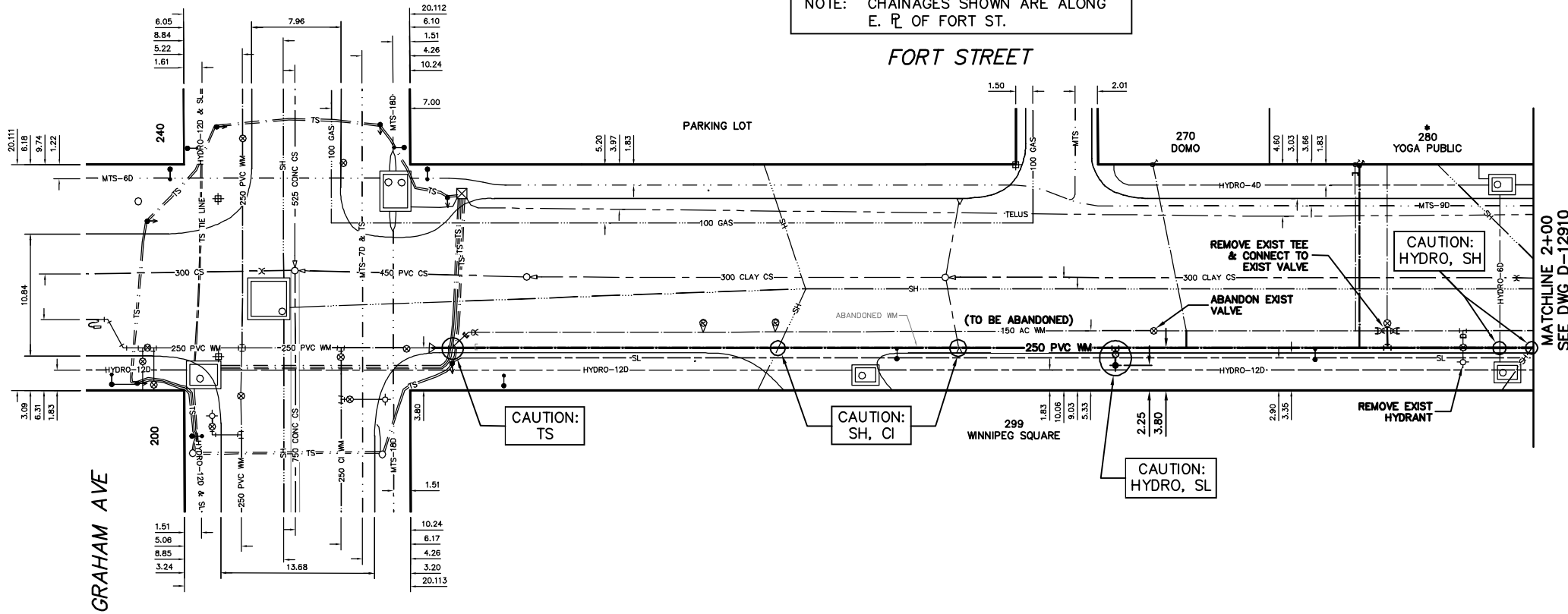

MATCHLINE 2+00
SEE DWG D-12910

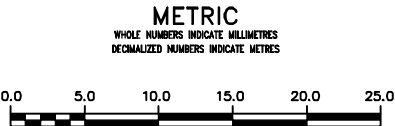

WARNING
IF POWER EQUIPMENT OR EXPLOSIVES ARE TO BE USED FOR EXCAVATION ON THIS PROJECT THE CONTRACTOR MUST:
1) NOTIFY THE GAS COMPANY OF THE PROPOSED LOCATION OF EXCAVATION.
2) TAKE PRECAUTION TO AVOID DAMAGE TO GAS COMPANY INSTALLATIONS.
SEE PROVINCIAL REGULATION 21072 FOR DETAILS

LOCATION APPROVED UNDERGROUND STRUCTURES
SUPV. U/G STRUCTURES COMMITTEE DATE
NOTE:
LOCATION OF UNDERGROUND STRUCTURES AS SHOWN ARE BASED ON THE BEST INFORMATION AVAILABLE BUT NO GUARANTEE IS GIVEN THAT ALL EXISTING UTILITIES ARE SHOWN OR THAT THE GIVEN LOCATIONS ARE EXACT. CONFIRMATION OF EXISTENCE AND EXACT LOCATION OF ALL SERVICES MUST BE OBTAINED FROM THE INDIVIDUAL UTILITIES BEFORE PROCEEDING WITH CONSTRUCTION.

B.M. ELEV.	
CONSTRUCTION COMPLETION DATE: YYYY MM DD	
NO.	REVISIONS
	DATE
	BY
	DATE

DESIGNED BY	NC	CHECKED BY	SC
DRAWN BY	CJH	APPROVED BY	KZ
SCALE:		RELEASED FOR CONSTRUCTION	
HORIZONTAL	1:250		
VERTICAL	1:50		
DATE	2012 03 21	DATE	
PLOT DATE:	2012 03 22		

ENGINEER'S SEAL
ORIGINAL SIGNED BY S.R.J. COURNOYER 12-03-21
CONSULTANT DRAWING NUMBER

THE CITY OF WINNIPEG
Winnipeg
WATER AND WASTE DEPARTMENT
ENGINEERING DIVISION
2012 WATERMAIN RENEWALS
FORT STREET
GRAHAM AVENUE TO
100 N OF GRAHAM AVENUE
SHEET 4 OF 10
CITY DRAWING NUMBER
D-12909

NOTE: ALL VALVES TO BE INSTALLED COUNTER-CLOCKWISE TO CLOSE