

WATER SERVICE INFORMATION					
ADDRESS	SIZE (mm) MATERIAL (STREET)	SIZE (mm) MATERIAL (PROP.)	SHORT & LONG MEASUREMENT	CORP. LOCATION	REMARKS
390 CORK AVE	-	-	4.23 W OF E HL	-	-
RESIDENTIAL	-	-	106.82 WM SALTER	-	-
388 CORK AVE	-	-	2.03 E OF W HL	-	-
RESIDENTIAL	-	-	96.37 WM SALTER	-	-
384 CORK AVE	-	-	8.46 W IF E HL	-	-
RESIDENTIAL	-	-	82.25 WM SALTER	-	-
385 CORK AVE	100	100	15.73 W OF E BL	OPP VALVE	RENEW W/ 150 PVC
SPRINKLER	CI	CI	63.54 WM SALTER	-	-
380 CORK AVE	-	-	5.50 W OF E HL	-	-
RESIDENTIAL	-	-	79.90 WM SALTER	-	-
376 CORK AVE	20	20	8.32 W OF E HL	OPP OF S/C	-
RESIDENTIAL	COPPER	COPPER	51.09 WM SALTER	-	-
372 CORK AVE	-	-	6.34 W OF E HL	-	-
RESIDENTIAL	-	-	33.43 WM SALTER	0.2 E OF S/C	-
368 CORK AVE	-	-	4.93 W OF E HL	-	-
RESIDENTIAL	-	-	19.91 WM SALTER	-	-
1154 SALTER ST	-	-	5.14 W OF E HL	-	SERVICED OFF
RESIDENTIAL	-	-	8.31 WM SALTER	-	CORK AVE
1162 SALTER ST	-	-	4.97 N OF S HL	-	-
RESIDENTIAL	-	-	9.15 NML CORK	-	-
1 VERA BY	-	-	6.97 E OF W HL	-	-
RESIDENTIAL	-	-	10.06 EEL SALTER	-	-
1154 SALTER ST	-	-	4.89 E OF W HL	-	-
RESIDENTIAL	-	-	10.03 EEL SALTER	-	-

SERVICES TO BE RENEWED TO R. ALL OTHERS TO BE RECONNECTED

NOTE: CHAINAGES SHOWN ARE ALONG S. P. OF CORK AVE.

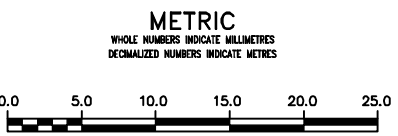
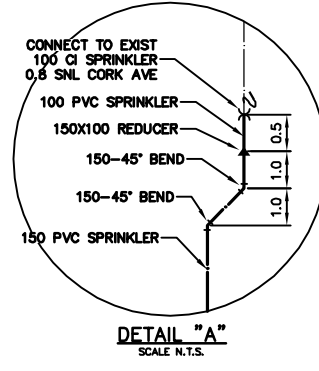
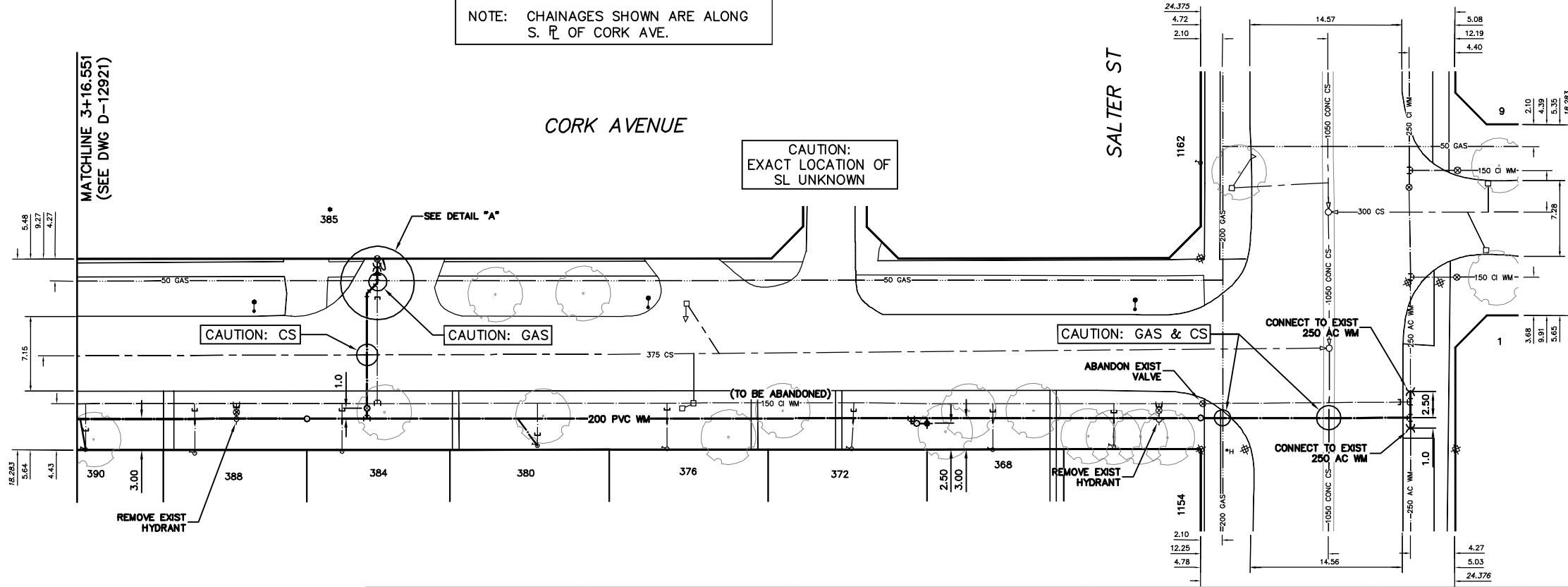

**WARNING**  
IF POWER EQUIPMENT OR EXPLOSIVES ARE TO BE USED FOR EXCAVATION ON THIS PROJECT THE CONTRACTOR MUST:  
1) NOTIFY THE GAS COMPANY OF THE PROPOSED LOCATION OF EXCAVATION.  
2) TAKE PRECAUTION TO AVOID DAMAGE TO GAS COMPANY INSTALLATIONS.  
SEE PROVINCIAL REGULATION 21072 FOR DETAILS

**LOCATION APPROVED UNDERGROUND STRUCTURES**  
SUPV. U/G STRUCTURES COMMITTEE DATE  
NOTE:  
LOCATION OF UNDERGROUND STRUCTURES AS SHOWN ARE BASED ON THE BEST INFORMATION AVAILABLE BUT NO GUARANTEE IS GIVEN THAT ALL EXISTING UTILITIES ARE SHOWN OR THAT THE GIVEN LOCATIONS ARE EXACT. CONFIRMATION OF EXISTENCE AND EXACT LOCATION OF ALL SERVICES MUST BE OBTAINED FROM THE INDIVIDUAL UTILITIES BEFORE PROCEEDING WITH CONSTRUCTION.

B.M. ELEV.	
CONSTRUCTION COMPLETION DATE: YYYY MM DD	
NO.	REVISIONS
	DATE
	BY
	DATE

DESIGNED BY	RL	CHECKED BY	SC
DRAWN BY	RSVCJH	APPROVED BY	KZ
SCALE:		RELEASED FOR CONSTRUCTION	
HORIZONTAL	1:250		
VERTICAL	1:50		
DATE	2012 03 27	DATE	
PLOT DATE:	2012 03 27		

ENGINEER'S SEAL  
ORIGINAL SIGNED BY S.R.J. COURNOYER 12-03-27  
CONSULTANT DRAWING NUMBER

**THE CITY OF WINNIPEG**  
Winnipeg  
WATER AND WASTE DEPARTMENT  
ENGINEERING DIVISION  
2012 WATERMAIN RENEWALS  
CORK AVENUE  
74 E OF HANNA STREET TO SALTER STREET

SHEET 6 OF 12  
CITY DRAWING NUMBER  
D-12922