

REFERENCE NOTES

- A. PAVEMENT DIMENSIONS ARE TO BACK OF CURB
- B. BASELINE IS CENTRE LINE RIGHT-OF-WAY
- C. PROPERTY LINES OBTAINED FROM CITY OF WINNIPEG L.B.I.S., AND NO SCALE FACTOR WAS APPLIED
- D. REFER TO AECOM FIELD BOOK NO. 4744

CONSTRUCTION NOTES

1. PLACE NEW ASPHALTIC PAVEMENT TYPE 1A (AVERAGE THICKNESS 80mm)
2. REMOVE EXISTING CONCRETE PAVEMENT AND CONSTRUCT NEW 200mm REINFORCED CONCRETE PAVEMENT *clw* 85mm ASPHALT OVERLAY
3. REMOVE EXISTING CONCRETE PAVEMENT AND CONSTRUCT NEW 200mm REINFORCED CONCRETE PAVEMENT
4. REMOVE EXISTING CATCHPIT AND INSTALL NEW CURB AND GUTTER INLET COMPLETE WITH CATCHPIT AND CONNECT TO EXISTING CATCH BASIN (SD-023)
5. ADJUST EXISTING MANHOLE/CATCH BASIN TO GRADE
6. INSTALL NEW CAST IRON RISER RING
7. CONSTRUCT NEW BARRIER CURB (150mm HT.)
8. CONSTRUCT NEW MODIFIED BARRIER CURB (150mm HT. DOWELLED)
9. ADJUST EXISTING WATER VALVE TO GRADE
10. RENEW EXISTING 100mm CONCRETE SIDEWALK
11. ADJUST EXISTING CURB STOP
12. REMOVE AND REINSTALL EXISTING PAVERS
13. ADJUST EXISTING MTS MANHOLE

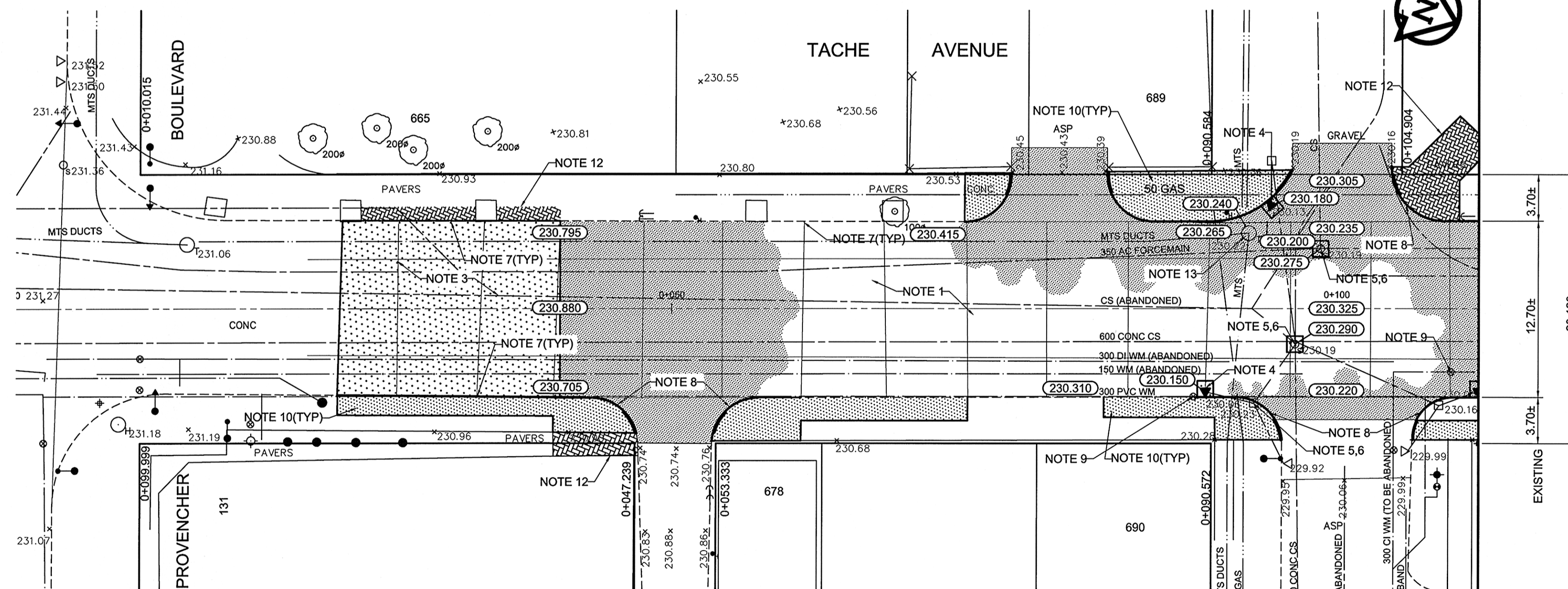

METRIC
WHOLE NUMBERS INDICATE MILLIMETRES
DECIMALIZED NUMBERS INDICATE METRES

EXISTING	LEGEND - PLAN	PROPOSED	EXISTING	LEGEND - PLAN	PROPOSED	EXISTING	LEGEND - PROFILE	PROPOSED
150 mm W.W.	WATERMAIN	150 mm W.W.	HYDRO	CONCRETE	CONCRETE	---	C PROFILE	---
300mm L.D.S.	LAND DRAINAGE SEWER	300mm L.D.S.	CONCRETE	ASPHALT	ASPHALT	---	NORTH/WEST GUTTER	---
250mm W.W.S.	WASTEWATER SEWER	250mm W.W.S.	PROPERTY LINE	PROPERTY LINE	---	---	SOUTH/EAST GUTTER	---
○	MANHOLE	○	SURVEY BAR	SURVEY BAR	---	---	N/W PROPERTY LINE	---
□	CATCH BASIN	□	ELEVATION	ELEVATION	(35.750)	---	S/E PROPERTY LINE	---
▽	CURB INLET	▽	TREE	TREE	---	---	---	---
---	JUNCTIONS	---	SIDEWALK RAMP	SIDEWALK RAMP	---	---	---	---
---	CULVERT	---	CONCRETE SIDEWALK	CONCRETE SIDEWALK	---	---	---	---
---	GAS	---	FENCE	FENCE	---	---	---	---

LOCATION APPROVED UNDERGROUND STRUCTURES

SUPV. U/G STRUCTURES COMMITTEE DATE

NOTE:
LOCATION OF UNDERGROUND STRUCTURES AS SHOWN ARE BASED ON THE BEST INFORMATION AVAILABLE. BUT NO GUARANTEE IS GIVEN THAT ALL EXISTING UTILITIES ARE SHOWN OR THAT THE GIVEN LOCATIONS ARE EXACT. CONFIRMATION OF EXISTENCE AND EXACT LOCATION OF ALL SERVICES MUST BE OBTAINED FROM THE INDIVIDUAL UTILITIES BEFORE PROCEEDING WITH CONSTRUCTION.

B.M. M10R104
ELEV. 231.146
Clip in 0.46m diam. concrete pile located in Blvd. on SE corner of Tache ave. and Rue Masson, 1.90m East of most Eastern edge of sidewalk on Eastside of Tache and 2.16m SW of light standard in front of 120 Rue Masson.

NO.	REVISIONS	DATE	BY
0	ISSUED FOR TENDER	04/13/2012	BC
A	ISSUED FOR REVIEW	03/28/2012	BC

AECOM

DESIGNED BY	SS	CHECKED BY	KWR
DRAWN BY	MS	APPROVED BY	
HOR. SCALE:	1:250	RELEASED FOR CONSTRUCTION BY:	
VERTICAL:	1:10	DATE	April 13/12

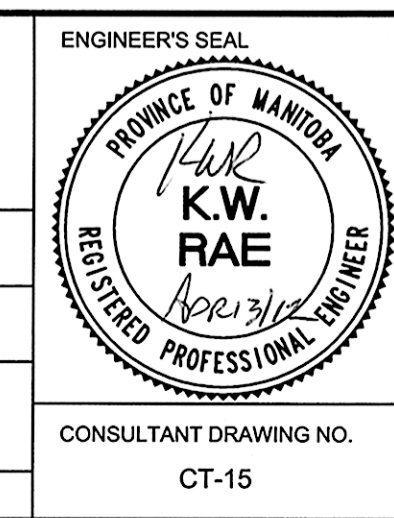

THE CITY OF WINNIPEG
PUBLIC WORKS DEPARTMENT
ENGINEERING DIVISION

2012 LOCAL STREET RENEWAL PROGRAM

TACHE AVE. - BOUL PROVANCHER TO RUE LA VERENDRYE
PAVEMENT REHABILITATION
STATION 0+025.4 TO STATION 0+110

CITY DRAWING NUMBER
SHEET 15 OF 19

CONSULTANT DRAWING NO.
CT-15