

MARK	REQ'D	SIZE AND SHAPE	LENGTH	REMARKS
P1	17	12"Ø	50'-0"	
P2	1	12"Ø	29'-10"	
P3	17	18"Ø	50'-0"	
P4	1	18"Ø	29'-10"	

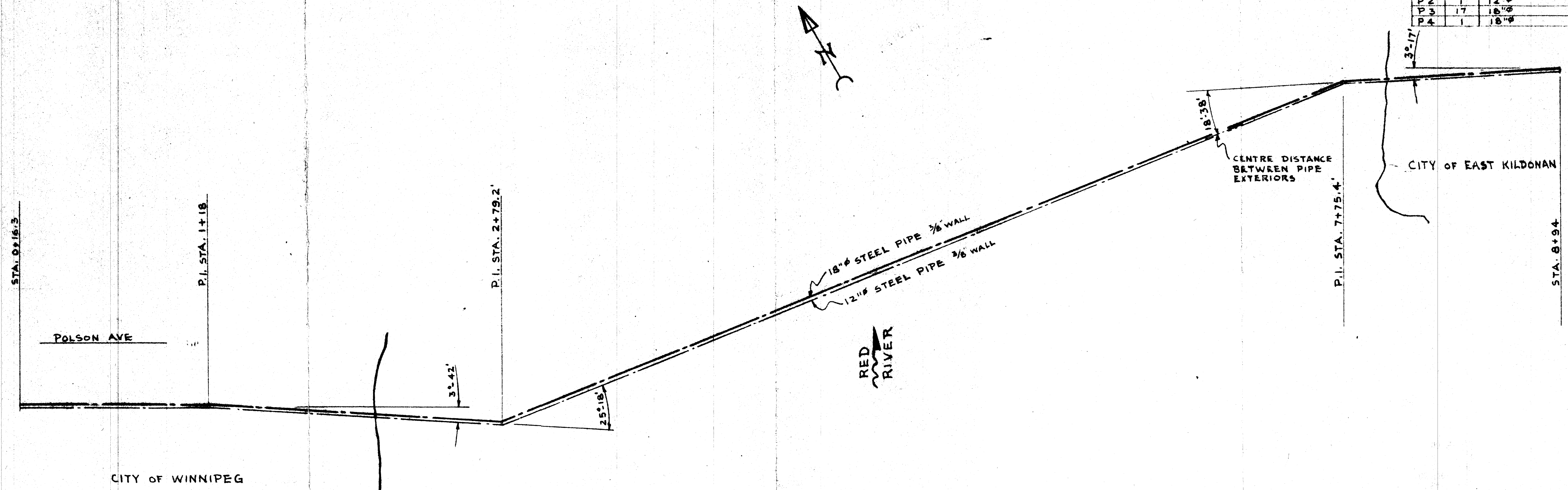

PLAN
RED RIVER CROSSING

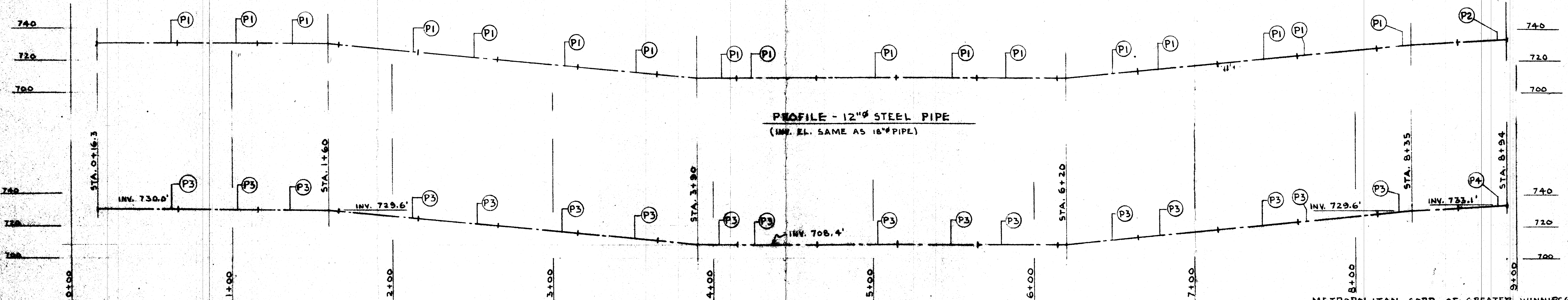

PROFILE - 12"Ø STEEL PIPE
(INV. EL. SAME AS 18"Ø PIPE)

PROFILE - 18"Ø STEEL PIPE

NOTE
ALL PIPE JOINTS & ELBOWS TO BE FIELD WELDED.
TERMINAL FLANGES & CONC. RINGS TO BE FIELD WELDED.

This drawing is the property of Armo Drainage & Metal Products of Canada Ltd. and must be returned in cases of not ordering material referred to or cancellation of order given.
The design and relevant details which appear on this drawing must not be used or disclosed and must not be reproduced either in whole or in part without the written permission. Permitted reproductions shall bear this notice.

METROPOLITAN CORP. OF GREATER WINNIPEG

ARMCO DRAINAGE & METAL PRODUCTS OF CANADA LTD.
WINNIPEG - MANITOBA

CUSTOMER WATERWORKS & WASTE DISPOSAL DIVISION

SUBJECT: RED RIVER CROSSING - MUNROE PUMPING
STA. TO POLSON AVE COMM. STA.

TYPE 12"Ø & 18"Ø STEEL PIPE	DRAWN BY M.W.H.
PAINT	CHECKED BY
FASTENERS	REVISED
CUST. DWG. No. 503	CUST. ORDER No.
BY WATERWORKS & WASTE DISP. DIV.	SCALE 1"=30'
DATE NOV. 30/64	DWG. No. W-53-M

1304