

294 SUPERSEDED BY 294A

Note original 294 Rev 2 with any REF. or DRAWING NO. Revision 4
 Note this also 294
 (Also have revision on Rev 7 made 1/10/57)
 294A (Rev 7)

DETAILS

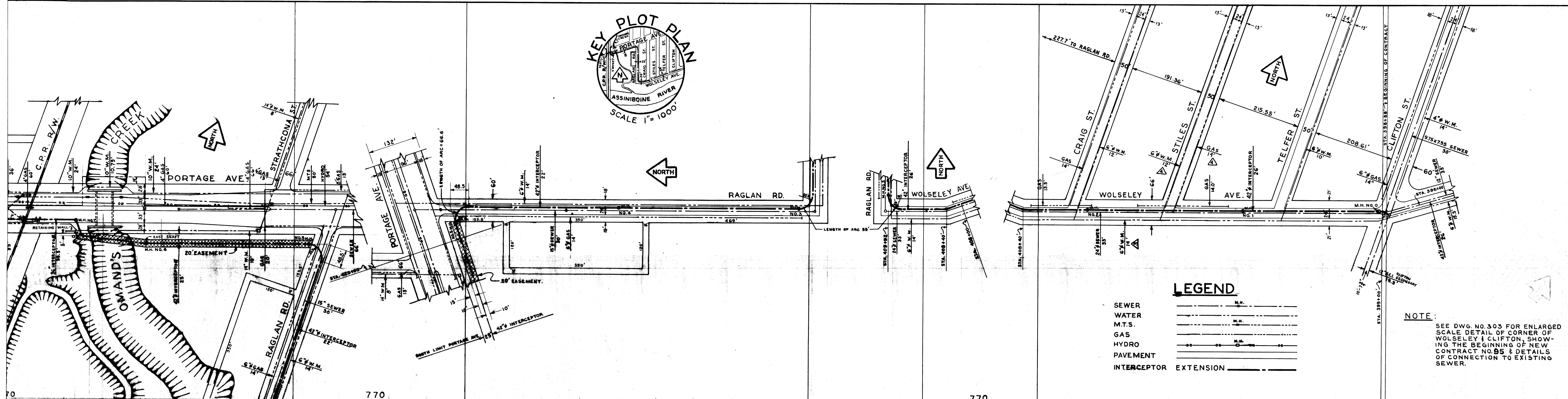
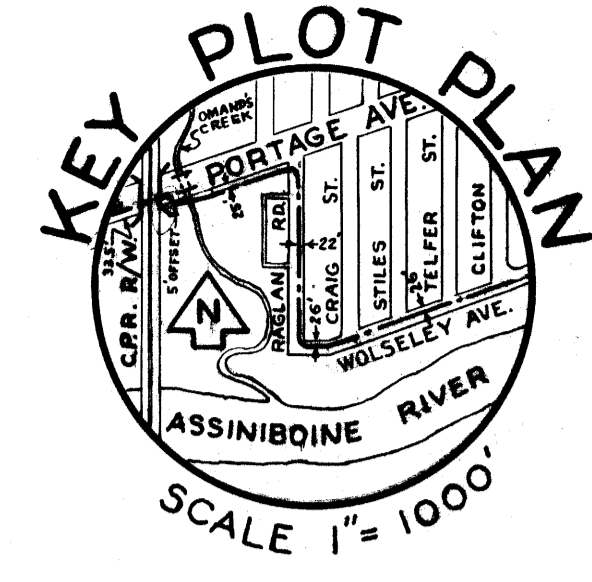

LEGEND

| | | |
|-----------------------|-----|------|
| SEWER | --- | M.H. |
| WATER | --- | M.H. |
| M.T.S. | --- | M.H. |
| GAS | --- | M.H. |
| HYDRO | --- | M.H. |
| PAVEMENT | --- | M.H. |
| INTERCEPTOR EXTENSION | --- | M.H. |

NOTE:
 SEE DWG. NO. 303 FOR ENLARGED SCALE DETAIL OF CORNER OF WOLSELEY & CLIFTON, SHOWING THE BEGINNING OF NEW CONTRACT NO. 95 & DETAILS OF CONNECTION TO EXISTING SEWER.

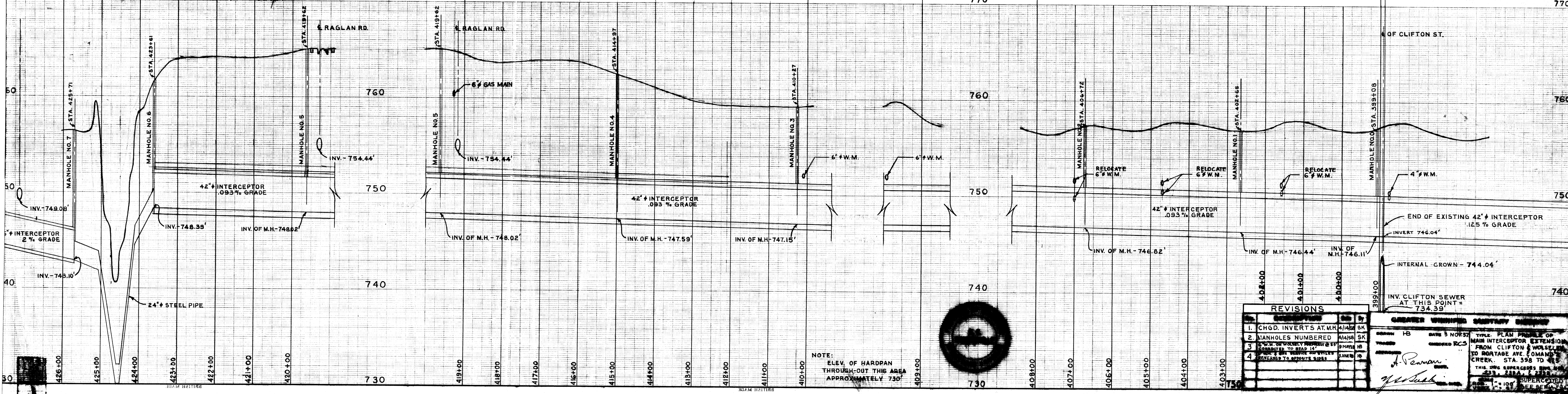

NOTE:
 ELEV. OF HARDPAN THROUGH-OUT THIS AREA APPROXIMATELY 730'

| REVISIONS | | | |
|-----------|--------------------------|----------|----|
| NO. | DESCRIPTION | DATE | BY |
| 1 | CHGD. INVERTS AT M.H. | 11/14/56 | SK |
| 2 | MANHOLES NUMBERED | 11/14/56 | SK |
| 3 | RELOCATED TO ROAD 14' | 11/14/56 | SK |
| 4 | RELOCATED TO APPROPRIATE | 11/14/56 | SK |