

power pole required for electrical access; power req'd below desk too.

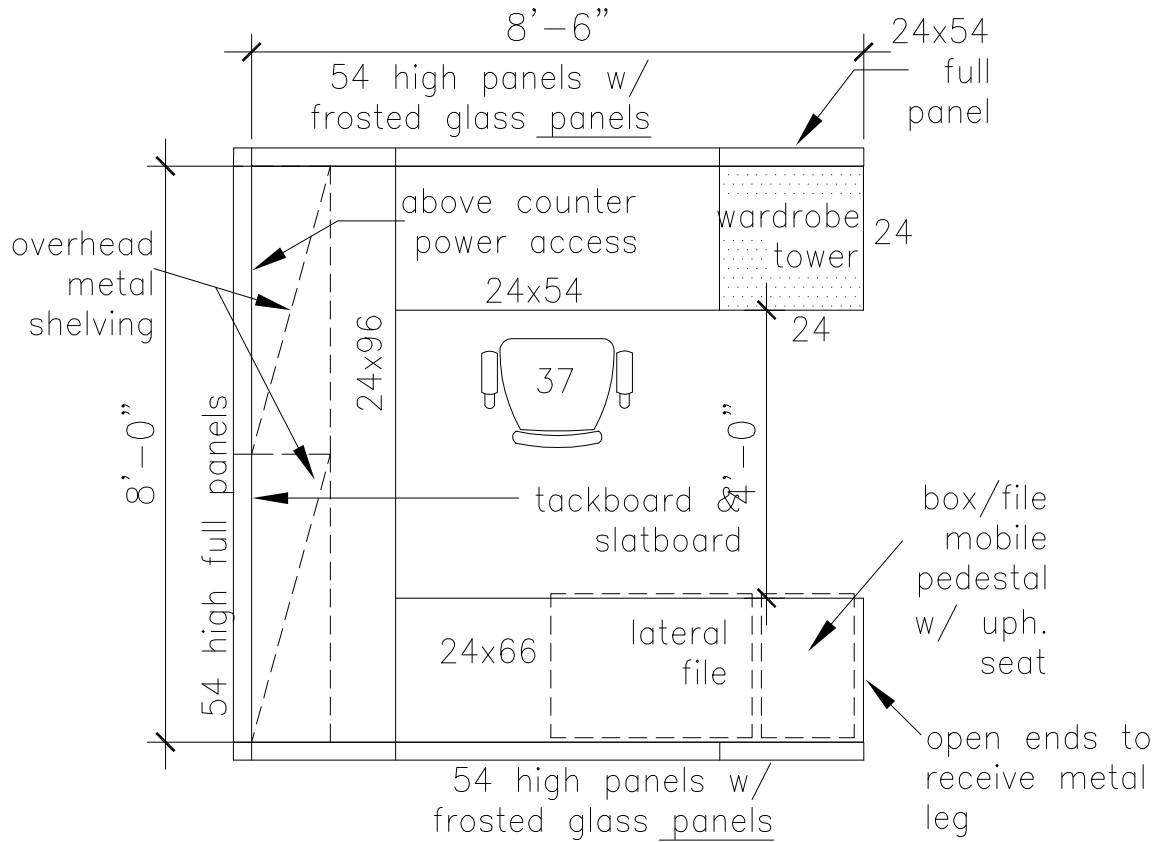

SWS Clerks workstation

 THE CITY OF WINNIPEG PLANNING, PROPERTY AND DEVELOPMENT DEPARTMENT MUNICIPAL ACCOMMODATIONS DIVISION 3-65 GARRY STREET, R3C 4K4		PROJECT SOLID WASTE/ IST RELOCATION 1120 WAVERLY STREET			SHEET TITLE SWS CLERKS WORKSTATIONS ENLARGED PLAN	
DRAWN BY:	CHECKED BY:	DESIGNED BY:	APPROVED BY:	DATE: 2012-04-05	SCALE: 3/8"=1'-0"	SHEET No:
KN		KN		eFILE:	PROJECT No: 2012-035	A7