

Note: refer to overall plan A1-R1 for complete layout.

power pole required for electrical access; power req'd below desk too.

Note: One slatwall accessory per desk required.

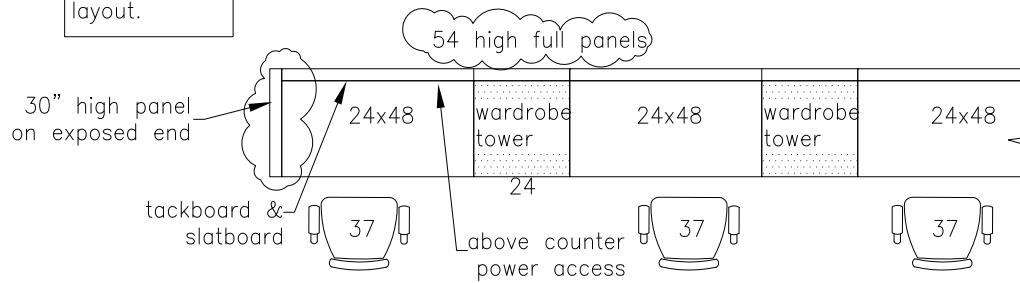

## SWS Student "hotelling" Desk

 THE CITY OF WINNIPEG PLANNING, PROPERTY AND DEVELOPMENT DEPARTMENT MUNICIPAL ACCOMMODATIONS DIVISION 3-65 GARRY STREET, R3C 4K4		PROJECT  <b>SOLID WASTE/ IST RELOCATION</b> 1120 WAVERLY STREET			SHEET TITLE <b>SWS STUDENTS TYPICAL DESK          ENLARGED PLAN</b>	
DRAWN BY:	CHECKED BY:	DESIGNED BY:	APPROVED BY:	DATE:	SCALE:	SHEET No:
KN		KN		2012-04-26	1/4"=1'-0"	<b>A10-R1</b>
				eFILE:	PROJECT No:	
					2012-035	