

FURNITURE LEGEND

- ITEM 1 IST TYPICAL WORKSTATION
- ITEM 2 TYPICAL PRIVATE OFFICE PLAN
- ITEM 3 SMS MANAGER'S DESK (#3)
- ITEM 4 IST MANAGER'S DESK (#1&8)
- ITEM 5 SMS "CLOSED" WORKSTATION
- ITEM 6 SMS CLERKS WORKSTATION
- ITEM 7 SMS "OPEN" WORKSTATIONS
- ITEM 8 SMS FIELD STAFF "HOTELLING" DESKS
- ITEM 9 SMS STUDENT DESKS
- ITEM 10 IST WORKROOM DESKS
- ITEM 11 IST CONSULTANT DESKS
- ITEM 12 MANUAL STORAGE SHELVES
- ITEM 13 TALL STORAGE CABINET - (PART OF IST WORKROOM DESK COMPONENTS)
- ITEM 14 3 DRAWER LATERAL FILES
- ITEM 15 SUPPLY CABINETS
- ITEM 16 END TAB FILING SHELVING
- ITEM 17 OPEN STORAGE SHELVING
- ITEM 18 FILE BOX STORAGE SHELVES
- ITEM 19 CUSTOM MAP STORAGE UNIT
- ITEM 20 MEETING ROOM TABLE - n.i.c
- ITEM 21 IST MEETING ROOM TABLE
- ITEM 22 BOARDROOM TABLES
- ITEM 23 MEDIASCAPE STOOL HEIGHT TABLE
- ITEM 24 STOOL HEIGHT TABLES
- ITEM 25 LUNCH ROOM TABLES
- ITEM 26 COFFEE TABLE
- ITEM 27 STOOL HEIGHT COUNTERS OVER FILE CABINETS
- ITEM 28 PRIVATE OFFICE ROUND MEETING TABLES
- ITEM 29 STROUS
- ITEM 30 LUNCH ROOM/BOARDROOM STACKING CHAIRS
- ITEM 31 LUNGE SEATING
- ITEM 32 ARMLESS TABLE CHAIRS
- ITEM 33 OTTOMAN
- ITEM 34 NOT USED
- ITEM 35 IST TASK CHAIRS
- ITEM 36 SMS TASK CHAIRS
- ITEM 37 CONSULTANT/ MEETING ROOM CHAIRS
- ITEM 38 MEETING TABLE STOOL TASK CHAIRS
- ITEM 39 PRIVATE OFFICE GUEST CHAIRS
- ITEM 40 IST MANAGER WHITEBOARD 48"x76"
- ITEM 41 IST OFFICE WHITEBOARDS 48"x60"
- ITEM 42 WHITEBOARD 48"x96"
- ITEM 43 MOBILE WHITEBOARD
- ITEM 44 FULL HEIGHT WALL MOUNTED WHITEBOARDS
- ITEM 45 TACKBOARD
- ITEM 46 PODIUM/ LECTURN
- ITEM 47 MEETING ROOM CONSOLE
- ITEM 48 RECEPTION DESK WORKSTATION
- ITEM 49 COUNTERTOP OVER FILE CABINETS
- ITEM 50

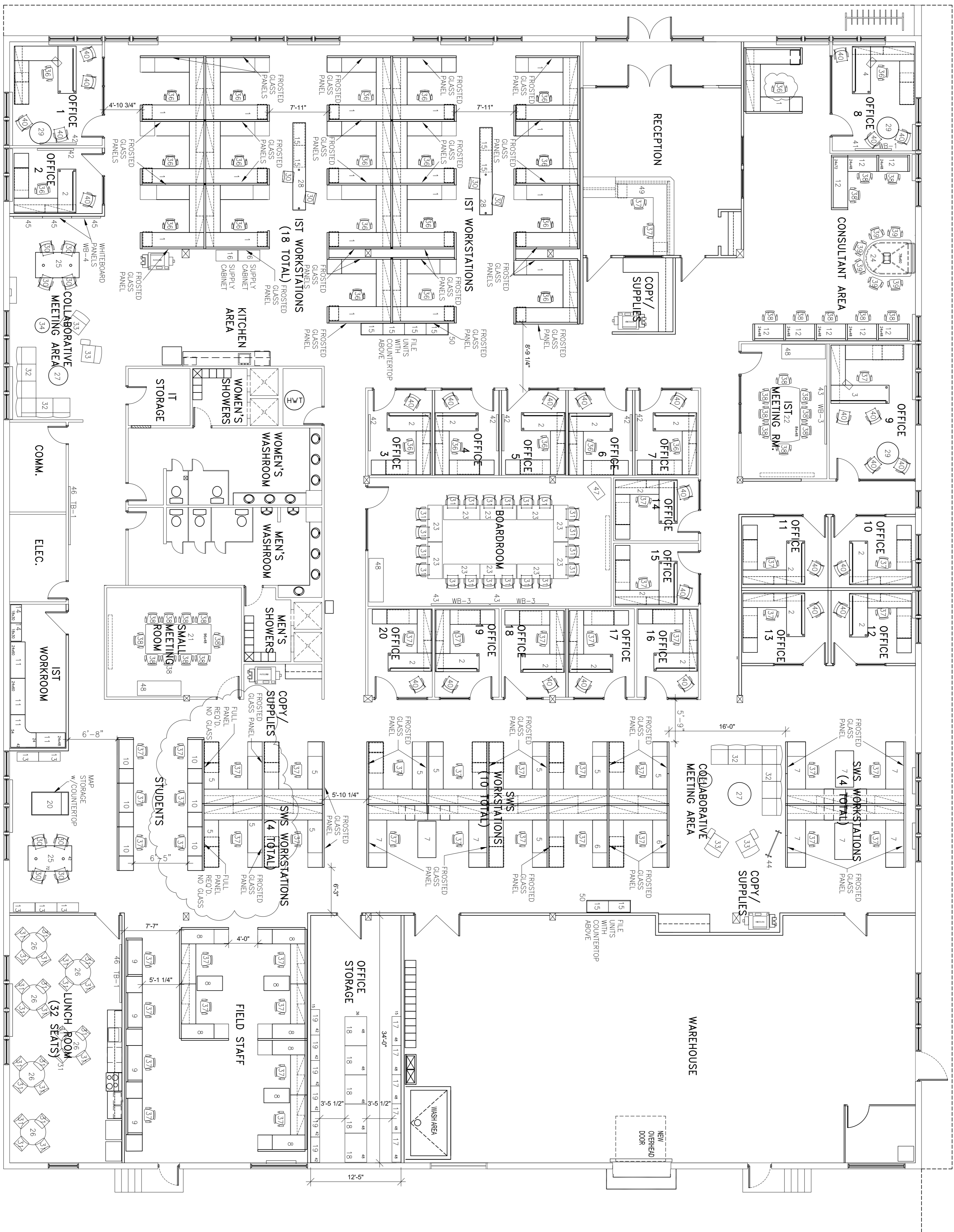

MAIN FLOOR PLAN - FURNITURE PLAN
SCALE: 1/8"=1'-0"



NOTES

- THESE DRAWINGS SHALL NOT BE SCALED.
- THE CONTRACTOR SHALL VERIFY THE SITE AND SIZES/CONCRETE OF ALL DIMENSIONS ON-PLANS AND DETAILED INFORMATION SHOWN ARE CORRECT.
- THE CONTRACTOR IS TO REVIEW AND CORRECT ALL ARCHITECTURAL, MECHANICAL, ELECTRICAL AND STRUCTURAL DRAWINGS FOR ADDITIONAL OPENINGS THROUGH FLOORS, WALLS AND CEILINGS FOR DUCT, PRE-ELECTRICAL RISERS AND ALL OPENINGS NOT SHOWN ON DRAWINGS.
- ALL OPENINGS THROUGH FLOOR ASSEMBLIES ARE TO BE PRE-STOPPED AND SEALED WITH ALL APPROVED PRE-STOPPING TO MAINTAIN THE INTEGRITY OF THE FLOOR SEPARATION AND PROVIDE A SMOKE-TIGHT BARRIER.
- ALL PRODUCTS AND MATERIALS TO BE USED AND INSTALLED SHALL CONFORM WITH MANUFACTURER'S SPECIFICATIONS & APPLICABLE CODES.
- THE CONTRACTOR SHALL BE RESPONSIBLE TO PATCH AND MAKE GOOD ALL EXISTING CONDITIONS AFFECTED BY THE REMOVAL OF ALL ITEMS REMAINING THE PART OF THE RECONSTRUCTION WORK.
- WHERE NEW FLOORING AND BASE IS TO BE INSTALLED IN EXISTING AREAS REFER TO FLOOR PLAN AND ROOM SCHEDULE. THE EXISTING FLOORING SURFACE AND BASE MUST BE REMOVED UNLESS OTHERWISE NOTED. ALL FLOOR SURFACES SHALL BE PREPARED IN ACCORDANCE TO MANUFACTURER'S RECOMMENDATIONS FOR INSTALLATION OF NEW FLOOR.
- WHERE PAINTING OF EXISTING WALLS IS INDICATED ON THE ROOM SCHEDULE, THESE WALLS MUST BE CLEANED OF ANY EXISTING WALL COVERING PATCHED & REPAIRED TO ACCEPT NEW MATERIAL UNLESS OTHERWISE NOTED.

No.	REVISION/DESCRIPTION	BY	DATE

DATE	USER	DESIGNED	APPROVED
2012/04/08			

THE CITY OF WINNIPEG
 PLANNING, PROPERTY AND
 DEVELOPMENT DEPARTMENT
 MUNICIPAL ACCOMMODATIONS DIVISION
 3-65 GARRY STREET, R3C 4K4
 PROJECT
 1120 WAVERLY STREET
 SOLID WASTE/IST RELOCATION

1120 WAVERLY STREET
 SHEET TITLE
 OVERALL FURNITURE PLAN