

WATER SERVICE INFORMATION

ADDRESS	SIZE (mm)	SIZE (mm)	SHORT & LONG MEASUREMENT	CORP. LOCATION	REMARKS
(STREET)	(MATERIAL)	(MATERIAL)	(PROP.)		
369 OAK ST RESIDENTIAL	20	20	1.67 NSL HSE	OPP S/C	-
372 OAK ST RESIDENTIAL	COPPER	COPPER	89.58>NNL GROSVENOR	OPP S/C	-
375 OAK ST RESIDENTIAL	12	12	1.86 NSL HSE	OPP S/C	RENEW TO 1/2 W/ 20 COPPER
375 OAK ST RESIDENTIAL	20	20	1.17 NSL HSE	OPP S/C	-
375 OAK ST RESIDENTIAL	COPPER	COPPER	78.30>NNL GROSVENOR	OPP S/C	-
376 OAK ST RESIDENTIAL	20	20	1.29 NSL HSE	OPP S/C	RENEW TO 1/2 W/ 20 COPPER
379 OAK ST RESIDENTIAL	COPPER	COPPER	77.07>NNL GROSVENOR	OPP S/C	-
379 OAK ST RESIDENTIAL	20	20	0.25 NSL HSE	OPP S/C	-
379 OAK ST RESIDENTIAL	COPPER	COPPER	63.35>NNL GROSVENOR	1.1 N OF S/C	-
380 OAK ST RESIDENTIAL	12	20	3.43 NSL HSE	OPP S/C	-
383 OAK ST RESIDENTIAL	COPPER	COPPER	87.19>NNL GROSVENOR	OPP S/C	-
383 OAK ST RESIDENTIAL	20	20	0.84 NSL HSE	OPP S/C	-
384 OAK ST RESIDENTIAL	COPPER	COPPER	52.65>NNL GROSVENOR	0.1 S OF S/C	-
384 OAK ST RESIDENTIAL	12	20	1.68 NSL HSE	OPP S/C	-
387 OAK ST RESIDENTIAL	COPPER	COPPER	53.31>NNL GROSVENOR	0.4 N OF S/C	-
387 OAK ST RESIDENTIAL	20	20	2.87 NSL HSE	OPP S/C	-
388 OAK ST RESIDENTIAL	COPPER	COPPER	41.27>NNL GROSVENOR	0.8 S OF S/C	-
388 OAK ST RESIDENTIAL	12	12	1.75 NSL HSE	OPP S/C	RENEW TO 1/2 W/ 20 COPPER
391 OAK ST RESIDENTIAL	12	12	40.29>NNL GROSVENOR	OPP S/C	-
391 OAK ST RESIDENTIAL	COPPER	LEAD	1.82 NSL HSE	OPP S/C	RENEW TO 1/2 W/ 20 COPPER
392 OAK ST RESIDENTIAL	COPPER	COPPER	28.38>NNL GROSVENOR	OPP S/C	-
392 OAK ST RESIDENTIAL	20	20	4.91 NSL HSE	OPP S/C	-
395 OAK ST RESIDENTIAL	COPPER	COPPER	30.71>NNL GROSVENOR	OPP S/C	-
395 OAK ST RESIDENTIAL	20	20	1.82 NSL HSE	OPP S/C	-
395 OAK ST RESIDENTIAL	COPPER	COPPER	15.49>NNL GROSVENOR	0.8 N OF S/C	-
398 OAK ST RESIDENTIAL	16	12	OPP SL HSE	1.5 S OF S/C	SHARED W/402
401 OAK ST RESIDENTIAL	20	20	13.97>NNL GROSVENOR	1.5 S OF S/C	RENEW TO 1/2 W/ 20 COPPER
401 OAK ST RESIDENTIAL	20	20	3.43 NSL HSE	OPP S/C	RENEW TO 1/2 W/ 20 COPPER
402 OAK ST RESIDENTIAL	LEAD	LEAD	4.21>NNL GROSVENOR	0.3 N OF S/C	-
402 OAK ST RESIDENTIAL	16	12	2.44 NSL HSE	OPP S/C	SHARED W/398
402 OAK ST RESIDENTIAL	LEAD	LEAD	13.55>NNL GROSVENOR	1.3 S OF S/C	RENEW TO 1/2 W/ 20 COPPER

*SERVICES TO BE RENEWED TO 1/2. ALL OTHERS TO BE RECONNECTED

NOTE: CHAINAGES SHOWN ARE ALONG E. R. OF OAK ST.

CAUTION: GAS, SL & CS ON W SIDE OF OAK ST

OAK STREET

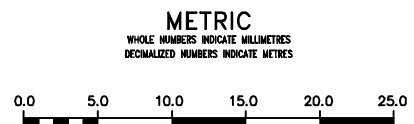
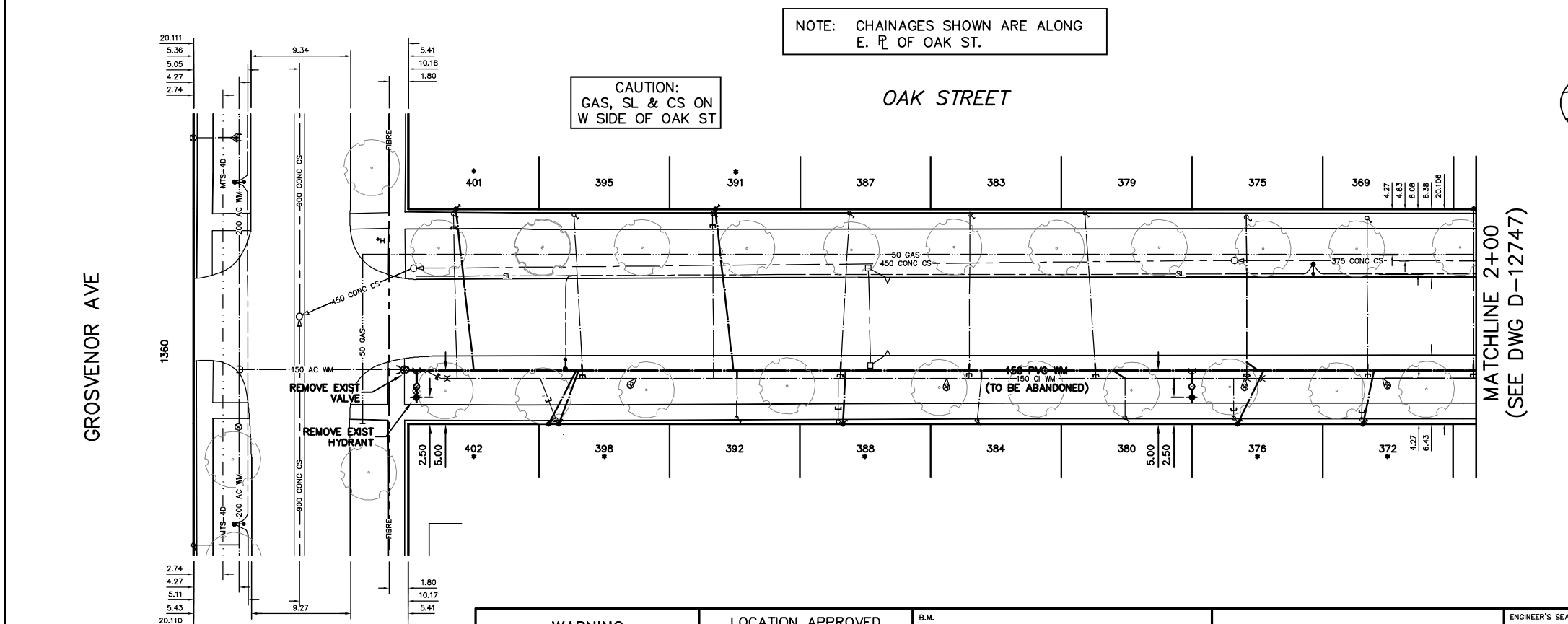

WARNING
IF POWER EQUIPMENT OR EXPLOSIVES ARE TO BE USED FOR EXCAVATION ON THIS PROJECT THE CONTRACTOR MUST:
1) NOTIFY THE GAS COMPANY OF THE PROPOSED LOCATION OF EXCAVATION.
2) TAKE PRECAUTION TO AVOID DAMAGE TO GAS COMPANY INSTALLATIONS.
SEE PROVINCIAL REGULATION 21072 FOR DETAILS

LOCATION APPROVED UNDERGROUND STRUCTURES
SUPV. U/G STRUCTURES COMMITTEE DATE _____
NOTE:
LOCATION OF UNDERGROUND STRUCTURES AS SHOWN ARE BASED ON THE BEST INFORMATION AVAILABLE BUT NO GUARANTEE IS GIVEN THAT ALL EXISTING UTILITIES ARE SHOWN OR THAT THE GIVEN LOCATIONS ARE EXACT. CONFIRMATION OF EXISTENCE AND EXACT LOCATION OF ALL SERVICES MUST BE OBTAINED FROM THE INDIVIDUAL UTILITIES BEFORE PROCEEDING WITH CONSTRUCTION.

B.M. ELEV.			
CONSTRUCTION COMPLETION DATE: YYYY MM DD			
DESIGNED BY	SC		
CHECKED BY	SC		
DRAWN BY	CJH		
APPROVED BY	KZ		
SCALE:			
HORIZONTAL	1:250		
VERTICAL	1:50		
RELEASED FOR CONSTRUCTION	KAS ZUREK		
NO.	REVISIONS	DATE	BY

ENGINEER'S SEAL
ORIGINAL SIGNED BY
S.R.J.
COURNOYER
12-03-28
CONSULTANT DRAWING NUMBER

THE CITY OF WINNIPEG
WATER AND WASTE DEPARTMENT
ENGINEERING DIVISION
2012 WATERMAIN RENEWALS
OAK STREET
GROSVENOR AVENUE TO
100 N OF GROSVENOR AVENUE
SHEET 9 OF 11
CITY DRAWING NUMBER
D-12746