

FLOOR PLAN

GENERAL NOTES

CONTRACTOR AND SUB-CONTRACTORS SHALL VERIFY ALL JOB SITE DIMENSIONS, ALL DRAWINGS, DETAILS, AND SPECIFICATIONS, AND REPORT ANY DISCREPANCIES TO CONTRACT ADMINISTRATOR  
PH. 204 233-9159, malvine@synergyinteriors.com

CONTRACTOR TO FAMILIARIZE THEMSELVES WITH THE BUILDING REGULATIONS AND ADHERE TO THE REGULATIONS SET FORTH BEFORE PROCEEDING WITH CONSTRUCTION.

CONTRACTOR TO FAMILIAR THEMSELVES WITH THE CITY OF WINNIPEG ACCESSIBILITY GUIDELINES 2010 FOR THIS PROJECT

CONTRACTOR TO ENSURE CONTINUOUS MAINTENANCE OF SITE DURING CONSTRUCTION OR PROTECTION OF ALL MATERIALS AND WORK DONE TO DATE.

REFERENCE SYMBOLS

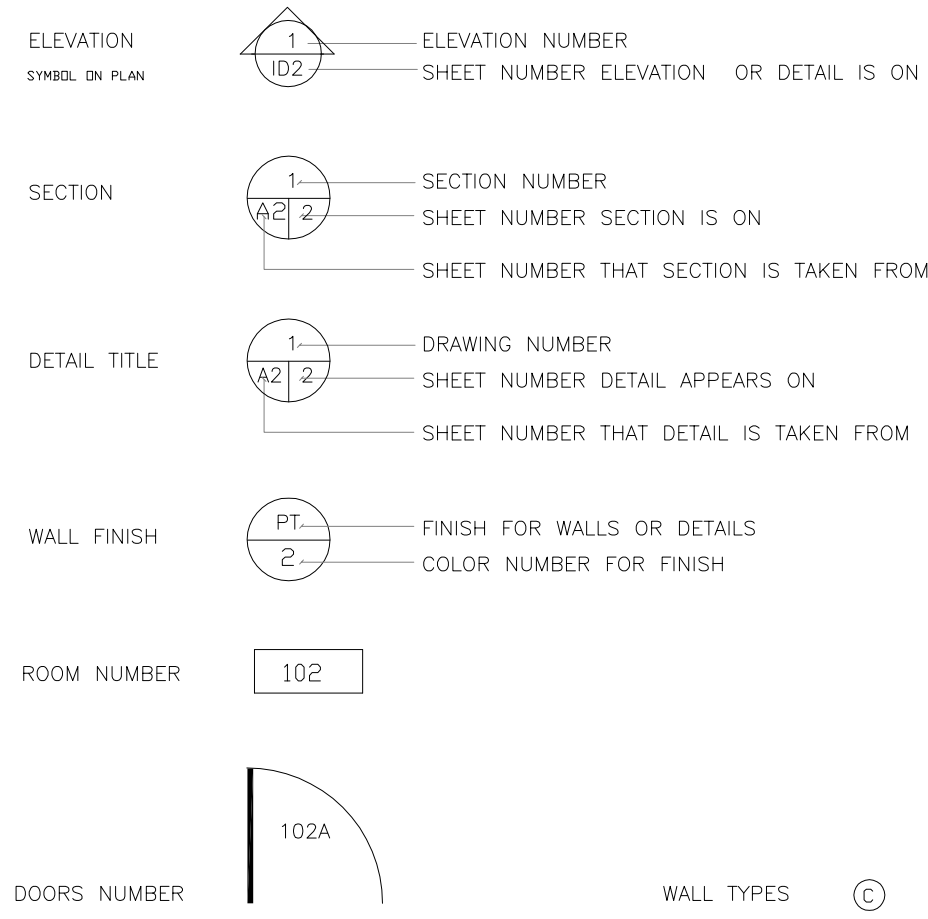

DO NOT SCALE DRAWINGS

CONTRACTOR SHALL FIELD VERIFY ALL JOB CONDITIONS AND DIMENSIONS, VARIATIONS THEREOF FROM THE DRAWINGS MUST BE REPORTED TO CONTRACT ADMINISTRATOR

DETAILS INDICATED ON THE DRAWINGS ARE REPRESENTATIVE AND TYPICAL, ALL ATTACHMENTS AND CONNECTIONS SHALL CONFORM TO BEST PRACTICE AND SHALL BE THE CONTACTOR'S RESPONSIBILITY.

THE INTENT OF THE DRAWINGS IS TO INCLUDE ALL MATERIAL, LABOR, EQUIPMENT AND SERVICES NECESSARY FOR THE COMPLETION OF ALL WORK SHOWN, DESCRIBED OR REASONABLY IMPLIED.

DRAWING INDEX

- ARCHITECTURAL  
 A-1 FLOOR PLAN, KEY PLAN, DOOR & ROOM SCHEDULE  
 GENERAL NOTES, DOOR HARDWARE  
 A-2 REFLECTED CEILING PLAN, LIGHTING SPECIFICATIONS  
 DEMOLITION PLAN, MATERIAL LIST, PLUMBING LIST  
 ELECTRICAL LAYOUT  
 A-3 ELEVATIONS, HARDWARE SPECIFICATIONS  
 A-4 MILLWORK SECTIONS  
 A-5 EXTERIOR WINDOW DETAILS  
 A-6 EXTERIOR WINDOW SPECIFICATIONS

ELECTRICAL

- E01 EXISTING KITCHEN, ELECTRICAL PLANS & SCOPE OF WORK  
 E02 ELECTRICAL SPECIFICATIONS & SCOPE OF WORK

MECHANICAL

- M01 PLUMBING DEMOLITION  
 M02 PLUMBING NEW  
 M03 HVAC DEMOLITION  
 M04 HVAC NEW  
 M05 MECHANICAL SPECIFICATIONS

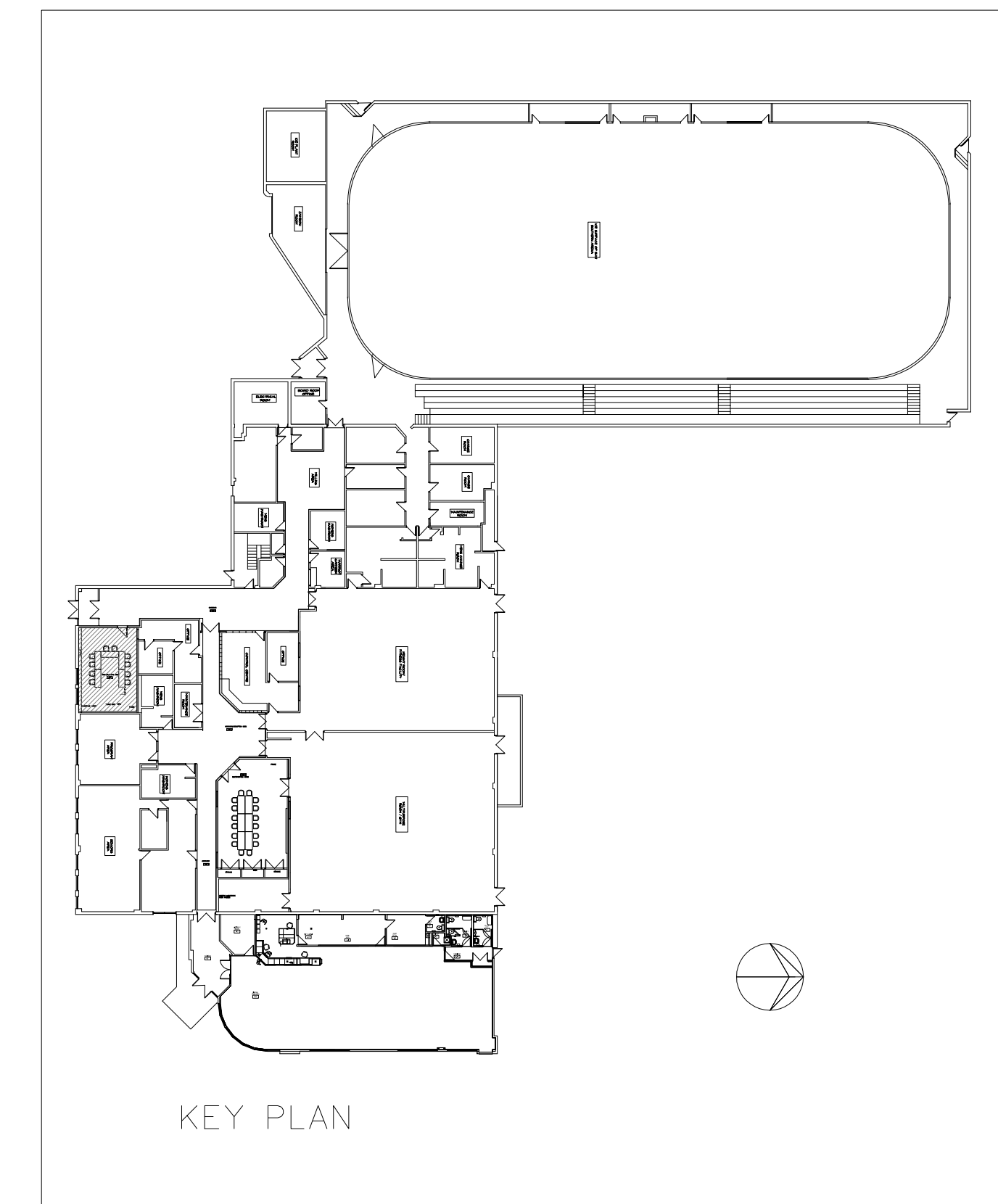

KEY PLAN

SCHEDULE OF FINISH HARDWARE PC12-S01 ALLMAR DISTRIBUTORS

Group #	Door Qty.	Description
1	1	D1
3		HINGES 3CB1HW 4 1/2" X 4 1/2" 652 IE
1		LOCKSET ND70PD RHG 626 SC
1		MORTISE CYLINDER 20-001 1 1/4" 626 SC
1		AUTO OPERATOR 9531 STD AL LC
1		KICKPLATE_050" K10A 12" X 37" 32D SM
1		DOOR STOP GSH 209 C26D GA
2		36" ACTUATOR INGRESS'IR - 3 XX
1		ELECTRIC STRIKE 1006 J SQUARE CORNERS & FLAT 630HE
1		POWER TRANSFER FACEPLATE CEPT SU
1		KEY SWITCH MKA SU

KEYSWITCH TO ACTIVATE AND DE-ACTIVATE OUTSIDE ACTUATOR WHEN ROOM IS LOCKED

ROOM FINISH SCHEDULE

AREA NO.	AREA NAME	FLOOR	BASEBOARDS				WALLS				CEILINGS		REMARKS
			NORTH	WEST	EAST	SOUTH	NORTH	WEST	EAST	SOUTH	HT.	MAT'L	
01	KITCHEN	EXISTING	R.C.B.	R.C.B.	MILLWORK	EXISTING	PT 5	PT 5	PT 7	PT 5	11'-0"	T & G	NEW CEILING TO MATCH EXISTING HEIGHT

DOOR SCHEDULE

NUMBER	NOMINAL SIZE	DOOR		CORE	FINISH	COLOR	HDWE	FRAME			U.L. FIRE RESISTANCE RATING	REMARKS
		TYPE	MAT'L					MAT'L	FINISH	COLOR		
D1	NEW 39" x 84"	1	STEEL	SOLID	PT	1						NEW DOOR, FRAME & HARDWARE WINDOW AS PER ELEVATION

GWB CEILING IN MULTIPURPOSE ROOM PAINT TYPE 8 INCLUDED VERTICAL GWB MEMBERS  
 ALL DOORS & FRAMES IN CORRIDORS TO BE PAINT TYPE 6  
 EXISING COUNTER IN RECEPTION AREA EXISTING PL.LAM TO RE REMOVED AND NEW PL. LAMINATE TO BE APPLIES TYPE 4  
 DOOR HARDWARE ALLMAR DISTRIBUTORS

NO.	DATE	DESCRIPTION	BY
-----	------	-------------	----

DRAWN BY: PRINTING DATE

The contractor is to verify dimensions and data noted herein with conditions on the site and is held responsible for reporting any discrepancy to the contract administrator for adjustment.

Bid Opportunity No. 300-2012



SYNERGY ARCHITECTURAL INTERIORS  
 13 Rosewarne Avenue WINNIPEG, MB Canada R2M 0V8  
 204 233 9159  
 malvine@synergyinteriors.com

DATE APRIL 20, 2012 SCALE 1/4"= 1'-0" REVISIONS

DRAWN BY M.G. CHECKED BY M.G.

KITCHEN UPGRADES & RENOVATIONS  
 FORT ROUGE LEISURE CENTER 625 OSBORNE ST SOUTH  
 WINNIPEG, MANITOBA

PROJECT SHEET  
 FLOOR PLANS, KEY PLAN, DOOR & ROOM SCHEDULE  
 GENERAL NOTES, DOOR HARDWARE,  
 AUTOCAD NUMBER DWG. A-1