

WORK AREA NO.1
SCALE 1/8"=1'0"

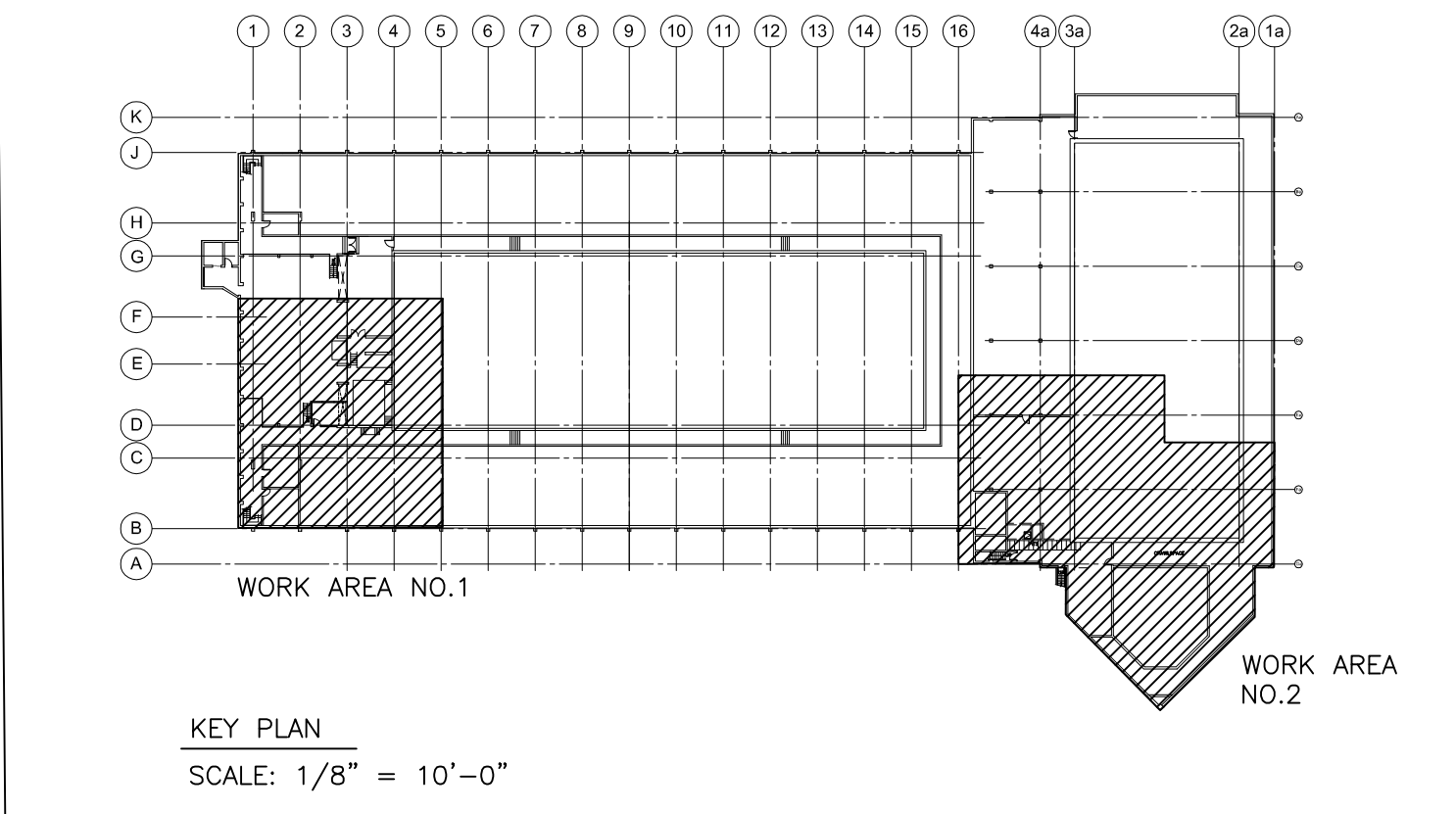
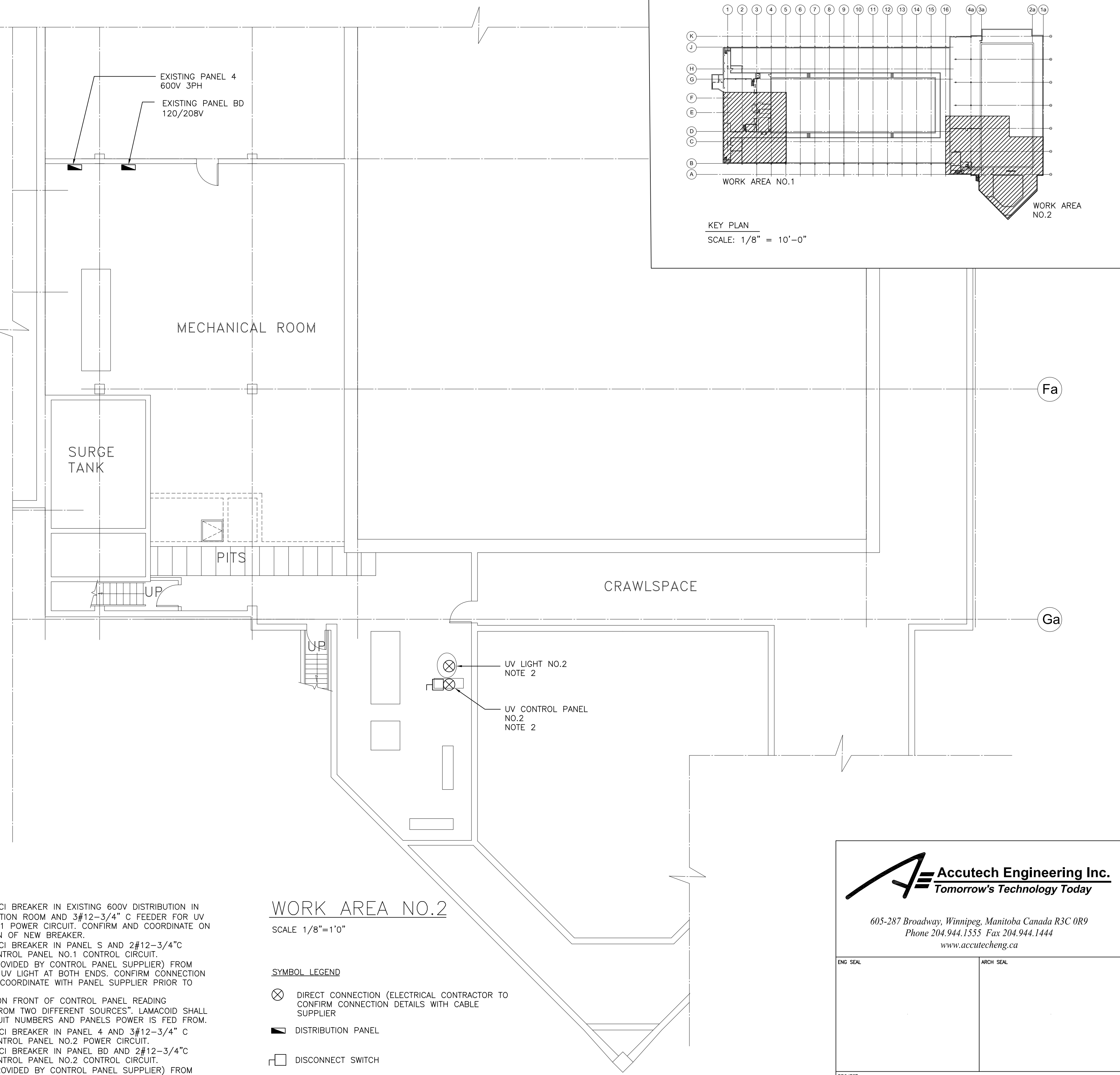

- NOTES:
1. PROVIDE 20A 3P GFCI BREAKER IN EXISTING 600V DISTRIBUTION IN ELECTRICAL DISTRIBUTION ROOM AND 3#12-3/4" C FEEDER FOR UV CONTROL PANEL NO.1 POWER CIRCUIT. CONFIRM AND COORDINATE ON SITE EXACT LOCATION OF NEW BREAKER.
PROVIDE 20A 1P GFCI BREAKER IN PANEL S AND 2#12-3/4" C FEEDER FOR UV CONTROL PANEL NO.1 CONTROL CIRCUIT.
CONNECT CABLE (PROVIDED BY CONTROL PANEL SUPPLIER) FROM CONTROL PANEL TO UV LIGHT AT BOTH ENDS. CONFIRM CONNECTION REQUIREMENTS AND COORDINATE WITH PANEL SUPPLIER PRIOR TO PRICING.
PROVIDE LAMACOID ON FRONT OF CONTROL PANEL READING "WARNING: POWER FROM TWO DIFFERENT SOURCES". LAMACOID SHALL ALSO INDICATE CIRCUIT NUMBERS AND PANELS POWER IS FED FROM.
 2. PROVIDE 15A 3P GFCI BREAKER IN PANEL 4 AND 3#12-3/4" C FEEDER FOR UV CONTROL PANEL NO.2 POWER CIRCUIT.
PROVIDE 20A 1P GFCI BREAKER IN PANEL BD AND 2#12-3/4" C FEEDER FOR UV CONTROL PANEL NO.2 CONTROL CIRCUIT.
CONNECT CABLE (PROVIDED BY CONTROL PANEL SUPPLIER) FROM CONTROL PANEL TO UV LIGHT AT BOTH ENDS. CONFIRM CONNECTION REQUIREMENTS AND COORDINATE WITH PANEL SUPPLIER PRIOR TO PRICING.
PROVIDE LAMACOID ON FRONT OF CONTROL PANEL READING "WARNING: POWER FROM TWO DIFFERENT SOURCES". LAMACOID SHALL ALSO INDICATE CIRCUIT NUMBERS AND PANELS POWER IS FED FROM.
 3. CONFIRM THESE BREAKER AND FEEDER SIZES WITH CONTROL PANEL SUPPLIER PRIOR TO PRICING. BREAKER AND FEEDER SIZES TO SUIT SUPPLIER'S NEEDS.

WORK AREA NO.2
SCALE 1/8"=1'0"

- SYMBOL LEGEND**
- ⊗ DIRECT CONNECTION (ELECTRICAL CONTRACTOR TO CONFIRM CONNECTION DETAILS WITH CABLE SUPPLIER)
 - ▬ DISTRIBUTION PANEL
 - ⊞ DISCONNECT SWITCH



605-287 Broadway, Winnipeg, Manitoba Canada R3C 0R9
Phone 204.944.1555 Fax 204.944.1444
www.accutech.ca

ENG SEAL	ARCH SEAL
----------	-----------

PROJECT			
CITY OF WINNIPEG			
PAN AM POOL UV PIPING			
SHEET TITLE			
PAN AM POOL UV LIGHT ADDITION ELECTRICAL LAYOUTS			
DRAWN BY	CHECKED BY	DATE	SHEET NO
VCV	BKW	APR 05 2012	E01
DESIGNED BY	CHECKED BY	SCALE	REVISION NO
BKW	KRD	AS NOTED	0