

B SIZE 11" X 17" (279mm x 432mm)

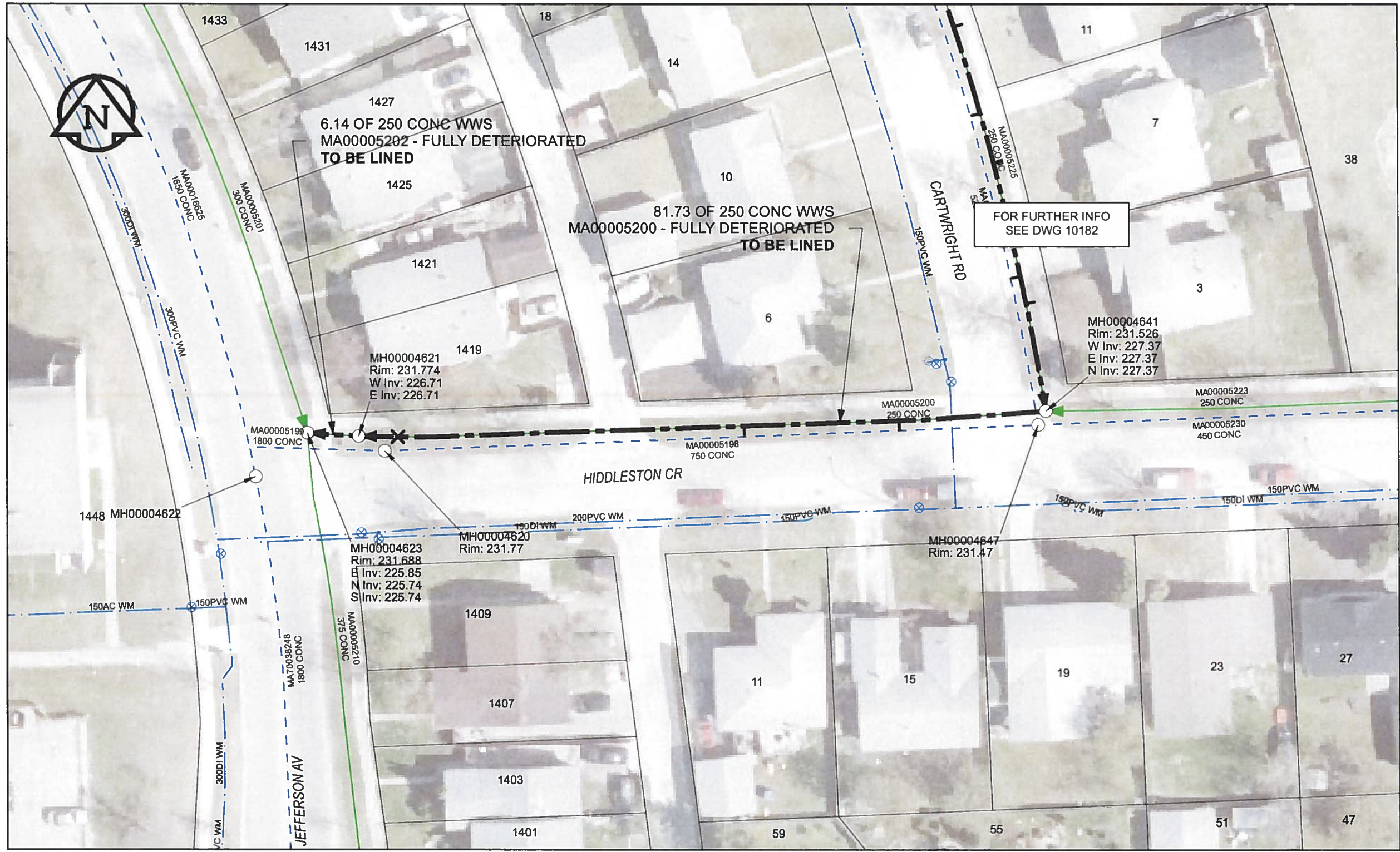

SEWER JUNCTION INFORMATION

REF MH*	DIST FROM* REF MH	SIZE*	CLOCK AT*
MH00004641	17.5	150Ø	10
MH00004641	35.9	150Ø	10
MH00004641	77.1	150Ø	12

*JUNCTION INFORMATION FROM VIDEO INSPECTION

WARNING

IF POWER EQUIPMENT OR EXPLOSIVES ARE TO BE USED FOR EXCAVATION ON THIS PROJECT, THE CONTRACTOR MUST:

- 1) NOTIFY THE GAS COMPANY OF THE PROPOSED LOCATION OF EXCAVATION.
- 2) TAKE PRECAUTION TO AVOID DAMAGE TO GAS COMPANY INSTALLATIONS.

SEE PROVINCIAL REGULATION 140/92 FOR DETAILS

AECOM

Certificate of Authorization

AECOM Canada Ltd.

No. 4671 Date: *June 21/12*

METRIC

WHOLE NUMBERS INDICATE MILLIMETRES
DECIMALIZED NUMBERS INDICATE METRES

0 2.5 5 10 15 20

█ Meters

BID OPPORTUNITY NO. 374-2012

AECOM REVIEW	DRFT CHK	FILE NAME: 190.pdf Saved By: JZ	LOCATION APPROVED UNDERGROUND STRUCTURES		Can-Net GPS Reference Station WINN/810
	AD		SUPR. U/G STRUCTURES COMMITTEE	DATE	
<p>NOTE: LOCATION OF UNDERGROUND STRUCTURES AS SHOWN ARE BASED ON THE BEST INFORMATION AVAILABLE. BUT NO GUARANTEE IS GIVEN THAT ALL EXISTING UTILITIES ARE SHOWN OR THAT THE GIVEN LOCATIONS ARE EXACT. CONFIRMATION OF EXISTENCE AND EXACT LOCATION OF ALL SERVICES MUST BE OBTAINED FROM THE INDIVIDUAL UTILITIES BEFORE PROCEEDING WITH CONSTRUCTION.</p>					
NO.		ISSUED FOR CONSTRUCTION	12/06/18	JZ	
NO.		REVISIONS	YY/MM/DD	BY	

AECOM

DESIGNED BY	ALD	CHECKED BY	<i>cm</i>
DRAWN BY	JZ	APPROVED BY	<i>aw</i>
HOR. SCALE	1:500	RELEASED FOR CONSTRUCTION	<i>[Signature]</i>
VERT. SCALE	N/A	DATE	<i>12/06/18</i>

PROFESSIONAL'S SEAL

PROVINCE OF MANITOBA

[Signature]
K. FITCHETT
REGISTERED ENGINEER

CONSULTANT DRAWING NO.
60250984-01-C-190-R0X.mxd

THE CITY OF WINNIPEG

WATER AND WASTE DEPARTMENT

2012 SEWER RENEWALS
BY CIPP LINING
CONTRACT 9
HIDDLESTON CR S LEG

MH @CARTWRIGHT RD TO 1ST MH E OF JEFFERSON AV
1ST MH E JEFFERSON AV TO MH @JEFFERSON AV

SHEET 20 OF 84

CITY DRAWING NUMBER

10190 REV 0