

**CONSTRUCTION NOTES:**

- ALL DIMENSIONS ARE TO BACK OF CURB.
- ISOLATE MISCELLANEOUS ITEMS IN NEW CONCRETE WORKS AS PER SD-228C.
- LEGAL PLAN AND UNDERGROUND INFORMATION FROM CITY OF WINNIPEG LBIS.
- CONTRACTOR TO TAKE PRECAUTIONARY STEPS TO AVOID DAMAGE FROM CONSTRUCTION ACTIVITIES TO TREES WITHIN THE LIMITS OF CONSTRUCTION.
- LOCATION OF EXISTING SERVICES TO BE CONFIRMED IN THE FIELD BY THE CONTRACTOR.
- CB LEADS TO BE INSTALLED AT MIN. 1.0% SLOPE OR AS DIRECTED BY CONTRACT ADMINISTRATOR.
- ADJUST EXISTING CATCH BASINS AND MANHOLES AND ISOLATE AS PER SD-220A.
- GAS INFRASTRUCTURE NOTES:
  - A MINIMUM VERTICAL SEPARATION OF 300 mm FROM GAS MAINS AND 100 mm FROM GAS SERVICE LINES MUST BE MAINTAINED BETWEEN THE BOTTOM OF ANY MANITOBA HYDRO FACILITY AND THE TOP OF ANY NEW CATCH BASIN OR LAND DRAINAGE SEWER.
  - A MINIMUM HORIZONTAL SEPARATION OF 1.0 m MUST BE MAINTAINED BETWEEN ANY MANITOBA HYDRO FACILITY AND ANY NEW CATCH BASIN.
  - A MINIMUM 900 mm OF COVER SHALL BE MAINTAINED IN ALL AREAS WHERE EQUIPMENT WILL BE CROSSING, TRAVELING OR COMPACTING OVER THE 168.3 mm GAS MAINS.
  - A MINIMUM 600 mm OF COVER SHALL BE MAINTAINED IN ALL AREAS WHERE EQUIPMENT WILL BE CROSSING, TRAVELING OR COMPACTING OVER THE 114.3 mm AND 60.3 mm GAS MAINS.
  - A MINIMUM 450 mm OF COVER SHALL BE MAINTAINED IN ALL AREAS WHERE EQUIPMENT WILL BE CROSSING, TRAVELING OR COMPACTING OVER THE GAS SERVICE LINES.
  - IF EQUIPMENT MUST CROSS, TRAVEL, OR COMPACT OVER THE GAS MAIN WITH LESS THAN THE MINIMUM DEPTH OF COVER, EARTH BRIDGING OR STEEL PLATES SHALL BE PLACED OVER THE MAIN AND EXTEND A MINIMUM OF 1.0 m ON EITHER SIDE AT EACH CROSSING LOCATION.
  - CAUTION MUST BE USED TO ENSURE THE INTEGRITY OF THE GAS PIPELINE COATING. ANY DAMAGES TO THE COATING MUST BE REPORTED TO AND REPAIRED BY MANITOBA HYDRO PRIOR TO BACKFILLING.
  - ALL EXCAVATIONS WITHIN 1.0 m OF ANY NATURAL GAS MAIN MUST BE COMPLETED BY HAND OR SOFT DIG METHODS.
- CONTRACTOR TO CONTACT JEFF SADLER OF NORSCAN INSTRUMENTS LTD. AT 233-9138 TO MARK OUT "DARK FIBRE NETWORK" PRIOR TO CONSTRUCTION.
- PROTECT EXISTING LEGAL PINS IN NEW PAVEMENT UTILIZING A WATER VALVE INSERT. GRIND OFF SYMBOL ON COVER.
- SEE P-3329-17 THROUGH 20 FOR TYPICAL CROSS-SECTIONS.

**WARNING**

IF POWER EQUIPMENT OR EXPLOSIVES ARE TO BE USED FOR EXCAVATION ON THIS PROJECT THE CONTRACTOR MUST:

- NOTIFY THE GAS COMPANY OF THE PROPOSED LOCATION OF EXCAVATION.
- TAKE PRECAUTION TO AVOID DAMAGE TO GAS COMPANY INSTALLATIONS SEE PROVINCIAL REGULATION 210/72 FOR DETAILS.
- OBTAIN EXCAVATION PERMITS PRIOR TO CONSTRUCTION.

**METRIC**

WHOLE NUMBERS INDICATE MILLIMETRES  
DECIMALIZED NUMBERS INDICATE METRES



Certificate of Authorization  
**Dillon Consulting Limited (MB)**  
No. 1789 Date: 06/08/2012

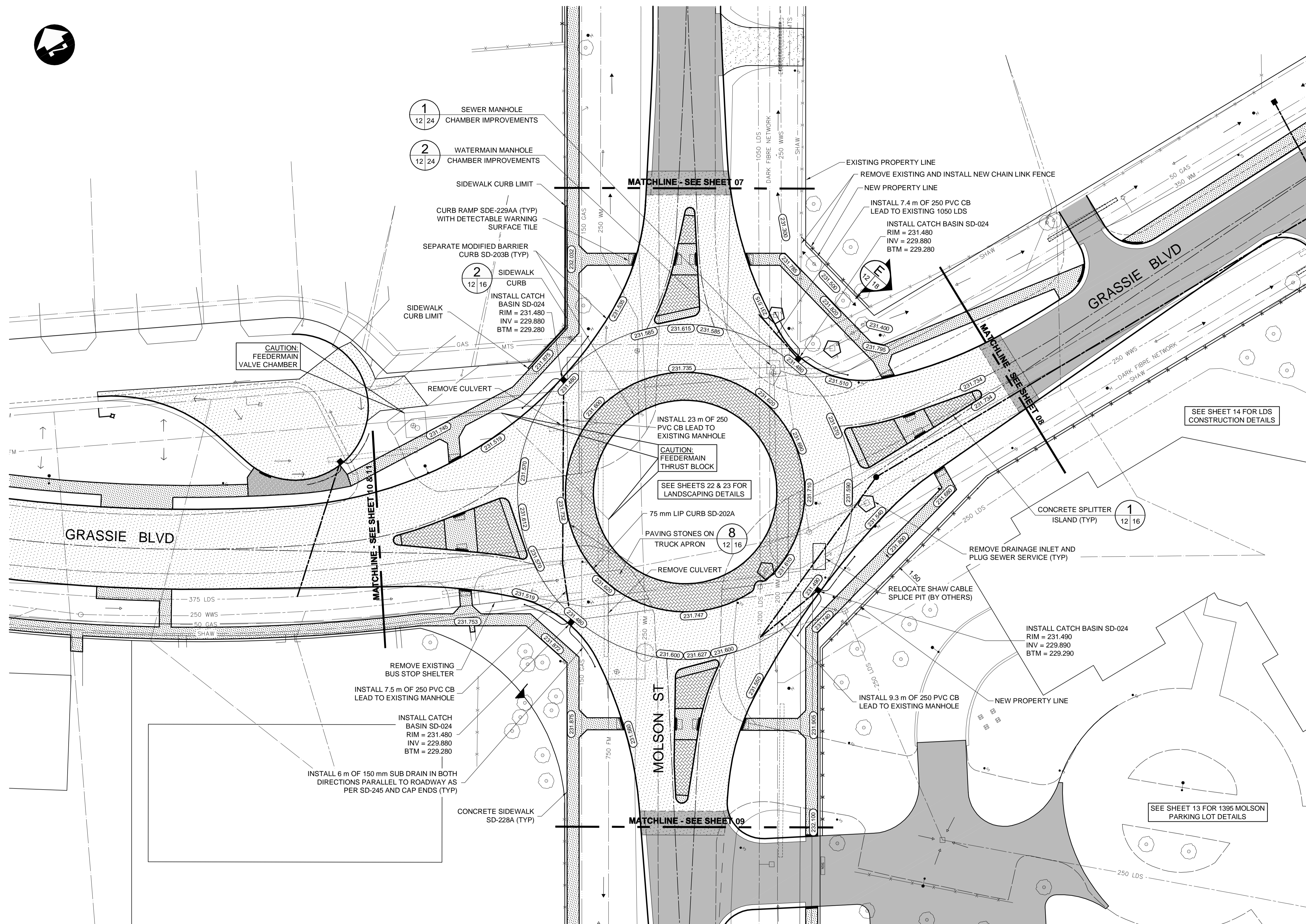
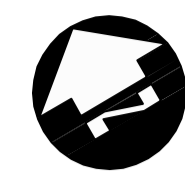

G:\CAD\114588\Contract\Current\Plan\Profile-Circle.dwg

EXISTING	LEGEND-PLAN	PROPOSED	EXISTING	LEGEND-PLAN	PROPOSED	EXISTING	LEGEND-PROFILE	PROPOSED
	WATERMAIN			HYDRO			WATERMAIN	
	HYDRANT VALVE			M.T.S.			HYDRANT VALVE	
	LAND DRAINAGE SEWER			300 LDS			LAND DRAINAGE SEWER	
	WASTE WATER SEWER			250 WWS			WASTE WATER SEWER	
	MANHOLE			ASPHALT			ASPHALT	
	CATCH BASIN			PLANING			PLANING	
	CURB INLET			SIDEWALK			SIDEWALK	
	JUNCTIONS			PAVING STONES			PAVING STONES	
	CULVERT			PARTIAL DEPTH REPAIR			PARTIAL DEPTH REPAIR	
	GAS			SURVEY BAR			SURVEY BAR	
	GAS			CURB RAMP			CURB RAMP	

**UNDERGROUND STRUCTURES**

SUPPLY U/G STRUCTURES COMMITTEE DATE

NOTE:  
LOCATION OF UNDERGROUND STRUCTURES AS SHOWN ARE BASED ON THE BEST INFORMATION AVAILABLE BUT NO GUARANTEE IS GIVEN THAT ALL EXISTING UTILITIES ARE SHOWN OR THAT THE GIVEN LOCATIONS ARE EXACT. CONFIRMATION OF EXISTENCE AND EXACT LOCATION OF ALL SERVICES MUST BE OBTAINED FROM THE INDIVIDUAL UTILITIES BEFORE PROCEEDING WITH CONSTRUCTION.

NO.	REVISIONS	DATE	BY	DATE	BY
3	ISSUED FOR TENDER	06/08/12	DBW		
2	ISSUED FOR REVIEW	05/31/12	DBW		
1	ISSUED FOR REVIEW	07/28/11	DBW		

DESIGNED BY	DRAWN BY	CHECKED BY	APPROVED BY	HOR. SCALE	VERTICAL
RTP	TJH	DBW	DPK	1:250	

**DILLON CONSULTING**

RELEASED FOR CONSTRUCTION

ENGINEER'S SEAL

PROVINCE OF MANITOBA  
REGISTERED PROFESSIONAL ENGINEER

T.J. PETERS  
06/08/2012  
Member 22309

CONSULTANT PROJECT NUMBER  
11-4588

**THE CITY OF WINNIPEG**  
PUBLIC WORKS DEPARTMENT

ROUNDABOUT CONSTRUCTION  
GRASSIE BOULEVARD AND MOLSON STREET INTERSECTION

CITY DRAWING NUMBER  
P-3329-12

SHEET  
12 OF 24

CONSULTANT DRAWING NUMBER

PAVING AND GRADING - ROUNDABOUT